

F.A.P. RTE.	SECTION	COUNTY	TOTAL SHEETS	SHEET NO.
807	00-00374-01-PV	CHAMPAIGN	242	87
STA.		TO STA.		
		ILLINOIS F.A. PROJ. NO. RS-HPP-1805(001)		
CONTRACT NO. 91368				



**SUGGESTED STAGE V CONSTRUCTION SEQUENCE**

1. CLOSE CURTIS ROAD TO ALL TRAFFIC AT WYNSTONE DRIVE (STATION 60+30) IN ACCORDANCE WITH STANDARD BLR 21. CLOSE CURTIS ROAD TO ALL TRAFFIC AT MATTIS AVENUE (STATION 85+10) IN ACCORDANCE WITH STANDARD BLR 21. CLOSE HALLBECK DRIVE TO THRU TRAFFIC AT THE SOUTH SIDE OF THE BARKSTALL ELEMENTARY SCHOOL ENTRANCE IN ACCORDANCE WITH STANDARD BLR 22. CLOSE HALLBECK DRIVE TO ALL TRAFFIC AT CURTIS ROAD IN ACCORDANCE WITH STANDARD BLR 21.
2. CONSTRUCT CURTIS ROAD BETWEEN STATIONS 71+62.50 AND 84+08.50. PROVIDE A TEMPORARY DITCH FROM THE UPSTREAM FLARED END SECTION AT LT. STATION 71+88 TO THE EXISTING DITCH AT APPROXIMATE STATION 71+00. PROVIDE A TEMPORARY DITCH FROM RT. STATION 71+62.50 TO THE EXISTING DITCH AT APPROXIMATE STATION 70+50.
3. CONSTRUCT THE PROPOSED CURB AND GUTTER FOR THE MEDIAN BETWEEN STATIONS 134+94 AND 135+24. PROVIDE TRAFFIC CONTROL ON CURTIS ROAD IN ACCORDANCE WITH STANDARD 701601.
4. AT THE END OF STAGE V, TURN ON THE TRAFFIC SIGNALS AT THE INTERSECTION OF CURTIS ROAD AND MATTIS AVENUE.

**LEGEND**

- CONSTRUCTION WORK ZONE
- POST MOUNTED SIGN LOCATION
- DETOUR SIGN NUMBER
- DIRECTION OF DETOUR
- PORTABLE CHANGEABLE MESSAGE SIGN

**DETOUR SIGN LEGEND**

ILLINOIS DEPARTMENT OF TRANSPORTATION  
**STAGE CONSTRUCTION AND MAINTENANCE OF TRAFFIC PLANS**  
 STAGE V

DATE : 10-08  
 DRAWN BY : J.A.J.  
 CHECKED BY : R.L.H.  
 SCALE : NONE

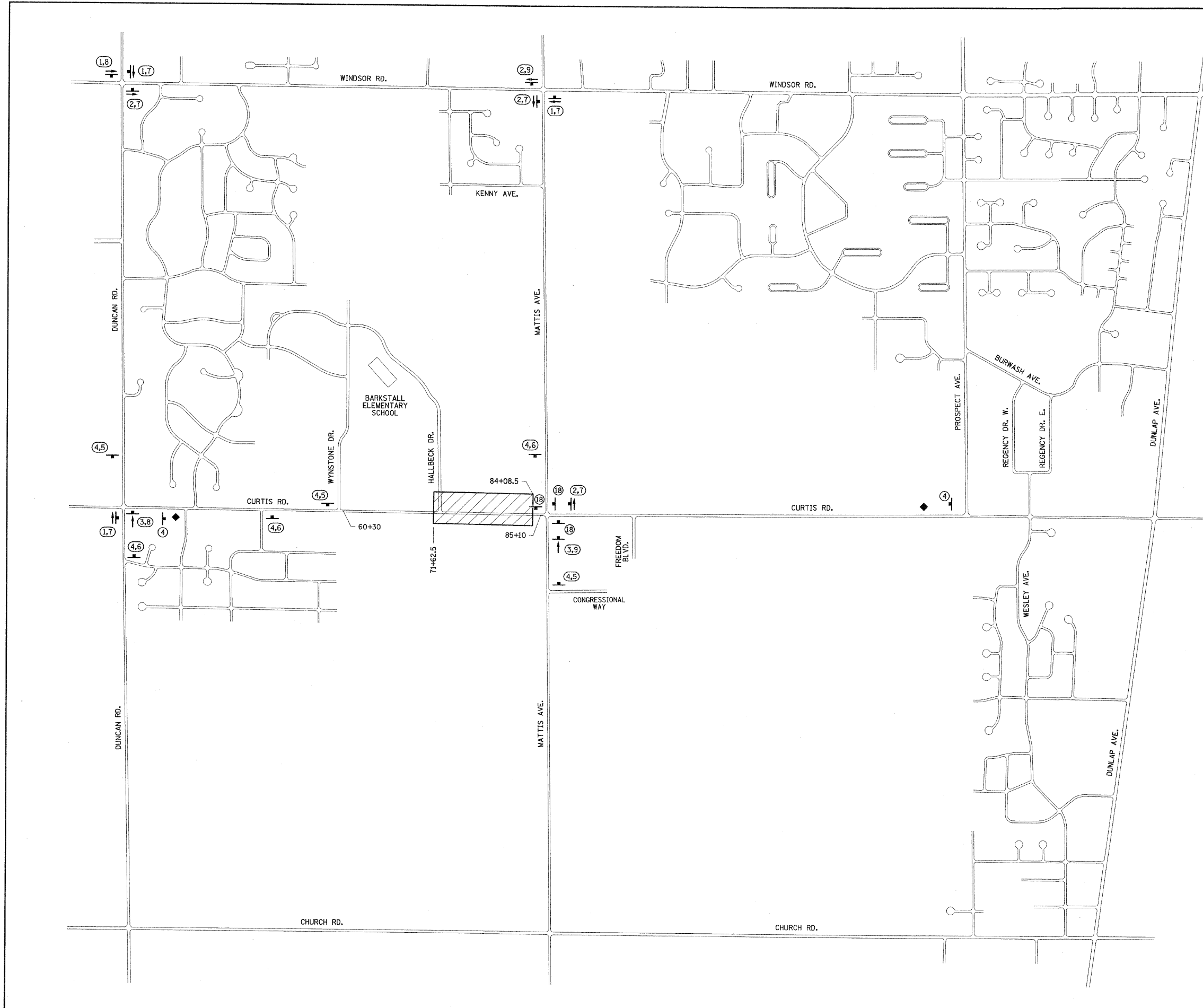

p:\c01401\plans\stageconst.dgn  
 10/2/2008 9:15:20 AM