

# TYPICAL APPLICATIONS OF URBAN PAVEMENT MARKINGS AND MARKERS

F.A.P. RTE.	SECTION	COUNTY	TOTAL SHEETS	SHEET NO.
807	00-00374-01-PV	CHAMPAIGN	242	122
STA.		TO STA.		
ILLINOIS F.A. PROJ. NO. RS-HPP-1805(001)				
CONTRACT NO. 91368				

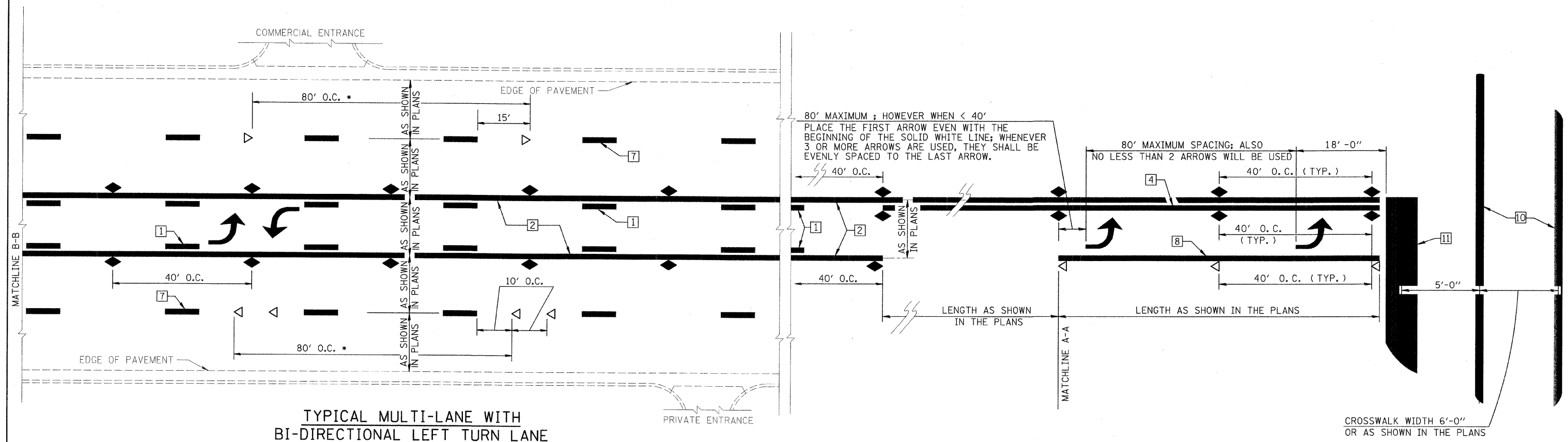

TYPICAL MULTI-LANE WITH BI-DIRECTIONAL LEFT TURN LANE

TYPICAL MULTI-LANE TRANSITION FROM BI-DIRECTIONAL LEFT TURN LANE TO LEFT TURN LANE

## SPECIAL NOTES

- TURN ARROW PAIRS SHALL BE PLACED AT 250' INTERVALS AND SHALL BE EVENLY SPACED BETWEEN BOTH ENDS OF THE BIDIRECTIONAL LEFT TURN LANE.
- THE SOLID YELLOW PAVEMENT MARKINGS [2] SHOULD GENERALLY START OR END NEAR THE RADIUS POINT OF EACH STREET RETURN EXCEPT WHERE ONE OR BOTH ENDS WOULD INCLUDE STOP BARS.
- THE SKIP-DASH PAVEMENT MARKINGS [1] OR [7] SHOULD BE CENTERED BETWEEN BOTH ENDS OF EACH CITY BLOCK AND SHALL BE PLACED SO THEY LINE UP ACROSS FROM EACH OTHER. SEE EXAMPLE ABOVE.
- \* REDUCE TO 40' O.C. IN NO PASSING ZONES AND ON CURVES WHERE ADVISORY SPEEDS ARE 10 MPH LOWER THAN POSTED SPEEDS.
- \*\* WHERE DOUBLE LANE LINE MARKERS ARE SPECIFIED, THEY SHALL BE SPACED AS SHOWN ABOVE.

ILLINOIS DEPARTMENT OF TRANSPORTATION

## PAVEMENT MARKING DETAILS

DATE : 10-08  
DRAWN BY : J.L.B.  
CHECKED BY : R.L.H.

SCALE : NONE