

F.A.P. RTE.	SECTION	COUNTY	TOTAL SHEETS	SHEET NO.
807	00-00374-01-PV	CHAMPAIGN	242	140
STA. 100+00.00		TO STA. 111+00.00		
ILLINOIS F.A. PROJ. NO. RS-HPP-1805/00D				
CONTRACT NO. 91368				

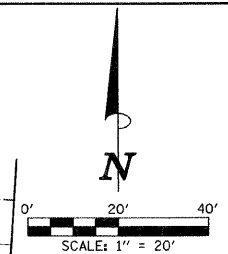

ROADWAY LIGHTING LEGEND

- ☐ PROPOSED TRAFFIC SIGNAL HANDHOLE. (SEE TRAFFIC SIGNAL PLANS FOR LOCATION)
- ⌚ PROPOSED 250W HPS LUMINAIRE, WITH M-C-III DISTRIBUTION, WITH 15' TRUSS ARM MOUNTED ON 35' TRAFFIC SIGNAL MAST ARM POLE. TRUSS ARM ORIENTATION SHALL BE AS INDICATED ON PLANS. TRUSS ARM, POLE, AND POLE FOUNDATION TO BE PROVIDED AND INSTALLED AS PART OF THE TRAFFIC SIGNAL INSTALLATION. COORDINATE LUMINAIRE INSTALLATION WITH POLE AND SIGNAL INSTALLATION.
- ☐ PROPOSED TRAFFIC SIGNAL CONTROLLER CABINET.
- ⌚ PROPOSED LIGHTING CONTROLLER (X INDICATES CONTROLLER #).
- ⌚ PROPOSED 250W HPS LUMINAIRE, WITH M-C-III DISTRIBUTION, WITH 8' MAST ARM MOUNTED ON 35' POLE, WITH AUGERED STEEL FOUNDATION.
- ⌚ PROPOSED 250W HPS LUMINAIRE, WITH M-C-III DISTRIBUTION, WITH 8' MAST ARM MOUNTED ON 35' POLE, WITH CONCRETE FOUNDATION. (SEE NOTE 13)
- ☐ PROPOSED JUNCTION BOX, SPECIAL. ALL JUNCTION BOXES SHALL BE 12"W x 12"L x 12"D UNLESS OTHERWISE NOTED.
- — — PROPOSED PVC CONDUIT (SCH. 80), AUGERED (SEE CONDUIT/CABLE SCHEDULE FOR QUANTITIES. (SEE NOTE 14)
- — — PROPOSED PVC CONDUIT (SCH. 40) IN TRENCH (SEE CONDUIT/CABLE SCHEDULE FOR QUANTITIES)

ELECTRIC SERVICE INSTALLATION, SPECIAL (SEE TECHNICAL SPECIFICATIONS)
THE POWER POLE AND ITS EXACT LOCATION WILL BE PROVIDED BY AMERENIP DURING CONSTRUCTION.

CONDUIT/CABLE SCHEDULE

- ① (1) 2" PVC CONDUIT WITH 2-#8, 1-#8 GND.
- ② (1) 2" PVC CONDUIT WITH 4-#8, 1-#8 GND.
- ③ (1) 2" PVC CONDUIT WITH 4-#6, 1-#6 GND.
- ④ (2) 3" PVC SERVICE LATERAL CONDUITS (1) WITH 3-#1 AND (1) SPARE. SERVICE LATERAL CONDUITS ABOVE GRADE SHALL BE RIGID GALVANIZED STEEL, ALL ELBOWS SHALL BE LONG RADIUS TYPE, RIGID GALVANIZED STEEL. SERVICE LATERAL CONDUITS SHALL COMPLY WITH ALL AMEREN IP REQUIREMENTS.
- ⑤ (2) 2" PVC CONDUITS, EACH WITH 4-#6, 1-#6 GND.

CIRCUIT DESIGNATION SCHEME

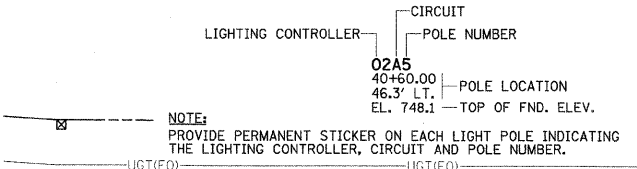

NOTE: PROVIDE PERMANENT STICKER ON EACH LIGHT POLE INDICATING THE LIGHTING CONTROLLER, CIRCUIT AND POLE NUMBER.

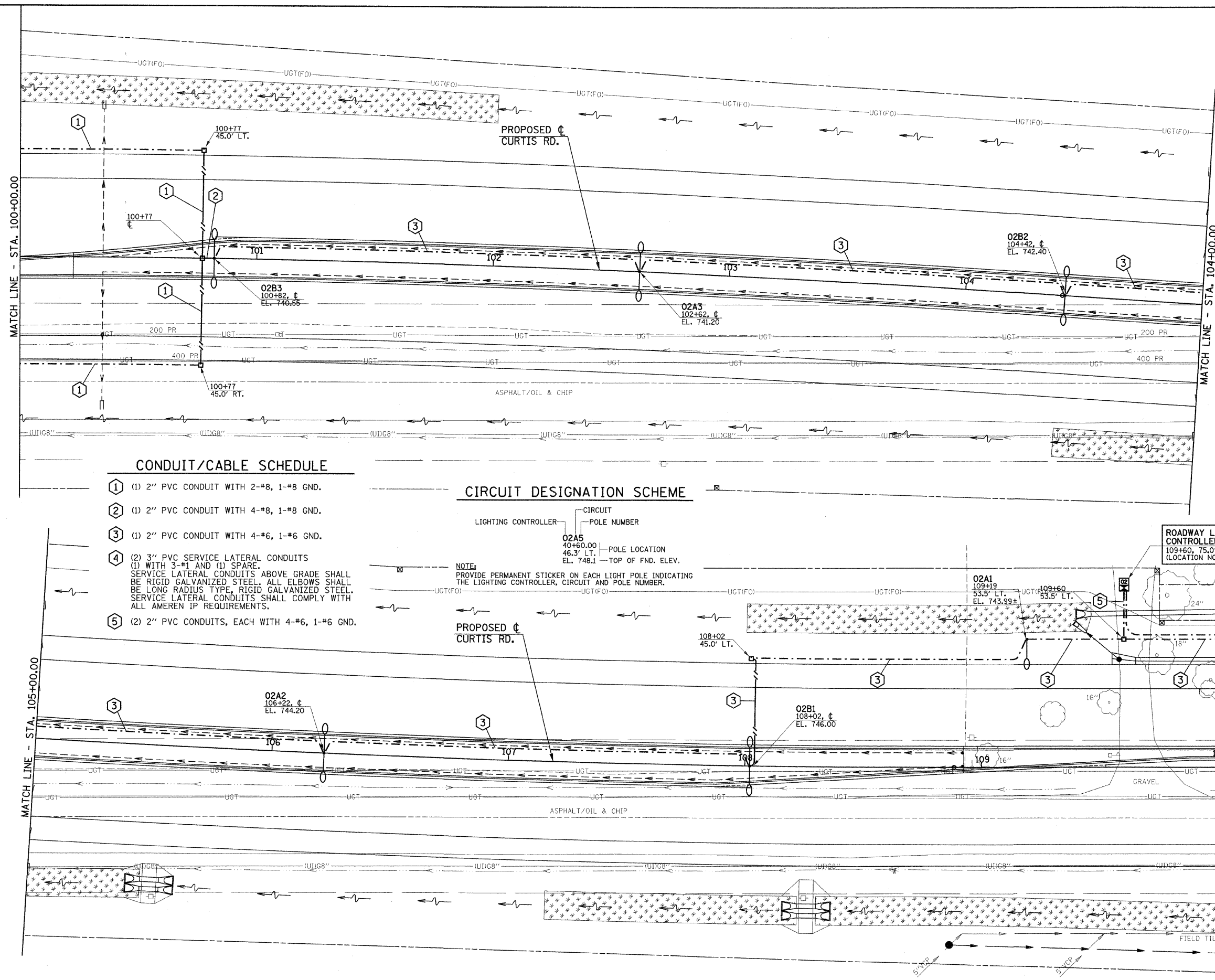

ILLINOIS DEPARTMENT OF TRANSPORTATION

CURTIS ROAD ROADWAY LIGHTING PLANS

DATE : 10-08
DRAWN BY : RJS/JAJ
CHECKED BY : JJP

SCALE : 1"=20'