

F.A.P. RTE.	SECTION	COUNTY	TOTAL SHEETS	SHEET NO.
807	00-00374-01-PV	CHAMPAIGN	242	159
STA.	TO STA.			
ILLINOIS F.A. PROJ. NO. RS-HPP-1805(00)				
CONTRACT NO. 91368				

- NOTES:**
- SEE THE P.C. CONCRETE DRIVEWAY DETAIL FOR ADDITIONAL DETAIL INFORMATION AND GENERAL NOTES.
 - EXISTING PAVING BRICKS AND POSTS SHALL BE SALVAGED AND BECOME THE PROPERTY OF THE OWNER. IF THE OWNER DOES NOT WANT THE SALVAGED MATERIALS THEY SHALL BE DISPOSED OF OFF SITE AS DIRECTED BY THE ENGINEER. THE COST OF REMOVING AND DISPOSING OF THE MATERIALS SHALL BE INCLUDED IN THE COST OF EARTH EXCAVATION AND NO ADDITIONAL COMPENSATION WILL BE ALLOWED.
 - THIS WORK WILL BE PAID FOR AT THE CONTRACT UNIT PRICES FOR THE FOLLOWING PAY ITEMS:
 20200100 EARTH EXCAVATION = 28 CU YD
 42300400 P.C. CONCRETE DRIVEWAY PAVEMENT 8" = 143 SQ YD
 42400300 P.C. CONCRETE SIDEWALK 6" = 88 SQ FT
 44000500 COMBINATION CURB AND GUTTER REMOVAL = 42 FOOT
 44000600 SIDEWALK REMOVAL = 88 SQ FT
 60261100 INLETS TO BE ADJUSTED WITH NEW TYPE 9 FRAME AND GRATE = 1 EACH
 60604400 COMBINATION CONCRETE CURB AND GUTTER, TYPE B-6.18 = 42 FOOT
 FLEXIBLE POST BARRICADE = 3 EACH
 - THE COST OF CONSTRUCTING THE P.C. CONCRETE SIDEWALK 8" THICK THROUGH THE DRIVEWAY SHALL BE INCLUDED IN THE COST OF THE P.C. CONCRETE SIDEWALK 6" AND NO ADDITIONAL COMPENSATION WILL BE ALLOWED.
 - THE FLEXIBLE POST BARRICADES SHALL BE INSTALLED AFTER THE PERMANENT DRIVEWAY TO PROSPECT POINTE APARTMENTS ON CURTIS ROAD IS OPENED TO TRAFFIC. THIS DRIVEWAY WILL THEN BE CLOSED TO TRAFFIC EXCEPT FOR EMERGENCY VEHICLE USE. THE FLEXIBLE POST BARRICADES WILL BE PAID FOR AT THE CONTRACT UNIT PRICE EACH FOR FLEXIBLE POST BARRICADES. SEE THE SPECIAL PROVISIONS FOR ADDITIONAL INFORMATION.

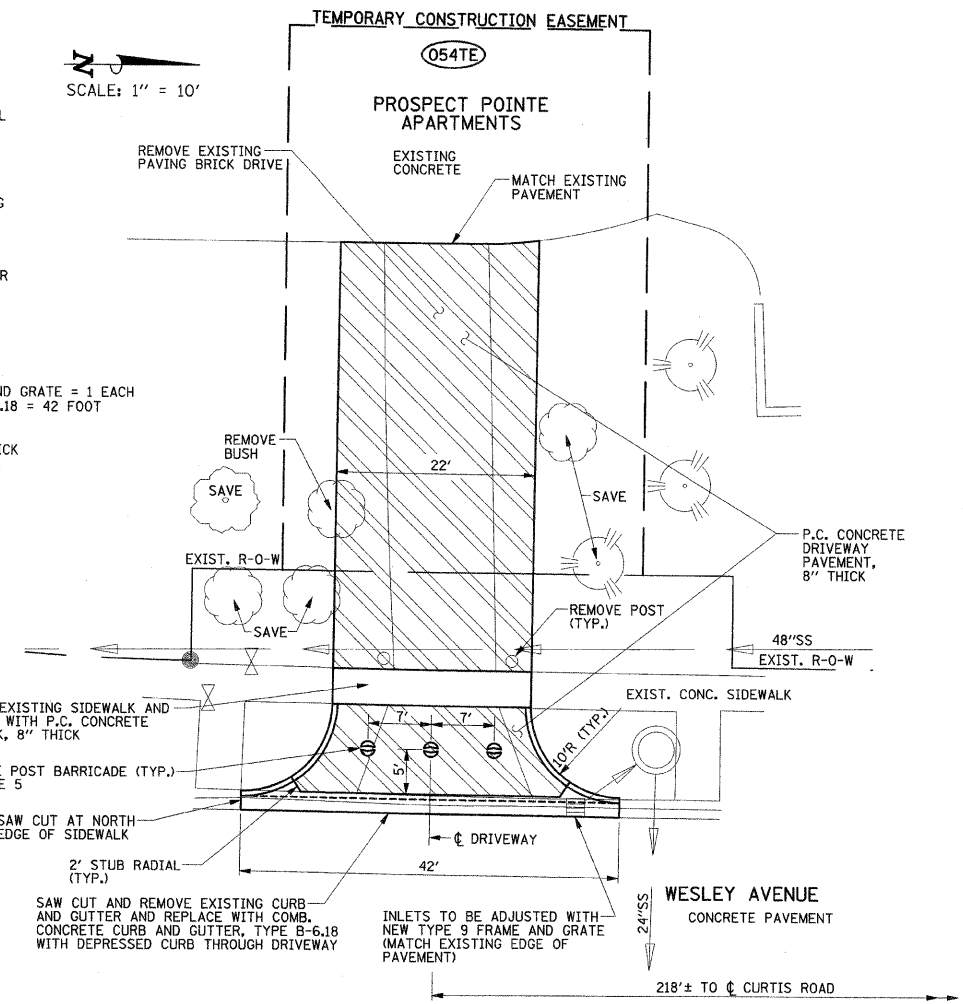

PROSPECT POINTE APARTMENTS DRIVEWAY DETAIL

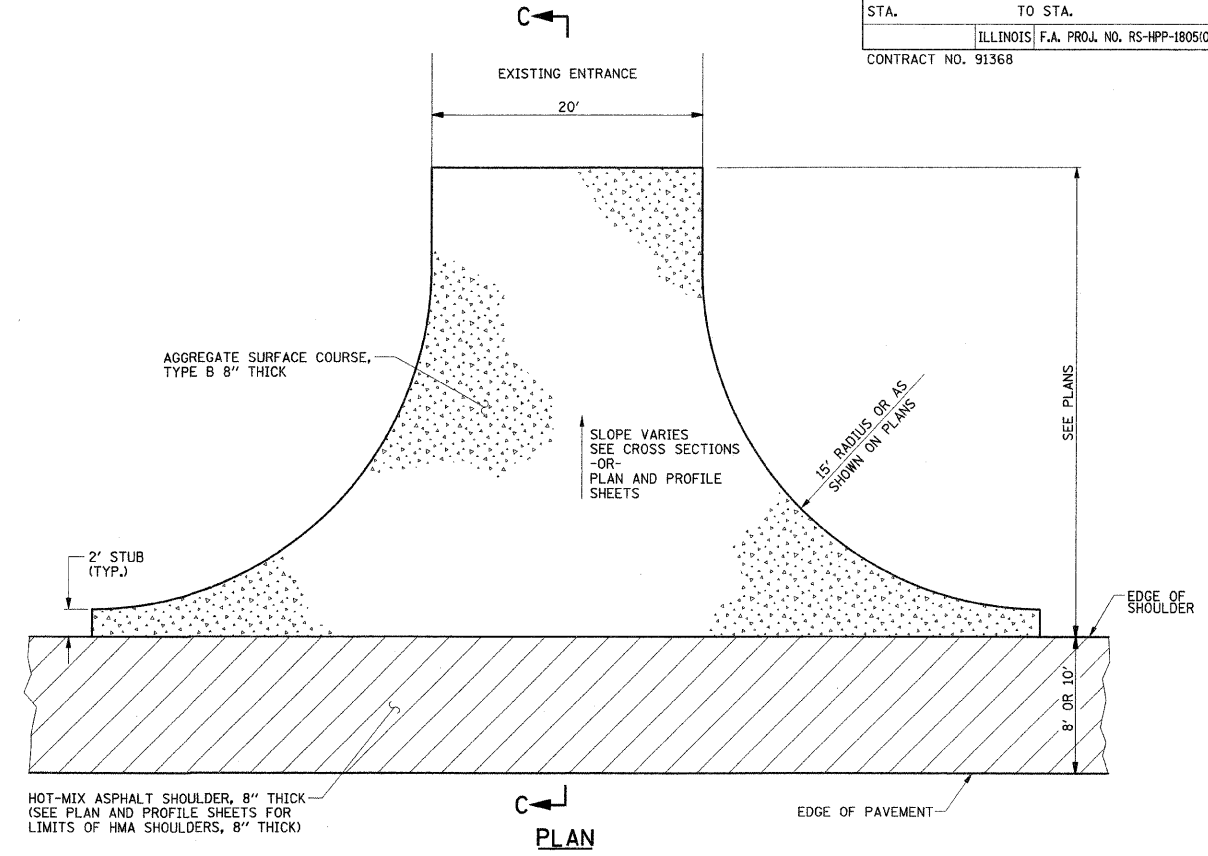

FIELD ENTRANCE DETAIL

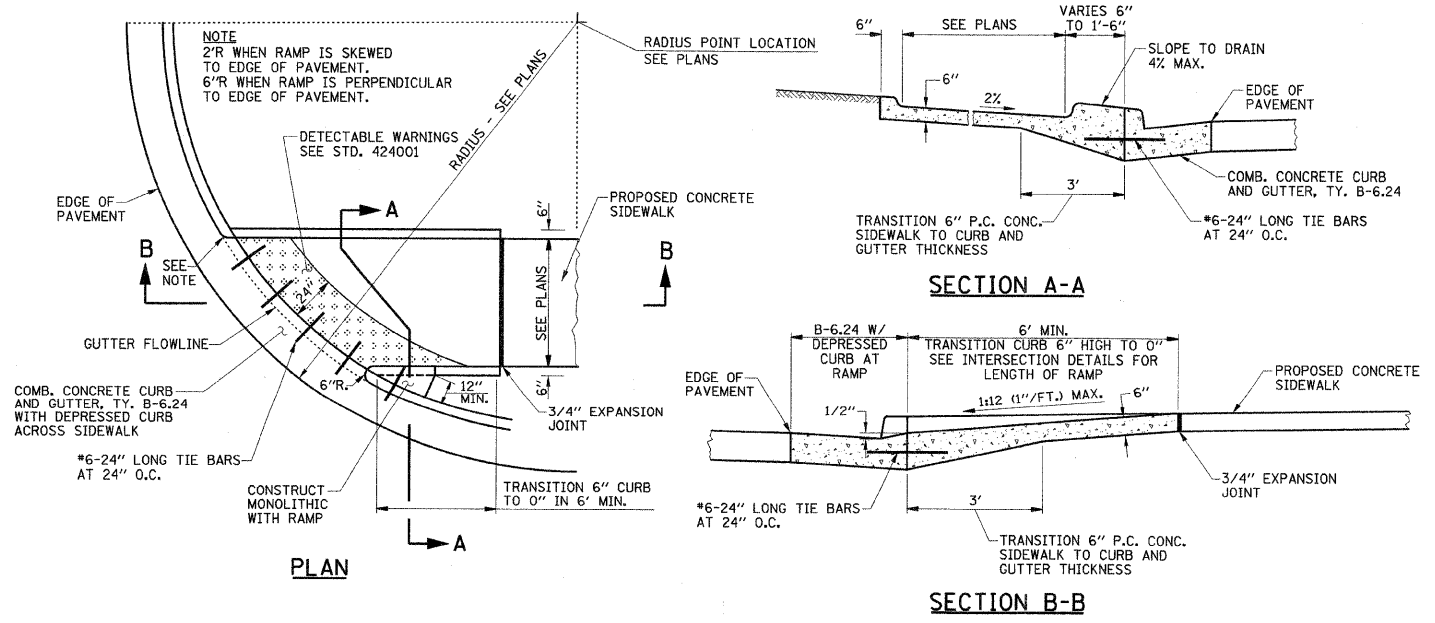

P.C. CONCRETE SIDEWALK RAMP DETAILS

SIDEWALK GENERAL NOTES

- THE COST OF CONSTRUCTING THE DEPRESSED CURB AS SHOWN SHALL BE CONSIDERED INCLUDED IN THE COST OF CONSTRUCTING COMBINATION CONCRETE CURB AND GUTTER TYPE B-6.24 AND NO ADDITIONAL COMPENSATION WILL BE ALLOWED.
- THE COST OF FURNISHING AND INSTALLING THE 3/4" EXPANSION JOINTS AND #6-24" LONG TIE BARS AND THE COST OF CONSTRUCTING THE P.C.C. SIDEWALK THICKNESS TRANSITION, INCLUDING THE ADJACENT CURBING AS SHOWN, SHALL BE INCLUDED IN THE COST OF CONSTRUCTING P.C. CONCRETE SIDEWALK 6" AND NO ADDITIONAL COMPENSATION WILL BE ALLOWED.
- THE DETECTABLE WARNINGS SHALL HAVE A CONTRASTING COLOR APPROVED BY THE ENGINEER AND SHALL BE CONSTRUCTED IN ACCORDANCE WITH STANDARD 424001 AND THE STANDARD SPECIFICATIONS. THE DETECTABLE WARNINGS WILL BE PAID FOR AT THE CONTRACT UNIT PRICE PER SQUARE FOOT FOR DETECTABLE WARNINGS.
- WHEN PREFABRICATED DETECTABLE WARNING PRODUCTS ARE USED THE SIDEWALK RAMP BELOW THE DETECTABLE WARNING UNITS SHALL BE A MINIMUM OF 4" THICK.
- THE NORMAL CROSS SLOPES OF SIDEWALKS SHALL BE 2.0% EXCEPT AT THE RAMP LOCATIONS.
- TRANSVERSE SAWED JOINTS SHALL BE PLACED AT 5' CENTERS FOR 5' WIDE SIDEWALKS AND AT 10' CENTERS FOR 8' WIDE SIDEWALKS. THE 3/4" EXPANSION JOINTS SHALL BE PLACED AT 100' CENTERS.

ILLINOIS DEPARTMENT OF TRANSPORTATION

P.C. CONCRETE SIDEWALK, FIELD ENTRANCE AND DRIVEWAY DETAILS

DATE : 10-08
 DRAWN BY : J.L.B.
 CHECKED BY : R.L.H.

SCALE : NONE