

FINAL SURVEY	SUBMITTED	DATE
NOTE BOOK	PLOTTED	BY
NO.	TEMPLATE	
	AREAS CHECKED	

ORIGINAL SURVEY	SUBMITTED	DATE
NOTE BOOK	PLOTTED	BY
NO.	TEMPLATE	
	AREAS CHECKED	

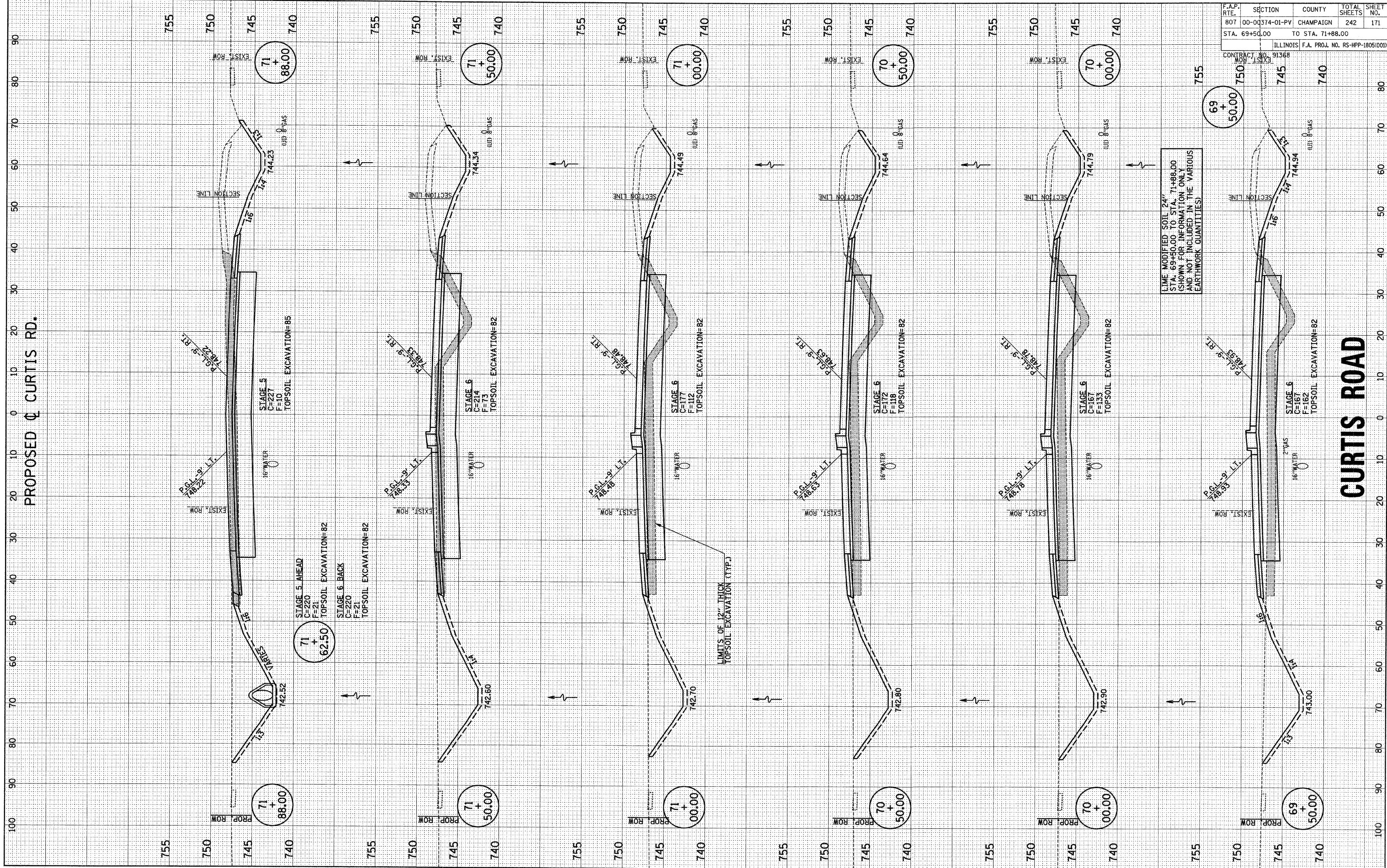

LIME MODIFIED SOIL 24" STA. 69+40.00 TO STA. 71+88.00 (SHOWN FOR INFORMATION ONLY AND NOT INCLUDED IN THE VARIOUS EARTHWORK QUANTITIES)

F.A.P. RTE.	SECTION	COUNTY	TOTAL SHEETS	SHEET NO.
807	00-00374-01-PV	CHAMPAIGN	242	171
STA. 69+50.00	TO STA. 71+88.00			
ILLINOIS		F.A. PROJ. NO. RS-HPP-1805(001)		

CURTIS ROAD