

FINAL SURVEY	SURVEYED	BY	DATE
NOTE BOOK	PLOTTED		
	TEMPLATE		
	AREAS CHECKED		

ORIGINAL SURVEY	SURVEYED	BY	DATE
NOTE BOOK	PLOTTED		
	TEMPLATE		
	AREAS CHECKED		

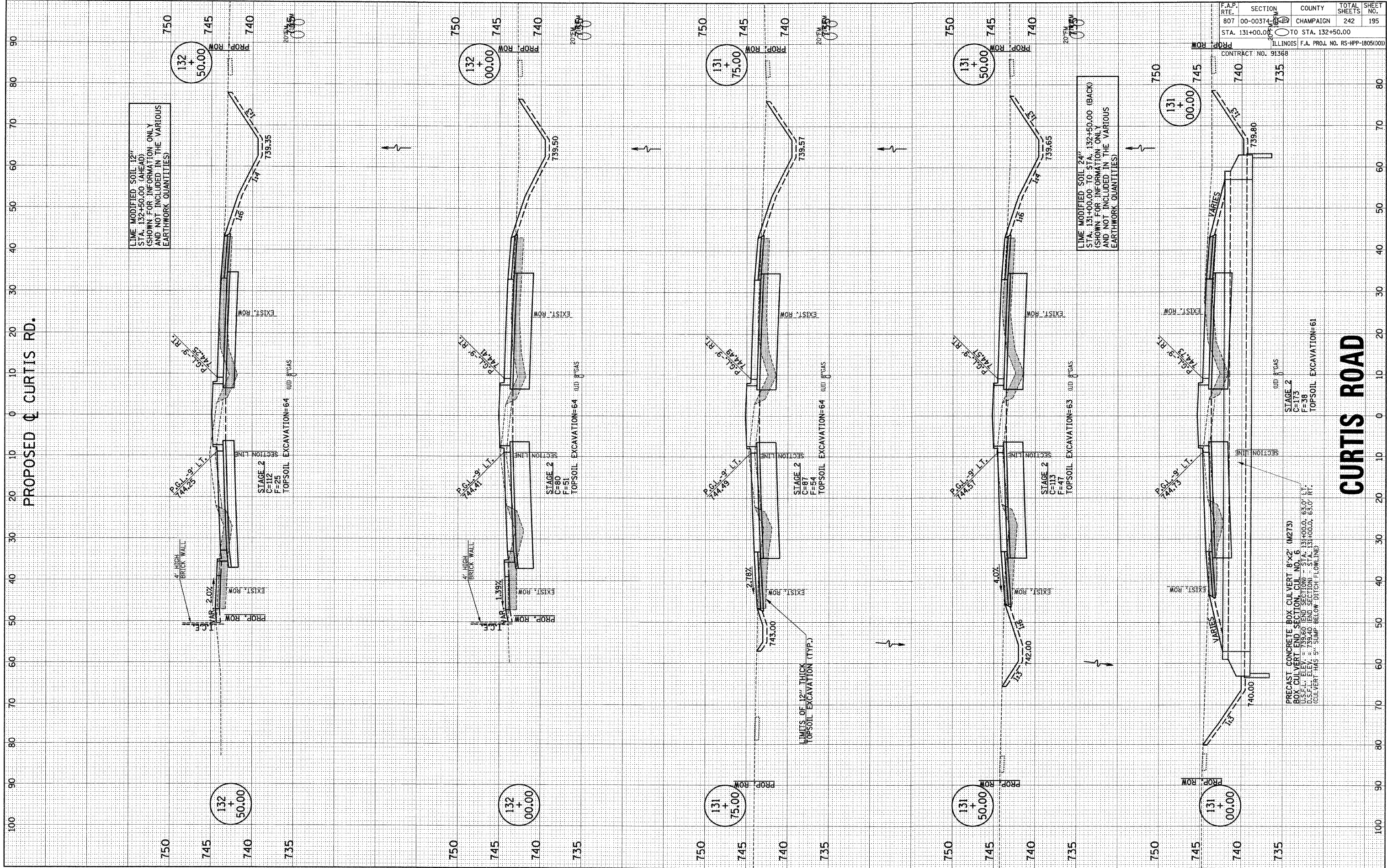

LIME MODIFIED SOIL 12"
 STA. 132+50.00 (AHEAD)
 (SHOWN FOR INFORMATION ONLY
 AND NOT INCLUDED IN THE VARIOUS
 EARTHWORK QUANTITIES)

LIME MODIFIED SOIL 24"
 STA. 131+00.00 TO STA. 132+50.00 (BACK)
 (SHOWN FOR INFORMATION ONLY
 AND NOT INCLUDED IN THE VARIOUS
 EARTHWORK QUANTITIES)

PRECAST CONCRETE BOX CULVERT 8'x2' (M2T3)
 BOX CULVERT END SECTION, CUL. NO. 6
 U.S. L.I. ELEV. = 739.60 END SECTION - STA. 131+00.00, 63.0' LT.
 (CULVERT HAS 5" SUMP BELOW DITCH FLOWLINE)

F.A.P. RTE.	SECTION	COUNTY	TOTAL SHEETS	SHEET NO.
807	00-00374-01-PV	CHAMPAIGN	242	195
STA. 131+00.00 TO STA. 132+50.00		ILLINOIS F.A. PROJ. NO. RS-HPP-1805(00)		
CONTRACT NO. 93P61				

CURTIS ROAD