

| F.A.P. RTE.         | SECTION      | COUNTY           | TOTAL SHEETS | SHEET NO. |
|---------------------|--------------|------------------|--------------|-----------|
| 781                 | 1YRS, 2ZRS-1 | CRAWFORD         | 378          | 107       |
| STA. 15+900         |              | TO STA. 16+016   |              |           |
| FED. ROAD DIST. NO. | ILLINOIS     | FED. AID PROJECT |              |           |

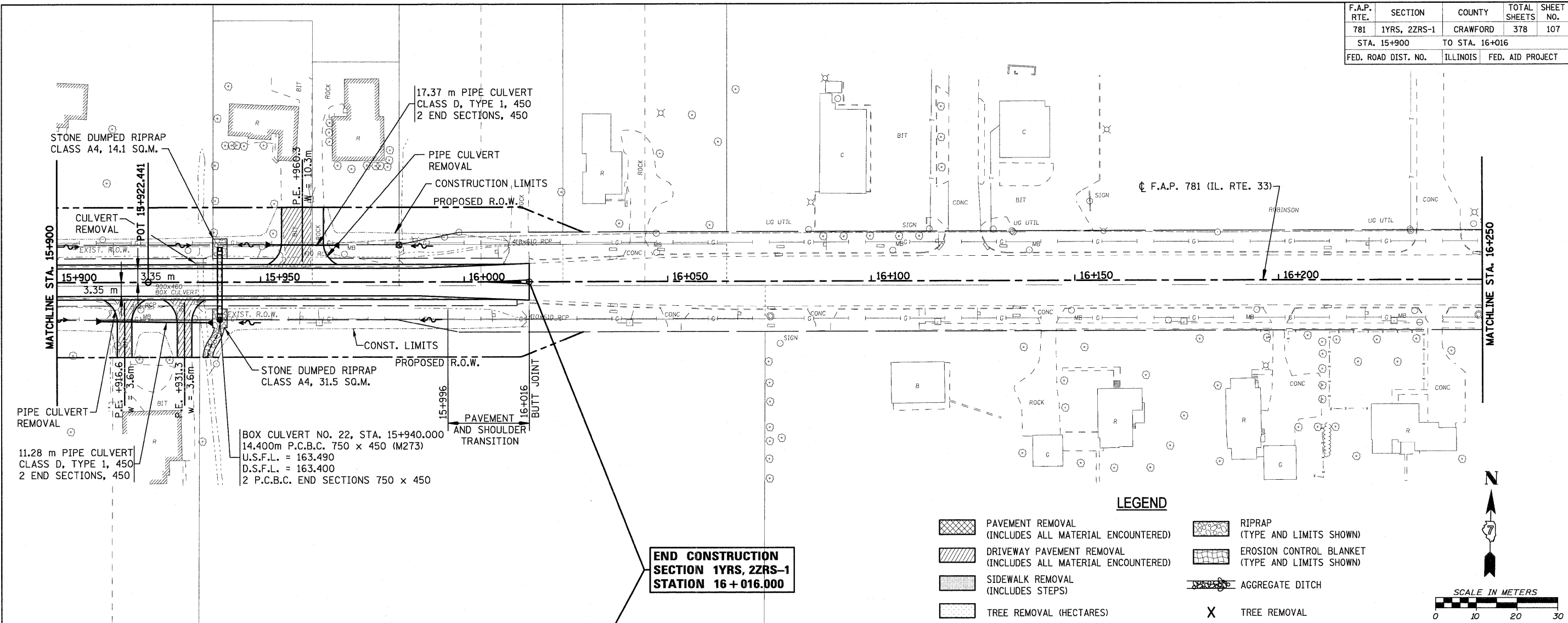

**END CONSTRUCTION  
SECTION 1YRS, 2ZRS-1  
STATION 16 + 016.000**

**LEGEND**

- PAVEMENT REMOVAL (INCLUDES ALL MATERIAL ENCOUNTERED)
- DRIVEWAY PAVEMENT REMOVAL (INCLUDES ALL MATERIAL ENCOUNTERED)
- SIDEWALK REMOVAL (INCLUDES STEPS)
- TREE REMOVAL (HECTARES)
- RIPRAP (TYPE AND LIMITS SHOWN)
- EROSION CONTROL BLANKET (TYPE AND LIMITS SHOWN)
- AGGREGATE DITCH
- TREE REMOVAL

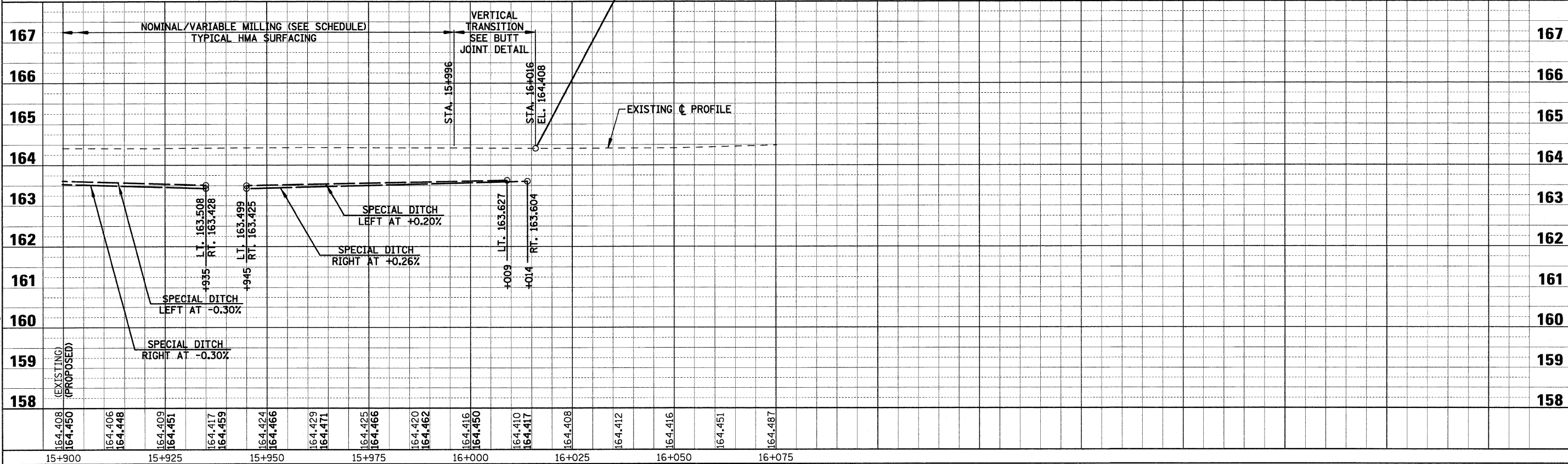
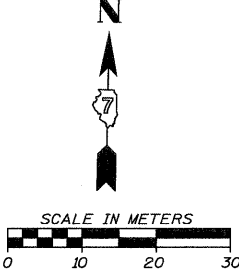

PLOT DATE = 4/18/2008  
FILE NAME = H:\1428\70107\_50pp\_41.dgn