

DATE	BY
REVISIONS	PLOTTED
ALIGNMENT CHECKED	NO. _____
NOTE BOOK	NO. _____
STRUCTURE NOTATIONS CHD	NO. _____

DATE	BY
REVISIONS	PLOTTED
GRADES CHECKED	NO. _____
STRUCTURE NOTATIONS CHD	NO. _____

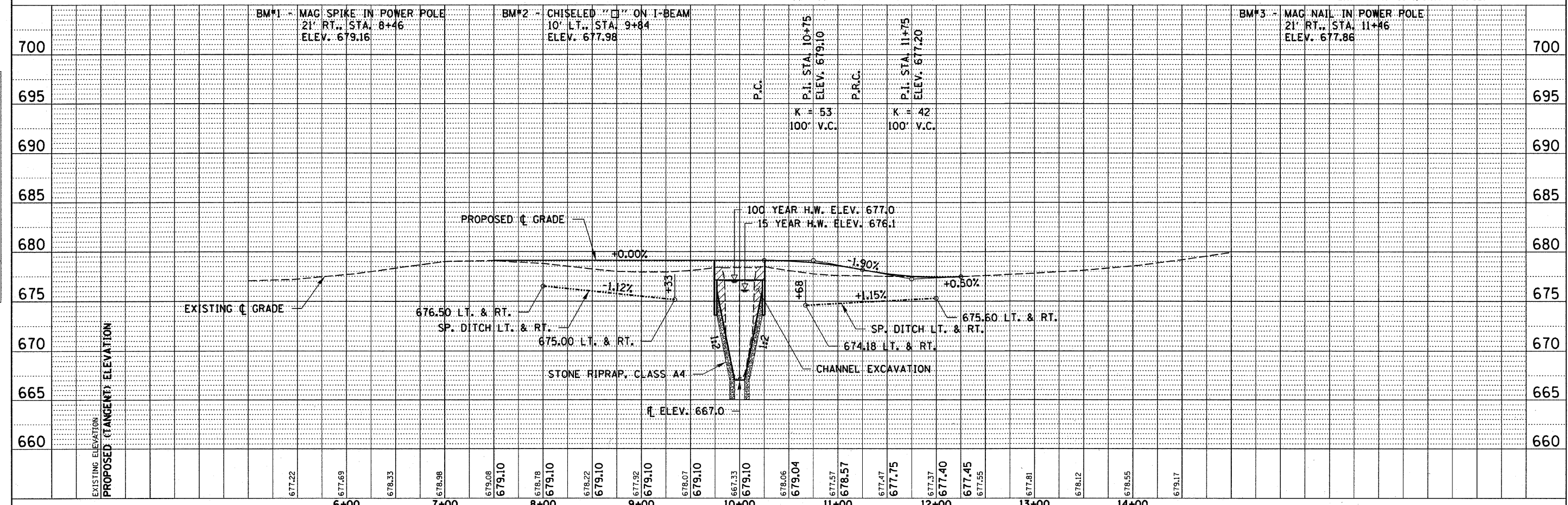

FILE NAME = 080094-sht-pp1.dgn	USER NAME =	DESIGNED - J.W.F.	REVISED -	STATE OF ILLINOIS MOULTRIE COUNTY HIGHWAY DEPARTMENT HAMPTON, LENZINI & RENWICK, INC. CIVIL & STRUCTURAL ENGINEERS LAND SURVEYORS SCALE: 1:50	PLAN & PROFILE LOWE ROAD DISTRICT T.R. 146 SECTION 08-05125-00-BR COUNTY MOULTRIE TOTAL SHEETS 15 SHEET NO. 3 CONTRACT NO. 95565 FED. ROAD DIST. NO. 7 ILLINOIS FED. AID PROJECT
	PLOT SCALE =	DRAWN - D.T.M.	REVISED -		
	PLOT DATE = 10/29/2008	CHECKED - S.W.M.	REVISED - S.W.M.		
		DATE - 04/08/08	REVISED - 10/29/08		