

F&P ROUTE	SECTION	COUNTY	TOTAL SHEETS	SHEET NO.
05-00016-03-BR	MADISON	129	29	
STA. 27+00	TO STA. 32+00			
CONTRACT NO.: 97351				

DATE	BY	BY	BY
2/2/06	J.P.F.	J.P.F.	J.P.F.
2/2/06	ERCO	ERCO	ERCO
2/2/06	ERCO	ERCO	ERCO
2/2/06	ERCO	ERCO	ERCO
2/2/06	ERCO	ERCO	ERCO
2/2/06	ERCO	ERCO	ERCO
2/2/06	ERCO	ERCO	ERCO
2/2/06	ERCO	ERCO	ERCO
2/2/06	ERCO	ERCO	ERCO

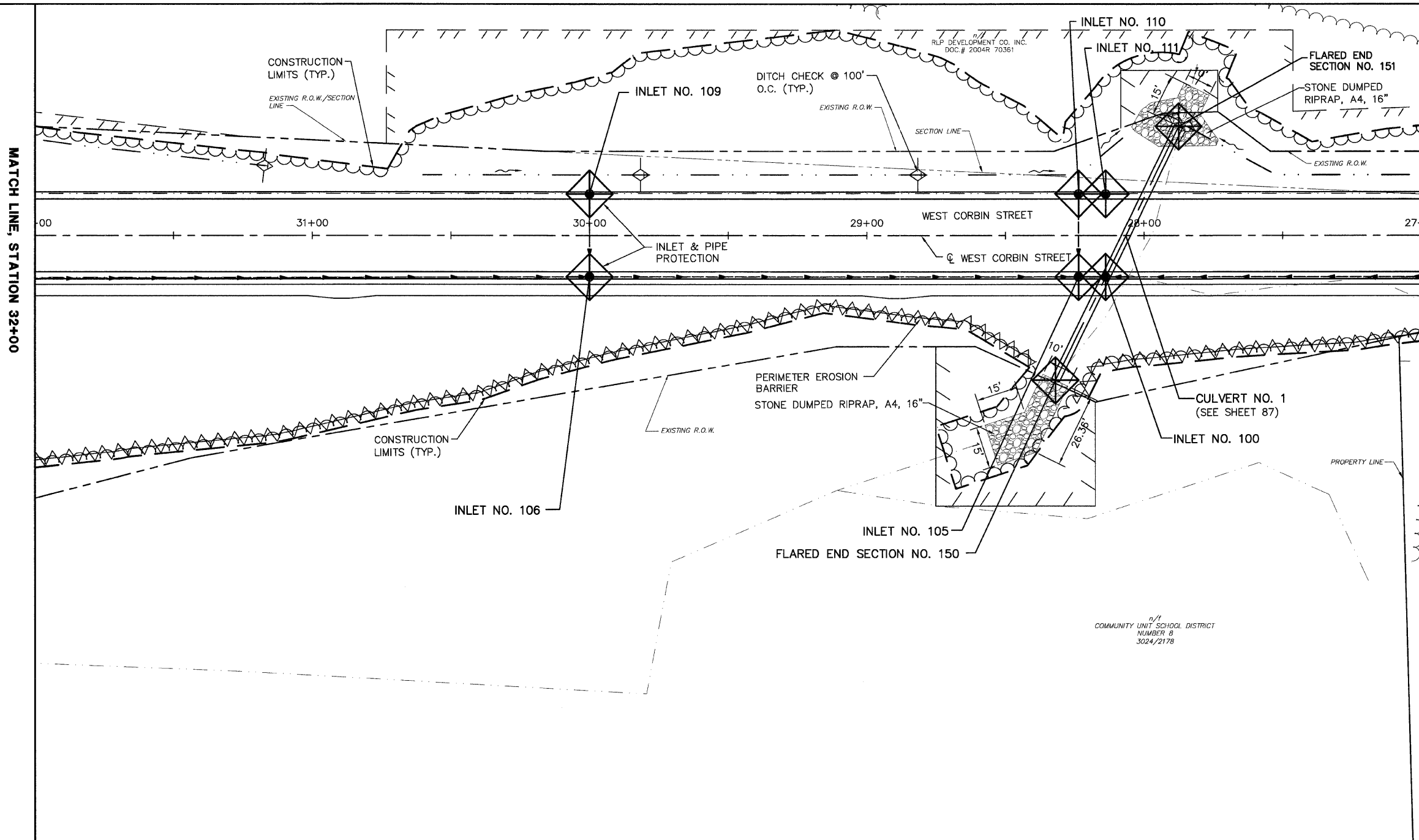

**LEGEND:**

	EXISTING STORM SEWER
	EXISTING SANITARY SEWER
	EXISTING SANITARY MANHOLE
	CONSTRUCTION LIMITS
	PROPOSED STORM SEWER
	PROPOSED SANITARY SEWER
	PROPOSED DITCH
	PROPOSED CURB INLET
	PROPOSED STORM MANHOLE
	PROPOSED SANITARY MANHOLE
	PROPOSED DITCH CHECK (TEMPORARY)
	PROPOSED DITCH FLOW
	PERIMETER EROSION BARRIER
	PROPOSED INLET AND PIPE PROTECTION

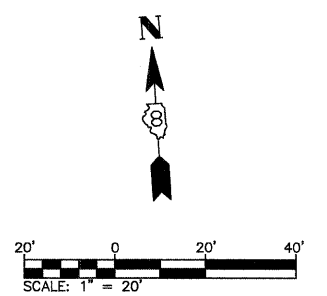

REVISIONS	
NAME	DATE

ILLINOIS DEPARTMENT OF TRANSPORTATION  
**EROSION AND SEDIMENT CONTROL PLANS—WEST CORBIN STREET**  
 FAU ROUTE 8959  
 SECTION 05-00016-03-BR  
 COUNTY MADISON  
 DRAWN BY: R.A.W.