

RESTORATION OF WORK AREA

RESTORATION OF THE TRAFFIC SIGNAL WORK AREA SHALL BE INCIDENTAL TO THE RELATED PAY ITEM SUCH AS FOUNDATION, CONDUIT, HANDHOLE, TRENCH AND BACKFILL, ETC., AND NO EXTRA COMPENSATION SHALL BE ALLOWED. ALL ROADWAY SURFACES SUCH AS SHOULDERS, MEDIANS, SIDEWALKS, PAVEMENT, ETC. SHALL BE REPLACED IN KIND. ALL DAMAGE TO MOWED LAWNS SHALL BE REPLACED WITH AN APPROVED SOD, AND ALL DAMAGE TO UNMOWED FIELDS SHALL BE SEEDING IN ACCORDANCE WITH STANDARD SPECIFICATIONS 252 AND 250 RESPECTIVELY.

NOTE:
THE TRAFFIC SIGNAL CONTROL EQUIPMENT FOR THIS PROJECT SHALL BE "ECONOLITE".

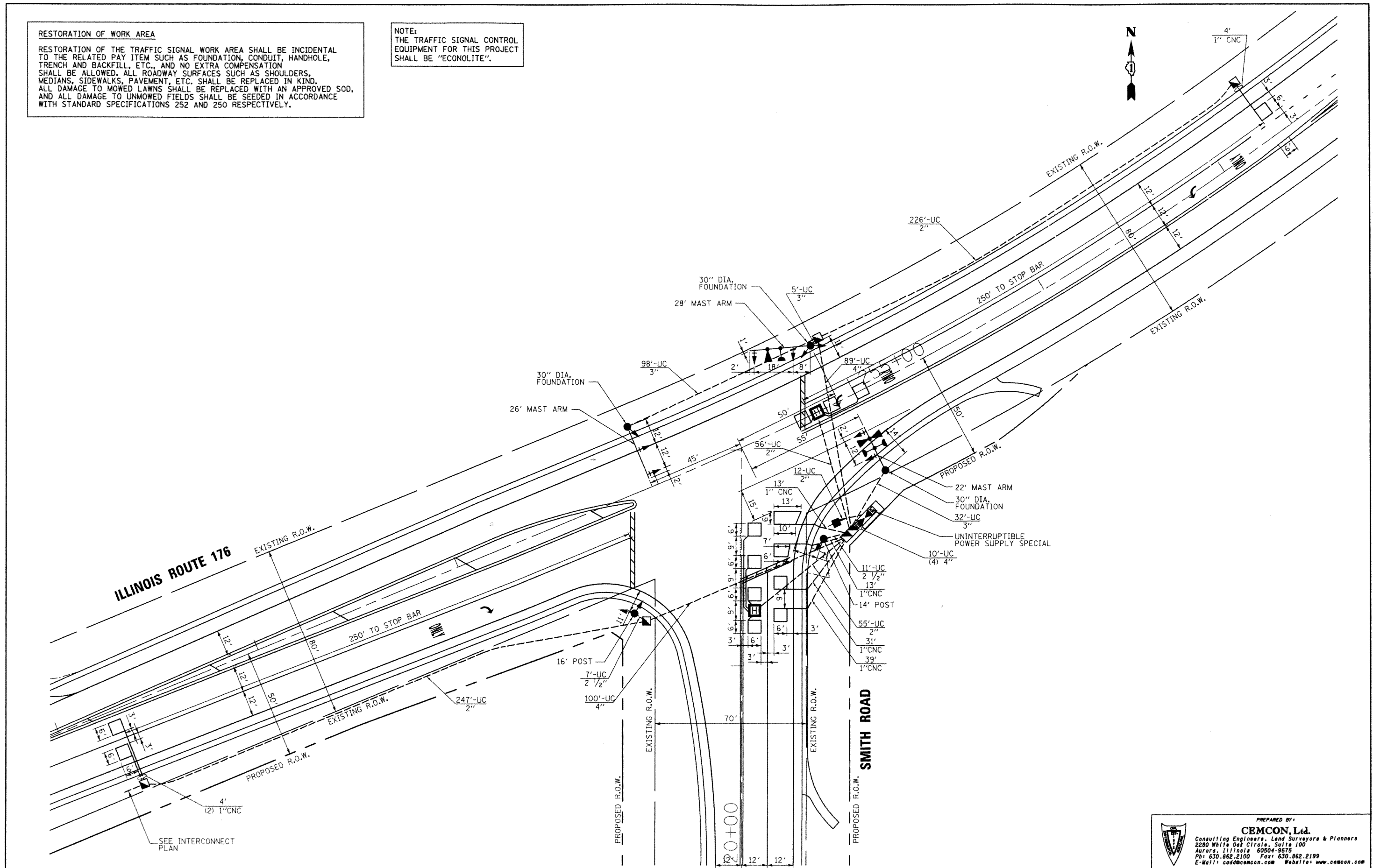

FILE NAME =
MICROST\352995\ RTE 176 SIG.DGN

USER NAME = ROS
PLOT SCALE = 1"=20'
PLOT DATE = 02-27-12

DESIGNED - KK
DRAWN - JGC
CHECKED - BPT
DATE - 02-27-12

REVISED -
REVISED -
REVISED -
REVISED -

**STATE OF ILLINOIS
DEPARTMENT OF TRANSPORTATION**

**TRAFFIC SIGNAL INSTALLATION PLAN
ILLINOIS ROUTE 176 AT SMITH ROAD**

SCALE: N.T.S. SHEET NO. OF SHEETS STA. TO STA.

PREPARED BY:				
CEMCON, Ltd.				
Consulting Engineers, Land Surveyors & Planners				
2280 White Oak Circle, Suite 100				
Aurora, Illinois 60504-9675				
Ph: 630.862.2100 Fax: 630.862.2199				
E-Mail: cadd@cemcon.com Website: www.cemcon.com				
F.A.P. RTE.	SECTION	COUNTY	TOTAL SHEETS	SHEET NO.
355	146 N-2	McHENRY	65	35
			CONTRACT NO. 60K20	
FED. ROAD DIST. NO.		ILLINOIS FED. AID PROJECT		