

**PART OF THE SE. 1/4 OF SECTION 16, TWP. 38 N., R. 12 E. OF THE 3RD. P.M., IN COOK COUNTY, ILLINOIS.**

F.A.P. RTE.	SECTION	COUNTY	TOTAL SHEETS	SHEET NO.
330	2010-082-1	COOK	152	63
CONTRACT NO. 60L73			ILLINOIS FED. AID PROJECT	

**LEGEND**

- SECTION CORNER
- QUARTER SECTION CORNER
- SECTION LINE
- QUARTER SECTION LINE
- QUARTER, QUARTER SECTION LINE
- PLATTED LOT LINES
- PROPERTY (DEED) LINE
- APL APPARENT PROPERTY LINE
- EXISTING CENTERLINE
- PROPOSED CENTERLINE
- EXISTING RIGHT OF WAY LINE
- PROPOSED RIGHT OF WAY LINE
- PROPOSED EASEMENT
- MEASURED DIMENSION
- COMPUTED DIMENSION
- RECORDED DIMENSION
- EXISTING BUILDING

GRAPHIC SCALE  
0 50.00  
20.40  
30.60  
SCALE: 1" = 20'

- Bearings are referenced to the Illinois Coordinate System, NAD83, East Zone, as provided by the Illinois Department of Transportation.
- IRON PIPE OR ROD FOUND
  - ⊕ "MAG" NAIL SET
  - + CUT CROSS FOUND OR SET
  - 5 / 8" REBAR SET
  - T1 THESE STAKES REFERENCE FOUND OR SET MONUMENTATION. SET 5/8 INCH IRON ROD FLUSH WITH GROUND TO TIE FOUND IRON STAKE IDENTIFIED BY COLORED PLASTIC CAP BEARING SURVEYORS REGISTRATION NUMBER.
  - T2
  - T3
  - BT1 THESE STAKES, IN CULTIVATED AREAS, REFERENCE FOUND OR SET MONUMENTATION. BURIED 5/8 INCH IRON ROD 20 INCHES BELOW GROUND TO TIE FOUND IRON STAKE, IDENTIFIED BY COLORED PLASTIC CAP BEARING SURVEYORS REGISTRATION NUMBER.
  - BT2
  - BT3
  - STAKING OF PROPOSED RIGHT OF WAY. SET DIVISION OF HIGHWAYS SURVEY MARKER TO MONUMENT THE POSITION SHOWN, IDENTIFIED BY INSCRIPTION DATA AND SURVEYORS REGISTRATION NUMBER.
  - M STAKING OF PROPOSED RIGHT OF WAY IN CULTIVATED AREAS. BURIED 5/8 INCH METAL ROD 20 INCHES BELOW GROUND TO MARK FUTURE SURVEY MARKER POSITION IDENTIFIED BY COLORED PLASTIC CAP BEARING SURVEYORS REGISTRATION NUMBER.
  - ⊙ PERMANENT SURVEY MARKER, I.D.O.T. STANDARD 2135 (TO BE SET BY OTHERS)
  - RIGHT OF WAY STAKING PROPOSED TO BE SET

STATE OF ILLINOIS )  
COUNTY OF WILL )

THIS IS TO CERTIFY THAT I, KENNETH J. PESAVENTO, AN ILLINOIS PROFESSIONAL LAND SURVEYOR, (WE, RUETTIGER, TONELLI & ASSOCIATES, AN ILLINOIS PROFESSIONAL DESIGN FIRM LAND SURVEYING CORPORATION, NUMBER 89,) HAVE SURVEYED THE PLAT OF HIGHWAYS SHOWN HEREON IN SECTION 16, TOWNSHIP 38 NORTH, RANGE 12 EAST OF THE THIRD PRINCIPAL MERIDIAN, COOK COUNTY, THAT THE SURVEY IS TRUE AND COMPLETE AS SHOWN TO THE BEST OF MY KNOWLEDGE AND BELIEF, THAT THE PLAT CORRECTLY REPRESENTS SAID SURVEY, THAT ALL MONUMENTS FOUND AND ESTABLISHED ARE OF PERMANENT QUALITY AND OCCUPY THE POSITIONS SHOWN THEREON AND THAT THE MONUMENTS ARE SUFFICIENT TO ENABLE THE SURVEY TO BE RETRACED, MADE FOR THE DEPARTMENT OF TRANSPORTATION, STATE OF ILLINOIS.

DATED AT Shrewsbury, ILLINOIS THIS 7th DAY OF October 2013 A.D.

*Kenneth J. Pesavento*  
ILLINOIS PROFESSIONAL LAND SURVEYOR NO. 3425  
LICENSE EXPIRATION DATE: 11-30-2014

THIS PROFESSIONAL SERVICE CONFORMS TO THE CURRENT ILLINOIS MINIMUM STANDARDS FOR A BOUNDARY SURVEY.

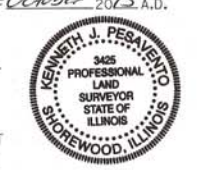

**RUETTIGER, TONELLI & ASSOCIATES, INC.**  
Land Surveyors/Engineers/Planners/Landscape Architects/G.I.S. Consultants  
129 CAPISTA DRIVE  
SHOREWOOD, ILLINOIS 60404  
PH. (815) 744-6600 FAX (815) 744-0101

**PLAT OF HIGHWAYS**  
STATE OF ILLINOIS  
DEPARTMENT OF TRANSPORTATION  
US 12/20/45

LIMITS: at Joliet Rd. COUNTY: COOK  
PROJECT JOB NO.: R90-008-11  
STATION 80+00 TO STATION 84+50  
SCALE: 1"=20' SHEET 14 OF 19

BUREAU OF LAND ACQUISITION  
201 WEST CENTER COURT  
SCHAUMBURG, ILLINOIS 60196

PARCEL NUMBER	OWNER	TOTAL HOLDINGS ACRES	PART TAKEN ACRES	AREA IN EXISTING R.O.W. ACRES	REMAINDER AREA ACRES	EASEMENT ACRES	AREA SQUARE FEET	EASEMENT PURPOSE	PERMANENT INDEX NUMBER	PROPERTY ACQUIRED BY
OHF001	CITY OF COUNTRYSIDE	5.510	A-0.122 B-0.171	N/A	5.217	TE-A-0.047 TE-F-0.010	N/A	CONST.	18-16-400-010 18-16-400-020 18-16-400-019 PT 18-16-400-023 PT	

See remainder of parcel OHF0011 on Sheets 13 & 15.  
See Total Holding diagram on Sheet 13.

**Lot 3**  
**Countryside City Center**  
Rec'd Sept. 18, 2012 as doc. no. 1226210108 and cert. of correction rec'd Oct. 11, 2012 as doc. no. 1228518001

**COORDINATE TABLE**

STATION	PT#	NORTH	EAST
80+00.31	55.00' RT.	5162	1863096.636
80+00.33	50.00' RT.	5181	1863096.467
84+00.00	33.00' RT.	7694	1863495.205
81+99.71	50.00' RT.	7740	1863295.704
81+99.78	33.00' RT.	7741	1863295.130
84+00.00	50.00' RT.	7744	1863495.850
84+25.33	50.00' RT.	7745	1863521.165

NOTES:  
COORDINATES SHOWN ABOVE ARE PROJECT COORDINATES. MULTIPLY PROJECT COORDINATES BY THE COMBINED SCALE FACTOR OF 0.9999620 TO OBTAIN ILLINOIS STATE PLANE COORDINATES EAST ZONE NAD83 (2007).

