

REVISED LIGHTING CONTROLLER CIRCUIT SCHEDULE (@ 240 VOLTS)						
	CIRCUIT	EXISTING LOAD	DEMO LOAD	TOTAL LOAD WATTS	TOTAL LOAD AMPS	C/B SIZE
1	SOUTHEAST	5616W	1008	4608W	19.2A	50A /1P
2	SOUTHWEST	3888W	1008	2880W	12A	50A /1P
	TOTAL	9504W	2016	7488W	31.2A	

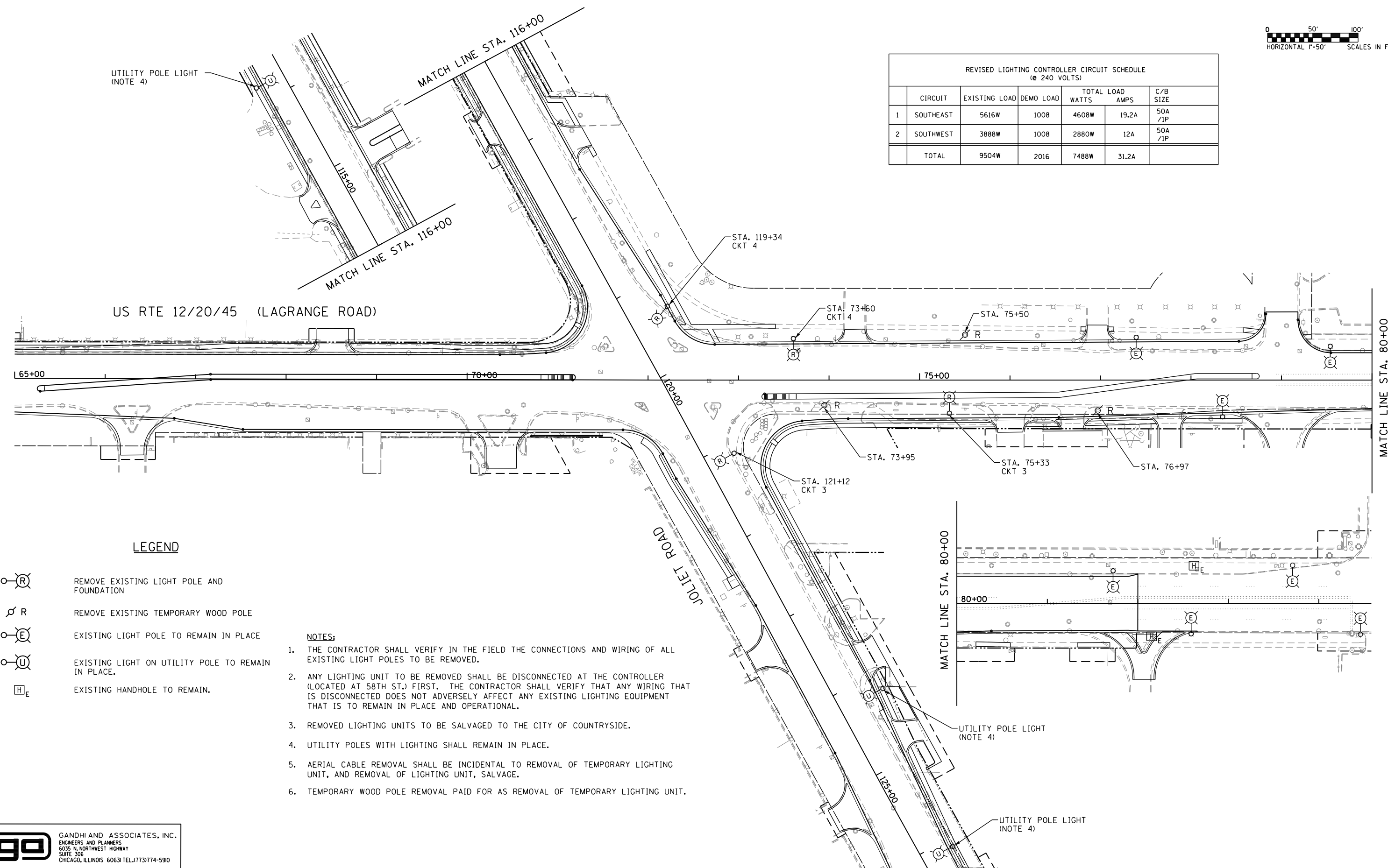
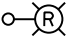
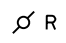
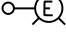
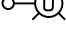
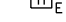

LEGEND

-  REMOVE EXISTING LIGHT POLE AND FOUNDATION
-  REMOVE EXISTING TEMPORARY WOOD POLE
-  EXISTING LIGHT POLE TO REMAIN IN PLACE
-  EXISTING LIGHT ON UTILITY POLE TO REMAIN IN PLACE.
-  EXISTING HANDHOLE TO REMAIN.

- NOTES:**
1. THE CONTRACTOR SHALL VERIFY IN THE FIELD THE CONNECTIONS AND WIRING OF ALL EXISTING LIGHT POLES TO BE REMOVED.
 2. ANY LIGHTING UNIT TO BE REMOVED SHALL BE DISCONNECTED AT THE CONTROLLER (LOCATED AT 58TH ST.) FIRST. THE CONTRACTOR SHALL VERIFY THAT ANY WIRING THAT IS DISCONNECTED DOES NOT ADVERSELY AFFECT ANY EXISTING LIGHTING EQUIPMENT THAT IS TO REMAIN IN PLACE AND OPERATIONAL.
 3. REMOVED LIGHTING UNITS TO BE SALVAGED TO THE CITY OF COUNTRYSIDE.
 4. UTILITY POLES WITH LIGHTING SHALL REMAIN IN PLACE.
 5. AERIAL CABLE REMOVAL SHALL BE INCIDENTAL TO REMOVAL OF TEMPORARY LIGHTING UNIT, AND REMOVAL OF LIGHTING UNIT, SALVAGE.
 6. TEMPORARY WOOD POLE REMOVAL PAID FOR AS REMOVAL OF TEMPORARY LIGHTING UNIT.

ga GANDHI AND ASSOCIATES, INC.
ENGINEERS AND PLANNERS
6035 N. NORTHWEST HIGHWAY
SUITE 306
CHICAGO, ILLINOIS 60631 TEL. (773) 774-5910

FILE NAME =	USER NAME = #USER#	DESIGNED - PKG	REVISED -
#FILEL#		DRAWN - MG, EA	REVISED -
	PLOT SCALE = #SCALE#	CHECKED - PKG	REVISED -
	PLOT DATE = #DATE#	DATE - 8/28/2013	REVISED -

**STATE OF ILLINOIS
DEPARTMENT OF TRANSPORTATION**

LIGHTING REMOVAL PLAN			
SCALE: 1"= 50'	SHEET NO. OF SHEETS	STA. TO STA.	

F.A.P. RTE. 330	SECTION 2010-082-1	COUNTY COOK	TOTAL SHEETS 152	SHEET NO. 114
FED. ROAD DIST. NO. 1 ILLINOIS FED. AID PROJECT				
CONTRACT NO. 60L73				