

TEMPORARY TRAFFIC SIGNAL NOTES

1. THESE SIGNAL HEADS SHALL BE INSTALLED PRIOR TO THE BEGINNING OF M.O.T. STAGE 4.
2. THE LEFT TURN SECTIONS OF THESE SIGNAL HEADS SHALL BE BAGGED AND DISCONNECTED PRIOR TO THE BEGINNING OF M.O.T. STAGE 4.
3. THE "LEFT ON GREEN ARROW ONLY" SIGNS SHALL BE INSTALLED AT THE LOCATIONS SHOWN ON THE SPAN WIRE PRIOR TO ACTIVATION OF THE LEFT TURN SIGNAL HEADS AT THE BEGINNING OF M.O.T. STAGE 4.

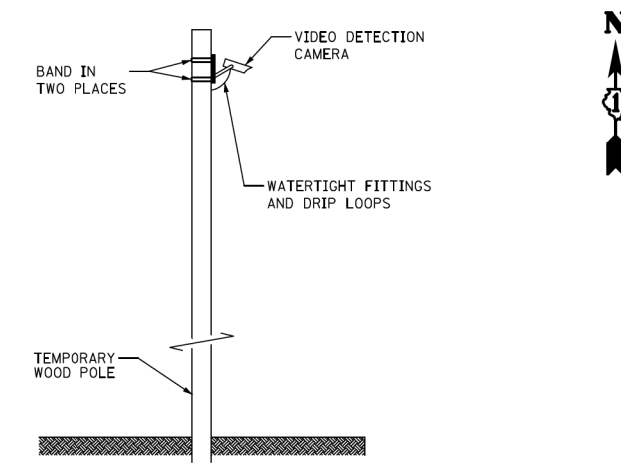

TEMPORARY VIDEO DETECTION DETAIL
(NOT TO SCALE)

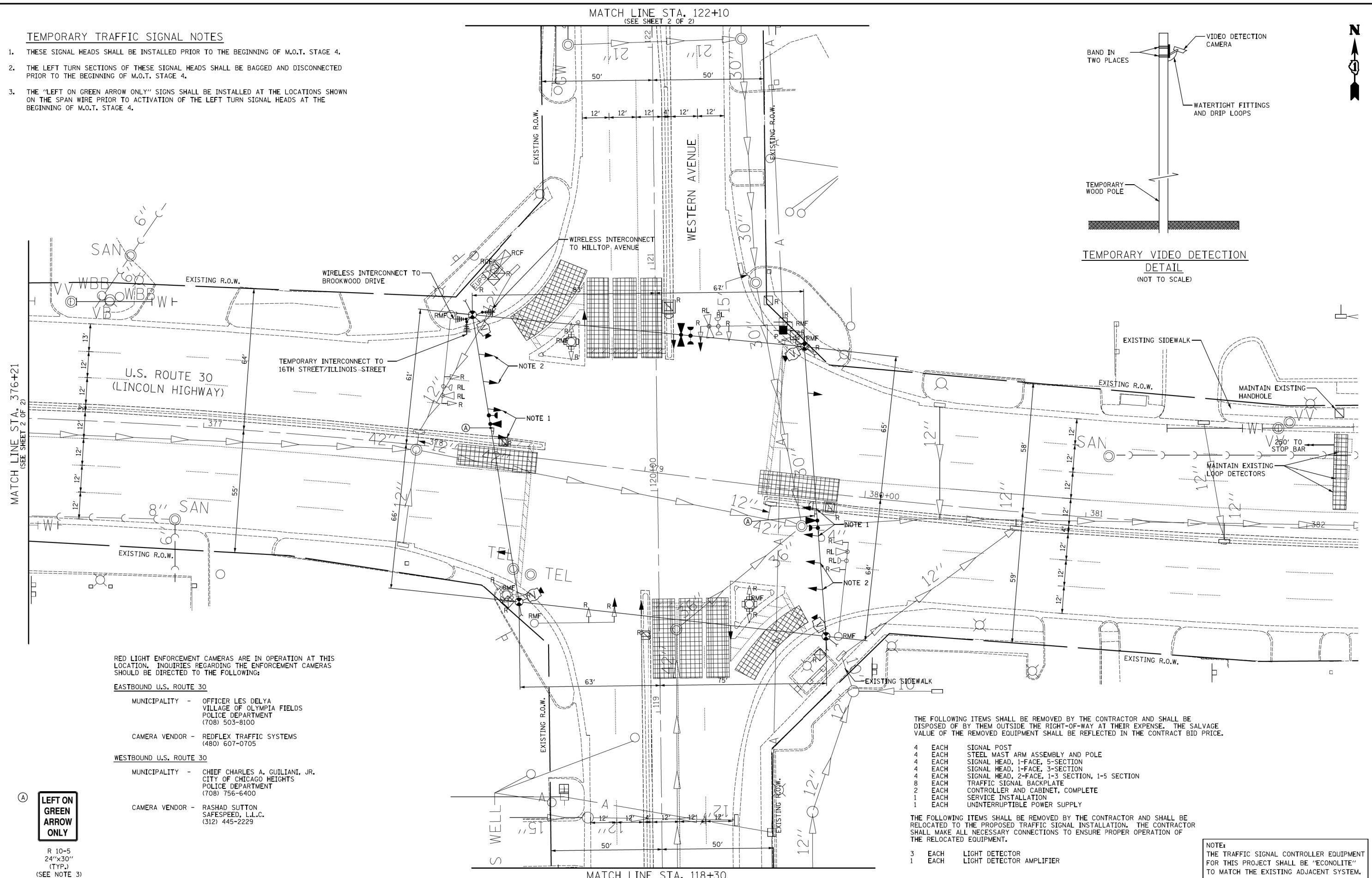

RED LIGHT ENFORCEMENT CAMERAS ARE IN OPERATION AT THIS LOCATION. INQUIRIES REGARDING THE ENFORCEMENT CAMERAS SHOULD BE DIRECTED TO THE FOLLOWING:

- EASTBOUND U.S. ROUTE 30**
- MUNICIPALITY - OFFICER LES DELYA VILLAGE OF OLYMPIA FIELDS POLICE DEPARTMENT (708) 503-8100
 - CAMERA VENDOR - REDFLEX TRAFFIC SYSTEMS (480) 607-0705
- WESTBOUND U.S. ROUTE 30**
- MUNICIPALITY - CHIEF CHARLES A. GUILIANI, JR. CITY OF CHICAGO HEIGHTS POLICE DEPARTMENT (708) 756-6400
 - CAMERA VENDOR - RASHAD SUTTON SAFESPEED, L.L.C. (312) 445-2229

LEFT ON GREEN ARROW ONLY

R 10-5
24"x30"
(TYP.)
(SEE NOTE 3)

THE FOLLOWING ITEMS SHALL BE REMOVED BY THE CONTRACTOR AND SHALL BE DISPOSED OF BY THEM OUTSIDE THE RIGHT-OF-WAY AT THEIR EXPENSE. THE SALVAGE VALUE OF THE REMOVED EQUIPMENT SHALL BE REFLECTED IN THE CONTRACT BID PRICE.

- 4 EACH SIGNAL POST
- 4 EACH STEEL MAST ARM ASSEMBLY AND POLE
- 4 EACH SIGNAL HEAD, 1-FACE, 5-SECTION
- 4 EACH SIGNAL HEAD, 1-FACE, 3-SECTION
- 4 EACH SIGNAL HEAD, 2-FACE, 1-3 SECTION, 1-5 SECTION
- 8 EACH TRAFFIC SIGNAL BACKPLATE
- 2 EACH CONTROLLER AND CABINET, COMPLETE
- 1 EACH SERVICE INSTALLATION
- 1 EACH UNINTERRUPTIBLE POWER SUPPLY

THE FOLLOWING ITEMS SHALL BE REMOVED BY THE CONTRACTOR AND SHALL BE RELOCATED TO THE PROPOSED TRAFFIC SIGNAL INSTALLATION. THE CONTRACTOR SHALL MAKE ALL NECESSARY CONNECTIONS TO ENSURE PROPER OPERATION OF THE RELOCATED EQUIPMENT.

- 3 EACH LIGHT DETECTOR
- 1 EACH LIGHT DETECTOR AMPLIFIER

NOTE:
THE TRAFFIC SIGNAL CONTROLLER EQUIPMENT FOR THIS PROJECT SHALL BE 'ECONOLITE' TO MATCH THE EXISTING ADJACENT SYSTEM.



USER NAME = jje	DESIGNED - BRD	REVISED -
	DRAWN - JRT	REVISED -
PLOT SCALE = 20.0000' / in.	CHECKED - JJE	REVISED -
PLOT DATE = 9/30/2013	DATE - 09/27/2013	REVISED -

**STATE OF ILLINOIS
DEPARTMENT OF TRANSPORTATION**

**TEMPORARY TRAFFIC SIGNAL INSTALLATION PLAN AND REMOVAL PLAN
U.S. ROUTE 30 (LINCOLN HWY.) & WESTERN AVENUE**

SCALE: 1" = 20' SHEET NO. 1 OF 2 SHEETS STA. TO STA.

F.A.P. RTE. 0353	SECTION 23N-2	COUNTY COOK	TOTAL SHEETS 75	SHEET NO. 37
CONTRACT NO. 60T19				
ILLINOIS FED. AID PROJECT				