

**LEGEND**

- ◉ DUAL ENTRY PHASE
- ◻ SINGLE ENTRY PHASE
- ◊ O.L. OVERLAP
- ◉ PEDESTRIAN PHASE
- NUMBER REFERS TO ASSOCIATED PHASE

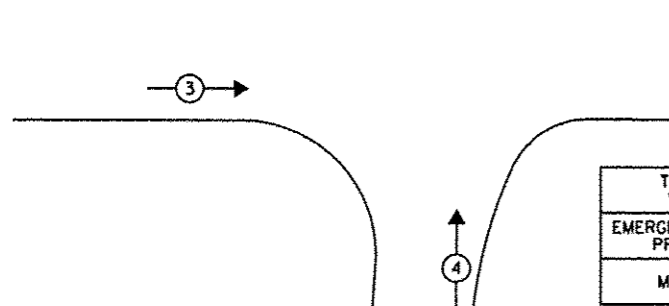
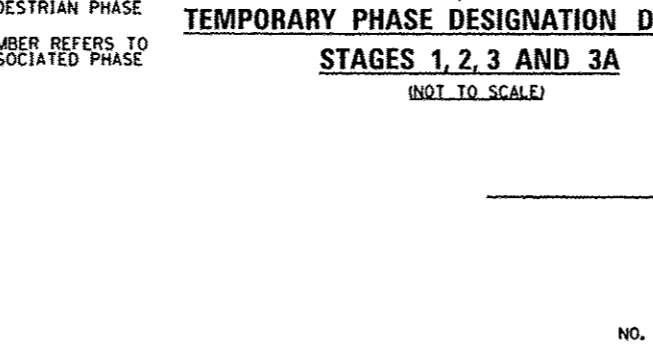
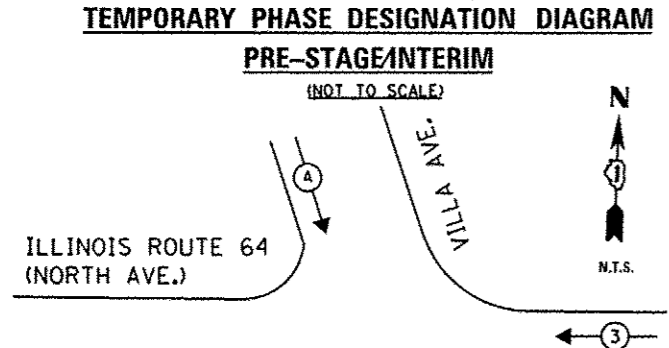

TEMPORARY EMERGENCY VEHICLE PREEMPTORS		
EMERGENCY VEHICLE PREEMPTOR	3	4
MOVEMENT	↔	↕

**TEMPORARY EMERGENCY VEHICLE PREEMPTION SEQUENCE**  
(NOT TO SCALE)

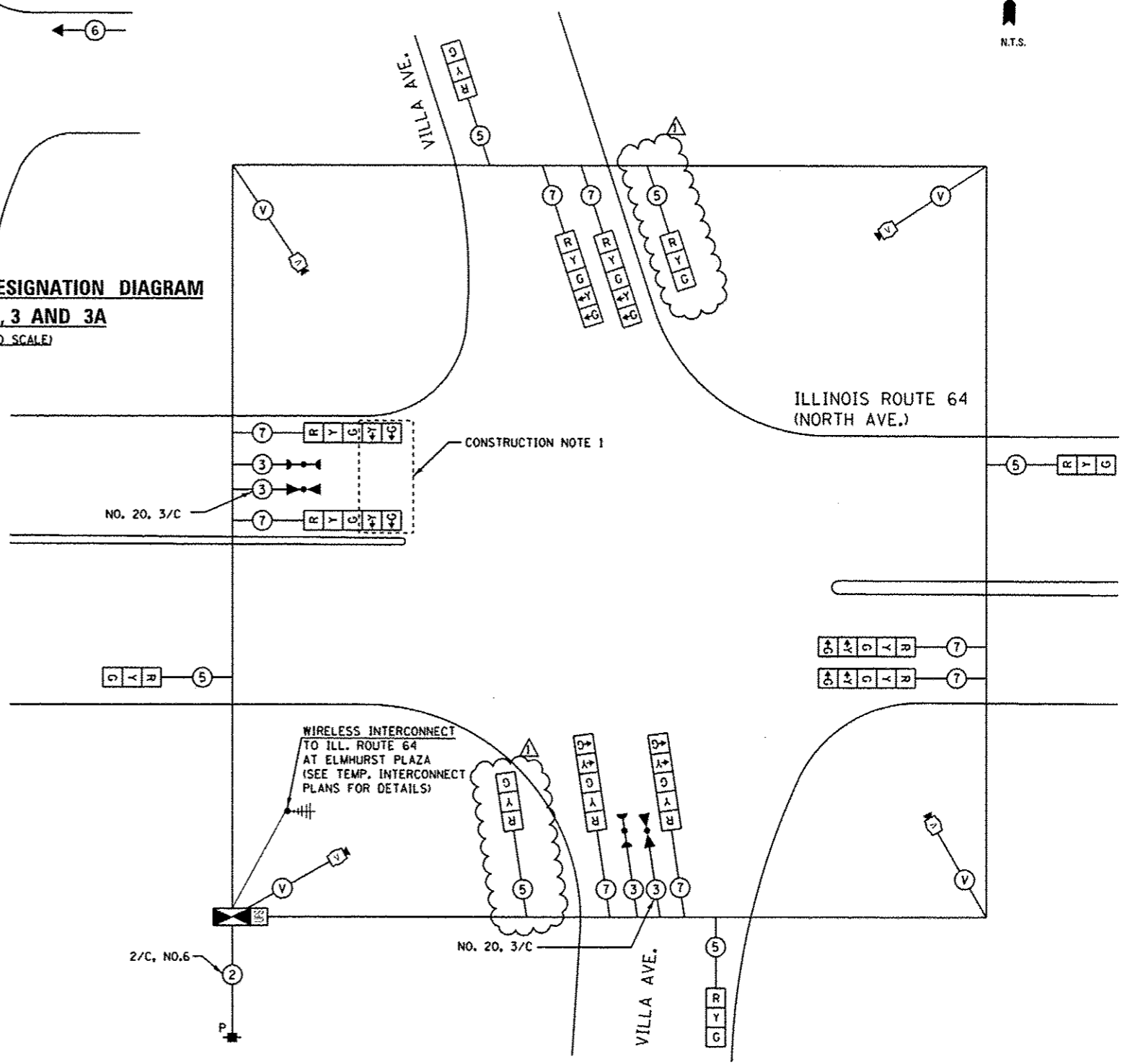

WIRELESS INTERCONNECT TO ILL. ROUTE 64 AT ELMHURST PLAZA (SEE TEMP. INTERCONNECT PLANS FOR DETAILS)

CONSTRUCTION NOTE 1

**CABLE PLAN**  
(NOT TO SCALE)

THE TRAFFIC SIGNAL CONTROL EQUIPMENT FOR THIS PROJECT SHALL BE "EAGLE" TO MATCH THE EXISTING ADJACENT SYSTEM.

I.D.O.T. TRAFFIC SIGNAL INSTALLATION ELECTRICAL SERVICE REQUIREMENTS					TOTAL WATTAGE
TYPE	NO LAMPS	WATTAGE	%OPERATION		
SIGNAL (RED)	14	17	0.50		119.00
(YELLOW)	14	25	0.25		87.50
(GREEN)	14	15	0.25		52.50
ARROW	16	12	0.10		19.20
PED. SIGNAL		25	1.00		
CONTROLLER	1	100	1.00		100.00
ILLUM. SIGN		25	0.05		
VIDEO SYSTEM	1	150	1.00		150.00
FLASHER			0.50		
ENERGY COSTS TO:				TOTAL =	528.20

ILLINOIS DEPARTMENT OF TRANSPORTATION  
201 WEST CENTER COURT  
SCHAMBURG, ILLINOIS 60196-1096  
ENERGY SUPPLY CONTACT: DEB RANKIN  
PHONE: (630) 691-4379  
COMPANY: COMMONWEALTH EDISON

**CONSTRUCTION NOTES:**

- THE YELLOW ARROW AND GREEN ARROW INDICATION ON THE 5-SECTION SIGNAL HEAD FOR THE WESTBOUND DIRECTION SHALL BE USED ONLY DURING PRE-CONSTRUCTION AND INTERIM STAGES AND SHALL BE BAGGED AND DISCONNECTED AT THE CONTROLLER DURING CONSTRUCTION STAGES 1, 2, 3 AND 3A.

**SINGH**  
SINGH & ASSOCIATES INC.  
CONSULTING ENGINEERS

USER NAME	mgarvide	DESIGNED	MG	REVISED	ADDENDUM 1 01/08/14
PLOT SCALE	1/8"=1'-0"	DRAWN	MG	REVISED	-
PLOT DATE	08-JAN-2014 15:54	CHECKED	KGP	REVISED	-
		DATE	10/25/2013	REVISED	-

STATE OF ILLINOIS  
DEPARTMENT OF TRANSPORTATION

TEMPORARY CABLE PLAN, TEMPORARY PHASE DESIGNATION DIAGRAM,  
AND TEMPORARY EMERGENCY VEHICLE PREEMPTION SEQUENCE OF OPERATION  
ILLINOIS ROUTE 64 (NORTH AVENUE) AT VILLA AVENUE  
SCALE: AS NOTED SHEET NO. 11 OF 26 SHEETS STA. TO STA.

F.A.P. RTE.	SECTION	COUNTY	TOTAL SHEETS	SHEET NO.
307	131B-BR	DUPAGE	111	54
CONTRACT NO. 60V24			ILLINOIS FED. AID PROJECT	

J:\3003\DRGN\CADD Sheets\1571-sh1-1s-13.dgn 08-JAN-2014 15:54 TIME \$