

EXISTING LIGHTING REMOVAL

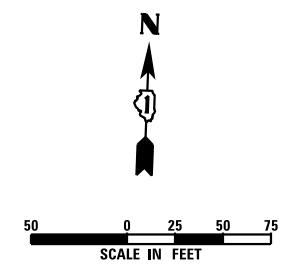
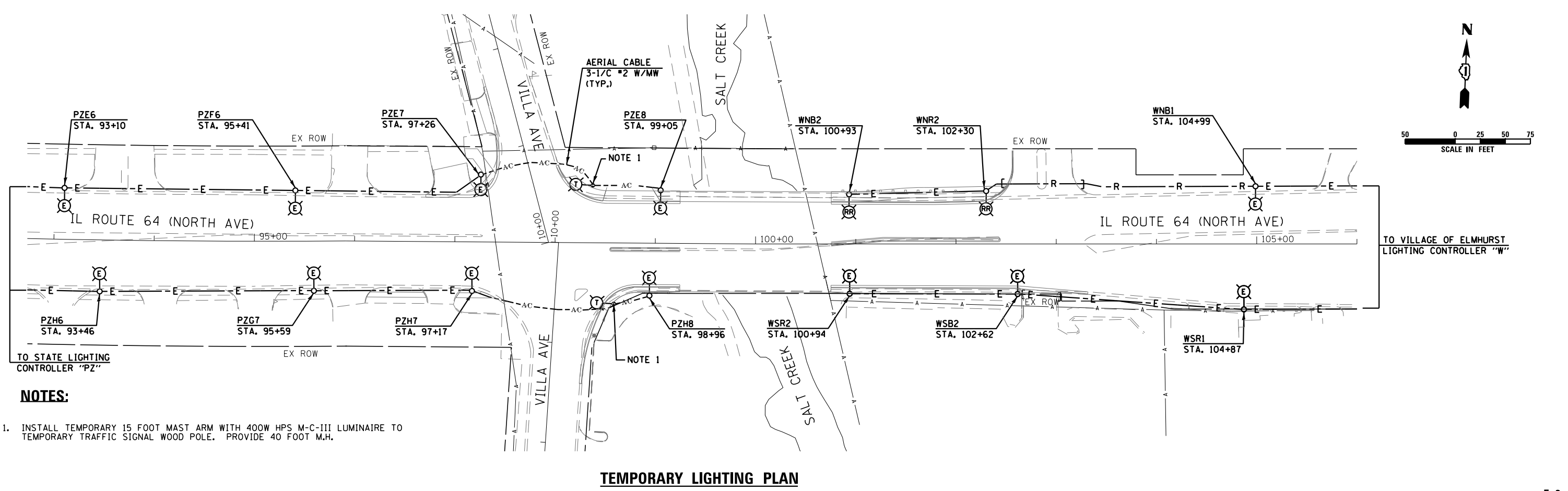

TEMPORARY LIGHTING PLAN

NOTES:

1. INSTALL TEMPORARY 15 FOOT MAST ARM WITH 400W HPS M-C-III LUMINAIRE TO TEMPORARY TRAFFIC SIGNAL WOOD POLE. PROVIDE 40 FOOT M.H.

I:\3003\DCN\CADD_Sheets\131B-shr-light-02.dgn
 24-OCT-2013 13:08:15
 SINGH & ASSOCIATES, INC. CONSULTING ENGINEERS



USER NAME = mgravida	DESIGNED - MK	REVISED -
PLOT SCALE = 100.000000:1.000000	DRAWN - MK	REVISED -
PLOT DATE = 24-OCT-2013 13:06	CHECKED - KGP	REVISED -
	DATE - 10/25/2013	REVISED -

STATE OF ILLINOIS
DEPARTMENT OF TRANSPORTATION

EXISTING LIGHTING REMOVAL AND TEMPORARY LIGHTING PLAN
ILLINOIS ROUTE 64 (VILLA AVE. TO ILLINOIS ROUTE 83)
SCALE: 1" = 50' SHEET NO. 2 OF 8 SHEETS STA. TO STA.

F.A.P. RTE. 307	SECTION 131B-BR	COUNTY DUPAGE	TOTAL SHEETS 111	SHEET NO. 37
ILLINOIS FED. AID PROJECT			CONTRACT NO. 60V24	