

**SIGNAL HEAD PLACEMENT FOR STAGE 1**

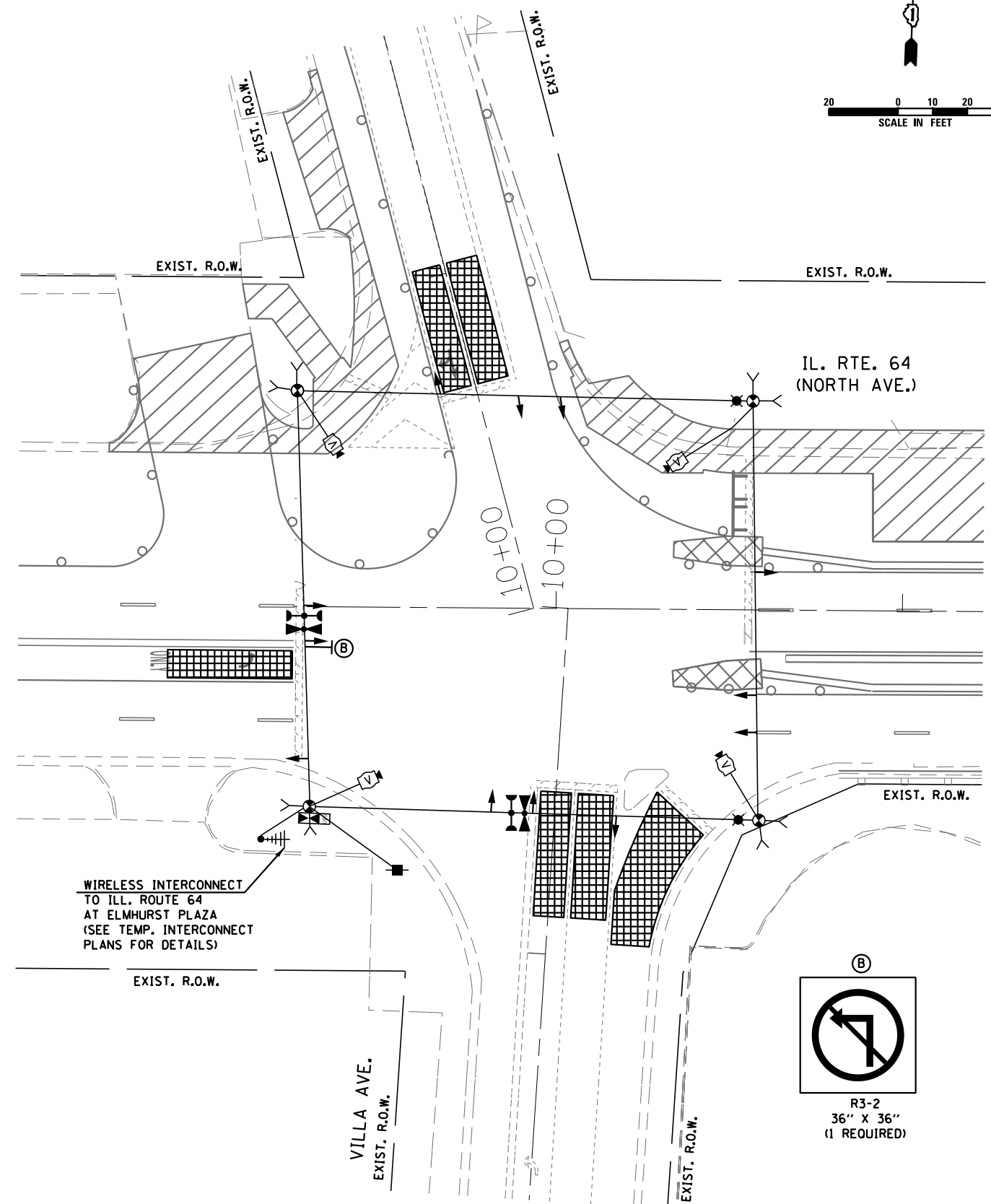

**SIGNAL HEAD PLACEMENT FOR STAGE 2**

THE TRAFFIC SIGNAL CONTROL EQUIPMENT FOR THIS PROJECT SHALL BE "EAGLE" TO MATCH THE EXISTING ADJACENT SYSTEM.

I:\3003\CD\CONV\CADD\_Sheets\15171-sht1-rs-ll.dgn 24-OCT-2013 09:17:51



USER NAME = mgravida  
 PLOT SCALE = 48.000000:1.000000  
 PLOT DATE = 24-OCT-2013 14:17

DESIGNED - MG  
 DRAWN - MG  
 CHECKED - KGP  
 DATE - 10/25/2013

REVISED -  
 REVISED -  
 REVISED -  
 REVISED -

STATE OF ILLINOIS  
 DEPARTMENT OF TRANSPORTATION

TEMPORARY TRAFFIC SIGNAL INSTALLATION PLAN  
 ILLINOIS ROUTE 64 (NORTH AVENUE) AT VILLA AVENUE  
 STAGE 1 AND STAGE 2  
 SCALE: AS NOTED SHEET NO. 9 OF 26 SHEETS STA. TO STA.

F.A.P. RTE.	SECTION	COUNTY	TOTAL SHEETS	SHEET NO.
307	131B-BR	DUPAGE	111	52
CONTRACT NO. 60V24				
ILLINOIS FED. AID PROJECT				