

SIGNAL HEAD PLACEMENT FOR STAGE 3

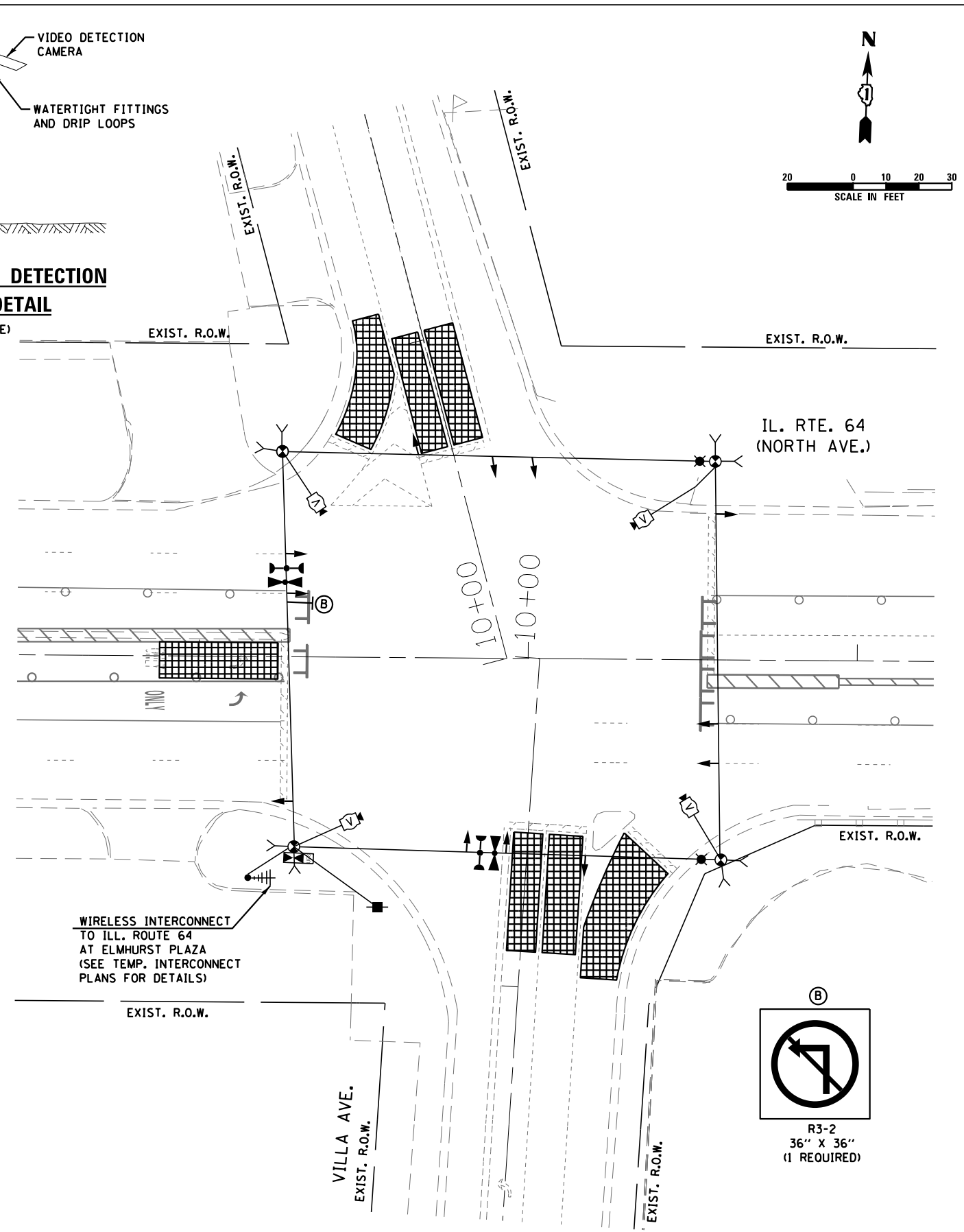

SIGNAL HEAD PLACEMENT FOR STAGE 3A

THE TRAFFIC SIGNAL CONTROL EQUIPMENT FOR THIS PROJECT SHALL BE "EAGLE" TO MATCH THE EXISTING ADJACENT SYSTEM.

I:\3000\CD\3000\CADD_Sheets\15171-sht-1s-12.dgn
 24-OCT-2013 09:17:58



USER NAME = mgravida	DESIGNED - MG	REVISED -
PLOT SCALE = 40.000000:1.000000	DRAWN - MG	REVISED -
PLOT DATE = 24-OCT-2013 14:17	CHECKED - KGP	REVISED -
	DATE - 10/25/2013	REVISED -

STATE OF ILLINOIS
DEPARTMENT OF TRANSPORTATION

TEMPORARY TRAFFIC SIGNAL INSTALLATION PLAN
ILLINOIS ROUTE 64 (NORTH AVENUE) AT VILLA AVENUE
STAGE 3 AND STAGE 3A
SCALE: AS NOTED SHEET NO. 10 OF 26 SHEETS STA. TO STA.

F.A.P. RTE. 307	SECTION 131B-BR	COUNTY DUPAGE	TOTAL SHEETS 111	SHEET NO. 53
ILLINOIS FED. AID PROJECT			CONTRACT NO. 60V24	