

PLAN AT CATCH BASIN

Cut longitudinal and transverse reinforcement to clear catch basins. Refer to Standard 420III-03 for additional details. See Civil Plans for drainage details.

Notes:
 See sheet S17 of S26 for Sections C-C & D-D.
 a(E), a2(E), a4(E), a10(E), a11(E), and a12(E) bar spacings measured along \bar{C} Rdwy.
 The joint opening shall be determined per Article 520.04.
 The minimum dimension shall be 1/2" for installation purposes.
 Bars indicated thus 1 x 2-#4 etc. indicates 1 line of bars with 2 lengths per line.
 See sheet S21 of S26 for Bicycle Railing details.

MINIMUM BAR LAP

#5 bar = 2'-7"

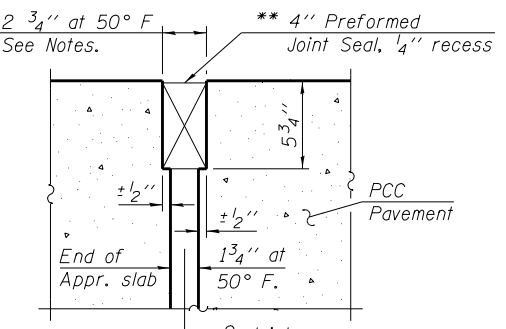

RIGID PAVEMENT

DETAIL A

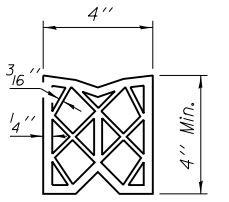

PREFORMED JOINT SEAL

** Cost included with Concrete Superstructure.

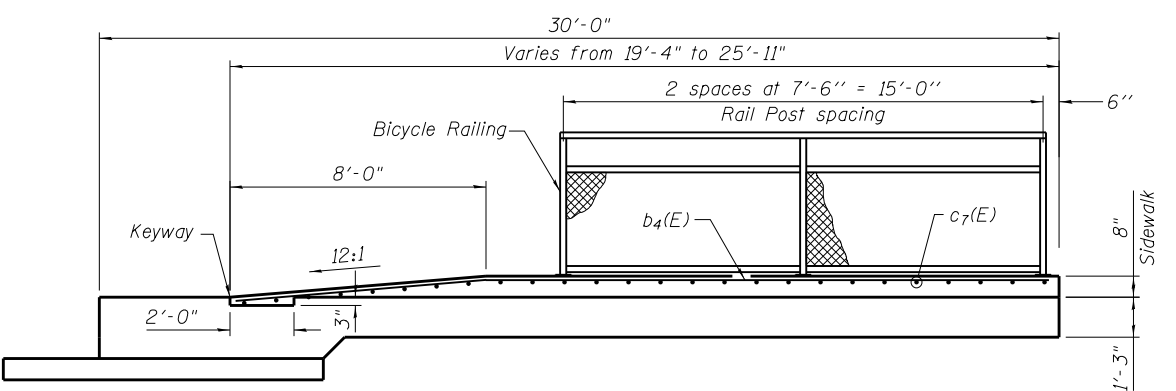

VIEW B-B

* Tilt #10 b3(E) bars as required to maintain clearance.

(Sheet 1 of 2)

COLLINS ENGINEERS
 133 N. Wacker Dr.
 Suite 900
 Chicago, IL 60606
 Tel: (312) 704-9300
 Fax: (312) 704-9320
 www.collinsengr.com
 ILLINOIS PROFESSIONAL DESIGN FIRM LICENSE NO. 184-000993

USER NAME =	DESIGNED - LJ	REVISOR
	CHECKED - EKM	REVISION
PLOT SCALE =	DRAWN - PRH	REVISION
PLOT DATE =	CHECKED - LJ	REVISION

STATE OF ILLINOIS
DEPARTMENT OF TRANSPORTATION

WEST BRIDGE APPROACH SLAB DETAILS
STRUCTURE NO. 022-0158

SHEET NO. S16 OF S26 SHEETS

F.A.P. RTE.	SECTION	COUNTY	TOTAL SHEETS	SHEET NO.
307	131B-BR	DuPAGE	111	85
CONTRACT NO. 60V24			ILLINOIS FED. AID PROJECT	