

NOTES
 1. TEMPORARY TRAFFIC CONTROL PAVEMENT MARKINGS SHALL MATCH TO THE CURRENT STAGE OF TRAFFIC CONTROL FOR CONTRACT NUMBER 60W26. FURTHER COORDINATION OF TEMP. MARKINGS AND DEVICES ALONG EASTBOUND AND WESTBOUND I-290 WILL BE REQUIRED.

LEGEND

- WORK ZONE
- TEMPORARY IMPACT ATTENUATOR
- DIRECTION OF TRAFFIC FLOW
- ARROW BOARD
- TYPE III BARRICADE
- TYPE II BARRICADE OR DRUM WITH FLASHING LIGHT

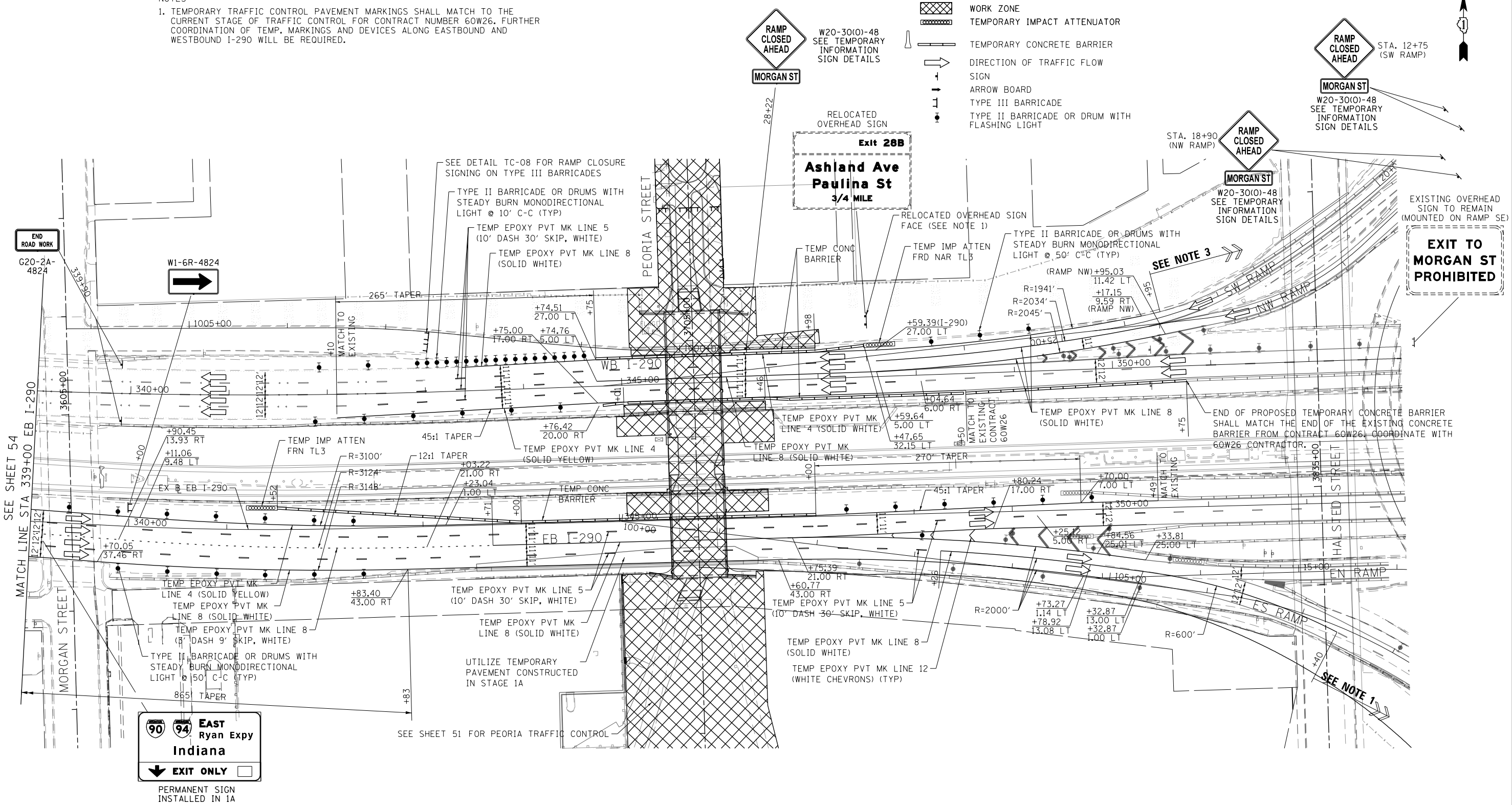
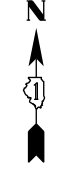

FILE PATH = p:\388035\pmt\lsc\com\lme\local\p\wec\000\Documents\01_Americas\Transportation\60269938_Circle\Phase 1\1000_CAD\005_Roadway\Sheets\60W26_Sht-3.dgn



D:\60W29-Sht-Staging-23.dgn	DESIGNED - JDT	REVISED -
USER NAME = BAWtor1	DRAWN - JTR	REVISED -
PLOT SCALE = 100.0000' / in.	CHECKED - JMG	REVISED -
PLOT DATE = 10/28/2013	DATE - 10/30/2013	REVISED -

**STATE OF ILLINOIS
 DEPARTMENT OF TRANSPORTATION**

**SUGGESTED STAGES OF CONSTRUCTION AND TRAFFIC CONTROL PLAN
 I-290 STAGE 1B**

SCALE: 1"=50' SHEET 3 OF 3 SHEETS STA. 339+00 TO STA. 353+00

F.A.I. RTE.	SECTION	COUNTY	TOTAL SHEETS	SHEET NO.
90/94/290	2013-011R	COOK	356	56
CONTRACT NO. 60W29			ILLINOIS FED. AID PROJECT	