

S. APPR. WEST CURB LINE

Location	Station	Offset	Theoretical Grade Elevations
S. End South Appr. Slab	3702+38.64	-22.49	596.25
AI	3702+48.64	-17.70	596.52
N. End South Appr. Slab	3702+58.64	-12.91	596.85

S. APPR. PGL & C ROADWAY

Location	Station	Offset	Theoretical Grade Elevations
S. End South Appr. Slab	3702+38.64	0.00	596.57
AI	3702+48.64	0.00	596.81
N. End South Appr. Slab	3702+58.64	0.00	597.04

S. APPR. EAST CURB LINE

Location	Station	Offset	Theoretical Grade Elevations
S. End South Appr. Slab	3702+38.64	-0.94	596.62
AI	3702+48.64	3.08	596.80
N. End South Appr. Slab	3702+58.64	7.09	596.93

S. APPR. CROWN

Location	Station	Offset	Theoretical Grade Elevations
S. End South Appr. Slab	3702+38.64	-0.94	596.62
AI	3702+48.64	-0.47	596.83
N. End South Appr. Slab	3702+58.64	0.00	597.04

N. APPR. WEST CURB LINE

Location	Station	Offset	Theoretical Grade Elevations
S. End North Appr. Slab	3705+29.73	-13.00	597.96
A2	3705+39.73	-13.00	597.64
N. End North Appr. Slab	3705+49.73	-13.00	597.31

N. APPR. CROWN

Location	Station	Offset	Theoretical Grade Elevations
S. End North Appr. Slab	3705+29.73	0.00	598.16
A2	3705+39.73	-2.50	597.80
N. End North Appr. Slab	3705+49.73	-5.00	597.43

N. APPR. PGL & C ROADWAY

Location	Station	Offset	Theoretical Grade Elevations
S. End North Appr. Slab	3705+29.73	0.00	598.16
A2	3705+39.73	0.00	597.76
N. End North Appr. Slab	3705+49.73	0.00	597.35

N. APPR. EAST CURB LINE

Location	Station	Offset	Theoretical Grade Elevations
S. End North Appr. Slab	3705+29.73	9.46	598.02
A2	3705+39.73	8.21	597.64
N. End North Appr. Slab	3705+49.73	6.96	597.25

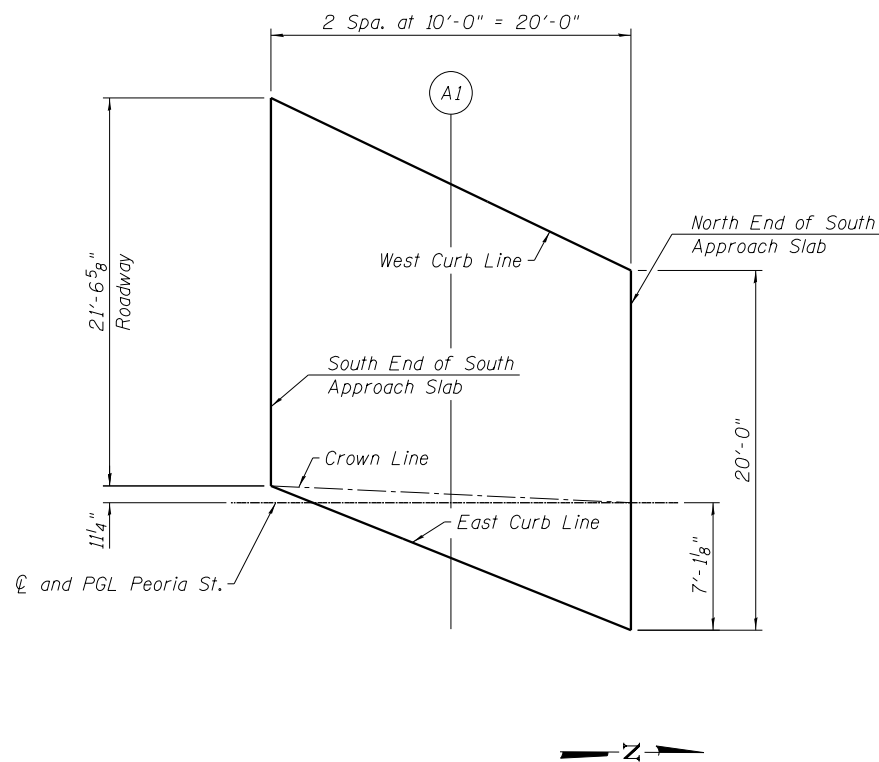

SOUTH APPROACH PLAN

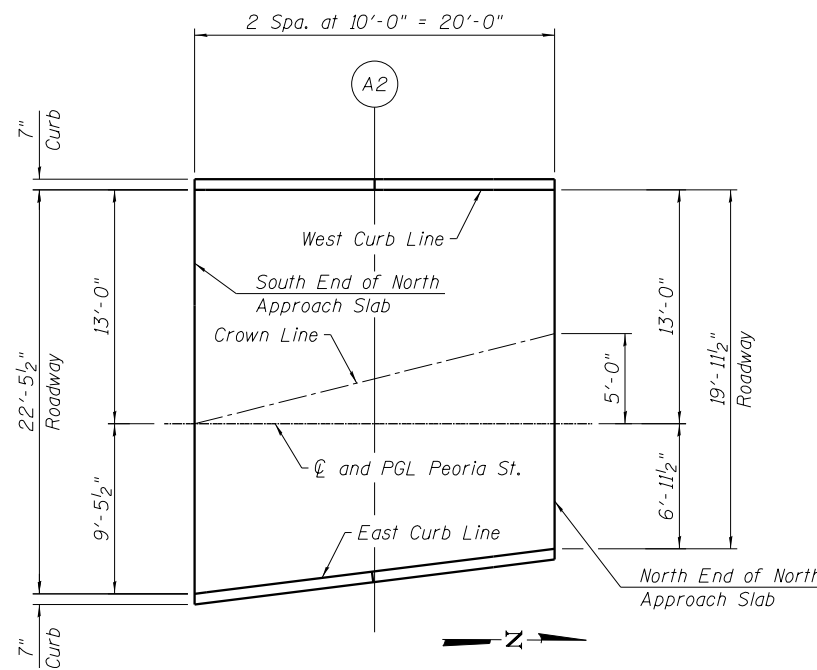

NORTH APPROACH PLAN

11:01:55 PM 01/17/08-60W29-5013-TopSlab-5.dgn



USER NAME = BAWIort	DESIGNED WJC	REVISED
	CHECKED DL	REVISED
PLOT SCALE = 10:8.0012 ' / in.	DRAWN WJC	REVISED
PLOT DATE = 10/28/2013	CHECKED DL	REVISED

**STATE OF ILLINOIS  
DEPARTMENT OF TRANSPORTATION**

**TOP OF APPROACH SLAB ELEVATIONS  
STRUCTURE NO. 016-1708**

SHEET NO. 13 OF 55 SHEETS

MUN	SECTION	COUNTY	TOTAL SHEETS	SHEET NO.
2090	2013-011R	COOK	356	145
CONTRACT NO.			60W29	
ILLINOIS FED. AID PROJECT				