

BOX CULVERT DETAILS
IL RTE 78
F.A.P. RTE 641 SECTION 104T-3
JO DAVIESS COUNTY
STA. 912 + 26
STR. NO. 043-1098

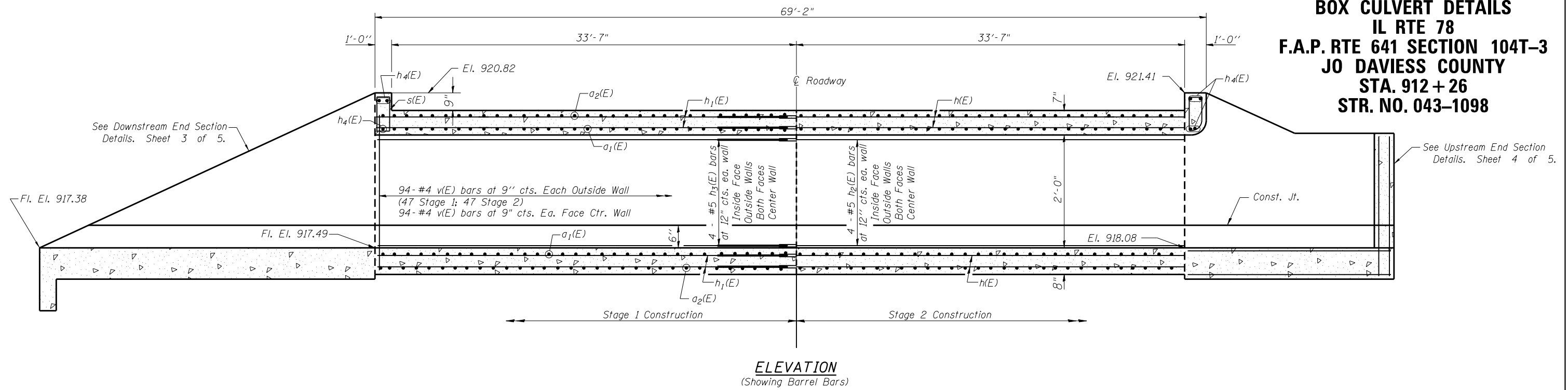

STAGE 1

STAGE 2

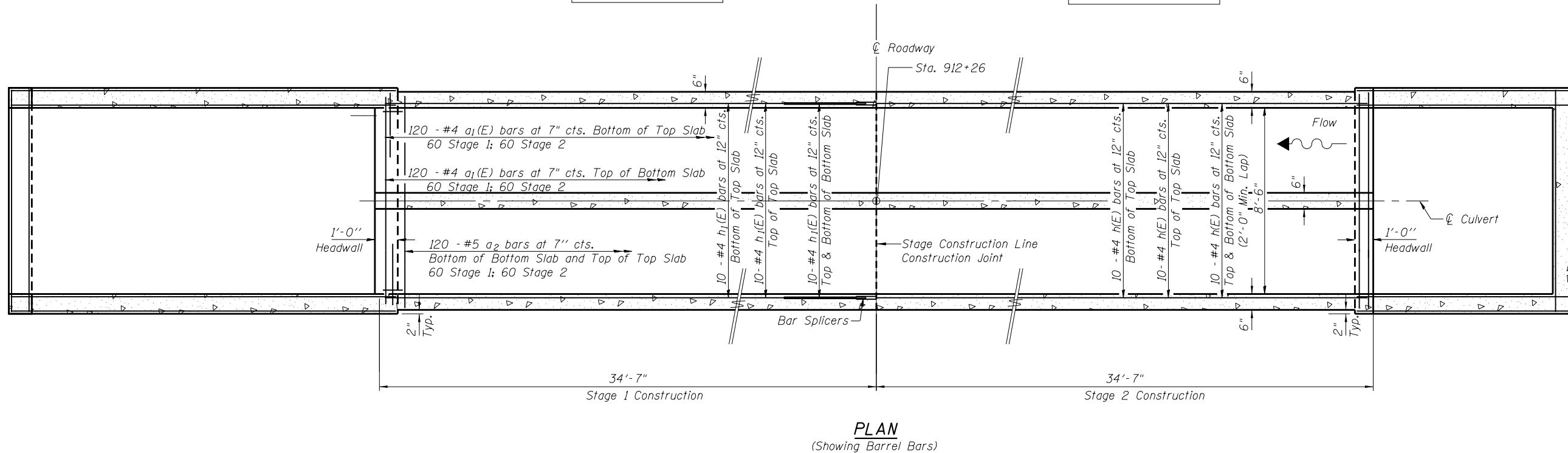

NOTES

Reinforcement bars shall conform to the requirements of ASTM A 706 Gr 60. See Special Provisions.
 Bars indicated thus 12 x 4-#5 etc. indicates 12 lines of bars with 4 lengths per line.
 Bars designated (E) shall be epoxy coated.

BAR LAP

#4 2'-0"
 #5 2'-6"



USER NAME = rundbladerr
 WES JOB # = 2130199
 PLOT SCALE = 10.0000' / in.
 PLOT DATE = Thu Oct 10 08:00:55 2013

DESIGNED - SB
 DRAWN - BEH
 CHECKED - DB
 DATE - 09/13/2013

REVISED -
 REVISED -
 REVISED -
 REVISED -

STATE OF ILLINOIS
DEPARTMENT OF TRANSPORTATION

BOX CULVERT DETAILS STA. 912 + 26
STRUCTURE NO. 043-1098

SHEET 2 OF 5 SHEETS STA. 912+26

F.A.P. RTE.	SECTION	COUNTY	TOTAL SHEETS	SHEET NO.
642	104T-3	JO DAVIESS	97	41
CONTRACT NO. 64F74				
ILLINOIS FED. AID PROJECT				