

PROP. CURVE CRV11360
 PI STA. = 140+80.16
 $\Delta = 61^\circ 58' 13''$ (RT)
 $D = 88^\circ 08' 50''$
 $R = 65.00'$
 $T = 39.03'$
 $L = 70.30'$
 $E = 10.82'$
 P.C. STA. = 140+41.13
 P.T. STA. = 141+11.43

PROP. CURVE CRV21360
 PI STA. = 141+71.33
 $\Delta = 31^\circ 28' 27''$ (LT)
 $D = 73^\circ 27' 22''$
 $R = 78.00'$
 $T = 21.98'$
 $L = 42.85'$
 $E = 3.04'$
 P.C. STA. = 141+49.35
 P.T. STA. = 141+92.20

PROP. CURVE CRV31360
 PI STA. = 142+62.28
 $\Delta = 35^\circ 18' 36''$ (RT)
 $D = 60^\circ 18' 41''$
 $R = 95.00'$
 $T = 30.24'$
 $L = 58.55'$
 $E = 4.70'$
 P.C. STA. = 142+32.04
 P.T. STA. = 142+90.59

BENCHMARK #212:
 RAILROAD SPIKE IN TELEPHONE POLE
 SOUTH SIDE OF IL. 17 NEAR HOUSE #4220
 STA. 1360+12.02, 48.41' RT.
 ELEV.= 652.20

BENCHMARK #213:
 CHISELED X ON TOP OF NORTH BOLT
 OF FIRE HYDRANT IN THE S.E. QUAD OF
 IL 17/ RAYMOND DR. (S4140W. RD.)
 STA. 1365+09.76, 65.40' RT.
 ELEV.= 641.08

BENCHMARK #214:
 RAILROAD SPIKE IN POWER POLE
 IN THE S.E. QUAD OF IL 17 / S4080W RD.
 STA. 1368+33.20, 49.00' RT.
 ELEV.= 636.14

BENCHMARK #215:
 CHISELED X ON TOP OF NORTH BOLT OF
 FIRE HYDRANT IN THE S.E. QUAD OF
 IL 17/S4000W RD.
 STA. 1372+68.62, 54.50' RT.
 ELEV.= 635.34

BENCHMARK #216:
 RAILROAD SPIKE IN TELEPHONE POLE
 SOUTH SIDE OF IL. 17
 STA. 1376+80.84, 46.90' RT.
 ELEV.= 634.15

BENCHMARK #217:
 CHISELED X ON TOP OF NORTH BOLT OF
 FIRE HYDRANT ON THE SOUTH SIDE OF IL. 17
 STA. 1382+15.35, 47.63' RT.
 ELEV.= 632.32

BENCHMARK #218:
 CHISELED X ON TOP OF NORTH BOLT OF FIRE HYDRANT
 ON THE SOUTH SIDE OF IL. 17 NEAR HOUSE #3718
 STA. 1387+12.81, 49.42' RT.
 ELEV.= 631.97

BENCHMARK #219:
 CHISELED X ON TOP OF NORTH BOLT OF FIRE HYDRANT
 SOUTH SIDE OF IL. 17 OPPOSITE OF N3290W (LYNN COURT)
 STA. 1394+16.23, 48.84' RT.
 ELEV.= 627.08

BENCHMARK #220:
 CHISELED SQUARE ON TOP OF S.W. HEADWALL
 OF BOX CULVERT
 STA. 1401+32.75, 23.06' RT.
 ELEV.= 623.09

BENCHMARK #221:
 RAILROAD SPIKE IN TELEPHONE POLE
 SOUTH SIDE OF IL. 17
 STA. 1406+64.24, 48.91' RT.
 ELEV.= 622.87

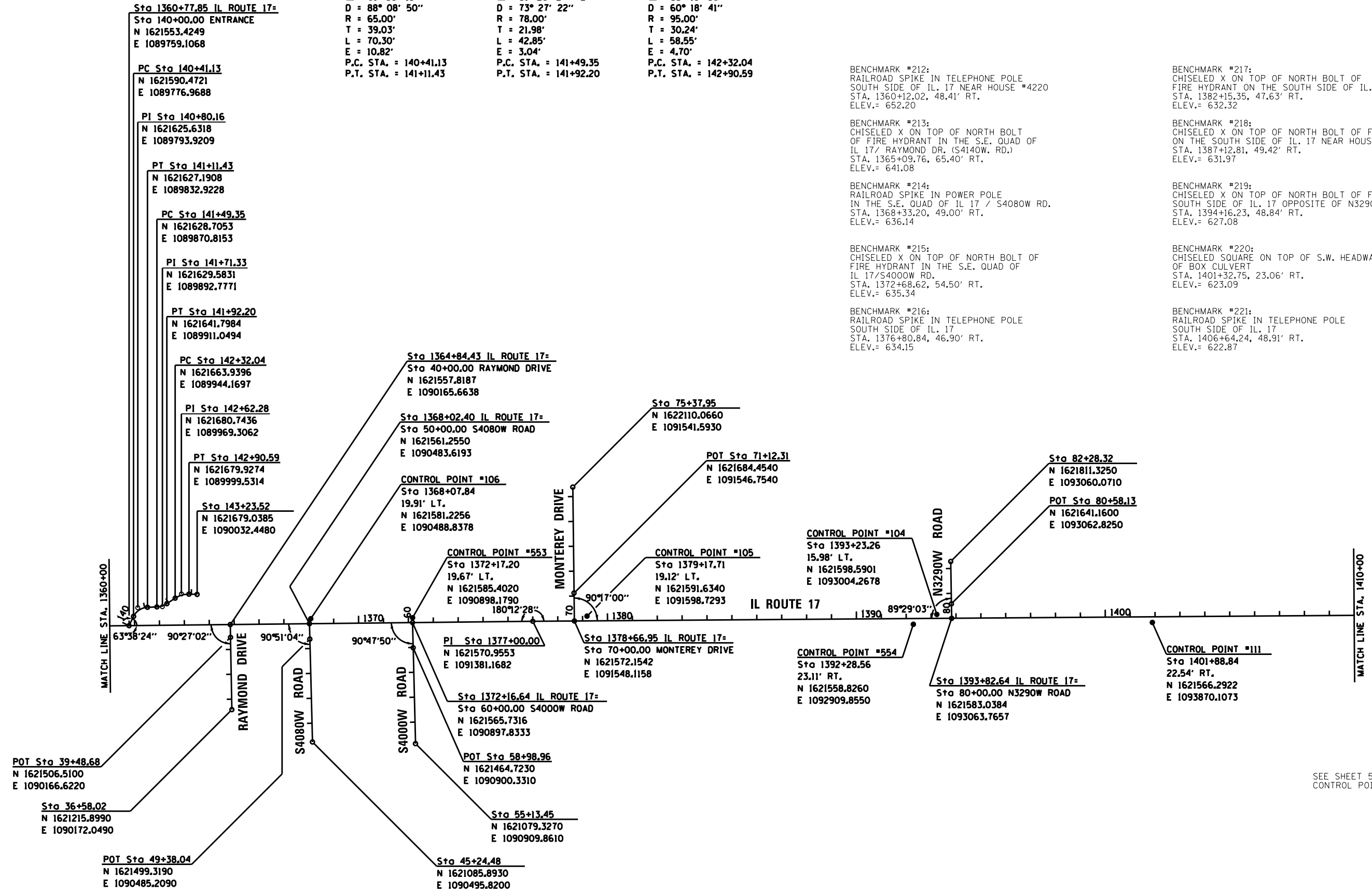

SEE SHEET 53 & 54 FOR
 CONTROL POINT TIES

FILE NAME = D366905-SHT-ALIGN-1360-1410.DGN	USER NAME = ---	DESIGNED - ---	REVISED - ---	STATE OF ILLINOIS DEPARTMENT OF TRANSPORTATION	IL ROUTE 17 ALIGNMENT, TIES, & BENCHMARKS			F.A.P. RTE.	SECTION	COUNTY	TOTAL SHEETS	SHEET NO.	
SHT_PLAN	PLOT SCALE = 1"=200'	CHECKED - JKC	REVISED - ---		SCALE: 1"=200'	SHEET	OF	SHEETS	41	(11)W&RS-1	KANKAKEE	450	50
	PLOT DATE = 07/13	DATE - 07/13	REVISED - ---		STA. 1360+00	TO STA. 1410+00	CONTRACT NO. 66905						
ILLINOIS FED. AID PROJECT													