

PLAN	SURVEYED	DATE
NOTE BOOK	CHAMLIN & ASSOCIATES	07/09
NO.	LAG	07/09
	JKC	07/09
	NY	07/09

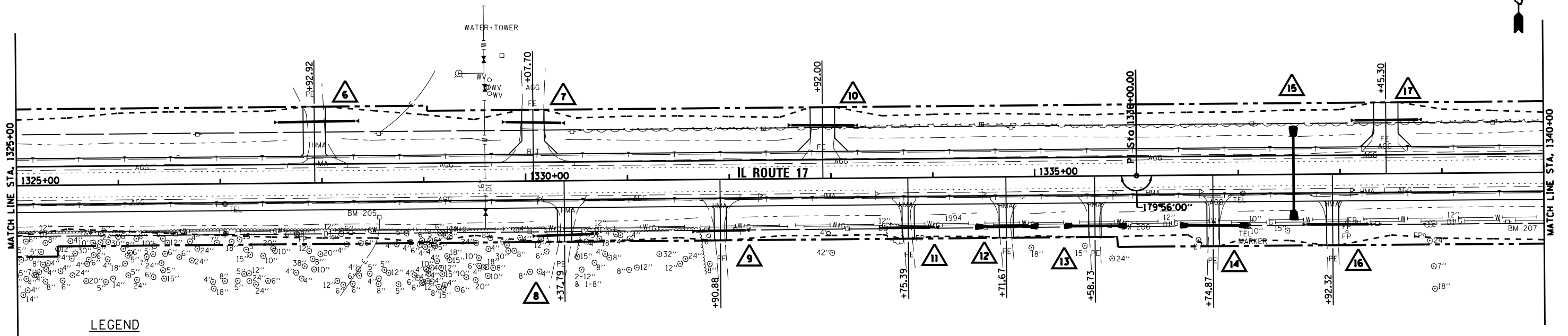

LEGEND

- STORM SEWER STRUCTURE NUMBER
- STORM SEWER PIPE NUMBER
- PIPE CULVERT NUMBER

SEE SCHEDULE OF QUANTITIES.

BENCHMARK #205:
RAILROAD SPIKE IN TELEPHONE POLE
SOUTH SIDE OF IL. 17
STA. 1328+56.01, 33.27' RT.
ELEV.= 654.74

BENCHMARK #206:
RAILROAD SPIKE IN TELEPHONE POLE
SOUTH SIDE OF IL. 17 NEAR HOUSE #4600
STA. 1335+73.24, 48.61' RT.
ELEV.= 653.61

BENCHMARK #207:
RAILROAD SPIKE IN TELEPHONE POLE
SOUTH SIDE OF IL. 17 NEAR HOUSE #4590
STA. 1339+63.95, 47.49' RT.
ELEV.= 653.04

PROFILE	SURVEYED	DATE
NOTE BOOK	CHAMLIN & ASSOCIATES	07/09
NO.	LAG	07/09
	JKC	07/09
	NY	07/09

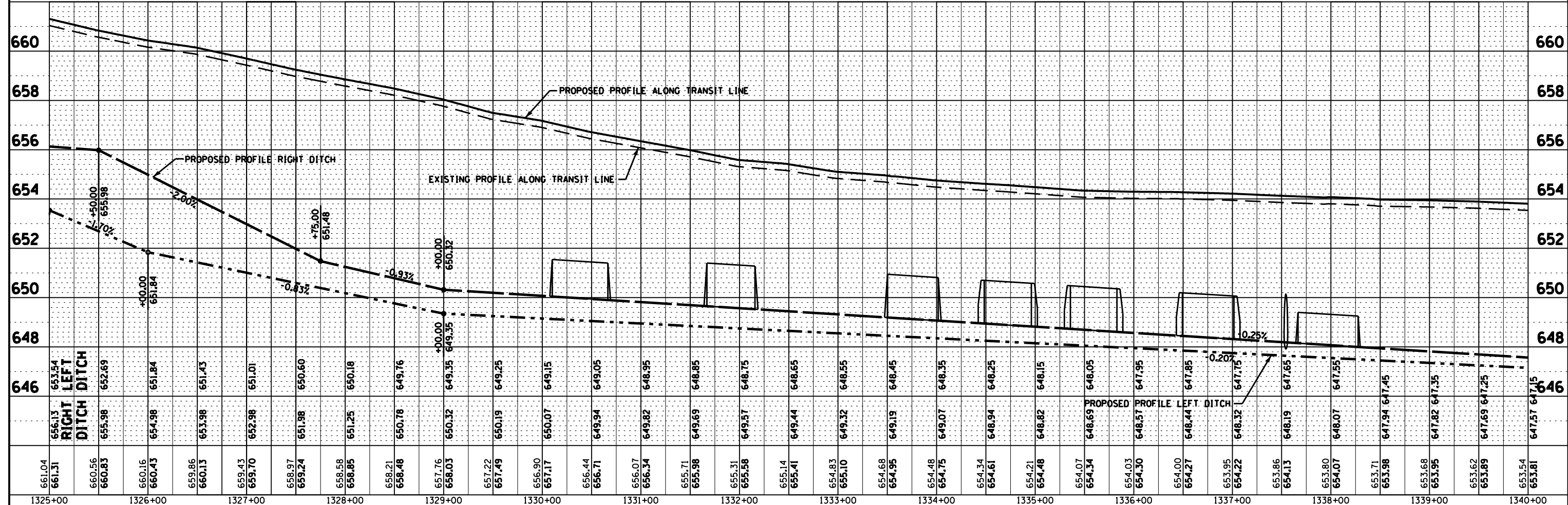

FILE NAME = D366905-SHT-PLNPRF-1325-1340.DGN	USER NAME = --	DESIGNED - JKC	REVISED -	STATE OF ILLINOIS DEPARTMENT OF TRANSPORTATION	PLAN & PROFILE - IL ROUTE 17				F.A.P. RT. 41	SECTION (I)W&S-1	COUNTY KANKAKEE	TOTAL SHEETS 450	SHEET NO. 68
PLOT SCALE = 1"=50'		DRAWN - LAG/NV	REVISED -		SCALE: 1"=50'	SHEET	OF	SHEETS	STA. 1325+00	TO STA. 1340+00	CONTRACT NO. 66905		
PLOT DATE = 07/13		CHECKED - JKC	REVISED -		ILLINOIS FED. AID PROJECT								
		DATE - 07/13	REVISED -										