

PLAN	SURVEYED	DATE
	PLOTTED	07/09
NOTE BOOK NO.	CHECKED	BY
	FILE NAME	0366905-1000.DGN

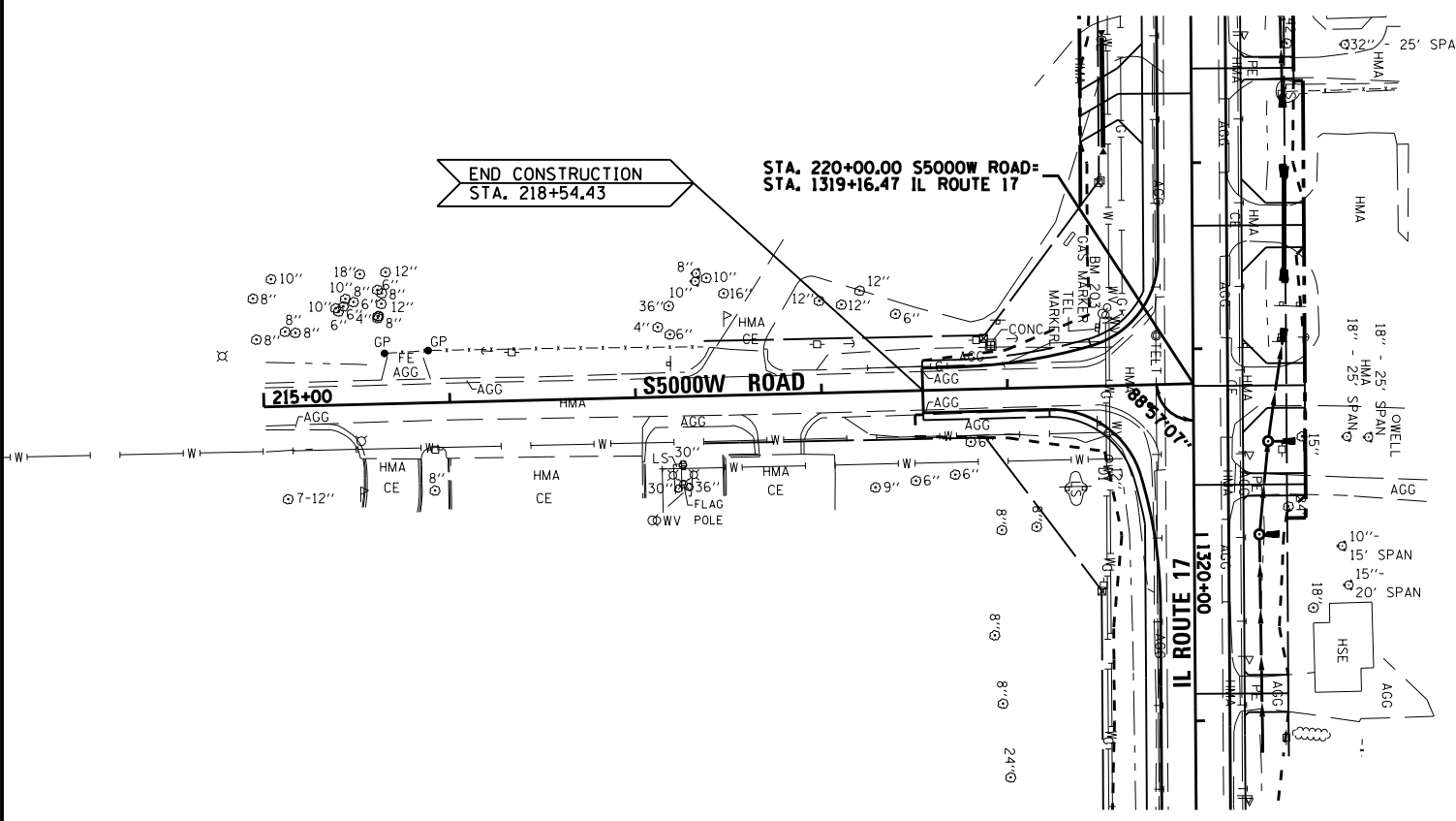

BENCHMARK #203:
 CHISELED X ON TOP N.E. BOLT OF FIRE HYDRANT
 IN THE S.W. QUAD OF IL. 17/S5000W RT. HEADING SOUTH
 STA. 1318+81.69, 48.47' RT.
 ELEV.= 661.87

FOR INTERSECTION
 DETAILS SEE SHEET 142

BENCHMARK #204:
 RAILROAD SPIKE IN TELEPHONE POLE
 SOUTH SIDE OF IL. 17
 STA. 1323+10.68, 48.50' RT.
 ELEV.= 665.25

PROFILE	SURVEYED	DATE
	PLOTTED	07/09
NOTE BOOK NO.	CHECKED	BY
	FILE NAME	0366905-1000.DGN

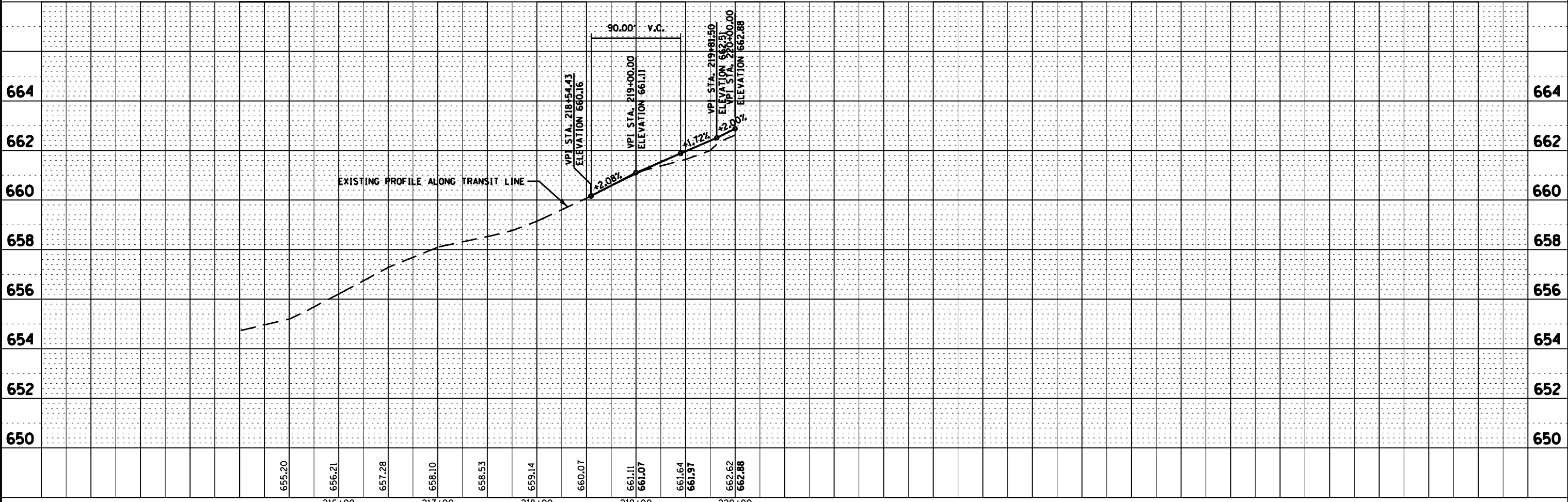

FILE NAME = D366905-SHT-PLNPRF-S5000.DGN	USER NAME = --	DESIGNED - JKC	REVISED -	STATE OF ILLINOIS DEPARTMENT OF TRANSPORTATION	PLAN & PROFILE - S5000W ROAD			F.A.P. RTE. 41	SECTION (I)W&RS-1	COUNTY KANKAKEE	TOTAL SHEETS 450	SHEET NO. 79
	PLOT SCALE = 1"=50'	DRAWN - LAG/NV	REVISED -		SCALE: 1"=50'	SHEET OF SHEETS	STA. 16+89.33 TO STA. 20+00	CONTRACT NO. 66905		ILLINOIS FED. AID PROJECT		
	PLOT DATE = 07/13	CHECKED - JKC	REVISED -									
		DATE - 07/13	REVISED -									