

PLAN	SURVEYED	DATE
NOTE BOOK NO.	LAG	07/09
	JKC	07/09
	NV	07/09
	FILE NAME	D:\66905\000.DGN

FOR INTERSECTION DETAILS SEE SHEET 143

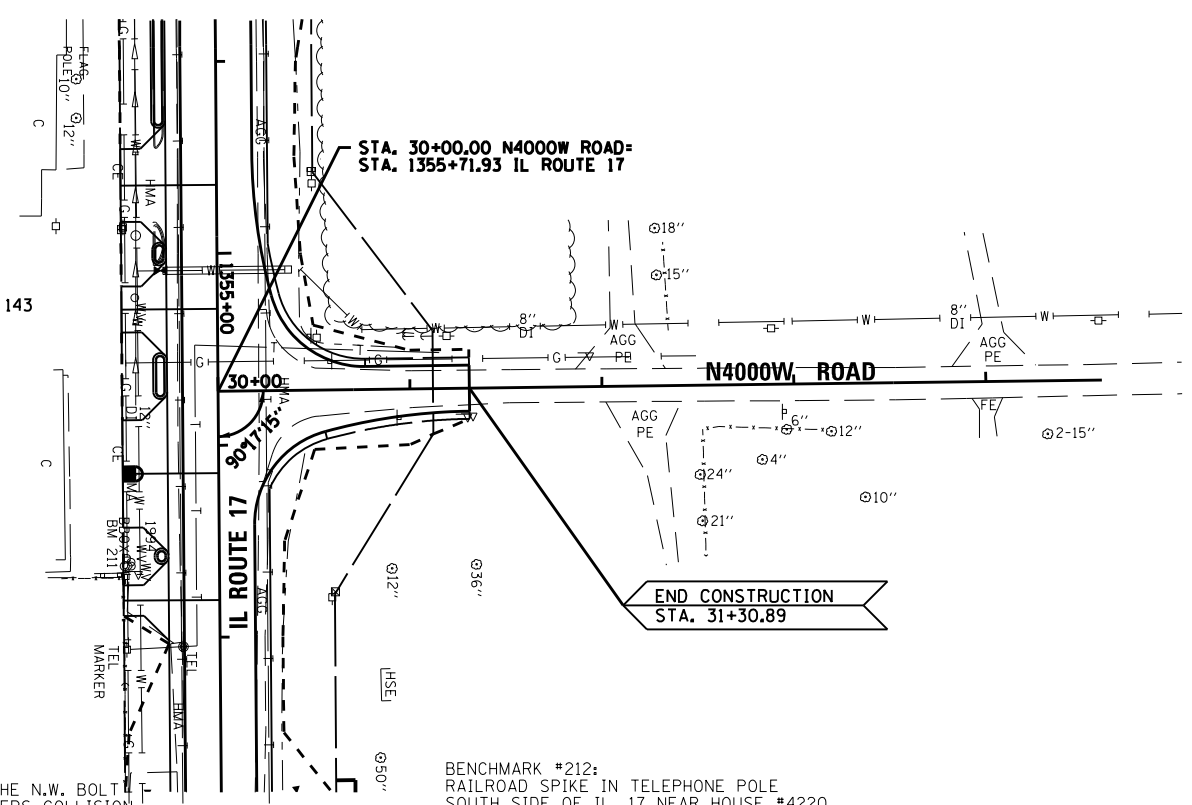

BENCHMARK #211:
CHISELED X ON TOP OF THE N.W. BOLT
OF FIRE HYDRANT @ TANNERS COLLISION
STA. 1356+62.42, 49.08' RT.
ELEV.= 655.52

BENCHMARK #212:
RAILROAD SPIKE IN TELEPHONE POLE
SOUTH SIDE OF IL. 17 NEAR HOUSE #4220
STA. 1360+12.02, 48.41' RT.
ELEV.= 652.20

PROFILE	SURVEYED	DATE
GRADES CHECKED	LAG	07/09
STRUCTURE NOTATIONS CHECKED	NV	07/09

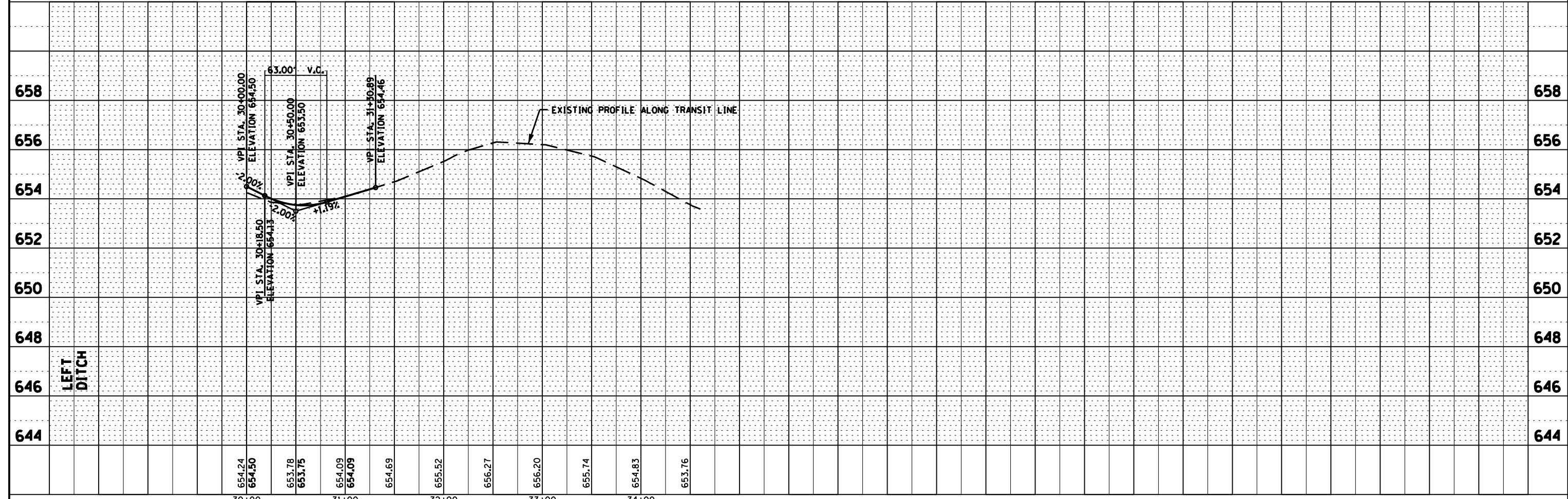

FILE NAME =	USER NAME =	DESIGNED -	REVISOR -	STATE OF ILLINOIS DEPARTMENT OF TRANSPORTATION	PLAN & PROFILE - N4000W ROAD SCALE: 1"=50' SHEET OF SHEETS STA. 30+00 TO STA. 34+60.46	F.A.P. RTE.	SECTION	COUNTY	TOTAL SHEETS	SHEET NO.
D366905-SHT-PLNPRF-N4000.DGN	--	DRAWN - LAG/NV	REVISOR -			41	(I)W&RS-1	KANKAKEE	450	80
PLOT SCALE = 1"=50'		CHECKED - JKC	REVISOR -			CONTRACT NO. 66905				
PLOT DATE = 07/13		DATE - 07/13	REVISOR -			ILLINOIS FED. AID PROJECT				