

BENCHMARK #213:  
CHISELED X ON TOP OF NORTH BOLT  
OF FIRE HYDRANT IN THE S.E. QUAD OF  
IL 17 / RAYMOND DR. (S4140W RD.)  
STA. 1365+09.76, 65.40' RT.  
ELEV.= 641.08

BENCHMARK #214:  
RAILROAD SPIKE IN POWER POLE  
IN THE S.E. QUAD OF IL 17 / S4080W RD.  
STA. 1368+33.20, 49.00' RT.  
ELEV.= 636.14

END CONSTRUCTION  
STA. 48+46.00

STA. 50+00.00 S4080W ROAD=  
STA. 1368+02.40 IL ROUTE 17

FOR INTERSECTION  
DETAILS SEE SHEET 144

PLAN	SURVEYED	DATE
NOTE BOOK	LAG	07/09
NO.	CHK	07/09
	BY	07/09
	CHAMLIN & ASSOCIATES	
	LAG	07/09
	CHK	07/09
	BY	07/09
	CHAMLIN & ASSOCIATES	
	LAG	07/09
	CHK	07/09
	BY	07/09
	CHAMLIN & ASSOCIATES	

PROFILE	SURVEYED	DATE
NOTE BOOK	LAG	07/09
NO.	CHK	07/09
	BY	07/09
	CHAMLIN & ASSOCIATES	
	LAG	07/09
	CHK	07/09
	BY	07/09
	CHAMLIN & ASSOCIATES	
	LAG	07/09
	CHK	07/09
	BY	07/09
	CHAMLIN & ASSOCIATES	

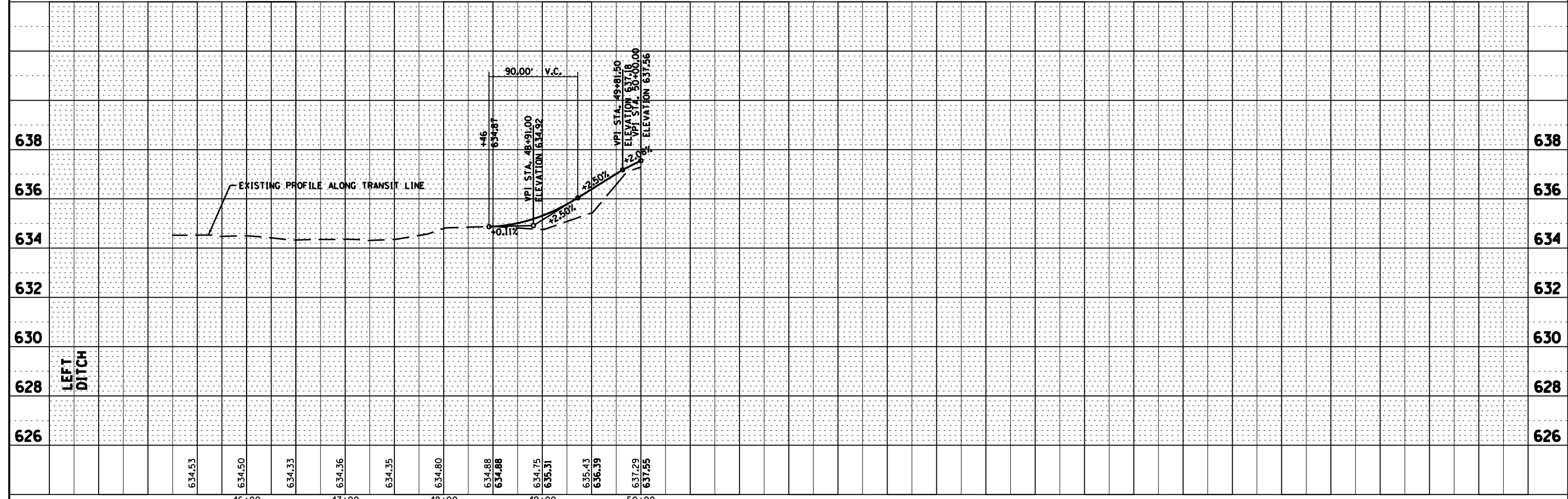
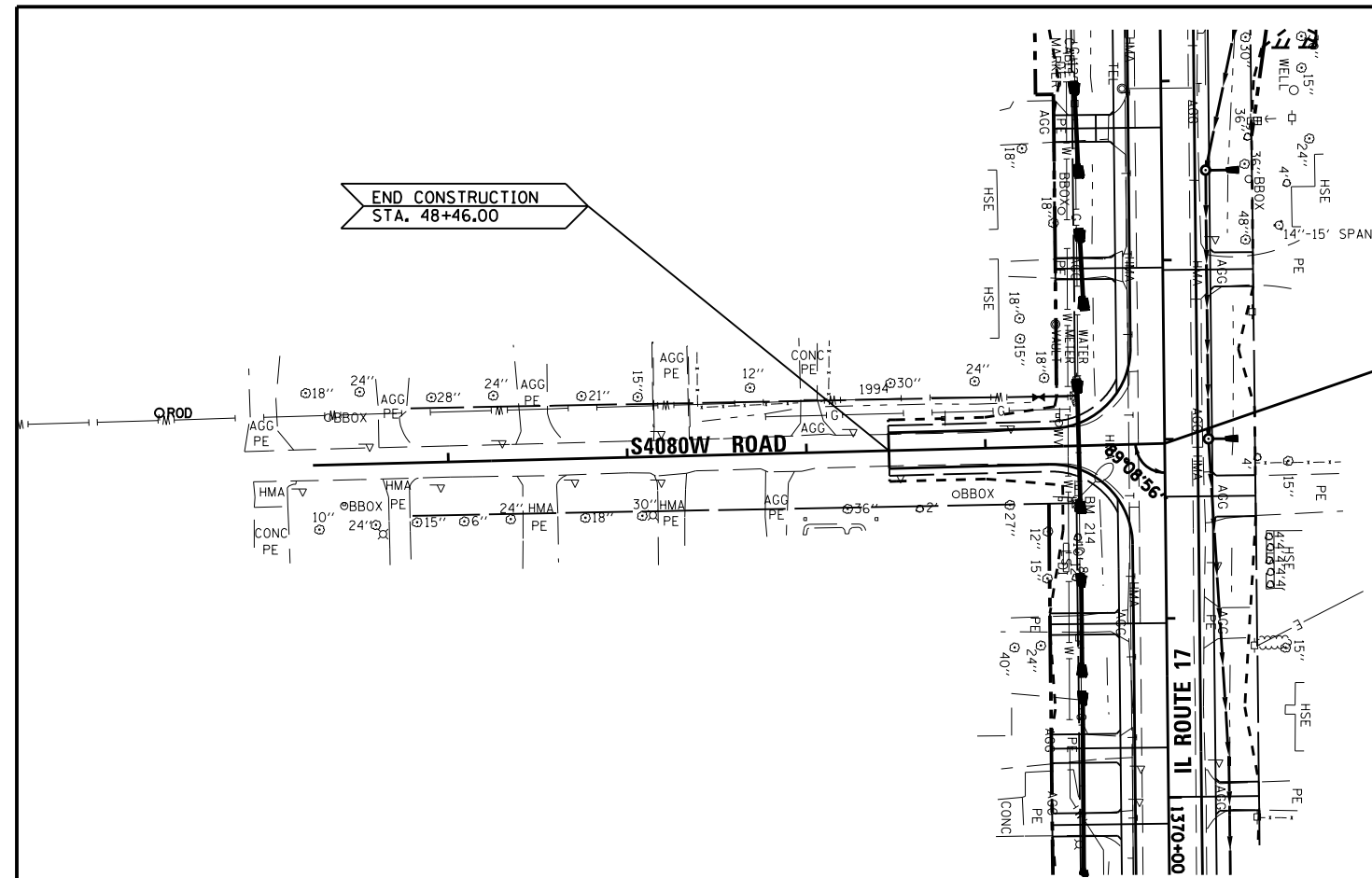

FILE NAME =	USER NAME =	DESIGNED -	REVISOR -	<b>STATE OF ILLINOIS</b> <b>DEPARTMENT OF TRANSPORTATION</b>	<b>PLAN &amp; PROFILE - S4080W ROAD</b>	F.A.P. RTE.	SECTION	COUNTY	TOTAL SHEETS	SHEET NO.
D366905-SHT-PLNPRF-S4080.DGN	--	JKC	-			41	(I)W&RS-1	KANKAKEE	450	83
PLOT SCALE = 1"=50'		LAG/NV	-			CONTRACT NO. 66905				
PLOT DATE = 07/13		JKC	-			ILLINOIS FED. AID PROJECT				
		DATE - 07/13	REVISOR -	SCALE: 1"=50'	SHEET OF SHEETS	STA. 45+24.48	TO STA. 50+00			