

PLAN	SURVEYED	DATE	BY
	PLOTTED	07/09	CHAMLIN & ASSOCIATES
	ALIGNED	07/09	LAG
	CHECKED	07/09	JKC
	FILE NAME	07/09	NV
	NO.	0366905-PLNPRF-N3290W.DGN	

PROFILE	SURVEYED	DATE	BY
	PLOTTED	07/09	CHAMLIN & ASSOCIATES
	GRADES CHECKED	07/09	LAG
	STRUCTURE	07/09	JKC
	NOTATION	07/09	NV
	NO.	0366905-PRO-001.DGN	

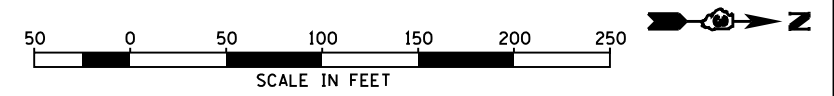

BENCHMARK #219:
 CHISELED X ON TOP OF NORTH BOLT OF FIRE HYDRANT
 SOUTH SIDE OF IL. 17 OPPOSITE OF N3290W (LYNN COURT)
 STA. 1394+16.23, 48.84' RT.
 ELEV.= 627.08

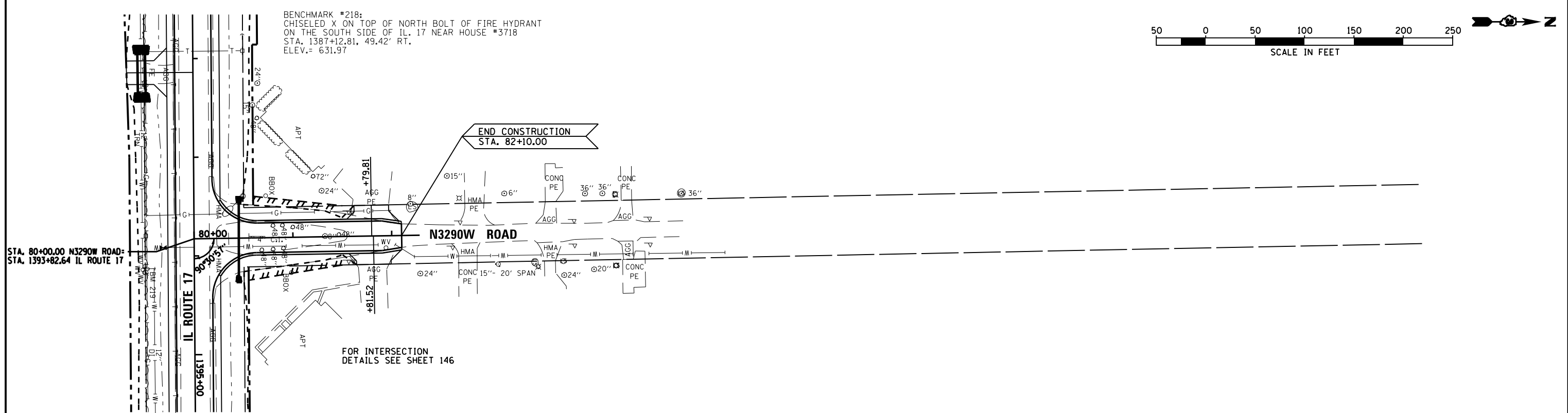
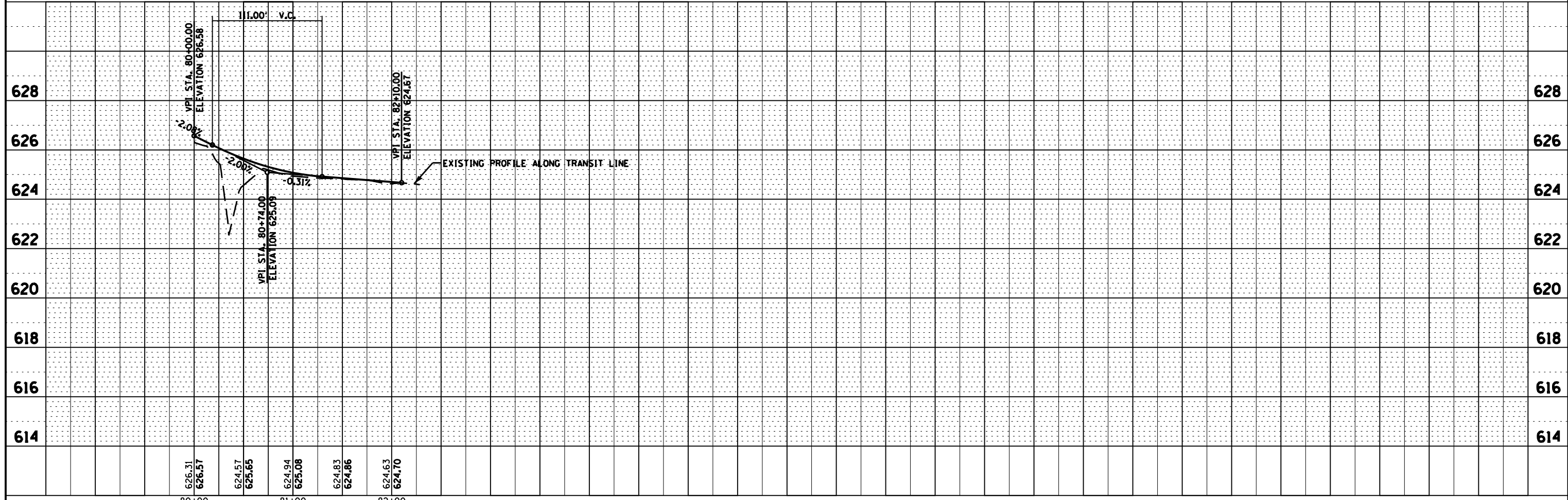

FILE NAME = 0366905-SHT-PLNPRF-N3290W.DGN	USER NAME = --	DESIGNED - JKC	REVISED -	STATE OF ILLINOIS DEPARTMENT OF TRANSPORTATION	PLAN & PROFILE - N3290W ROAD		F.A.P. RTE. 41	SECTION (I)W&RS-1	COUNTY KANKAKEE	TOTAL SHEETS 450	SHEET NO. 86
	PLOT SCALE = 1"=50'	DRAWN - LAG/NV	REVISED -		SCALE: 1"=50'	SHEET OF SHEETS	STA. 80+00 TO STA. 82+28.32	CONTRACT NO. 66905		ILLINOIS FED. AID PROJECT	
	PLOT DATE = 07/13	CHECKED - JKC	REVISED -								
		DATE - 07/13	REVISED -								