

BENCHMARK #224:  
RAILROAD SPIKE IN POWER POLE IN THE N.E. QUAD  
OF IL. 17/ CR 6 (PIPELINE ROAD)  
STA. 1422+87.57, 47.28' LT.  
ELEV.= 623.95

FOR INTERSECTION  
DETAILS SEE SHEET 148

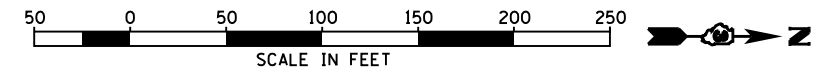

STA. 110+00.00 N2750W ROAD=  
STA. 1422+53.35 IL ROUTE 17

END CONSTRUCTION  
STA. 111+30.74

PLAN	SURVEYED	DATE
NOTE BOOK	PLOTTED	07/09
NO.	ALIGNED	07/09
	CHECKED	07/09
	FILE NAME	07/09
	BY	CHAMLIN & ASSOCIATES
	LAG	JKC
	LAG/NV	LAG/NV
	DATE	07/09

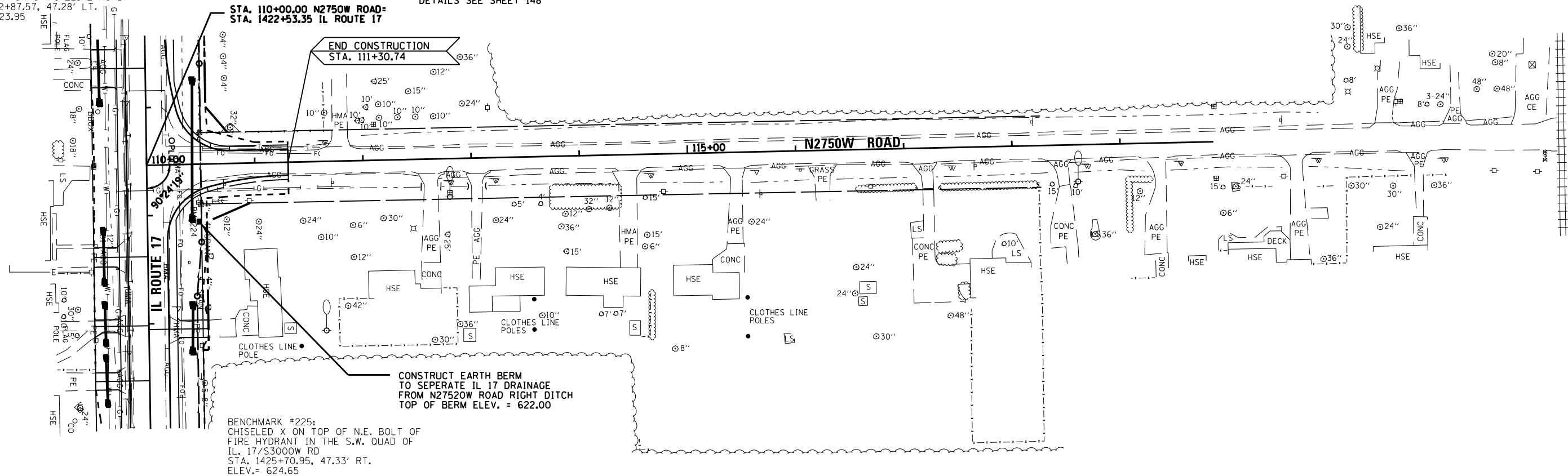

PROFILE	SURVEYED	DATE
GRADES CHECKED	PLOTTED	07/09
STRUCTURE	NOT AT THIS CHFD	07/09
BY	CHAMLIN & ASSOCIATES	
LAG	JKC	
LAG/NV	LAG/NV	
DATE	07/09	

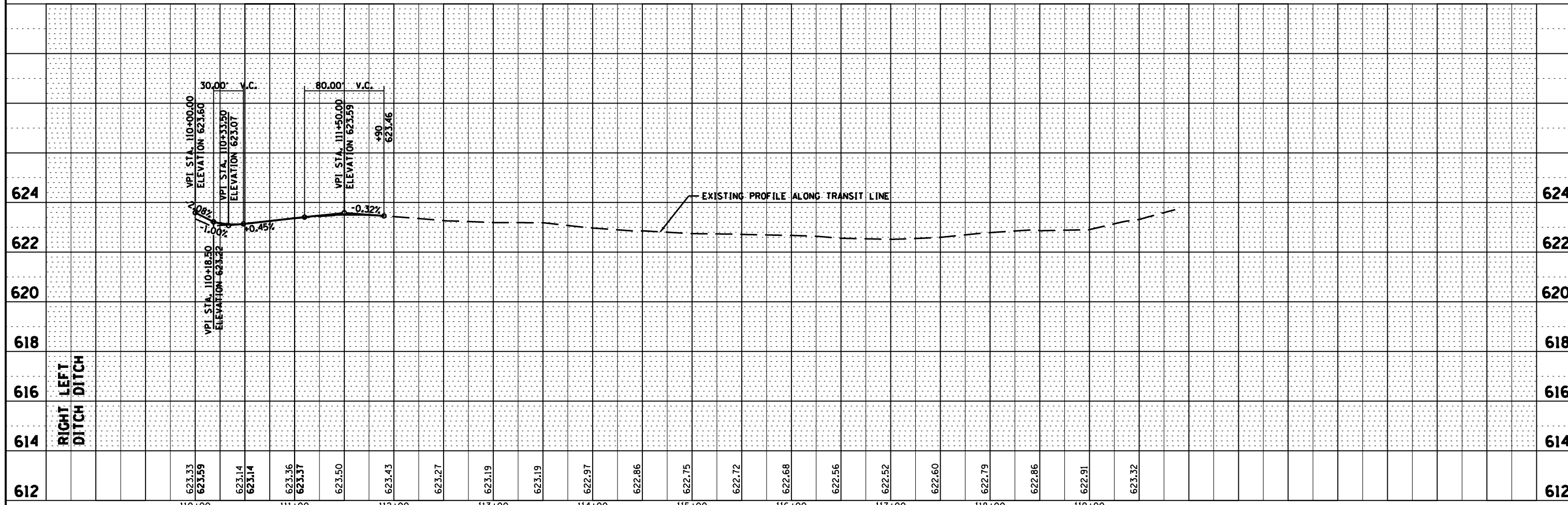

FILE NAME =	USER NAME =	DESIGNED - JKC	REVISED -	STATE OF ILLINOIS DEPARTMENT OF TRANSPORTATION	PLAN & PROFILE - N2750W ROAD	F.A.P. RTE.	SECTION	COUNTY	TOTAL SHEETS	SHEET NO.	
D366905-SHT-PLNPRF-N2750.DGN		DRAWN - LAG/NV	REVISED -			41	(11)W&RS-1	KANKAKEE	450	89	
		CHECKED - JKC	REVISED -			CONTRACT NO. 66905					
		DATE - 07/13	REVISED -			ILLINOIS FED. AID PROJECT					