

BENCHMARK #234:
RAILROAD SPIKE IN POWER POLE WITH LIGHT
NORTH SIDE OF IL. 17 @ C.E. TO R.R. YARD
STA. 1475+65.19, 48.40' LT.
ELEV.= 628.75

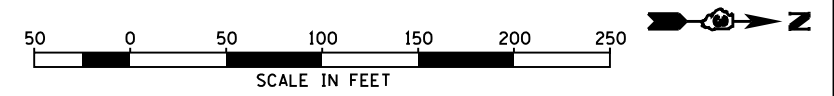

PLAN	SURVEYED	DATE
	PLOTTED	07/09
NOTE BOOK	CHECKED	BY
	FILE NAME	0366905-SHT-PLNPRF-W1790.DGN

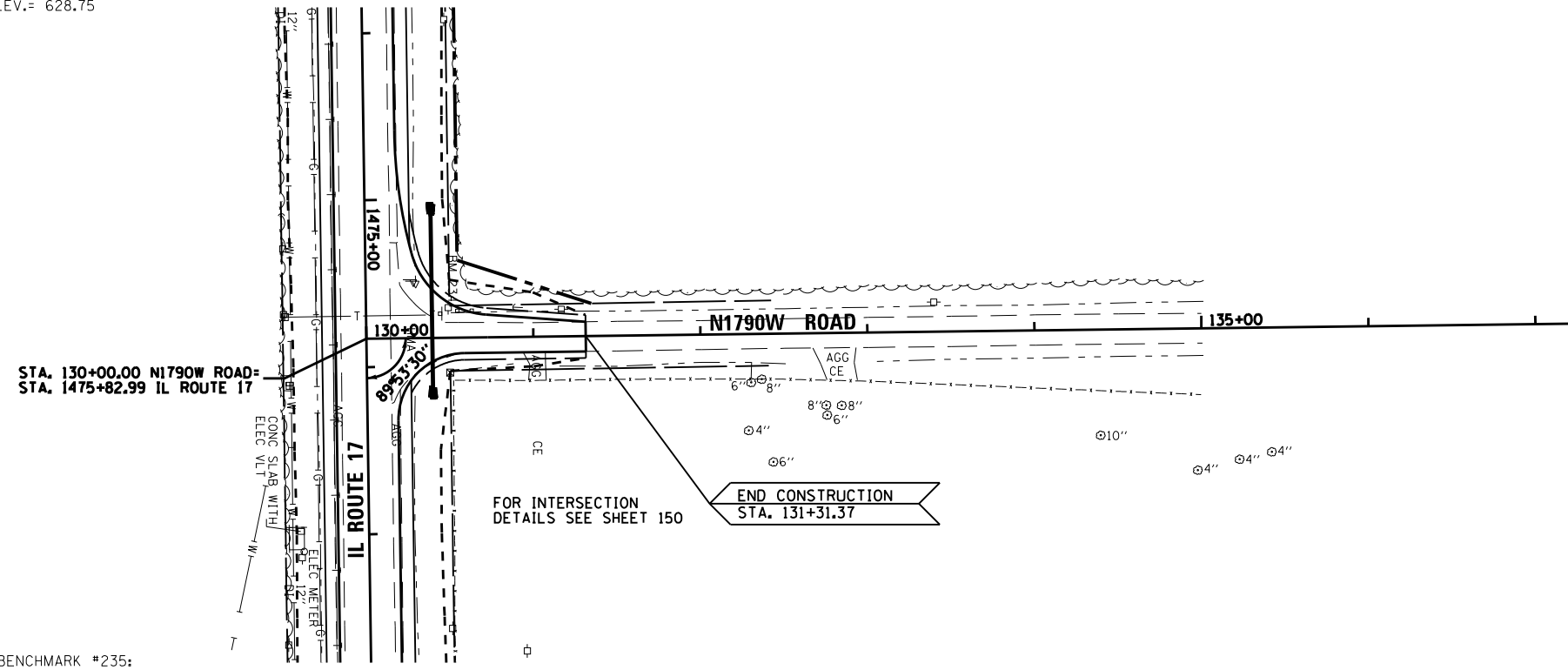

BENCHMARK #235:
CHISELED SQUARE TOP W. END 18" RCP
@ C.E. N. SIDE IL 17
STA. 1481+93.99, 33.78' LT.
ELEV.= 625.87

PROFILE	SURVEYED	DATE
	PLOTTED	07/09
NOTE BOOK	CHECKED	BY
	FILE NAME	0366905-SHT-PLNPRF-W1790.DGN

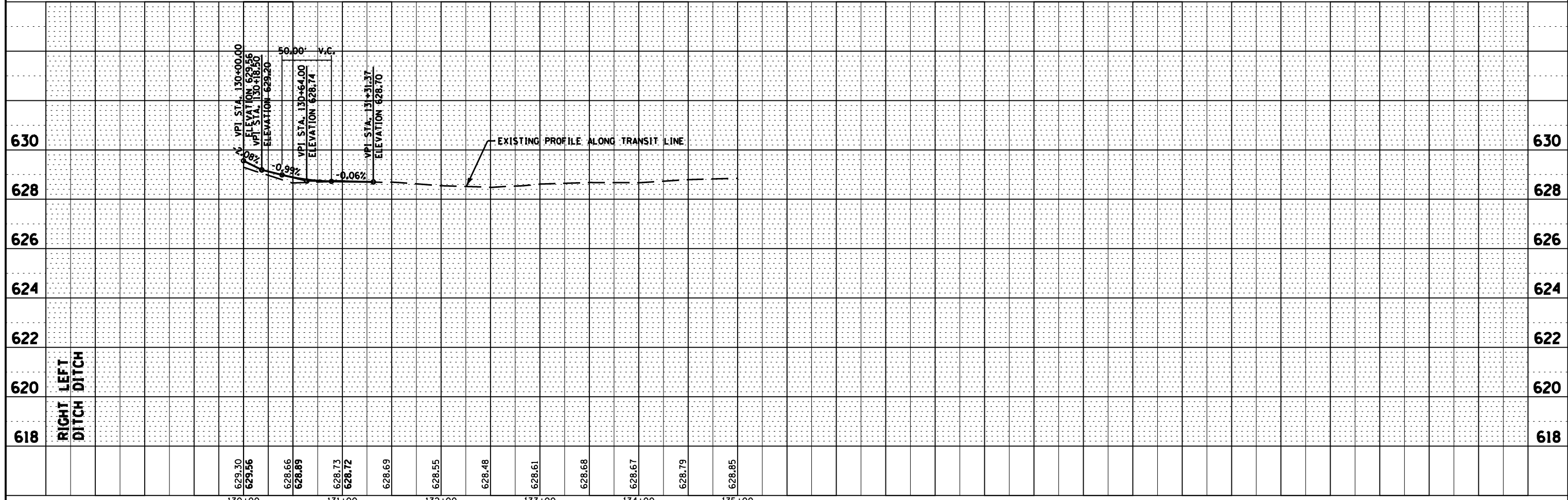

FILE NAME =	USER NAME = --	DESIGNED - JKC	REVISED -	STATE OF ILLINOIS DEPARTMENT OF TRANSPORTATION	PLAN & PROFILE - N1790W ROAD	F.A.P. RTE.	SECTION	COUNTY	TOTAL SHEETS	SHEET NO.
0366905-SHT-PLNPRF-W1790.DGN		DRAWN - LAG/NV	REVISED -			41	(I)W&RS-1	KANKAKEE	450	91
PLOT SCALE = 1"=50'		CHECKED - JKC	REVISED -			CONTRACT NO. 66905				
PLOT DATE = 07/13		DATE - 07/13	REVISED -			ILLINOIS FED. AID PROJECT				