

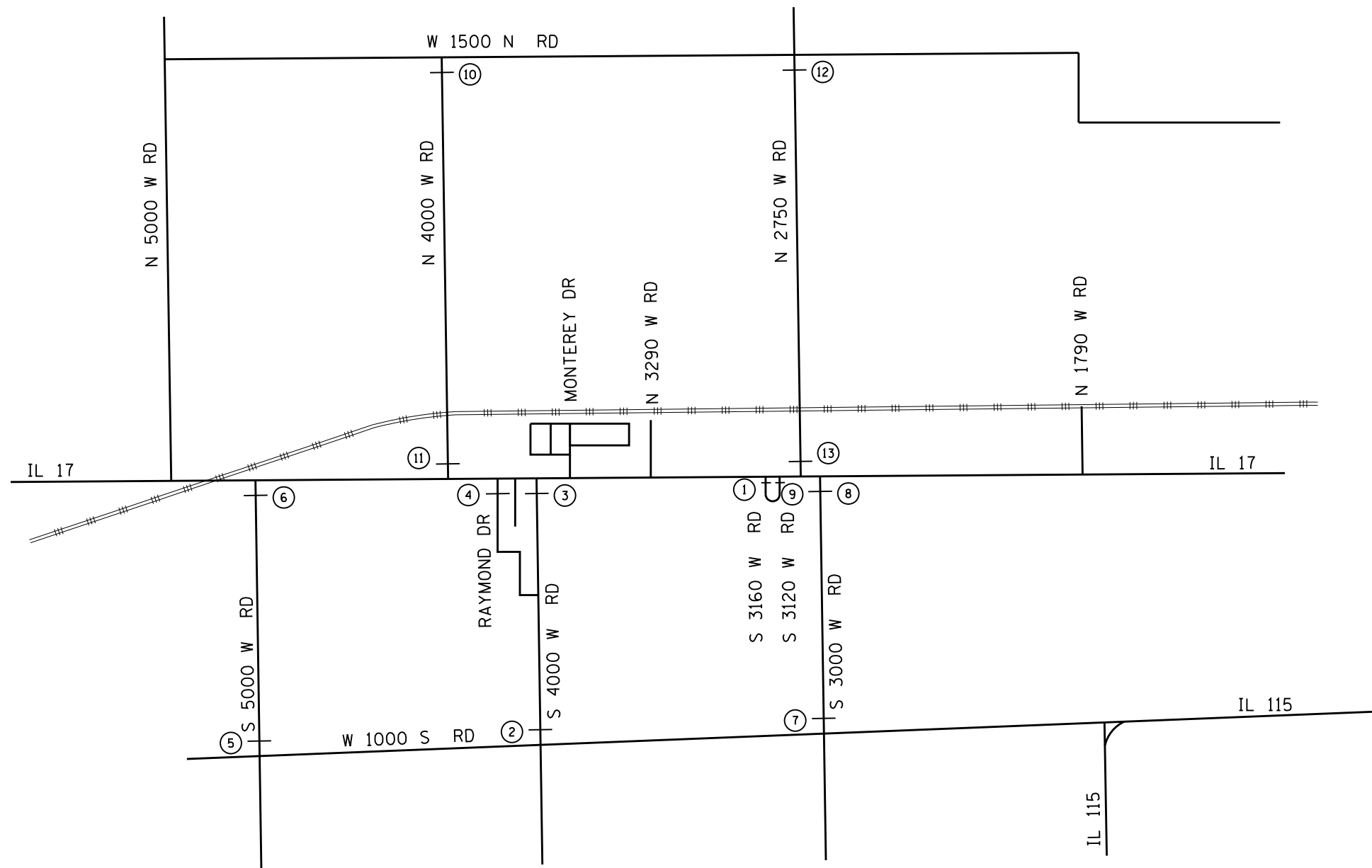

**SIDE ROAD TRAFFIC CONTROL NOTES\***

1. CLOSE S3160W ROAD TO ALL TRAFFIC IN ACCORDANCE WITH HIGHWAY STANDARD BLR 21 AT IL 17 AND STA. 89+30 (S3160W) - STAGE IA
2. CLOSE S4000W ROAD TO THRU TRAFFIC IN ACCORDANCE WITH HIGHWAY STANDARD BLR 22 AT W1000S ROAD - STAGE IB
3. CLOSE S4000W ROAD TO ALL TRAFFIC IN ACCORDANCE WITH HIGHWAY STANDARD BLR 21 AT IL 17 AND STA. 58+25 (S4000W) - STAGE IB
4. CLOSE RAYMOND DRIVE TO ALL TRAFFIC IN ACCORDANCE WITH HIGHWAY STANDARD BLR 21 AT IL 17 AND STA.39+25 (RAYMOND DRIVE) - STAGE IC
5. CLOSE S5000W ROAD TO THRU TRAFFIC IN ACCORDANCE WITH HIGHWAY STANDARD BLR 22 AT W1000S ROAD - STAGE IE
6. CLOSE S5000W ROAD TO ALL TRAFFIC IN ACCORDANCE WITH HIGHWAY STANDARD BLR 21 AT IL 17 AND STA. 218+00 (S5000W) - STAGE IE
7. CLOSE S3000W ROAD TO THRU TRAFFIC IN ACCORDANCE WITH HIGHWAY STANDARD BLR 22 AT W1000S ROAD - STAGE IF
8. CLOSE S3000W ROAD TO ALL TRAFFIC IN ACCORDANCE WITH HIGHWAY STANDARD BLR 21 AT IL 17 AND STA. 118+00 (S3000W) - STAGE IF
9. CLOSE S3120W ROAD TO ALL TRAFFIC IN ACCORDANCE WITH HIGHWAY STANDARD BLR 21 AT IL 17 AND STA. 99+25 (S3120W) - STAGE IF
10. CLOSE N4000W ROAD TO THRU TRAFFIC IN ACCORDANCE WITH HIGHWAY STANDARD BLR 22 AT W1500N ROAD - STAGE IIB
11. CLOSE N4000W ROAD TO ALL TRAFFIC IN ACCORDANCE WITH HIGHWAY STANDARD BLR 21 AT IL 17 AND STA. 31+50 (N4000W) - STAGE IIB
12. CLOSE N2750W ROAD TO THRU TRAFFIC IN ACCORDANCE WITH HIGHWAY STANDARD BLR 22 AT W1500N ROAD - STAGE IIC
13. CLOSE N2750W ROAD TO ALL TRAFFIC IN ACCORDANCE WITH HIGHWAY STANDARD BLR 21 AT IL 17 AND STA. 111+50 (N2750W) - STAGE IIC
14. WORK AT S4120W ROAD, MONTEREY DRIVE, N3290W ROAD, AND N1790W SHALL BE STAGED TO ALLOW ONE-LANE TWO WAY TRAFFIC CONTROLLED BY FLAGMEN WHEN WORKERS ARE PRESENT AND OPEN TO TWO-WAY TWO LANE TRAFFIC WHEN WORKERS ARE NOT PRESENT

\* EXCEPT AT S3160W AND RAYMOND DRIVE THE DURATION OF SIDE ROAD CLOSURES SHALL BE LIMITED TO ONE CALENDAR WEEK. DURING THAT TIME WORK TO WIDEN IL 17 SHALL BE COMPLETED THROUGH THE INTERSECTION, EXCEPT FOR LEVELING BINDER AND SURFACE COURSE.



FILE NAME = D366905-SHT-STAGING-TC.DGN  
 USER NAME = --  
 PLOT SCALE = 1"=50'  
 PLOT DATE = 07/13

DESIGNED - JKC	REVISED - -
DRAWN - LAG/NV	REVISED - -
CHECKED - JKC	REVISED - -
DATE - 07/13	REVISED - -

**STATE OF ILLINOIS  
 DEPARTMENT OF TRANSPORTATION**

**CONSTRUCTION STAGING & TRAFFIC CONTROL**

SCALE: 1"=50' SHEET \_\_\_ OF \_\_\_ SHEETS STA. - TO STA. -

F.A.P. RTE.	SECTION	COUNTY	TOTAL SHEETS	SHEET NO.
41	(1)W&RS-1	KANKAKEE	450	93
<b>CONTRACT NO. 66905</b>				
<small>ILLINOIS FED. AID PROJECT</small>				