



SEQUENCE OF OPERATIONS

STAGE III - A (PEAK HOURS ONLY)

NOTE: See the Special Provision entitled "Working Restrictions & Staging Notes", No. 6 for a definition of peak hours of operation.

PURPOSE

Stages III-A & III-B are primarily for the placement of widening and drainage work on the south side of Farmington road. Stage III-A is for peak hour traffic and Stage III-B is for off-peak hour traffic. Therefore, the contractor shall be shifting between Stages III-A & III-B on a daily basis.

CONSTRUCTION

- Remove existing HMA shoulder and place widening from lt. sta. 33+50 to sta. 43+00.
- The contractor shall clean the 54 inch pipe culvert prior to any proposed drainage work that is to be constructed. This shall be done according to the special provisions and to the satisfaction of the Resident Engineer.
- Construct proposed drainage work, as specified in the drainage plans, from left sta. 38+40 to sta. 39+30.
- Re-construct entrances as specified in the plans.

TRAFFIC

Farmington Road

Shift EB traffic as previously defined by pavement marking tape in Stages II-A & II-B. All lanes shall remain open. Traffic control shall conform to TC&P Standard 701502, except as noted or shown in the plan details and Special Provisions. During this Stage, vertical barricades with lights shall be required overnight adjacent to the work area and within tapers of the eastbound lane, even if workers are not present. The "CENTERLANE CLOSED" and opposing traffic arrows signs shown in Standard 701502 shall not be required.

Sterling Avenue

Sterling Avenue shall remain open to normal traffic movement with possible variations in patterns during this stage.

Side Roads

Stever Avenue and Rhodora Avenue shall remain open to normal traffic patterns.

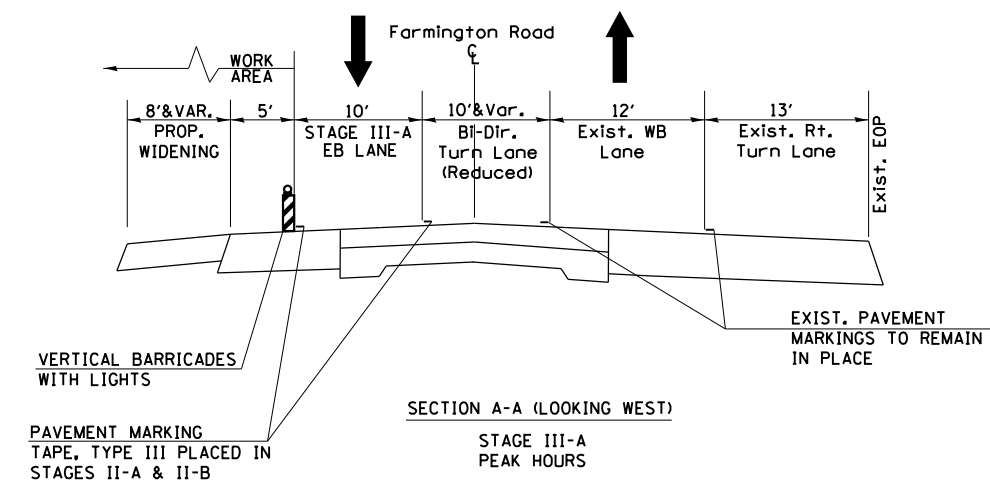
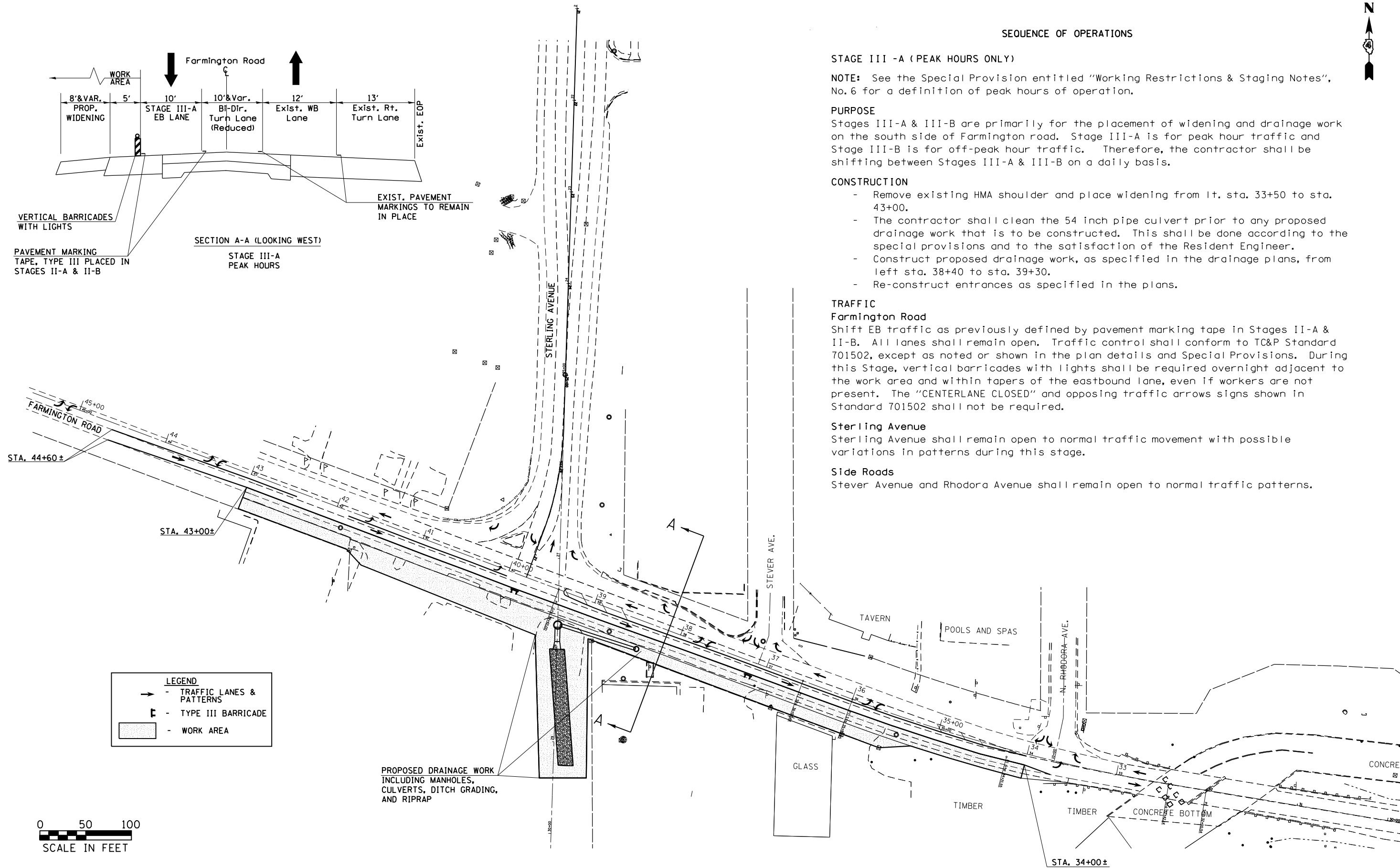

LEGEND

	TRAFFIC LANES & PATTERNS
	TYPE III BARRICADE
	WORK AREA

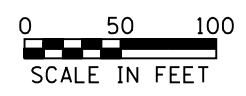

FILE NAME =	USER NAME = aubreys	DESIGNED -	REVISED -	STATE OF ILLINOIS DEPARTMENT OF TRANSPORTATION	TRAFFIC CONTROL PLAN - STAGE III-A PEAK HOURS			F.A.U. RTE.	SECTION	COUNTY	TOTAL SHEETS	SHEET NO.
Default	ct:\pw\work\p\dot\aubreys\d0318675\046870-staging.dgn	DRAWN -	REVISED -		6658	ION	PEORIA	120	31			
	PLOT SCALE = 100.0000' / in.	CHECKED -	REVISED -		CONTRACT NO. 68A70							
	PLOT DATE = 10/17/2013	DATE -	REVISED -		ILLINOIS FED. AID PROJECT							
					SCALE:	SHEET 3	OF 11 SHEETS	STA.	TO STA.			