

SECTION A-A (LOOKING WEST)
STAGE VII

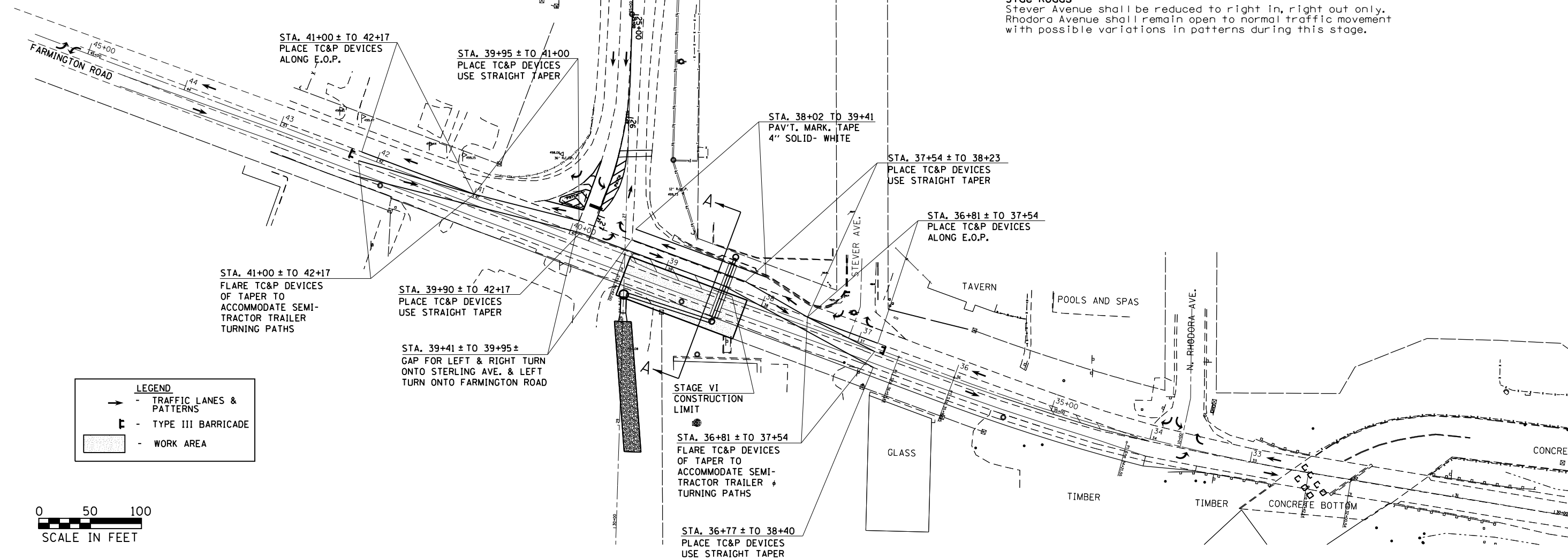

LEGEND	
	- TRAFFIC LANES & PATTERNS
	- TYPE III BARRICADE
	- WORK AREA

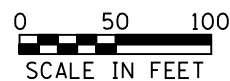

SEQUENCE OF OPERATIONS

STAGE VII

NOTE: See the Special Provision entitled "Working Restrictions & Staging Notes", (No. 16) for work hour restrictions on this stage.

PURPOSE

Stage VII is designed for installation of the second half of the cross road culvert at sta. 38+40 on Farmington Road.

CONSTRUCTION

- Place pavement marking tape from sta. 38+02 to 39+41 to define the north edge of the WB stage traffic lane.
- Work area for this stage is defined from sta. 38+15 to 39+36.
- Remove pavement and install pipe culvert beginning at the centerline of Farmington Road.
- Replace pavement with a Class D Patch with PP-2 material requirements.

TRAFFIC

Farmington Road

Shift the WB traffic on Farmington Road into the existing right turn lane and maintain through majority of the intersection before transitioning back to actual WB lane. Close the center bi-directional turn lane and shift the EB traffic on Farmington Road to the existing WB lane. One lane in each direction shall remain open. Traffic control shall conform to TC&P Standard 701502, except as noted or shown in the plan details and Special Provisions. Traffic shall be channelized with approved devices to remain in place for nighttime closure, during non-working hours.

Sterling Avenue

Sterling Avenue shall remain open to normal traffic movement with possible variations in patterns during this stage.

Side Roads

Stever Avenue shall be reduced to right in, right out only. Rhodora Avenue shall remain open to normal traffic movement with possible variations in patterns during this stage.



FILE NAME =	USER NAME = aubreys	DESIGNED -	REVISED -
Default	Default	DRAWN -	REVISED -
	PLOT SCALE = 100.0000' / 1" =	CHECKED -	REVISED -
	PLOT DATE = 10/17/2013	DATE -	REVISED -

STATE OF ILLINOIS
DEPARTMENT OF TRANSPORTATION

TRAFFIC CONTROL PLAN - STAGE VII

SCALE: SHEET 8 OF 11 SHEETS STA. TO STA.

F.A.U. RTE.	SECTION	COUNTY	TOTAL SHEETS	SHEET NO.
6658	10N	PEORIA	120	36
CONTRACT NO. 68A70				
ILLINOIS FED. AID PROJECT				