



NOTE:

- SEEDING AND MULCH QUANTITIES FOR LEFT SIDE OF STERLING AVENUE ARE CALCULATED FROM BACK OF SIDEWALK TO THE R.O.W. LINE

LEGEND

- ① INLET & PIPE PROTECTION
- ② INLET FILTER
-  RIPRAP
-  HEAVY DUTY EROSION CONTROL BLANKET
-  MULCH METHOD 2

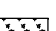
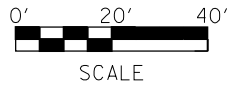
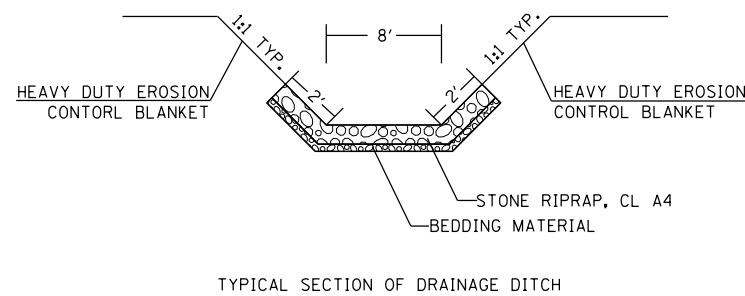
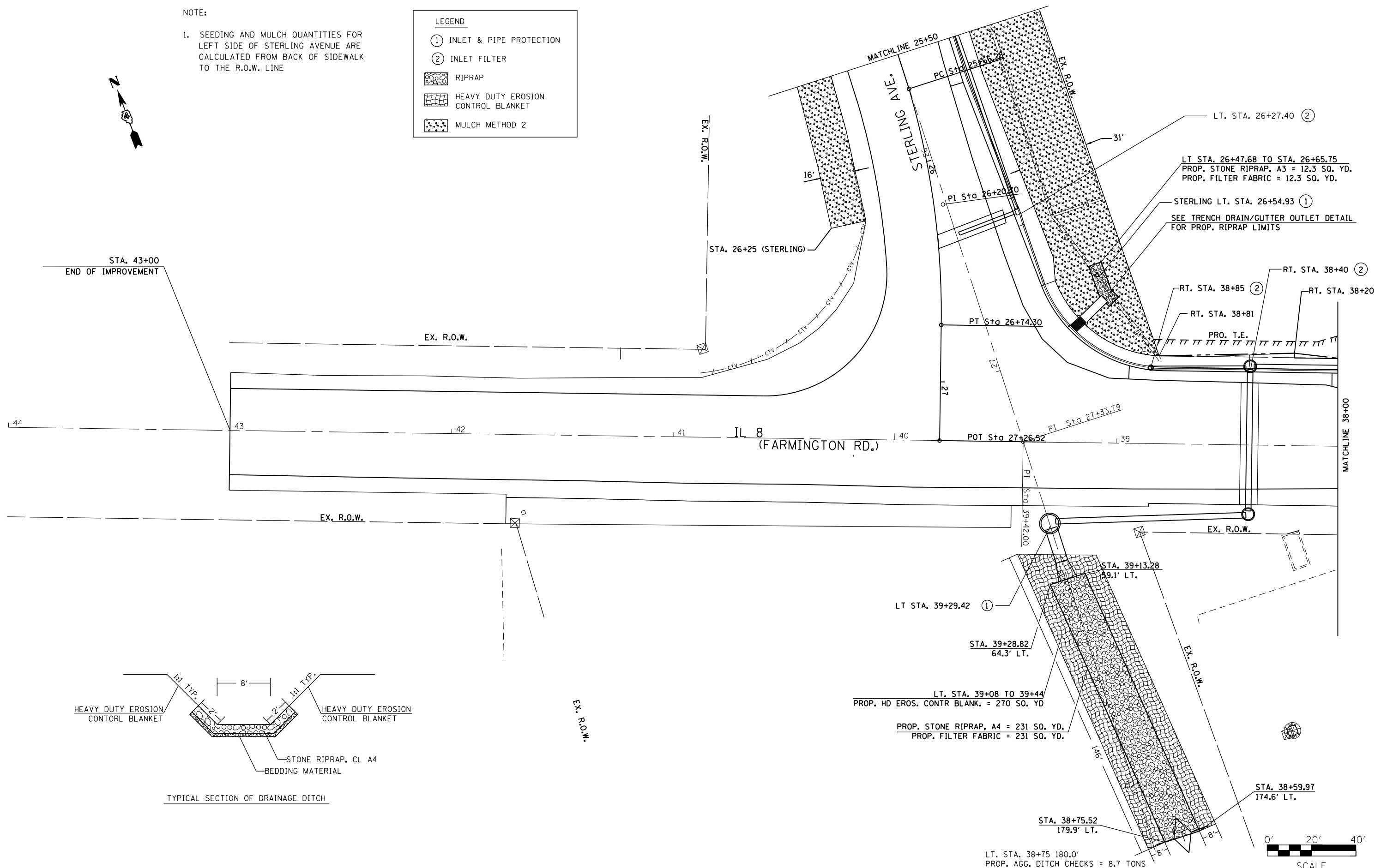

FILE NAME =	USER NAME = aubreygs	DESIGNED -	REVISED -
ct:\pw\work\p\dot\aubreygs\d0318674\046870-sh-t-drain.dgn		DRAWN -	REVISED -
Default	PLOT SCALE = 40.0000' / in.	CHECKED -	REVISED -
	PLOT DATE = 10/17/2013	DATE -	REVISED -

STATE OF ILLINOIS
DEPARTMENT OF TRANSPORTATION

PROPOSED EROSION CONTROL

SCALE: SHEET 2 OF 3 SHEETS STA. 38+00 TO STA. 43+00

F.A.U. RTE.	SECTION	COUNTY	TOTAL SHEETS	SHEET NO.
6658	10N	PEORIA	120	53
CONTRACT NO. 68A70				
ILLINOIS FED. AID PROJECT				