

TYPICAL URBAN ENTRANCE

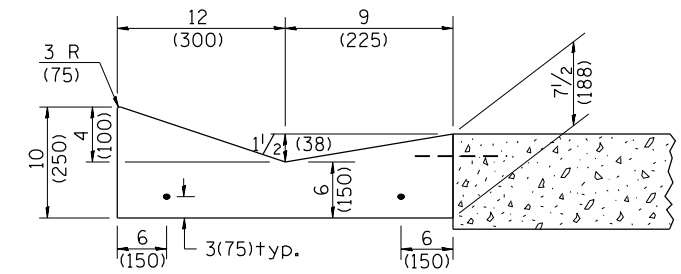

SECTION A-A & C-C

**QUANTITY URBAN ENTRANCE**  
 Section B'-B' to B-B= 0.1 cu. yd./ft.  
 Section C-C to B'-B' + B-B to A-A= 0.69 cu. yd.

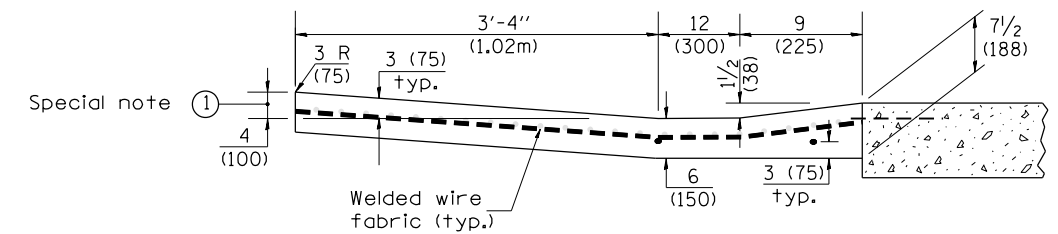

SECTION B-B & B'-B'

Special note ①

**SPECIAL NOTES:**  
 ① 4 (100) is the normal dimension. If specified in the plans, the following shall be used for improved entrance match-up: Minimum - 2 1/2 (65) Maximum - 5 (125)

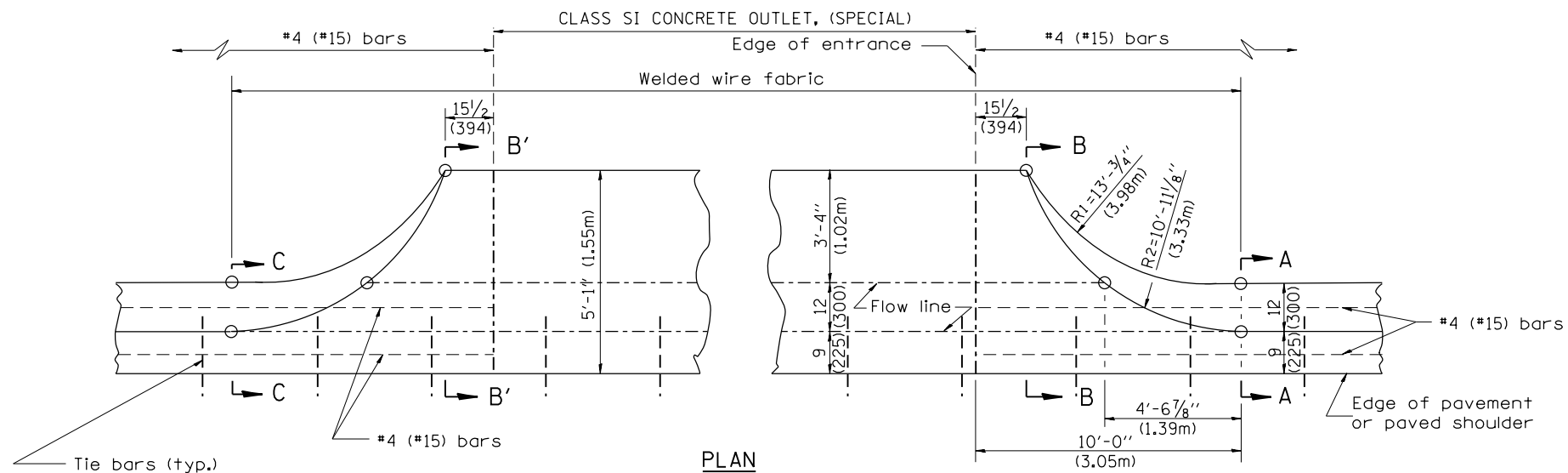

TYPICAL RURAL ENTRANCE

**QUANTITY RURAL ENTRANCE**  
 Section B'-B' to B-B= 0.1 cu. yd./ft.  
 Section C-C to B'-B' + B-B to A-A= 1.19 cu. yd.

**QUANTITIES**  
 CALC. BY: \_\_\_\_\_ DATE: \_\_\_\_\_  
 CHECKED BY: \_\_\_\_\_ DATE: \_\_\_\_\_  
 QUANTITY CALCULATIONS ARE ON FILE AT THE DISTRICT 4 OFFICE; BUREAU OF PROJECT IMPLEMENTATION; DOCUMENTATION SECTION

All dimensions are in inches (millimeters) unless otherwise noted.

STATE OF ILLINOIS  
 DEPARTMENT OF TRANSPORTATION

CONCRETE GUTTER, TYPE B, (SPECIAL)  
 (INLET, OUTLET & ENTRANCE)

NOT TO SCALE

SHT. 3 OF 3  
 CADD STD. 606201-D4

F.A.U. RTE.	SECTION	COUNTY	TOTAL SHEETS	SHEET NO.
6658	10N	PEORIA	120	87
CONTRACT NO. 68A70				
FED. ROAD DIST. NO. ILLINOIS FED. AID PROJECT				