

SECTION A - A

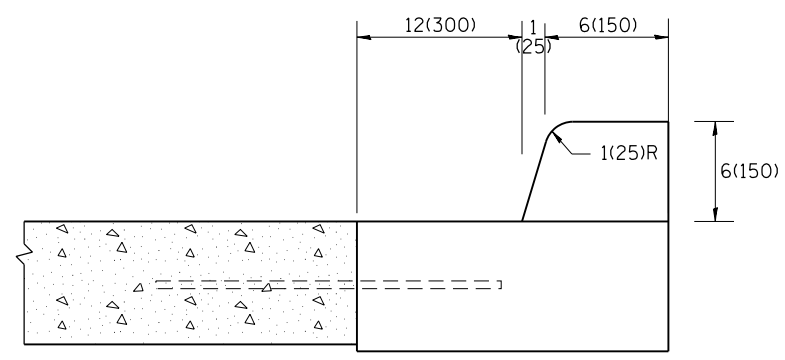

SECTION B - B

GENERAL NOTES:

1. Tie bars shall be constructed in accordance with details for BULKHEAD LONGITUDINAL CONSTRUCTION JOINT shown on Standard 420001.
2. Adjacent to sound existing p.c.c. pavement, tie bars shall be installed in drilled holes in accordance with article 420.10(b).
3. Construction and expansion joints shall be installed in prolongation with joints in the pavement. Joint shall be constructed in accordance with the applicable portion of Art. 606.06 of the Standard Specifications.

All dimensions are in inches (millimeters) unless otherwise noted.

01-01-97	RENUM. A-7.11, METRICS, NEW REVISION BOX, REVISED	T.P.				STATE OF ILLINOIS DEPARTMENT OF TRANSPORTATION	TRANSITION FROM CONCRETE CURB AND GUTTER TYPE B-6.12 (B-15.30) TO OUTLET FOR TYPE B GUTTER (SPECIAL)	F.A.U. RTE.	SECTION	COUNTY	TOTAL SHEETS	SHEET NO.	
10-16-06	GENERAL NOTES, ELIMINATED EXPANSION TIE ANCHORS	M.A.						6658	10N	PEORIA	120	88	
02-15-11	REVISED TO 2007 SPEC.	R.D.											CONTRACT NO. 68A70
	CHANGED MODIFIED TO SPECIAL												

NOT TO SCALE

CADD STD. 606206-D4

FED. ROAD DIST. NO. ILLINOIS FED. AID PROJECT