

F.A.P. RTE.	SECTION	COUNTY	TOTAL SHEETS	SHEET NO.
668	28R-1	SANGAMON	354	83
STA. 6+900.000 TO STA. 7+000.000				
FED. ROAD DIST. NO.		ILLINOIS	FED. AID PROJECT	
CONTRACT NO. 72501				

NOTE:  
SEE DRAINAGE PLANS FOR STATION, OFFSET, AND ELEVATION INFORMATION FOR PROPOSED CURB AND GUTTER SECTIONS BEYOND PROPOSED SIDEWALK. ALL CURB AND GUTTER POINTS ARE CALLED OUT TO THE TOP OF FACE OF CURB.

BM FH1 60D NAIL IN PP AT NE QUAD OF THE KEYS AVE & DIRKSEN PKWY INTERSECTION  
STA. 7+026.63, 14.34m RT, ELEV 179.763m

SEC 25, T16N, R5W, 3RD P.M.

LABORER'S INTERNATIONAL UNION OF NORTH AMERICA LOCAL #477  
DENNIS W. & KAREN J. OVERTURF

KEYS AVENUE

MATCH LINE STA. 6+900  
SEE SHEET 81

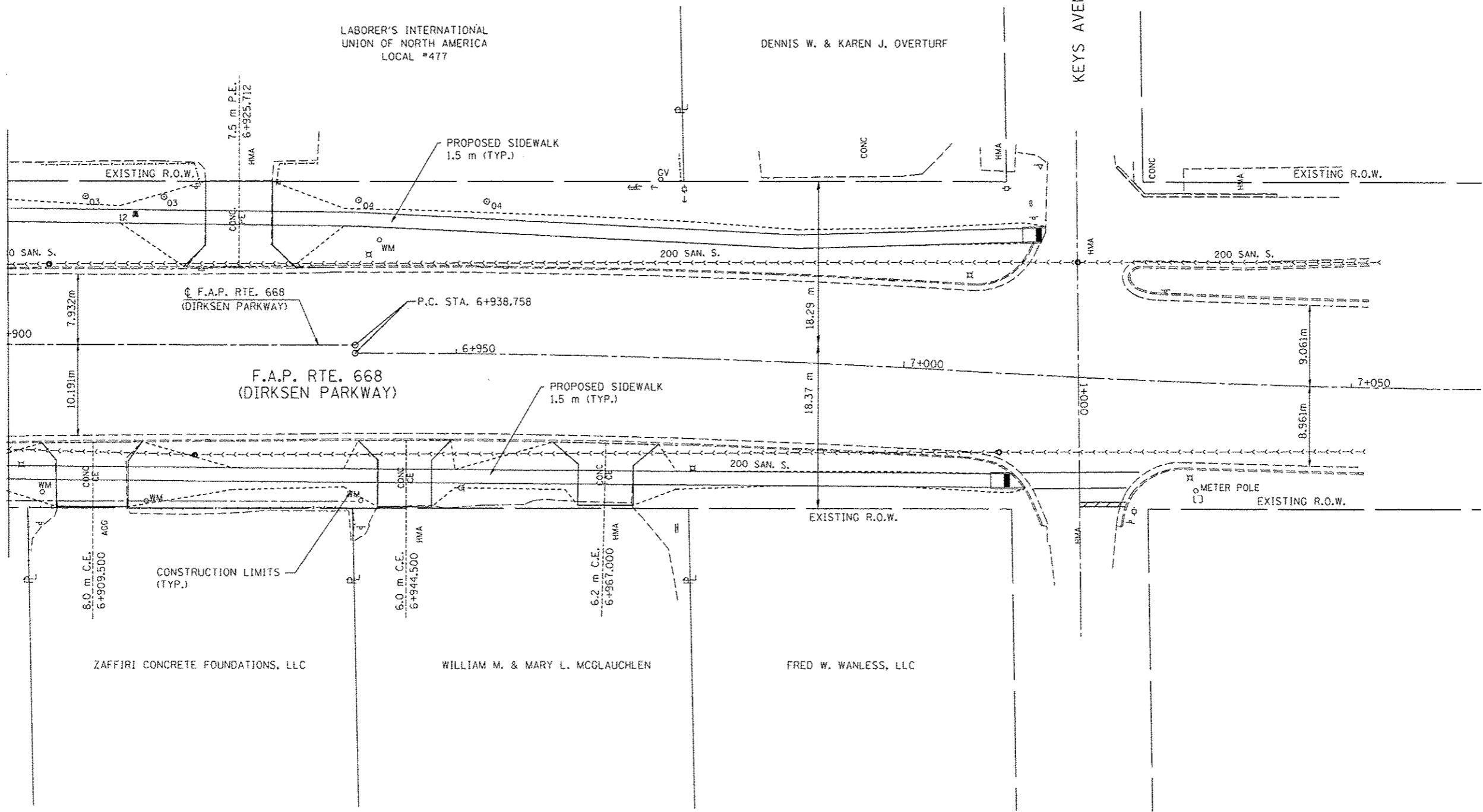

BY	DATE

BY	DATE

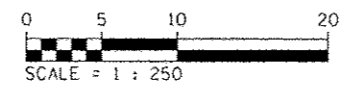

REVISIONS	
NAME	DATE

ILLINOIS DEPARTMENT OF TRANSPORTATION  
ROADWAY PLANS  
F.A.P. ROUTE 668 (DIRKSEN PARKWAY)  
SECTION 28R-1  
SANGAMON COUNTY  
SCALE 1 : 250  
DATE 06/2013  
DRAWN BY RK  
CHECKED BY FML