

F.A.P. RTE.	SECTION	COUNTY	TOTAL SHEETS	SHEET NO.
668	28R-1	SANGAMON	354	89
STA. 0+900.000		TO STA. 0+959.000		
FED. ROAD DIST. NO.		ILLINOIS FED. AID PROJECT		
CONTRACT NO. 72501				

NOTE:
SEE DRAINAGE PLANS FOR STATION, OFFSET, AND ELEVATION INFORMATION FOR PROPOSED CURB AND GUTTER SECTIONS BEYOND PROPOSED SIDEWALK. ALL CURB AND GUTTER POINTS ARE CALLED OUT TO THE TOP OF FACE OF CURB.

FINAL SURVEY	BY	DATE
SURVEYED		
PLOTTED		
TEMPLATE		
NO. BOOK		
AREAS CHECKED		

ORIGINAL SURVEY	BY	DATE
SURVEYED		
PLOTTED		
TEMPLATE		
NO. BOOK		
AREAS CHECKED		

BM FH-2
600 IN L.P. ON WEST SIDE OF DIRKSEN PKWY @ ENT. TO HOUSE #949
STA. 6+087.88, 13.36m LT
ELEV 180.735m

SEC 25, T16N, R5W, 3RD P.M.

KATHERINE A. FELECCIA
PARCEL NO. 6271167

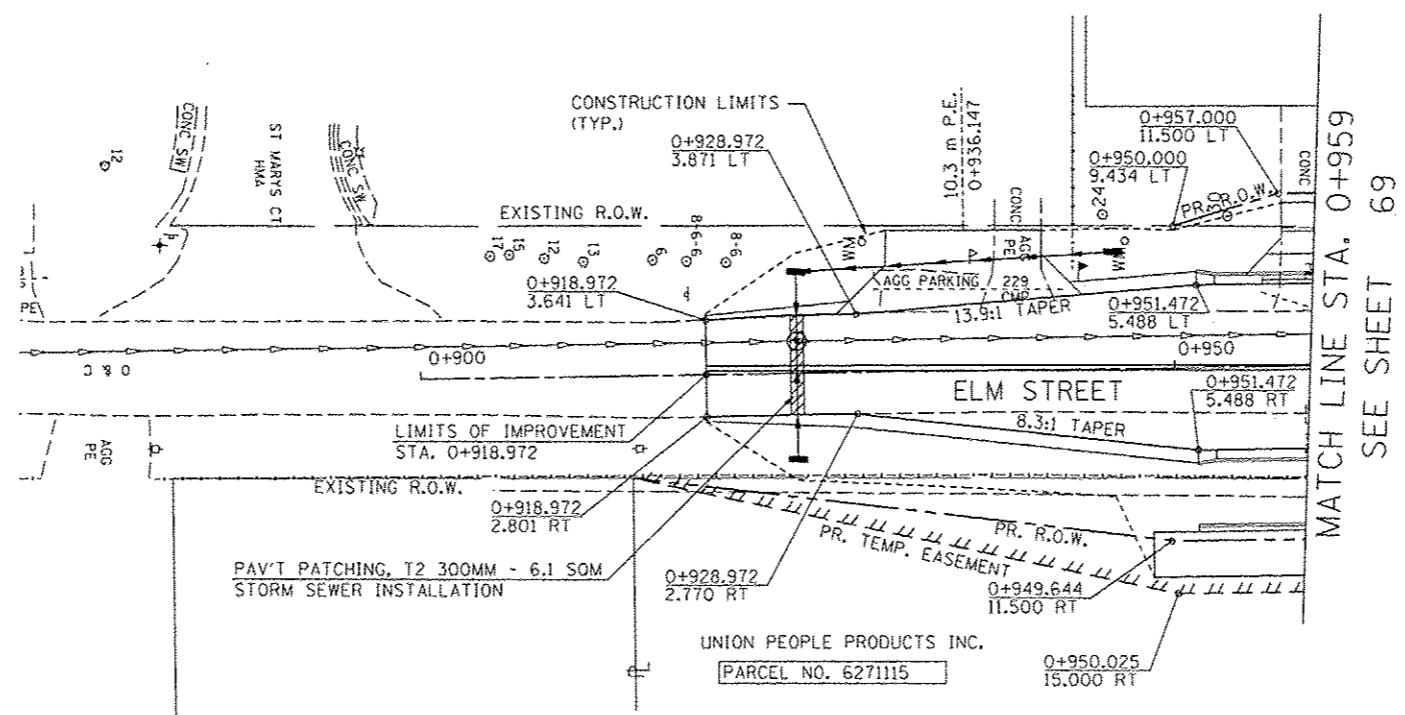

MATCH LINE STA. 0+959
SEE SHEET 69

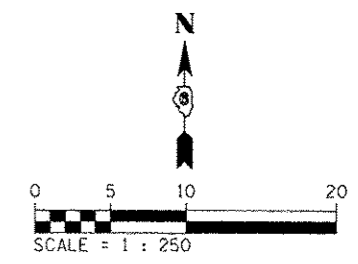

REVISIONS	
NAME	DATE

ILLINOIS DEPARTMENT OF TRANSPORTATION
ROADWAY PLANS
F.A.P. ROUTE 668 (DIRKSEN PARKWAY)
SECTION 28R-1
SANGAMON COUNTY

SCALE 1 : 250
DATE 06/2013

DRAWN BY RK
CHECKED BY FML