

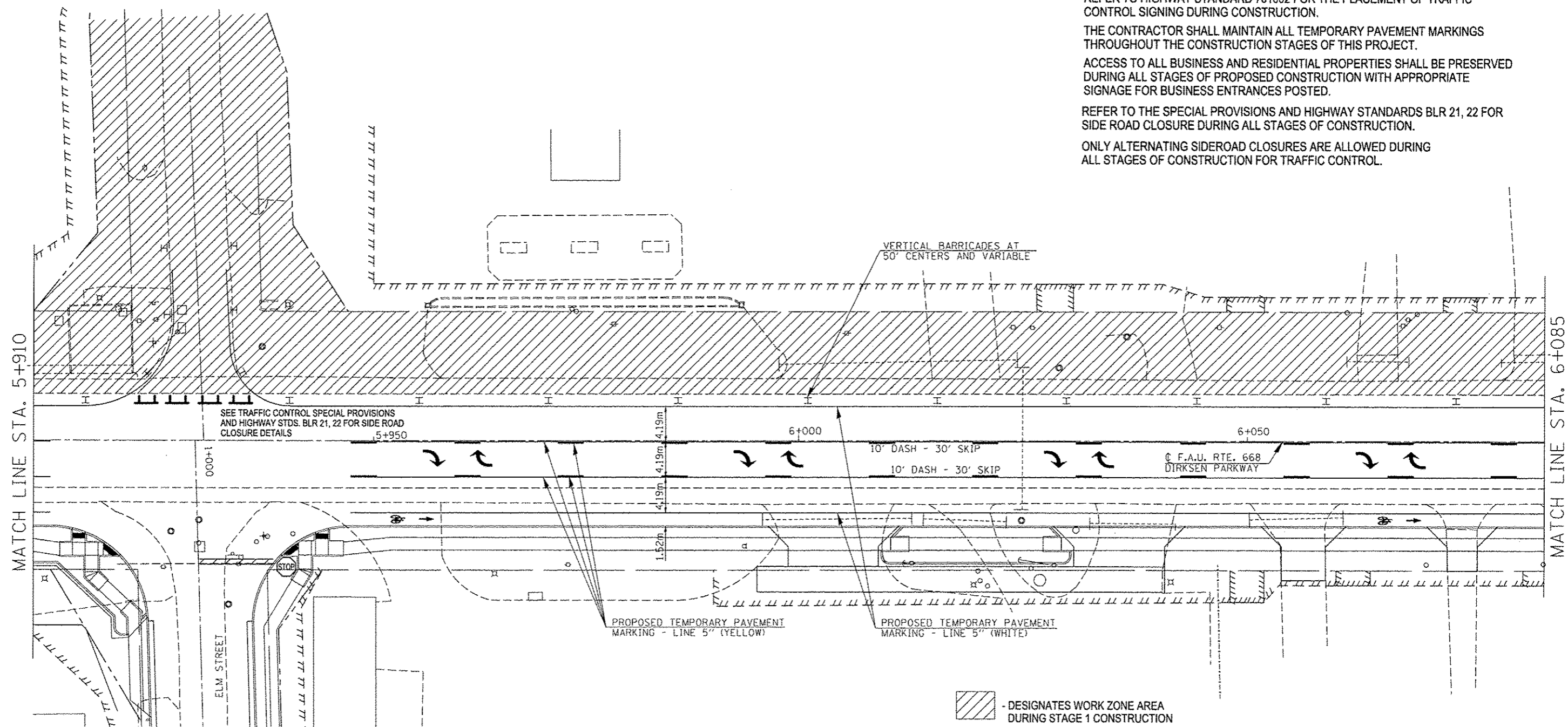







NOTES:
 REFER TO HIGHWAY STANDARD 701602 FOR THE PLACEMENT OF TRAFFIC CONTROL SIGNING DURING CONSTRUCTION.
 THE CONTRACTOR SHALL MAINTAIN ALL TEMPORARY PAVEMENT MARKINGS THROUGHOUT THE CONSTRUCTION STAGES OF THIS PROJECT.
 ACCESS TO ALL BUSINESS AND RESIDENTIAL PROPERTIES SHALL BE PRESERVED DURING ALL STAGES OF PROPOSED CONSTRUCTION WITH APPROPRIATE SIGNAGE FOR BUSINESS ENTRANCES POSTED.
 REFER TO THE SPECIAL PROVISIONS AND HIGHWAY STANDARDS BLR 21, 22 FOR SIDE ROAD CLOSURE DURING ALL STAGES OF CONSTRUCTION.
 ONLY ALTERNATING SIDEROAD CLOSURES ARE ALLOWED DURING ALL STAGES OF CONSTRUCTION FOR TRAFFIC CONTROL.



-  - DESIGNATES WORK ZONE AREA DURING STAGE 1 CONSTRUCTION
-  - DRUM BARRICADE
-  - VERTICAL BARRICADE
-  - DIRECTION INDICATOR BARRICADE
-  - TYPE I OR II BARRICADE
-  - TYPE III BARRICADE
-  - STOP SIGN, TEMPORARY

FILE NAME : ...Temp Pavement Marking Sheets, Stage 2b.dgn	USER NAME : Plotted by Scott	DESIGNED - RTS	REVISED -	STATE OF ILLINOIS DEPARTMENT OF TRANSPORTATION	STAGE CONSTRUCTION, STAGE 2b			F.A.P. RTE. 668	SECTION 28R-1	COUNTY SANGAMON	TOTAL SHEETS 354	SHEET NO. 97
MODELNAME :	PLOT SCALE : 10.0000' / 1" =	CHECKED -	REVISED -		SCALE:	SHEET 7 OF 10 SHEETS	STA. TO STA.	CONTRACT NO. 72501				
	PLOT DATE :	DATE - 05-20-13	REVISED -		ILLINOIS FED. AID PROJECT							