

▨ - DESIGNATES WORK ZONE AREA DURING STAGE 1 CONSTRUCTION

○ - DRUM BARRICADE OR VERTICADE (CHANNELING TRAFFIC DURING CONSTRUCTION)

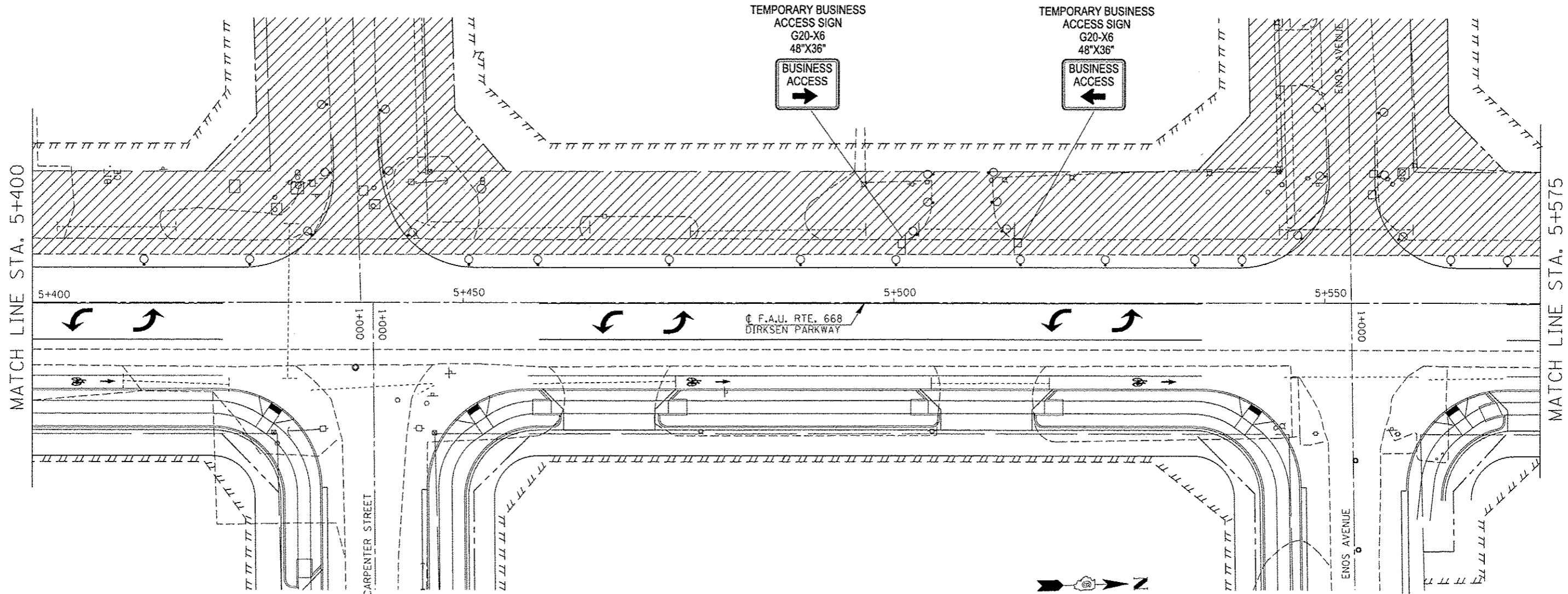

TYPICAL BUSINESS ENTRANCE DETAIL DURING CONSTRUCTION
 (ACCESS TO BUSINESSES AT ALL TIMES DURING CONSTRUCTION,
 SEE SPECIAL PROVISIONS FOR STAGED TRAFFIC CONTROL)

FILE NAME ...Temporary Business Access detail.dgn	USER NAME Plotted by Scott	DESIGNED -	REVISED -	STATE OF ILLINOIS DEPARTMENT OF TRANSPORTATION	TEMPORARY BUSINESS ACCESS DETAIL			F.A.P. RTE. 668	SECTION 28R-1	COUNTY SANGAMON	TOTAL SHEETS 354	SHEET NO. 101
MODELNAME	PLOT SCALE 1/8" = 100'	CHECKED -	REVISED -		SCALE:	SHEET 1	OF 1	SHEETS	STA.	TO STA.	CONTRACT NO. 72501	
	PLOT DATE	DATE 05-09-13	REVISED -		ILLINOIS FED. AID PROJECT							