

F.A.P. RTE.	SECTION	COUNTY	TOTAL SHEETS	SHEET NO.
668	28R-1	SANGAMON	354	108
STA. 6+262.5		TO STA. 6+437.5		
FED. ROAD DIST. NO.		ILLINOIS	FED. AID PROJECT	
CONTRACT NO. 72501				

FINAL SURVEY PLOTTED	BY	DATE
NOTE BOOK TEMPLATE AREAS CHECKED		
NO.		

MATCH LINE STA. 6+262.5
SEE SHEET 107

MATCH LINE STA. 6+437.5
SEE SHEET 109

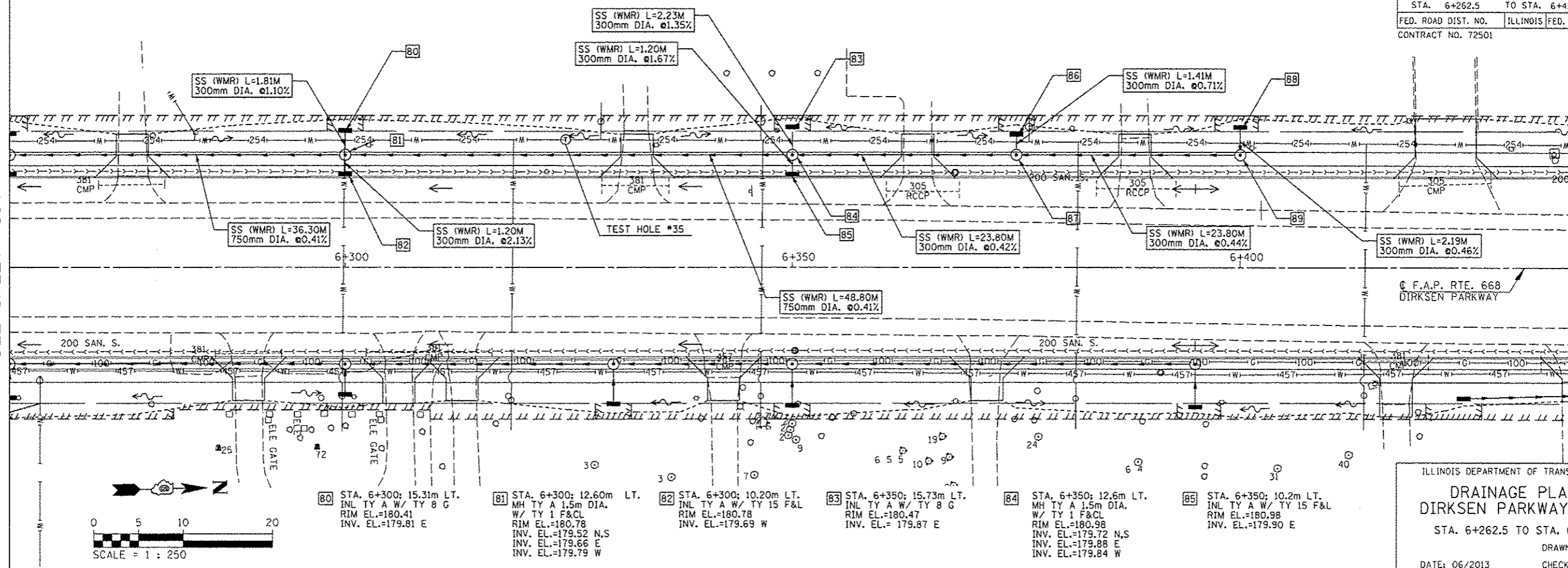

ILLINOIS DEPARTMENT OF TRANSPORTATION
DRAINAGE PLANS
DIRKSEN PARKWAY - LT
STA. 6+262.5 TO STA. 6+437.5
DRAWN BY: GE
DATE: 06/2013
CHECKED BY: FML

- 80 STA. 6+300; 15.31m LT. INL TY A W/ TY 8 G RIM EL.=180.41 INV. EL.=179.81 E
- 81 STA. 6+300; 12.60m LT. MH TY A 1.5m DIA. W/ TY 1 F&CL RIM EL.=180.78 INV. EL.=179.52 N,S INV. EL.=179.66 E INV. EL.=179.79 W
- 82 STA. 6+300; 10.20m LT. INL TY A W/ TY 15 F&L RIM EL.=180.78 INV. EL.=179.69 W
- 83 STA. 6+350; 15.73m LT. INL TY A W/ TY 8 G RIM EL.=180.47 INV. EL.=179.87 E
- 84 STA. 6+350; 12.6m LT. MH TY A 1.5m DIA. W/ TY 1 F&CL RIM EL.=180.98 INV. EL.=179.72 N,S INV. EL.=179.88 E INV. EL.=179.84 W
- 85 STA. 6+350; 10.2m LT. INL TY A W/ TY 15 F&L RIM EL.=180.98 INV. EL.=179.90 E
- 86 STA. 6+375; 14.91m LT. INL TY A W/ TY 8 G RIM EL.=180.67 INV. EL.=180.07 E
- 87 STA. 6+375; 12.60m LT. MH TY A 1.2m DIA. W/ TY 1 F&CL RIM EL.=181.01 INV. EL.=179.82 N,S INV. EL.=180.06 W
- 88 STA. 6+400; 15.69m LT. INL TY A W/ TY 8 G RIM EL.=180.49 INV. EL.=179.93 E
- 89 STA. 6+400; 12.60m LT. MH TY A 1.2m DIA. W/ TY 1 F&CL RIM EL.=181.03 INV. EL.=179.92 S,W

ORIGINAL SURVEY PLOTTED	BY	DATE
NOTE BOOK TEMPLATE AREAS CHECKED		
NO.		

