

F.A.P. RTE.	SECTION	COUNTY	TOTAL SHEETS	SHEET NO.
668	28R-1	SANGAMON	354	114
STA.		TO STA.		
FED. ROAD DIST. NO.		ILLINOIS	FED. AID PROJECT	
CONTRACT NO. 72501				

DATE	BY
FINAL SURVEY PLOTTED	
NOTE BOOK TEMPLATE	
AREAS CHECKED	
NO.	

MATCH LINE STA. 5+750
SEE SHEET 113

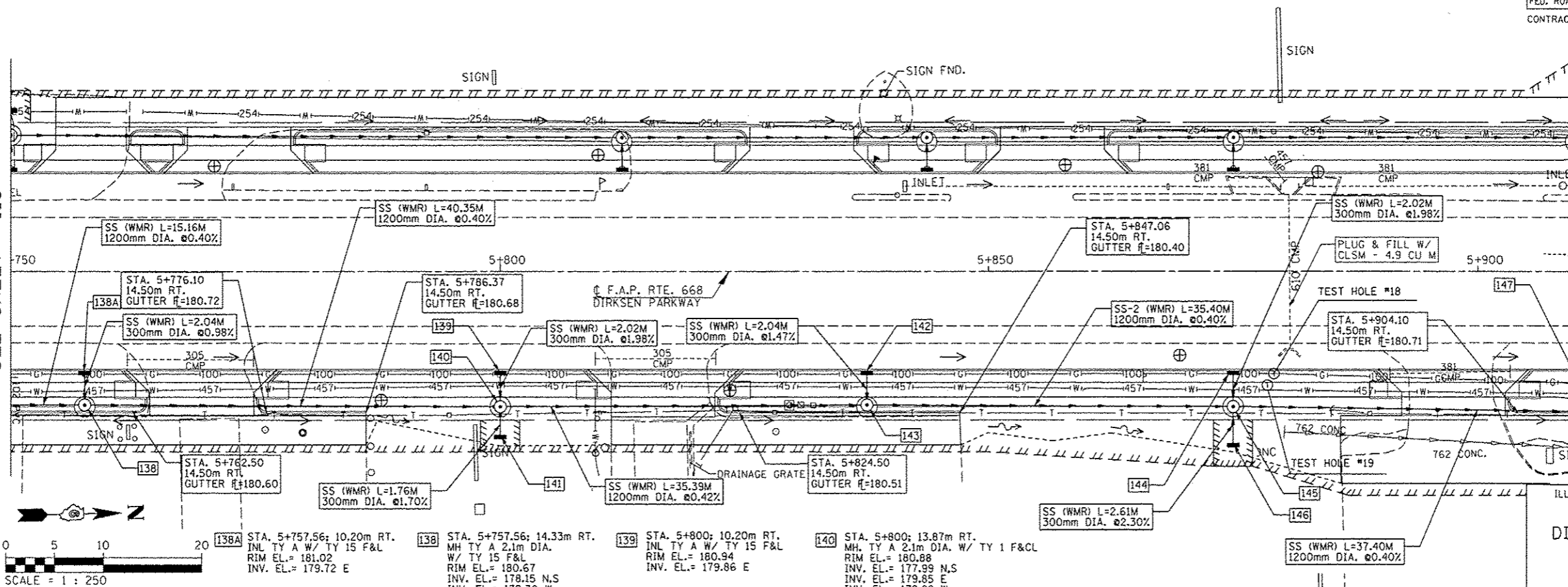

MATCH LINE STA. 5+910
SEE SHEET 115

ILLINOIS DEPARTMENT OF TRANSPORTATION
DRAINAGE PLANS
DIRKSEN PARKWAY - RT
STA. 5+750 TO STA. 5+910

DRAWN BY: GE
CHECKED BY: FML

DATE: 06/2013

- [141] STA. 5+800; 16.98m RT. INL TY A W/ TY 8 G RIM EL.= 180.48 INV. EL.= 179.88 W
- [142] STA. 5+837.50; 10.20m RT. INL TY A W/ TY 15 F&L RIM EL.= 180.87 INV. EL.= 179.82 E
- [143] STA. 5+837.50; 14.32m RT. MH TY A 2.1m DIA. W/ TY 15 F&L RIM EL.= 180.61 INV. EL.= 177.85 N, S INV. EL.= 179.79 W
- [144] STA. 5+875; 10.20m RT. INL TY A W/ TY 15 F&L RIM EL.= 180.80 INV. EL.= 179.72 E
- [145] STA. 5+875; 13.87m RT. MH TY A 2.1m DIA. W/ TY 1 F&CL RIM EL.= 180.72 INV. EL.= 177.71 N,S INV. EL.=179.41 E INV. EL.=179.68 W
- [146] STA. 5+875; 17.83m RT. INL TY A W/ TY 8 G RIM EL.= 180.12 INV. EL.= 179.46 W
- [147] STA. 5+910; 10.20m RT. INL TY A W/ TY 15 F&L RIM EL.= 180.74 INV. EL.= 179.69 NE

DATE	BY
ORIGINAL SURVEY PLOTTED	
NOTE BOOK TEMPLATE	
AREAS CHECKED	
NO.	

