

|                     |                   |                  |              |           |
|---------------------|-------------------|------------------|--------------|-----------|
| F.A.P. RTE.         | SECTION           | COUNTY           | TOTAL SHEETS | SHEET NO. |
| 668                 | 28R-1             | SANGAMON         | 354          | 135       |
| STA. 6+405.000      | TO STA. 6+580.000 |                  |              |           |
| FED. ROAD DIST. NO. | ILLINOIS          | FED. AID PROJECT |              |           |
| CONTRACT NO. 72501  |                   |                  |              |           |

SEC 25, T16N, R5W, 3RD P.M.

|                                  |    |
|----------------------------------|----|
| DATE                             | BY |
|                                  |    |
| FINAL SURVEY PLOTTED             |    |
| NOTE BOOK TEMPLATE AREAS CHECKED |    |
| NO.                              |    |

|                                  |    |
|----------------------------------|----|
| DATE                             | BY |
|                                  |    |
| ORIGINAL SURVEY PLOTTED          |    |
| NOTE BOOK TEMPLATE AREAS CHECKED |    |
| NO.                              |    |

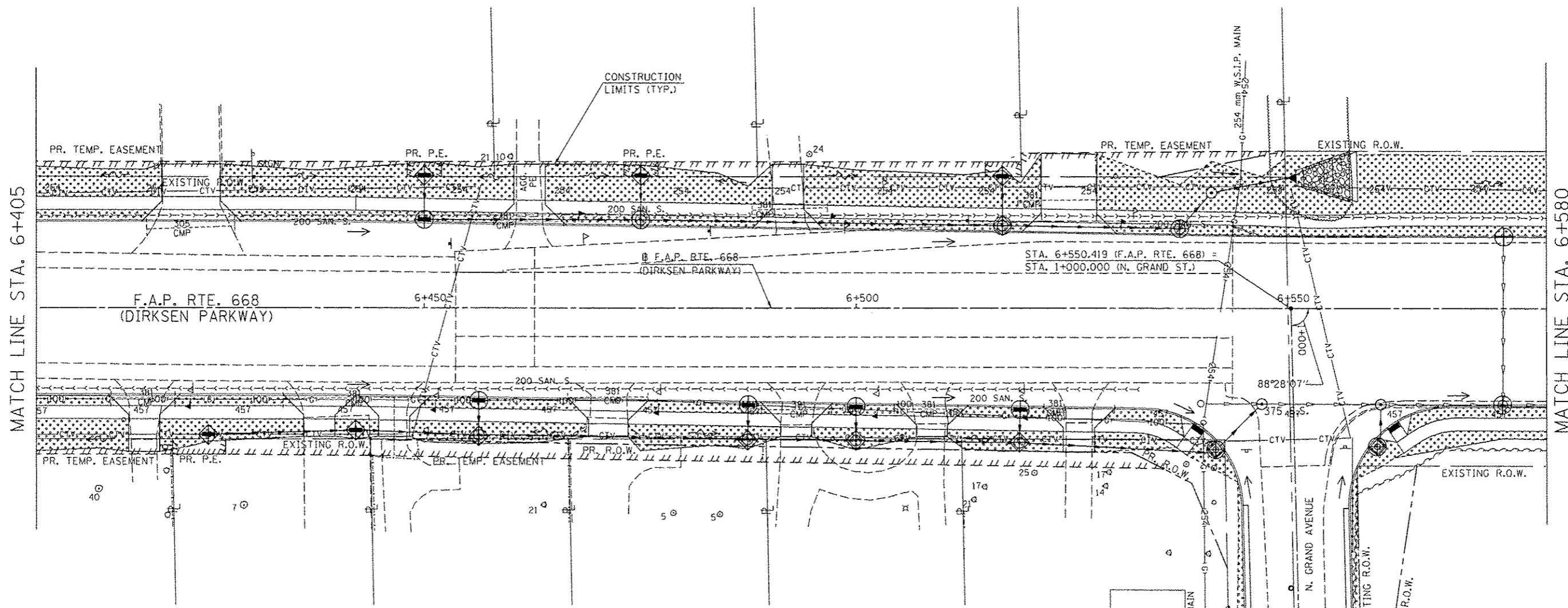

**LEGEND**

- SEEDING, CLASS 1 W/ MULCH, METHOD 3
- TEMPORARY DITCH CHECK
- INLET & PIPE PROTECTION
- INLET FILTER
- STONE RIPRAP CLASS A3
- SEEDING, CLASS 1 W/ HEAVY DUTY EROSION CONTROL BLANKET

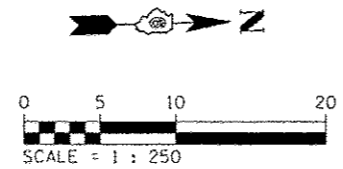

| REVISIONS |      |
|-----------|------|
| NAME      | DATE |
|           |      |
|           |      |
|           |      |
|           |      |
|           |      |
|           |      |
|           |      |

ILLINOIS DEPARTMENT OF TRANSPORTATION  
 EROSION CONTROL PLANS  
 F.A.P. ROUTE 668 (DIRKSEN PARKWAY)  
 SECTION 28R-1  
 SANGAMON COUNTY

SCALE 1 : 250  
 DATE 06/2013

DRAWN BY RK  
 CHECKED BY SEW

LIMITS OF IMPROVEMENT  
 STA. 1+059.289