

F.A.P. RTE.	SECTION	COUNTY	TOTAL SHEETS	SHEET NO.
668	28R-1	SANGAMON	354	147
STA.		TO STA.		
FED. ROAD DIST. NO.		ILLINOIS FED. AID PROJECT		
CONTRACT NO. 72501				

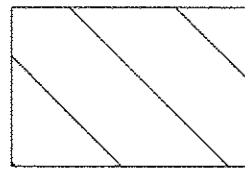

MAINTAIN MAINLINE PROFILE AND CROSS SECTION

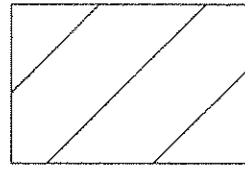

MAINTAIN SIDE ROAD PROFILE AND CROSS SECTION

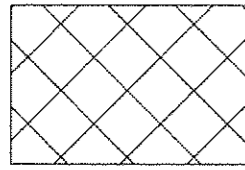

TRANSITION SIDE STREET

GENERAL NOTES:

1. MAINTAIN THE PROFILE AND CROSS SECTION OF DIRKSEN PARKWAY THROUGH THE INTERSECTION.
2. TRANSITION THE APPROACH PAVEMENTS OF NORTH GRAND AVE. WITHIN THE RADIUS RETURNS TO THE ELEVATIONS AS SHOWN ON THIS SHEET.
3. SEE DRAINAGE PLANS FOR STATION, OFFSET, AND ELEVATION INFORMATION FOR PROPOSED CURB AND GUTTER SECTIONS BEYOND PROPOSED SIDEWALK. ALL CURB AND GUTTER POINTS ARE CALLED OUT TO THE TOP OF FACE OF CURB.

E.O.P. ELEVATIONS ON CURVE

NUMBER	DIRKSEN PARKWAY			NORTH GRAND AVENUE			ELEVATION
	STATION	OFFSET	SIDE	STATION	OFFSET	SIDE	
A1	6+568.467	11.311	RIGHT	1+011.789	17.739	LEFT	179.818
A2	6+564.034	12.299	RIGHT	1+012.658	13.281	LEFT	179.857
A3	6+560.322	14.912	RIGHT	1+015.171	9.500	LEFT	179.970
A4	6+557.896	18.748	RIGHT	1+018.941	6.973	LEFT	180.160
A5	6+557.129	23.218	RIGHT	1+023.389	6.086	LEFT	180.273
B1	6+544.943	22.894	RIGHT	1+022.739	6.086	RIGHT	180.253
B2	6+543.943	18.483	RIGHT	1+018.303	6.968	RIGHT	180.089
B3	6+541.334	14.792	RIGHT	1+014.543	9.478	RIGHT	180.005
B4	6+537.514	12.378	RIGHT	1+012.029	13.232	RIGHT	180.080
B5	6+533.540	11.606	RIGHT	1+011.150	17.183	RIGHT	180.147
C1				1+011.464	0.0		180.013
C2				1+015.248	0.0		180.048
C3				1+019.032	0.0		180.232
C4				1+022.816	0.0		180.346
C5				1+023.320	0.0		180.354

NOTES:

1. POINT NO. 1 & NO. 5 ON CURVE ARE THE END POINTS OF CURVE.
2. STATION EQUATION: STATION 6+030.021 BK = STATION 6+027.285 AH

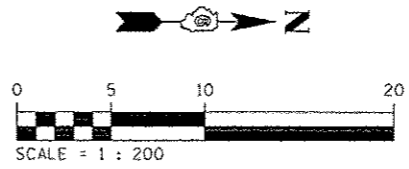
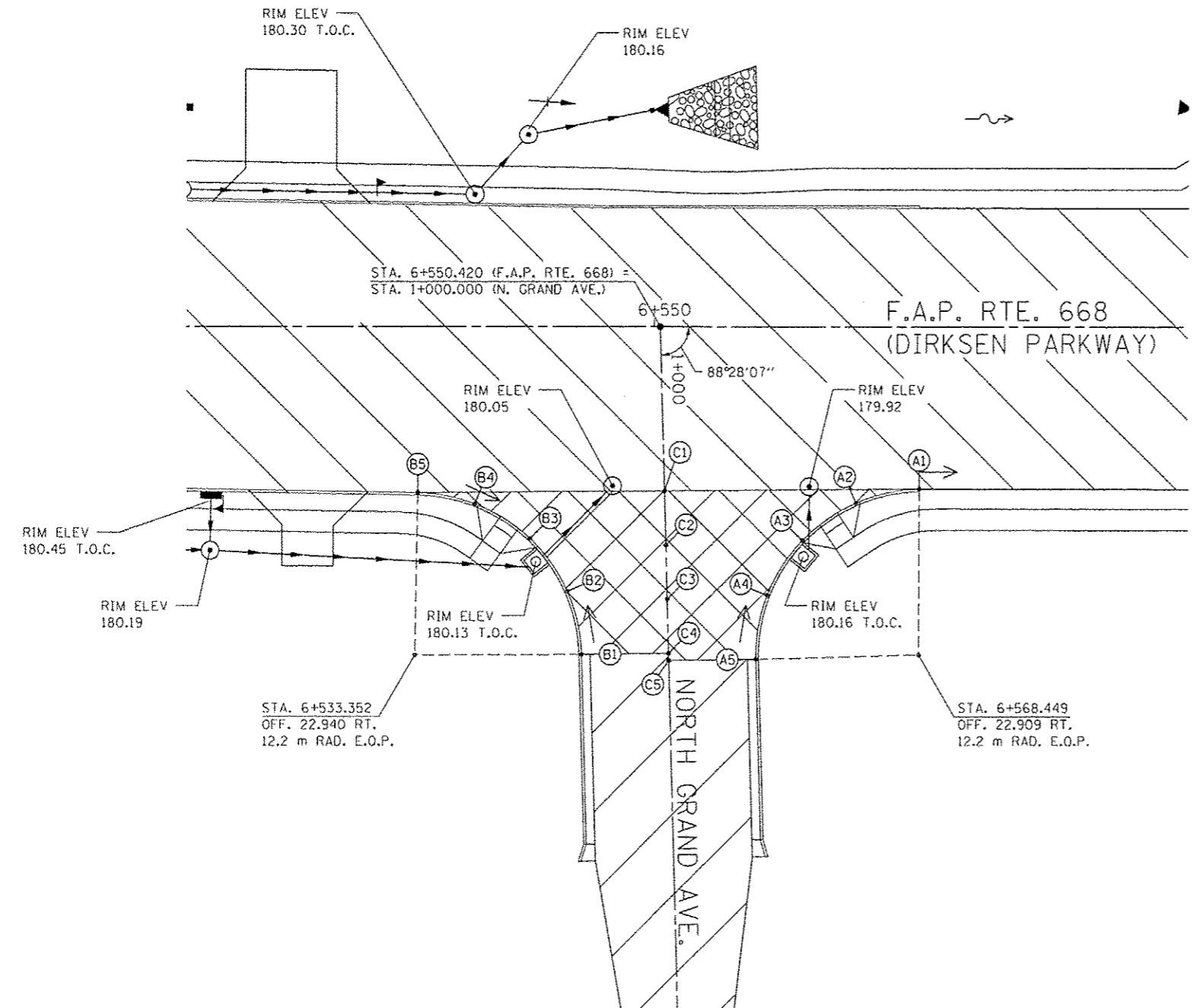

REVISIONS		ILLINOIS DEPARTMENT OF TRANSPORTATION INTERSECTION DETAILS NORTH GRAND AVENUE F.A. ROUTE 668 (DIRKSEN PARKWAY) SECTION 28I-2 SANGAMON COUNTY DRAWN BY: RK CHECKED BY: SEW
NAME	DATE	

NORTH GRAND AVENUE