

LOGAN COUNTY

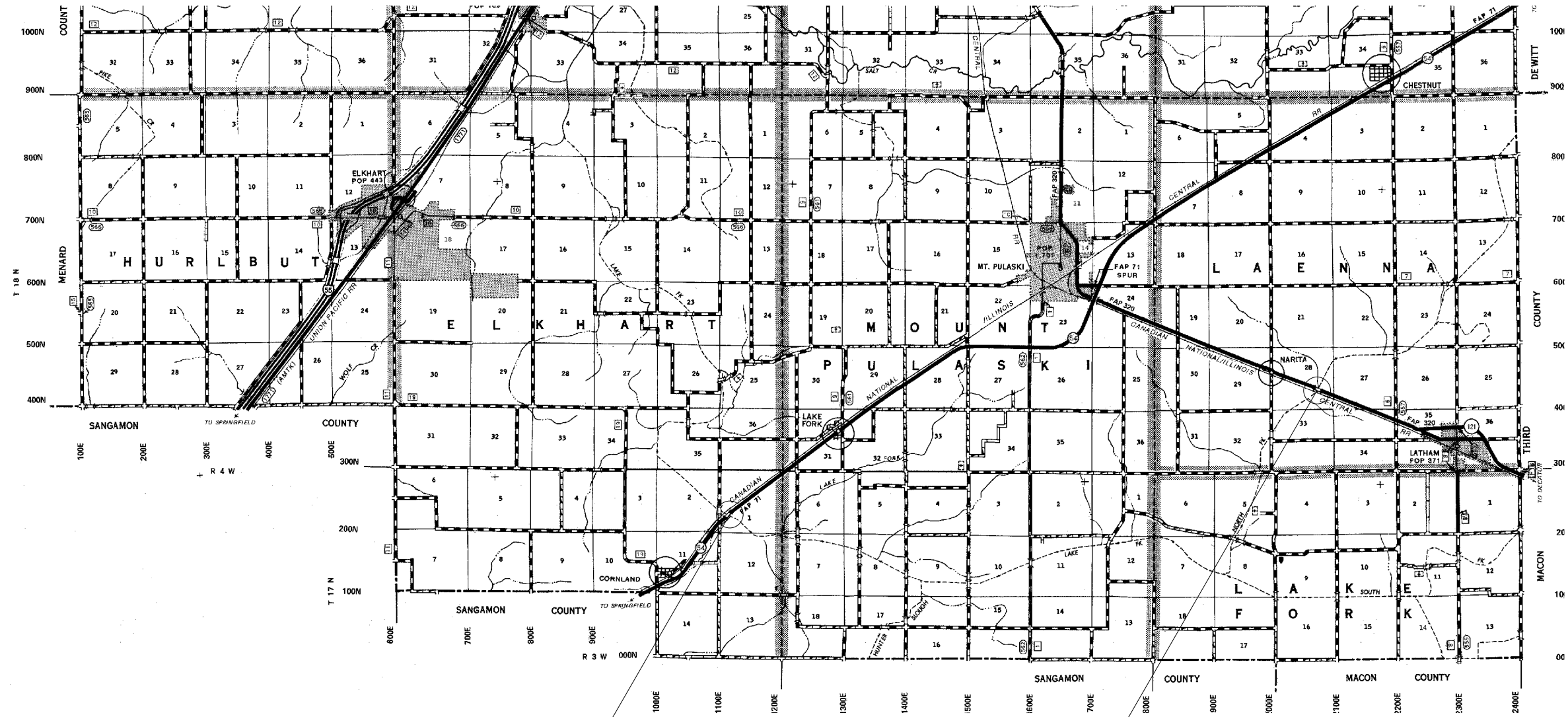

SN 054-0031 OVER
LAKE FORK CREEK

SN 054-0022 OVER
NORTH BRANCH LAKE FORK

- D6 BDGE DECK SEALING 2014-2
- LOGAN, CHRISTIAN, MONTGOMERY

| | | | |
|---|------------------------------------|------------|-----------|
| FILE NAME = | USER NAME = sparksgw | DESIGNED - | REVISED - |
| ct:\pw\work\p\dot\sparksgw\10289421\06xxx-sht-LOGAN.L.dgn | | DRAWN - | REVISED - |
| | PLOT SCALE = 40.0000' / in. | CHECKED - | REVISED - |
| | PLOT DATE = Oct-25-2013 03:05:22PM | DATE - | REVISED - |

**STATE OF ILLINOIS
DEPARTMENT OF TRANSPORTATION**

BRIDGE LOCATION MAP LOGAN COUNTY

SCALE: SHEET 3 OF 3 SHEETS STA. TO STA.

| F.A. RTE. | SECTION | COUNTY | TOTAL SHEETS | SHEET NO. |
|---------------------------|---------|------------|--------------|-----------|
| VAR | • | •• VARIOUS | 14 | 9 |
| CONTRACT NO. 72E26 | | | | |
| ILLINOIS FED. AID PROJECT | | | | |