

NOTE

1. THE PROPOSED MAST ARM AND ALL ITS TRAFFIC SIGNAL EQUIPMENT SHALL BE INSTALLED PRIOR TO REMOVING THE EXISTING MAST ARM AND ALL ITS TRAFFIC SIGNAL EQUIPMENT. THIS WORK SHALL BE COMPLETED PRIOR TO END OF THE WORKING DAY;
2. WHILE TURNING ON THE PROPOSED SIGNALS, THE INTERSECTION SHALL BE PLACED ON 'FLASHING RED' MODE. IN ADDITION, PORTABLE STOP SIGNS SHALL BE INSTALLED ON EACH APPROACH;
3. EXISTING TRAFFIC SIGNALS SHALL BE COVERED/TURNED WHILE PROPOSED TRAFFIC SIGNALS ARE TURNED ON;

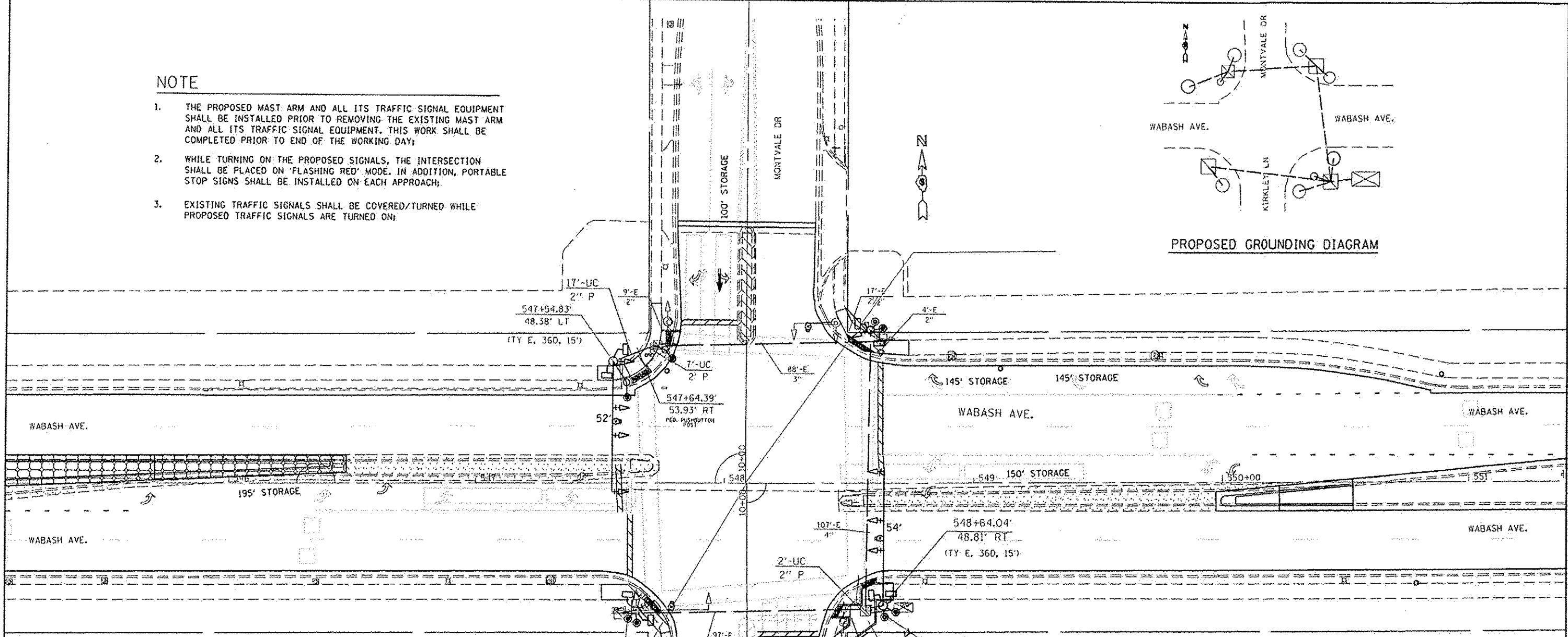
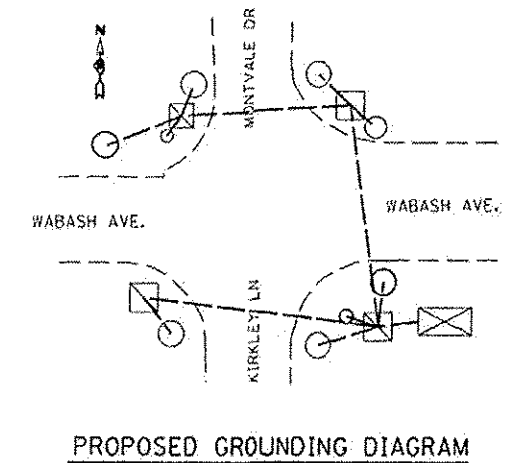

BILL OF MATERIALS: WABASH & KIRKLEY/MONTVALE

CODE NO.	ITEM	UNIT	TOTAL QUANTITY
81028350	UNDERGROUND CONDUIT, PVC, 2" DIA.	FOOT	31
85000200	MAINTENANCE OF EXISTING TRAFFIC SIGNAL INSTALLATION	EACH	1
87300010	GROUNDING EXISTING HANDHOLE FRAME AND COVER.	EACH	4
87301245	ELECTRIC CABLE IN CONDUIT, SIGNAL NO. 14 5C	FOOT	1445
87301705	ELECTRIC CABLE IN CONDUIT, COMMUNICATION NO. 18 3 PAIR	FOOT	690
87301900	ELECTRIC CABLE IN CONDUIT, EQUIPMENT GROUNDING CONDUCTOR, NO. 6 1C	FOOT	455
87502700	TRAFFIC SIGNAL POST, ALUMINUM 16FT.	EACH	1
87600100	PEDESTRIAN PUSH-BUTTON POST, TYPE I	EACH	2
87700300	STEEL MAST ARM ASSEMBLY AND POLE, 52 FT.	EACH	1
87700310	STEEL MAST ARM ASSEMBLY AND POLE, 54 FT.	EACH	1
87800100	CONCRETE FOUNDATION, TYPE A	FOOT	3
87800415	CONCRETE FOUNDATION, TYPE E 38-INCH DIAMETER	FOOT	30
87900200	DRILL EXISTING HANDHOLE	EACH	4
88040070	SIGNAL HEAD, POLYCARBONATE, LED, 1-FACE, 3-SECTION, BRACKET MOUNTED	EACH	1
88040090	SIGNAL HEAD, POLYCARBONATE, LED, 1-FACE, 3-SECTION, MAST ARM MOUNTED	EACH	4
88040110	SIGNAL HEAD, POLYCARBONATE, LED, 1-FACE, 4-SECTION, BRACKET MOUNTED	EACH	2
88040120	SIGNAL HEAD, POLYCARBONATE, LED, 1-FACE, 4-SECTION, MAST ARM MOUNTED	EACH	2

88102845	PEDESTRIAN SIGNAL HEAD, POLYCARBONATE, LED, 2-FACE, BRACKET MOUNTED WITH COUNT DOWN TIMER	EACH	5
88200510	TRAFFIC SIGNAL BACKPLATE, RETROREFLECTIVE	EACH	9
88800100	PEDESTRIAN PUSH-BUTTON	EACH	8
89502200	MODIFY EXISTING CONTROLLER	EACH	1
89502210	MODIFY EXISTING CONTROLLER CABINET	EACH	1
89502300	REMOVE ELECTRIC CABLE FROM CONDUIT	FOOT	845
89502375	REMOVE EXISTING TRAFFIC SIGNAL EQUIPMENT.	EACH	27
89502385	REMOVE EXISTING CONCRETE FOUNDATION	EACH	3
X8140115	HANDHOLE TO BE ADJUSTED	EACH	3
20010688	CAMERA MOUNTING ASSEMBLY	EACH	4
20033072	VIDEO VEHICLE DETECTION SYSTEM	EACH	1

REVISED SHEET 12-27-13