

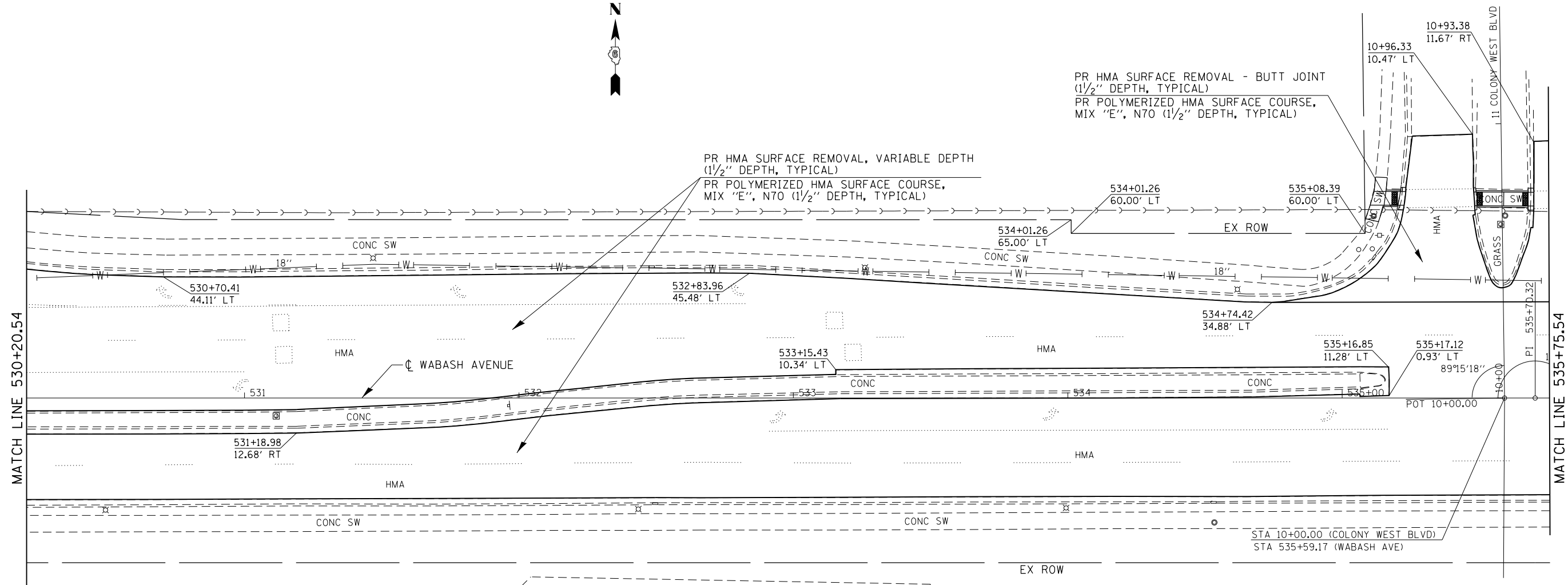

PR HMA SURFACE REMOVAL - BUTT JOINT  
 (1/2" DEPTH, TYPICAL)  
 PR POLYMERIZED HMA SURFACE COURSE,  
 MIX "E", N70 (1/2" DEPTH, TYPICAL)

PR HMA SURFACE REMOVAL, VARIABLE DEPTH  
 (1/2" DEPTH, TYPICAL)  
 PR POLYMERIZED HMA SURFACE COURSE,  
 MIX "E", N70 (1/2" DEPTH, TYPICAL)



FILE NAME =	USER NAME = sparksgw	DESIGNED -	RTS	REVISED -	
c:\pw\work\p\idot\sparksgw\10296742\06729-sht-plan.dgn		DRAWN -	RTS	REVISED -	
Default	PLOT SCALE = 40.0000' / in.	CHECKED -		REVISED -	
	PLOT DATE = Nov-08-2013 12:08:43PM	DATE -		REVISED -	

**STATE OF ILLINOIS  
 DEPARTMENT OF TRANSPORTATION**

**PLAN SHEET - WABASH AVE.**

SCALE: SHEET 8 OF 21 SHEETS STA. TO STA.

F.A.P. RTE.	SECTION	COUNTY	TOTAL SHEETS	SHEET NO.
664	(GRS-15,TS-9,(21)RS-9,TS-2	SANGAMON	126	43
CONTRACT #72F29				
ILLINOIS FED. AID PROJECT				