

PAVEMENT MARKING LEGEND	
①	THERMOPLASTIC PAVEMENT MARKING - LINE 5"
②	THERMOPLASTIC PAVEMENT MARKING - LINE 5" (DOUBLE YELLOW)
③	THERMOPLASTIC PAVEMENT MARKING - LINE 6"
④	THERMOPLASTIC PAVEMENT MARKING - LINE 6" (6' SKIP, 2' DASH)
⑤	THERMOPLASTIC PAVEMENT MARKING - LINE 8"
⑥	THERMOPLASTIC PAVEMENT MARKING - LINE 12"
⑦	PREFORMED PLASTIC PAVEMENT MARKING, TYPE B - INLAID - 24" LINE
⑧	THERMOPLASTIC PAVEMENT MARKING - LINE 5" (30' SKIP, 10' DASH)
↶	PREFORMED PLASTIC PAVEMENT MARKING, TYPE B - INLAID - LETTERS AND SYMBOLS (WHITE)
▷	RAISED REFLECTIVE PAVEMENT MARKER (ONE-WAY CRYSTAL)
▷	RAISED REFLECTIVE PAVEMENT MARKER (ONE-WAY AMBER)
◆	RAISED REFLECTIVE PAVEMENT MARKER (TWO-WAY AMBER)
○-W	PAVEMENT MARKING, WHITE
○-Y	PAVEMENT MARKING, YELLOW

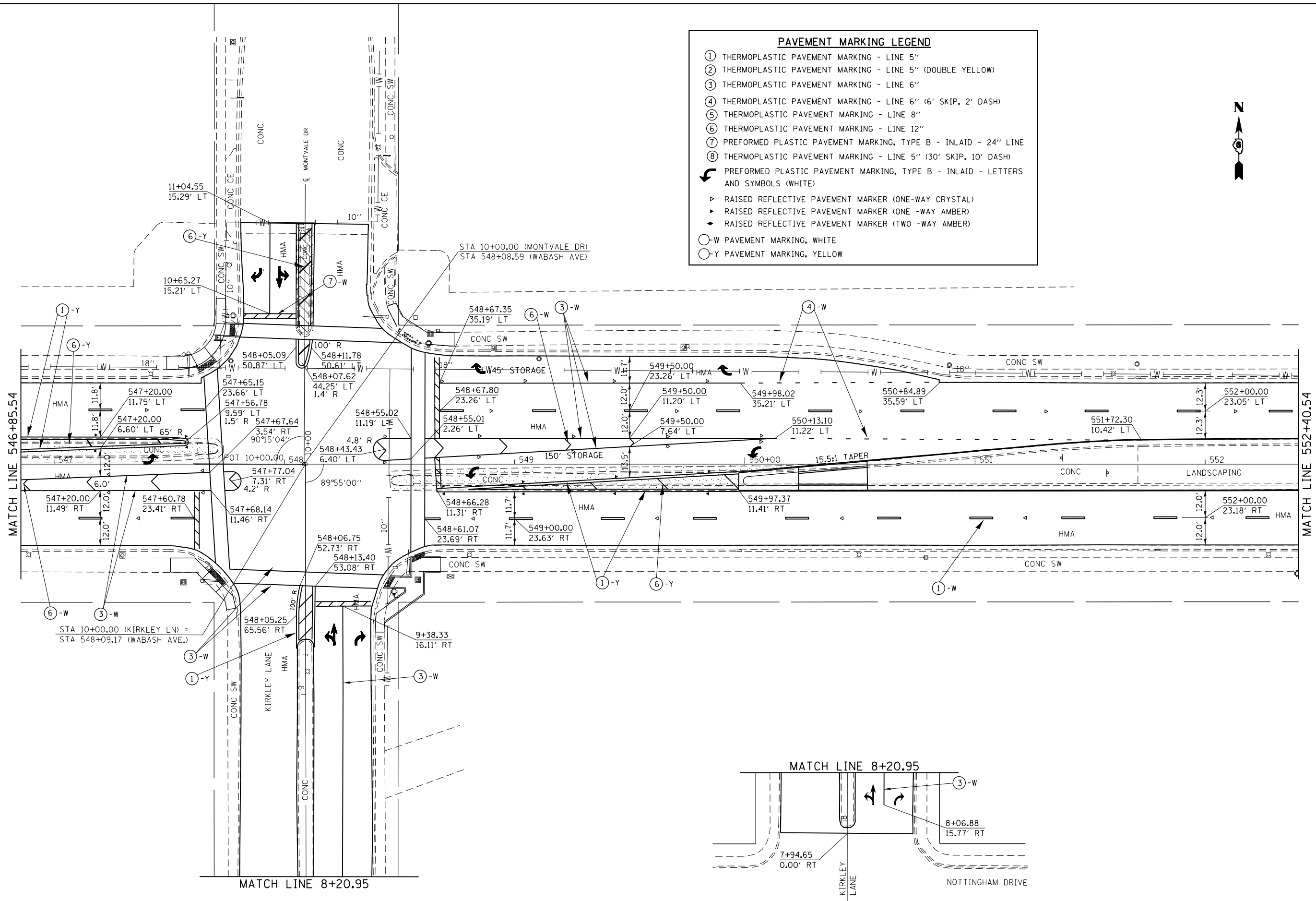

FILE NAME =	USER NAME = sparksgw	DESIGNED -	RTS	REVISED -	
et:\pw\work\p\idot\sparksgw\10296742\06729-sh-t-pmk.dgn		DRAWN -	RTS	REVISED -	
Default		PLOT SCALE =	40.0000' / in.	CHECKED -	
		PLOT DATE =	Nov-08-2013 12:08:59PM	DATE -	10-11-2013

**STATE OF ILLINOIS
DEPARTMENT OF TRANSPORTATION**

PAVEMENT MARKING - WABASH AVE.			
SCALE:	SHEET 11 OF 21 SHEETS	STA.	TO STA.

F.A.P. RTE.	SECTION	COUNTY	TOTAL SHEETS	SHEET NO.
664	.	SANGAMON	126	67
ILLINOIS FED. AID PROJECT			CONTRACT NO. 72F29	