

STATE OF ILLINOIS
DEPARTMENT OF TRANSPORTATION
DIVISION OF HIGHWAYS

**PROPOSED
HIGHWAY PLANS**

F.A.P. ROUTE 327 (U.S. RTE. 45/50)
SECTION D7 HMA RESURF 2014-2

RESURFACING
CLAY COUNTY
C-97-076-13

FOR INDEX OF SHEETS, SEE SHEET NO. 2

ADT = 6500 (2008)

F.A.P. RTE.	SECTION	COUNTY	TOTAL SHEETS	SHEET NO.
327	D7 HMA RESURF 2014-2	CLAY	26	1
		ILLINOIS	CONTRACT NO. 74630	

D-97-030-13

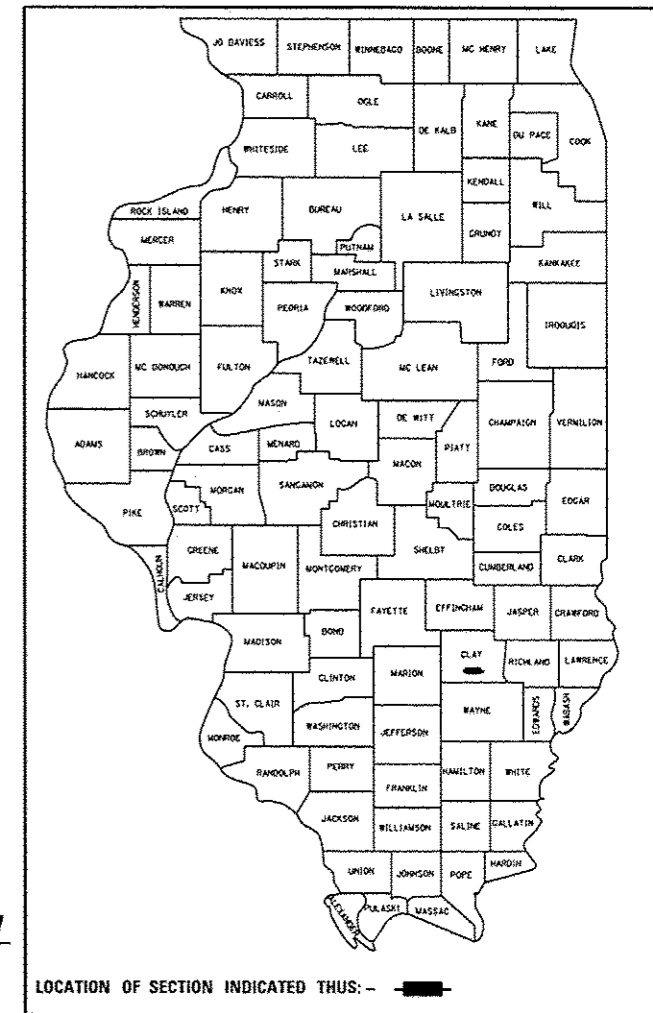

BEGINNING STA. 589 + 54

ENDING STA. 645 + 61.7

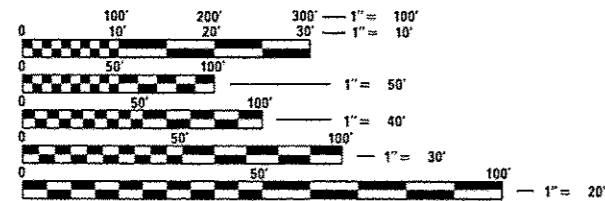
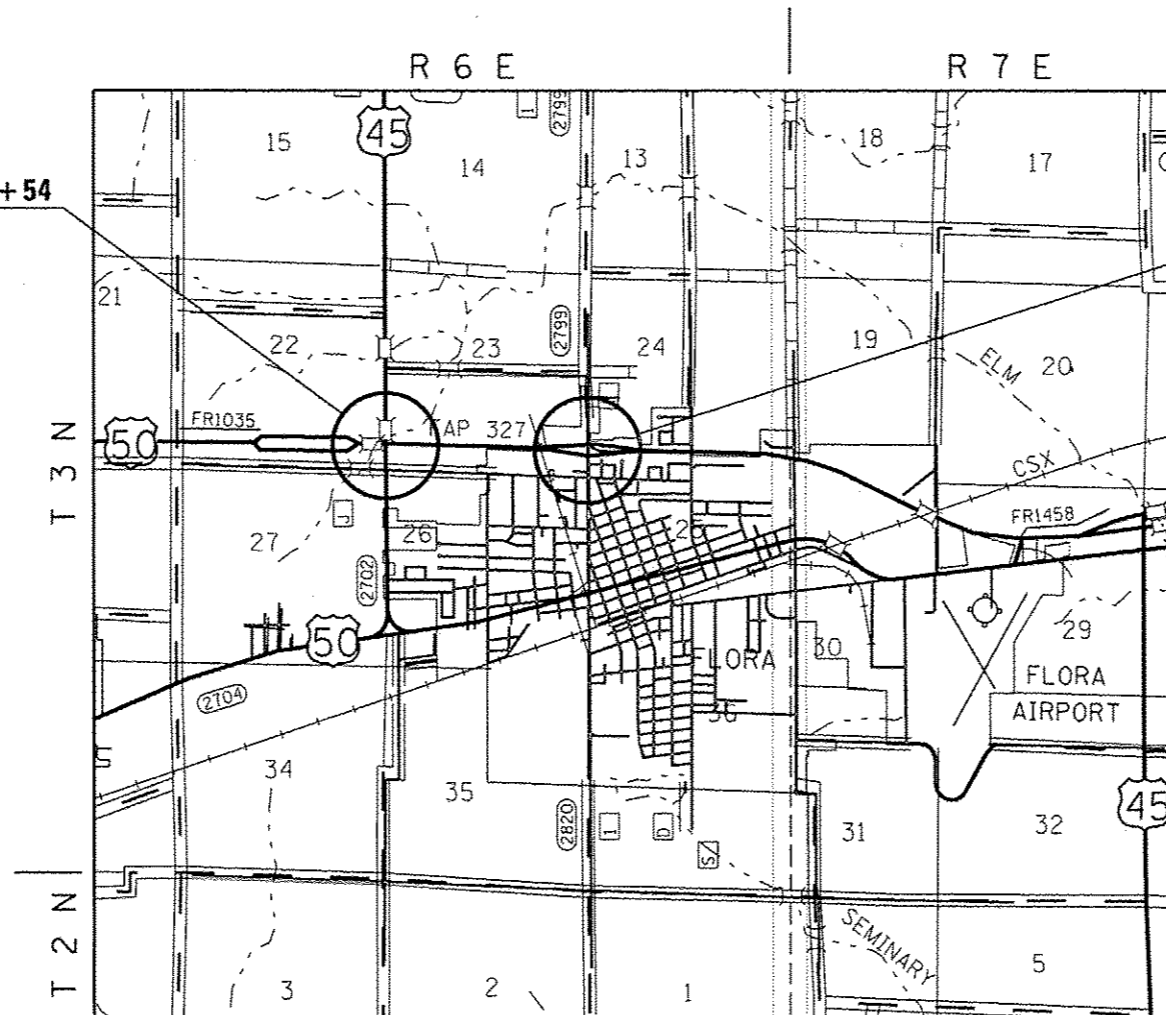

FULL SIZE PLANS HAVE BEEN PREPARED USING STANDARD ENGINEERING SCALES. REDUCED SIZED PLANS WILL NOT CONFORM TO STANDARD SCALES. IN MAKING MEASUREMENTS ON REDUCED PLANS, THE ABOVE SCALES MAY BE USED.

J.U.L.I.E.
JOINT UTILITY LOCATION INFORMATION FOR EXCAVATION
1-800-892-0123
OR 811

PROJECT ENGINEER: TOM RONAN
PROJECT MANAGER: ROSS BIERMAN
PHONE: (217)-342-8320
CONTRACT NO. 74630

GROSS LENGTH = 5607.7 FT. = 1.06 MILE
NET LENGTH = 5607.7 FT. = 1.06 MILE

STATE OF ILLINOIS
DEPARTMENT OF TRANSPORTATION
DIVISION OF HIGHWAYS

SUBMITTED Sept 26 20 13
Roma L. Driskell
DEPUTY DIRECTOR OF HIGHWAYS, REGION ENGINEER

Dec 6 20 13
John D. Baranzelli, P.E.
ENGINEER OF DESIGN AND ENVIRONMENT

Dec 6 20 13
Omer Osman, P.E.
DIRECTOR OF HIGHWAYS, CHIEF ENGINEER

PRINTED BY THE AUTHORITY
OF THE STATE OF ILLINOIS

INDEX OF SHEETS

SHEET NO.	ITEM
1	COVER SHEET
2	INDEX OF SHEETS AND GENERAL NOTES
3-4	SUMMARY OF QUANTITIES
5-8	TYPICAL SECTIONS
9	SCHEDULE OF QUANTITIES
10-19	PLANS
20-21	DETECTOR LOOPS
22-25	PAVEMENT MARKING AND RAISED REFLECTIVE PAVEMENT MARKERS DETAILS
26	RUMBLE STRIP DETAIL

THE FOLLOWING STANDARDS ARE A PART OF THESE PLANS AND ARE INCLUDED AFTER SHEET NO. 26:

STD. NO.	DESCRIPTION
00001-06	STANDARD SYMBOLS, ABBREVIATIONS AND PATTERNS
442201-03	CLASS C AND D PATCHES
701001-02	OFF-ROAD OPERATIONS, 2L, 2W, MORE THAN 15' AWAY
701006-05	OFF-RD OPERATIONS, 2L, 2W, 15' TO 24" FROM PAVEMENT EDGE
701201-04	LANE CLOSURE, 2L, 2W, DAY ONLY
701301-04	LANE CLOSURE, 2L, 2W, SHORT TIME OPERATIONS
701306-03	LANE CLOSURE, 2L, 2W, SLOW MOVING OPERATIONS DAY ONLY, FOR SPEEDS >= 45 MPH
701311-03	LANE CLOSURE 2L, 2W, MOVING OPERATIONS - DAY ONLY
701336-06	LANE CLOSURE, 2L, 2W, WORK AREAS IN SERIES, FOR SPEEDS >= 45 MPH
701901-03	TRAFFIC CONTROL DEVICES
780001-04	TYPICAL PAVEMENT MARKINGS
781001-03	TYPICAL APPLICATIONS RAISED REFLECTIVE PAVEMENT MARKERS

GENERAL NOTES

THIS SECTION SHALL BE CONSTRUCTED IN ACCORDANCE WITH THE PLANS; THE "STANDARD SPECIFICATIONS FOR ROAD AND BRIDGE CONSTRUCTION" ADOPTED JANUARY 1, 2012; AND THE SPECIAL PROVISIONS INCLUDED IN THE PROPOSAL.

THIS PROJECT IS LOCATED ON FAP ROUTE 327 IN CLAY COUNTY, BEGINNING AT THE INTERSECTION OF ROUTE 45 AND US ROUTE 50 AND EXTENDING APPROXIMATELY 1 MILE TO THE EAST ON US ROUTE 50 TO THE INTERSECTION OF US ROUTE 50 AND MAIN STREET IN FLORA.

PAVEMENT MARKING SHALL BE APPLIED IN ACCORDANCE WITH SECTION 780 OF THE STANDARD SPECIFICATIONS. SHORT TERM PAVEMENT MARKING SHALL BE APPLIED TO THE MILLED SURFACE AND HOT-MIX ASPHALT SURFACE COURSE AS SPECIFIED IN SECTION 703 OF THE STANDARD SPECIFICATIONS. TEMPORARY TAPE SHALL BE USED ON THE SURFACE COURSE AND PAINT SHALL BE USED ON THE MILLED SURFACE.

THE TOTAL QUANTITY OF THERMOPLASTIC PAVEMENT MARKING-LINE 4" CONSISTS OF 11,328 FEET OF WHITE AND 6,166 FEET OF YELLOW.

THE TOTAL QUANTITY OF THERMOPLASTIC PAVEMENT MARKING-LINE 6" CONSISTS OF 1,366 FEET OF WHITE AND 459 FEET OF YELLOW.

THE TOTAL QUANTITY OF THERMOPLASTIC PAVEMENT MARKING-LINE 24" CONSISTS OF 304 FEET OF WHITE.

THE TOTAL QUANTITY OF RAISED REFLECTIVE PAVEMENT MARKERS CONSISTS OF 22 CRYSTAL ONE-WAY MARKERS, 70 AMBER ONE-WAY MARKERS, AND 59 TWO-WAY AMBER MARKERS.

THE EXISTING PAVEMENT SHALL BE PATCHED IN ACCORDANCE WITH SECTION 442 OF THE STANDARD SPECIFICATIONS AND THE SPECIAL PROVISIONS. THE QUANTITY OF PATCHING SHOWN ON THE PLANS IS AN ESTIMATE ONLY AND THE FINAL LOCATIONS AND QUANTITY SHALL BE DETERMINED BY THE ENGINEER IN THE FIELD.

THE PAY ITEM TEMPORARY RAMP HAS BEEN INCLUDED FOR THE CONSTRUCTION OF TEMPORARY RAMPS IN ACCORDANCE WITH ARTICLE 406.08 OF THE STANDARD SPECIFICATIONS. THE COST SHALL INCLUDE BOTH THE INSTALLATION AND THE REMOVAL OF THE TEMPORARY RAMPS.

THE RESIDENT ENGINEER SHALL BE THE SOLE JUDGE CONCERNING THE CURING TIME FOR THE VARIOUS HOT-MIX ASPHALT PAY ITEMS.

VIBRATORY ROLLERS IN DYNAMIC MODE WILL NOT BE PERMITTED EAST OF THE INTERSECTION OF WORTHY ST. AND US 50. DENSITY REQUIREMENTS MUST STILL BE MET.

THE CONTRACTOR SHALL PROVIDE INTERNET ACCESSIBILITY TO THE HOT-MIX ASPHALT PLANT QUALITY CONTROL LAB SO THAT HOT-MIX ASPHALT PLANT REPORTS CAN BE E-MAILED TO THE DISTRICT HEADQUARTERS. THIS WORK SHALL BE INCLUDED IN THE COST OF ALL HOT-MIX ASPHALT ITEMS.

THE CONTRACTOR SHALL USE EITHER RC-70, SS1H, OR SS-1HP, APPLIED AT THE RATE DIRECTED BY THE ENGINEER, FOR THE PAY ITEM BITUMINOUS MATERIALS (PRIME COAT).

A UNIFORMLY STRAIGHT SAW CUT SHALL BE MADE AT LOCATIONS WHERE PROPOSED NEW CONSTRUCTION WILL ABUT EXISTING HOT-MIX ASPHALT SURFACES. THE SAW CUT SHALL BE MADE FULL DEPTH THROUGH THE EXISTING SURFACE. THIS WORK WILL BE CONSIDERED INCLUDED IN THE COST OF THE CONTRACT ITEMS INVOLVED AND NO EXTRA COMPENSATION WILL BE ALLOWED.

THE FOLLOWING MIXTURE REQUIREMENTS ARE APPLICABLE FOR THIS PROJECT:

MIXTURE USE: SURFACE COURSE (1 1/2") AND INCIDENTAL SURFACING (1 1/2")
 APPLICATION: POLYMERIZED HOT-MIX ASPHALT SURFACE COURSE, MIX "D" N90
 PG GRADE: SBS PG 70-22
 DESIGN AIR VOIDS: 4.0% @ NDESIGN = 90
 MIXTURE COMPOSITION: 1L-9.5
 FRICTION AGGREGATE: MIXTURE D

MIXTURE USE: PAVEMENT PATCHING
 APPLICATION: HOT-MIX ASPHALT BINDER COURSE
 PG GRADE: PG 64-22
 DESIGN AIR VOIDS: 4.0% @ NDESIGN = 70
 MIXTURE COMPOSITION: 1L-19.0
 FRICTION AGGREGATE: N/A

THE FOLLOWING RATES OF APPLICATION HAVE BEEN USED IN THE CALCULATING PLAN QUANTITIES:

BITUMINOUS MATERIALS (PRIME COAT) 0.10 GAL/SQ YD
 AGGREGATE (PRIME COAT) 4 LBS/SQ YD
 HOT-MIX ASPHALT 112 LBS/SQ YD/INCH

FILE NAME :	USER NAME :	DESIGNED :	REVISED :	STATE OF ILLINOIS DEPARTMENT OF TRANSPORTATION	INDEX OF SHEETS AND GENERAL NOTES	F.A.P. RTE:	SECTION	COUNTY	TOTAL SHEETS	SHEET NO.
cr:\pav\work\pav\dot\stef\annik\d0348176\07	stefannik	DRAWN :	REVISED :			327	07 HMA RESURF 2014-2	CLAY	26	2
Default		CHECKED :	REVISED :			CONTRACT NO. 74630				
		DATE :	REVISED :			ILLINOIS FED. AID PROJECT				

SUMMARY OF QUANTITIES			URBAN TOTAL QUANTITIES	CONSTRUCTION TYPE CODE	
CODE NO	ITEM	UNIT		100% STATE 0005	
40600100	BITUMINOUS MATERIALS (PRIME COAT)	GALLON	2243	2243	
40600300	AGGREGATE (PRIME COAT)	TON	45	45	
40600990	TEMPORARY RAMP	SQ YD	321	321	
40603545	POLYMERIZED HOT-MIX ASPHALT SURFACE COURSE, MIX "D", N90	TON	1650	1650	
40800050	INCIDENTAL HOT-MIX ASPHALT SURFACING	TON	234	234	
44000155	HOT-MIX ASPHALT SURFACE REMOVAL, 1 1/2"	SQ YD	19645	19645	
44201798	CLASS D PATCHES, TYPE I, 13 INCH	SQ YD	42	42	
44201803	CLASS D PATCHES, TYPE II, 13 INCH	SQ YD	133	133	
44201807	CLASS D PATCHES, TYPE III, 13 INCH	SQ YD	172	172	
44201809	CLASS D PATCHES, TYPE IV, 13 INCH	SQ YD	640	640	
67100100	MOBILIZATION	L SUM	1	1	
70100450	TRAFFIC CONTROL AND PROTECTION, STANDARD 701201	L SUM	1	1	

SUMMARY OF QUANTITIES			URBAN TOTAL QUANTITIES	CONSTRUCTION TYPE CODE	
CODE NO	ITEM	UNIT		100% STATE 0005	
70100460	TRAFFIC CONTROL AND PROTECTION, STANDARD 701306	L SUM	1	1	
70300100	SHORT TERM PAVEMENT MARKING	FOOT	4780	4780	
70300210	TEMPORARY PAVEMENT MARKING LETTERS AND SYMBOLS	SQ FT	359	359	
70300220	TEMPORARY PAVEMENT MARKING - LINE 4"	FOOT	17494	17494	
70300240	TEMPORARY PAVEMENT MARKING - LINE 6"	FOOT	1825	1825	
70300280	TEMPORARY PAVEMENT MARKING - LINE 24"	FOOT	304	304	
70301000	WORK ZONE PAVEMENT MARKING REMOVAL	SQ FT	797	797	
78000100	THERMOPLASTIC PAVEMENT MARKING - LETTERS AND SYMBOLS	SQ FT	359	359	
78000200	THERMOPLASTIC PAVEMENT MARKING - LINE 4"	FOOT	17494	17494	
78000400	THERMOPLASTIC PAVEMENT MARKING - LINE 6"	FOOT	1825	1825	
78000650	THERMOPLASTIC PAVEMENT MARKING - LINE 24"	FOOT	304	304	
78100100	RAISED REFLECTIVE PAVEMENT MARKER	EACH	151	151	

* SPECIALTY ITEM

EXISTING TYPICAL CROSS SECTION

U.S. ROUTE 50
 STA. 589+54 TO STA. 609+51
 STA. 627+26 TO STA. 629+90.7

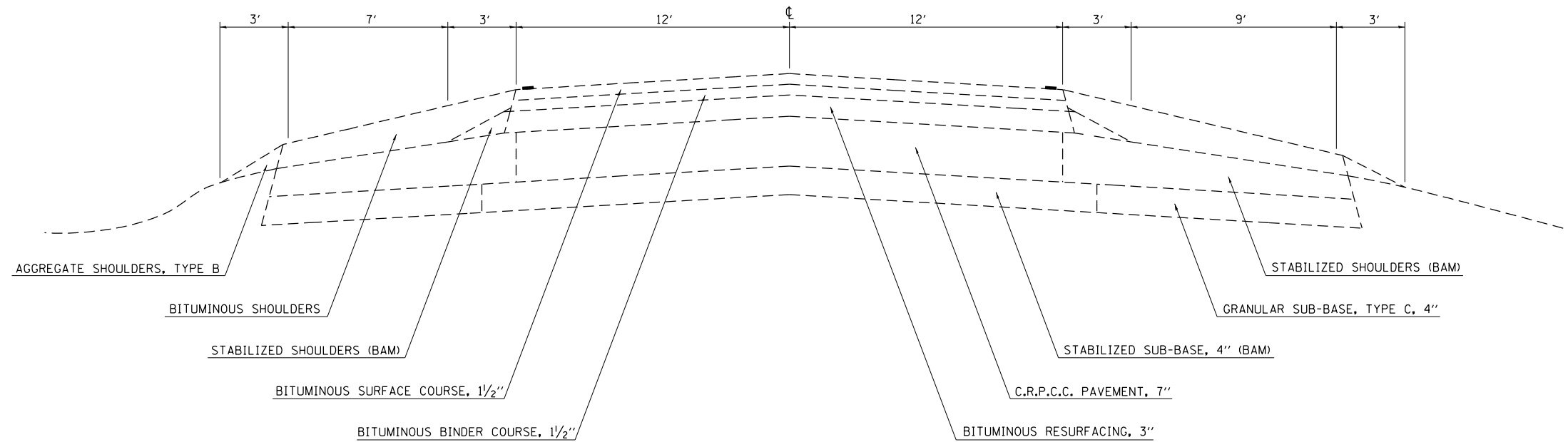

NOTE: NOT TO SCALE

EXISTING TYPICAL CROSS SECTION

U.S. ROUTES 50 & 45
 STA. 609+51.00 TO STA. 627+26

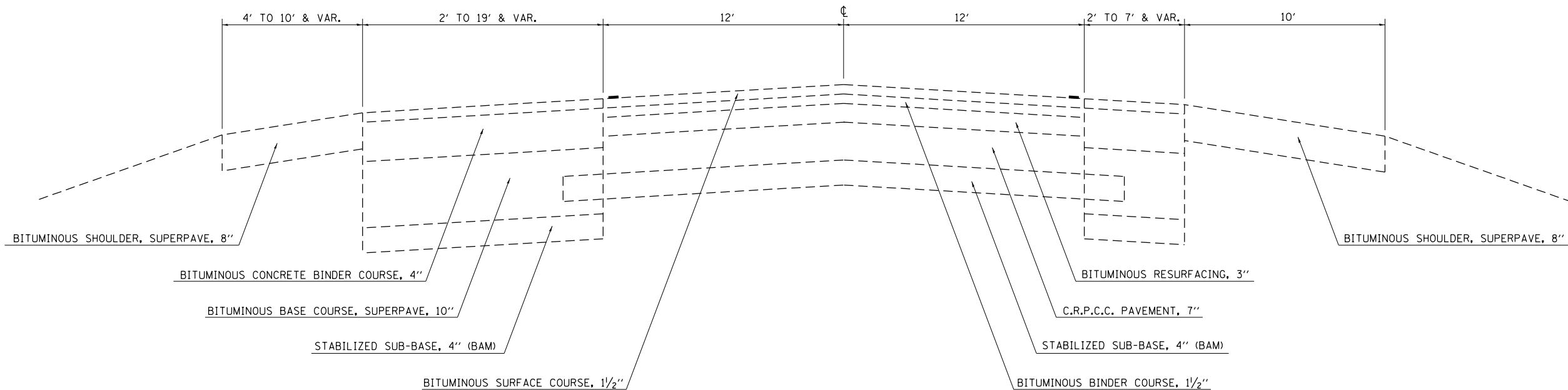

NOTE: NOT TO SCALE

FILE NAME =	USER NAME = steffenmk	DESIGNED -	REVISED -
c:\pwork\pwork\stevfennk\d0348176\074630-sh-typical.dgn		DRAWN -	REVISED -
		CHECKED -	REVISED -
		DATE -	REVISED -

STATE OF ILLINOIS
 DEPARTMENT OF TRANSPORTATION

EXISTING TYPICAL CROSS SECTIONS

SCALE: N/A SHEET 1 OF 4 SHEETS STA. TO STA.

F.A.P. RTE.	SECTION	COUNTY	TOTAL SHEETS	SHEET NO.
327	D7 HMA RESURF 2014-2	CLAY	26	5
CONTRACT NO. 74630			ILLINOIS FED. AID PROJECT	

EXISTING TYPICAL CROSS SECTION

U.S. ROUTE 50
STA. 629+90.7 TO STA. 634+67.7

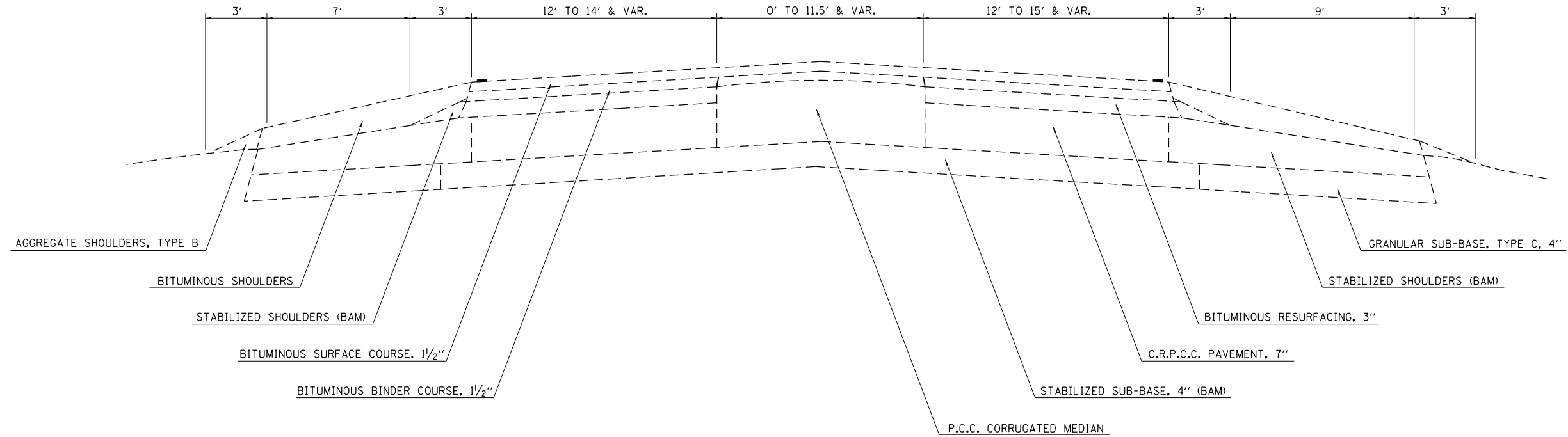

NOTE: NOT TO SCALE

EXISTING TYPICAL CROSS SECTION

U.S. ROUTE 50
STA. 634+67.7 TO STA. 645+61.7

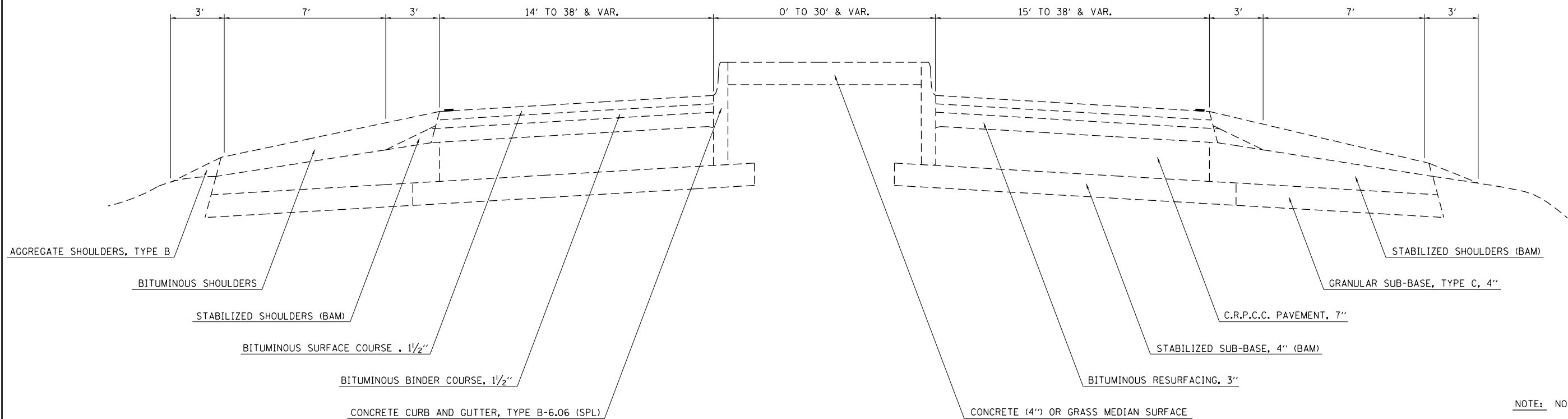

NOTE: NOT TO SCALE

FILE NAME =	USER NAME = steffenmk	DESIGNED -	REVISED -
c:\pwork\pwork\stevfenmk\d0348176\074630-sh-typical.dgn		DRAWN -	REVISED -
	PLOT SCALE = 100.0000' / 1in.	CHECKED -	REVISED -
Default	PLOT DATE = 10/1/2013	DATE -	REVISED -

STATE OF ILLINOIS
DEPARTMENT OF TRANSPORTATION

EXISTING TYPICAL CROSS SECTIONS

SCALE: N/A SHEET 2 OF 4 SHEETS STA. TO STA.

F.A.P. RTE.	SECTION	COUNTY	TOTAL SHEETS	SHEET NO.
327	D7 HMA RESURF 2014-2	CLAY	26	6
ILLINOIS FED. AID PROJECT			CONTRACT NO. 74630	

PROPOSED TYPICAL CROSS SECTION

U.S. ROUTE 50
 STA. 589+54 TO STA. 609+51
 STA. 627+26 TO STA. 629+90.7

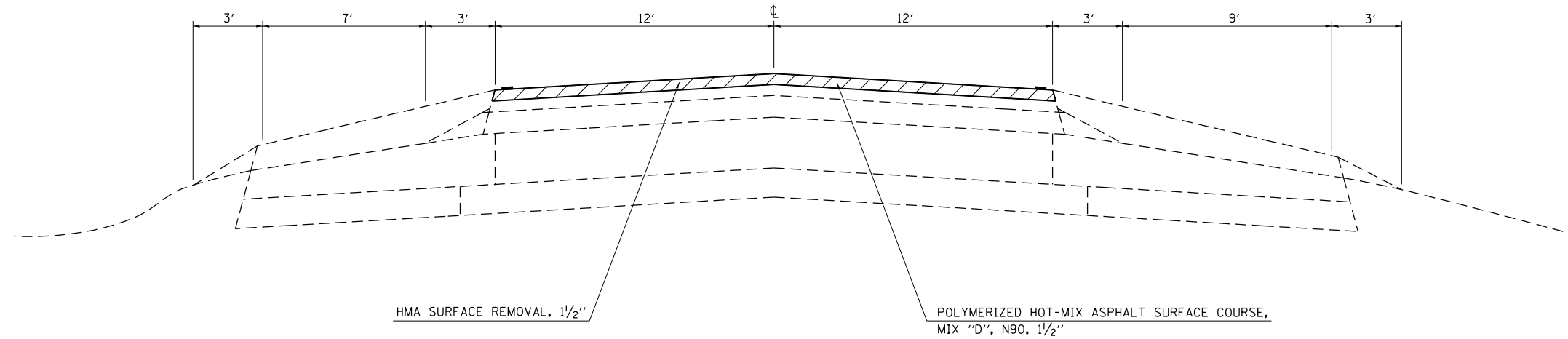

 HMA SURFACE REMOVAL, 1/2"

NOTE: NOT TO SCALE

PROPOSED TYPICAL CROSS SECTION

U.S. ROUTES 50 & 45
 STA. 609+51.00 TO STA. 627+26

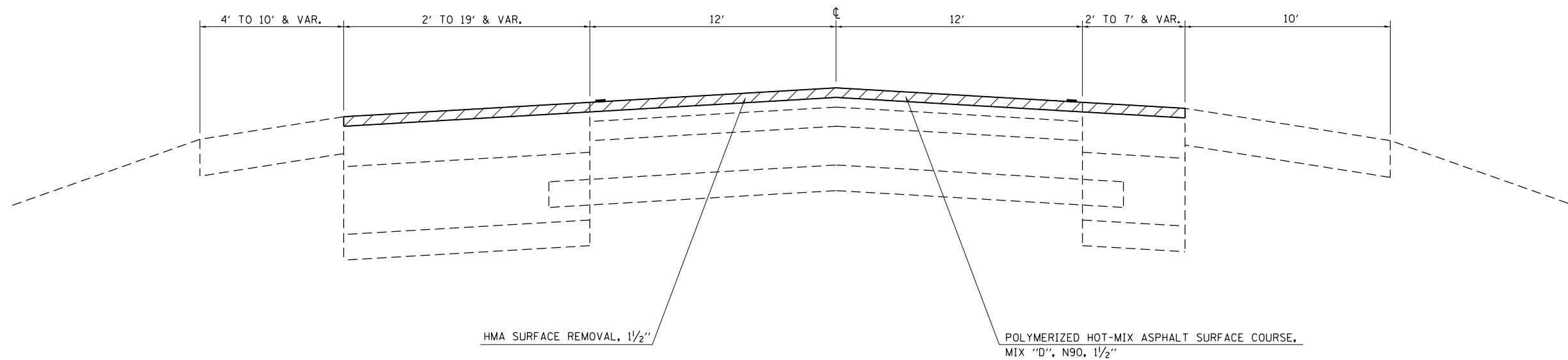

 HMA SURFACE REMOVAL, 1/2"

NOTE: NOT TO SCALE

FILE NAME =	USER NAME = steffenmk	DESIGNED -	REVISED -
c:\pwork\pwork\dot\steffenmk\d0348176\07	74630-sh-typical.dgn	DRAWN -	REVISED -
	PLOT SCALE = 100.0000' / 1in.	CHECKED -	REVISED -
Default	PLOT DATE = 10/1/2013	DATE -	REVISED -

**STATE OF ILLINOIS
 DEPARTMENT OF TRANSPORTATION**

PROPOSED TYPICAL CROSS SECTIONS

SCALE: N/A SHEET 3 OF 4 SHEETS STA. TO STA.

F.A.P. RTE.	SECTION	COUNTY	TOTAL SHEETS	SHEET NO.
327	D7 HMA RESURF 2014-2	CLAY	26	7
CONTRACT NO. 74630			ILLINOIS FED. AID PROJECT	

PROPOSED TYPICAL CROSS SECTION

U.S. ROUTE 50
STA. 629+90.7 TO STA. 634+67.7

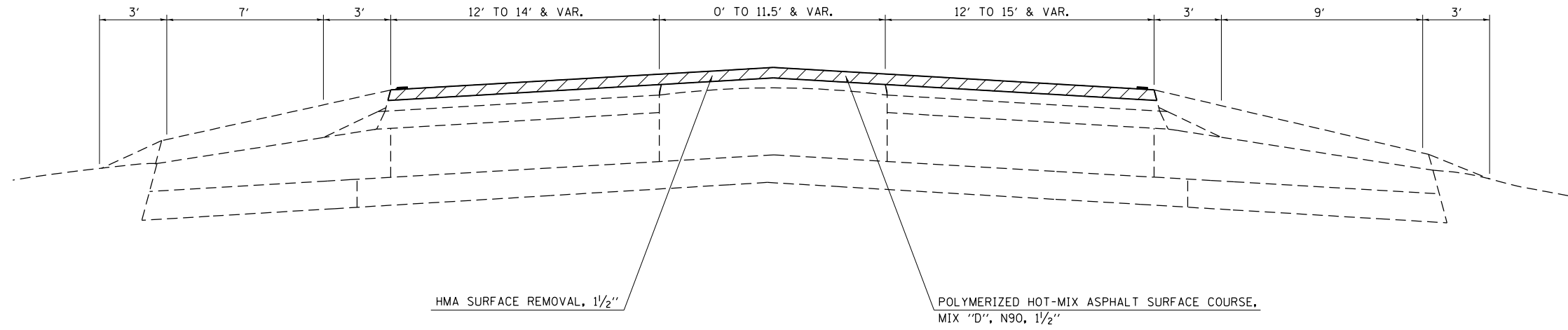

 HMA SURFACE REMOVAL, 1/2"

NOTE: NOT TO SCALE

PROPOSED TYPICAL CROSS SECTION

U.S. ROUTE 50
STA. 634+67.7 TO STA. 645+61.7

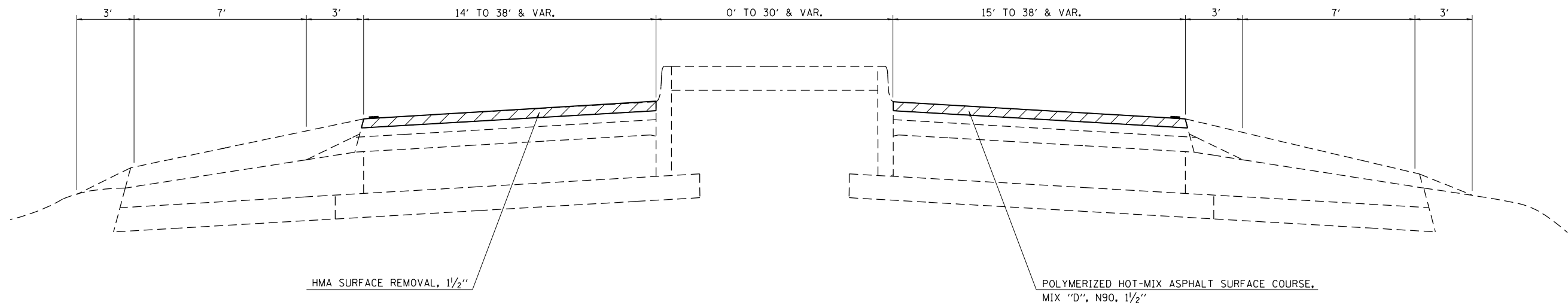

 HMA SURFACE REMOVAL, 1/2"

NOTE: NOT TO SCALE

FILE NAME =	USER NAME = steffenmk	DESIGNED -	REVISED -
c:\pwork\pwork\dot\steffenmk\d0348176\074630-sh-typical.dgn	74630-sh-typical.dgn	DRAWN -	REVISED -
Default	PLOT SCALE = 100.0000' / in.	CHECKED -	REVISED -
	PLOT DATE = 10/1/2013	DATE -	REVISED -

STATE OF ILLINOIS
DEPARTMENT OF TRANSPORTATION

PROPOSED TYPICAL CROSS SECTIONS

SCALE: N/A SHEET 4 OF 4 SHEETS STA. TO STA.

F.A.P. RTE.	SECTION	COUNTY	TOTAL SHEETS	SHEET NO.
327	D7 HMA RESURF 2014-2	CLAY	26	8
CONTRACT NO. 74630			ILLINOIS FED. AID PROJECT	

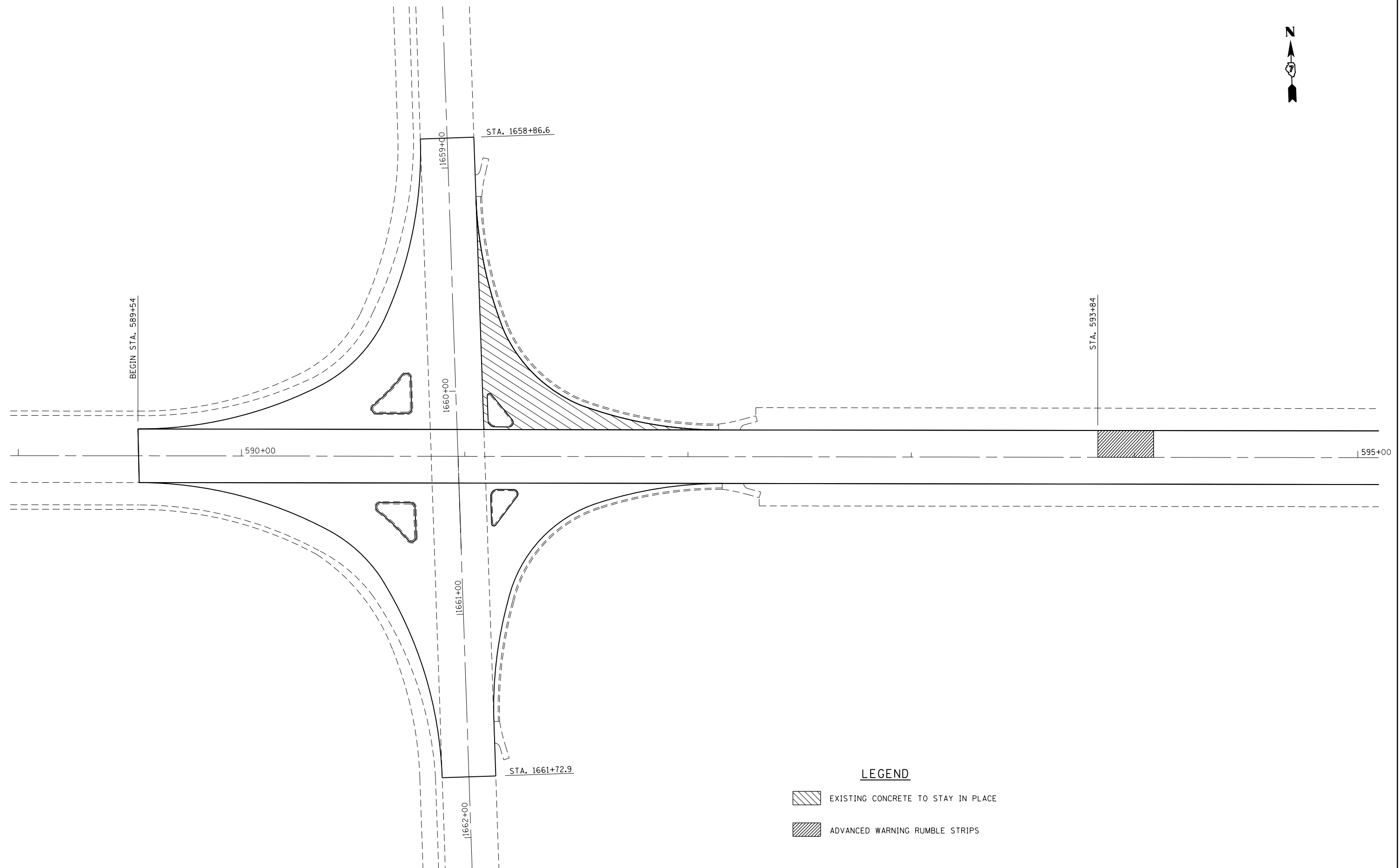

LEGEND

- EXISTING CONCRETE TO STAY IN PLACE
- ADVANCED WARNING RUMBLE STRIPS

FILE NAME =	USER NAME = steffenmk	DESIGNED -	REVISED -
ci:\pw\work\p\idot\stefjenmk\d0348176\074630-sh-t-plan.dgn		DRAWN -	REVISED -
Default	PLOT SCALE = 40.0000' / in.	CHECKED -	REVISED -
	PLOT DATE = 10/1/2013	DATE -	REVISED -

**STATE OF ILLINOIS
DEPARTMENT OF TRANSPORTATION**

PLAN

SCALE: 20 SHEET 1 OF 10 SHEETS STA. 589+00 TO STA. 595+00

F.A.P. RTE.	SECTION	COUNTY	TOTAL SHEETS	SHEET NO.
327	D7 HMA RESURF 2014-2	CLAY	26	10
ILLINOIS FED. AID PROJECT			CONTRACT NO. 74630	

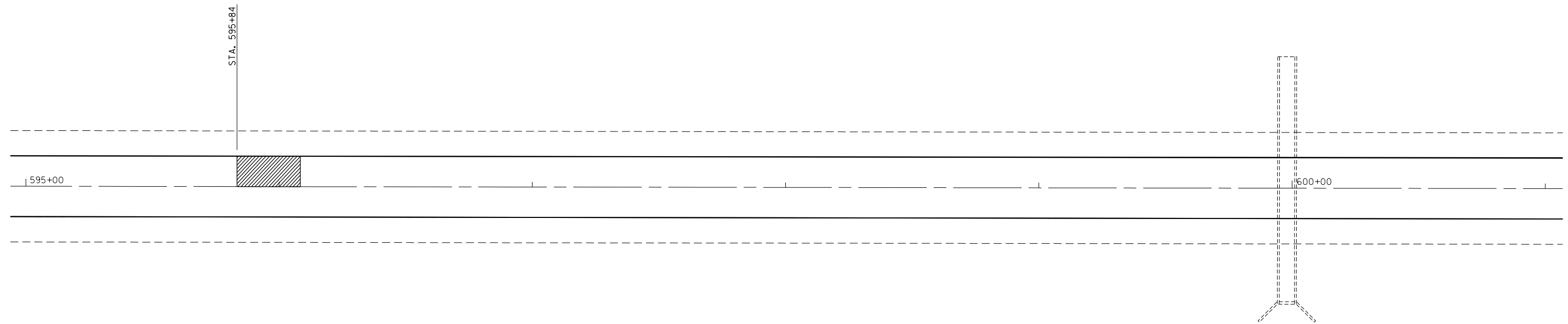

LEGEND

 ADVANCED WARNING RUMBLE STRIPS

FILE NAME =	USER NAME = steffenmk	DESIGNED -	REVISED -	STATE OF ILLINOIS DEPARTMENT OF TRANSPORTATION	PLAN	F.A.P. RTE.	SECTION	COUNTY	TOTAL SHEETS	SHEET NO.
ci:\pw\work\p\dot\steffenmk\d0348176\074630-sh-t-pln.dgn		DRAWN -	REVISED -			327	D7 HMA RESURF 2014-2	CLAY	26	11
Default	PLOT SCALE = 40.0000' / in.	CHECKED -	REVISED -			CONTRACT NO. 74630			ILLINOIS FED. AID PROJECT	
	PLOT DATE = 10/1/2013	DATE -	REVISED -			SCALE: 20	SHEET 2 OF 10 SHEETS	STA. 595+00 TO STA. 601+00		



STA. 604+76

605+00

LEGEND

 ADVANCED WARNING RUMBLE STRIPS

FILE NAME =	USER NAME = steffenmk	DESIGNED -	REVISED -
c:\pw\work\p\dot\stefjenmk\d0348176\074630-sh-t-plan.dgn		DRAWN -	REVISED -
Default	PLOT SCALE = 40.0000' / in.	CHECKED -	REVISED -
	PLOT DATE = 10/1/2013	DATE -	REVISED -

**STATE OF ILLINOIS
DEPARTMENT OF TRANSPORTATION**

PLAN
SCALE: 20 SHEET 3 OF 10 SHEETS STA. 601+00 TO STA. 607+00

F.A.P. RTE.	SECTION	COUNTY	TOTAL SHEETS	SHEET NO.
327	D7 HMA RESURF 2014-2	CLAY	26	12
ILLINOIS FED. AID PROJECT			CONTRACT NO. 74630	

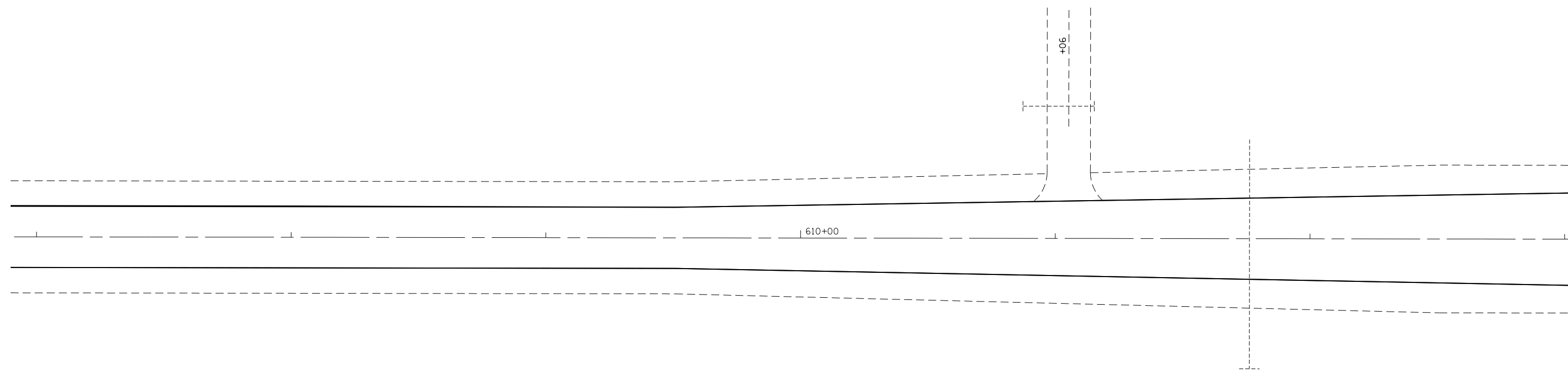

FILE NAME =	USER NAME = steffenmk	DESIGNED -	REVISED -
c:\pw\work\p\dot\stefjenmk\d0348176\07	74630-sh-t-pln.dgn	DRAWN -	REVISED -
Default	PLOT SCALE = 40.0000' / in.	CHECKED -	REVISED -
	PLOT DATE = 10/1/2013	DATE -	REVISED -

**STATE OF ILLINOIS
DEPARTMENT OF TRANSPORTATION**

PLAN

SCALE: 20 SHEET 4 OF 10 SHEETS STA. 607+00 TO STA. 613+00

F.A.P. RTE.	SECTION	COUNTY	TOTAL SHEETS	SHEET NO.
327	D7 HMA RESURF 2014-2	CLAY	26	13
CONTRACT NO. 74630				
ILLINOIS FED. AID PROJECT				

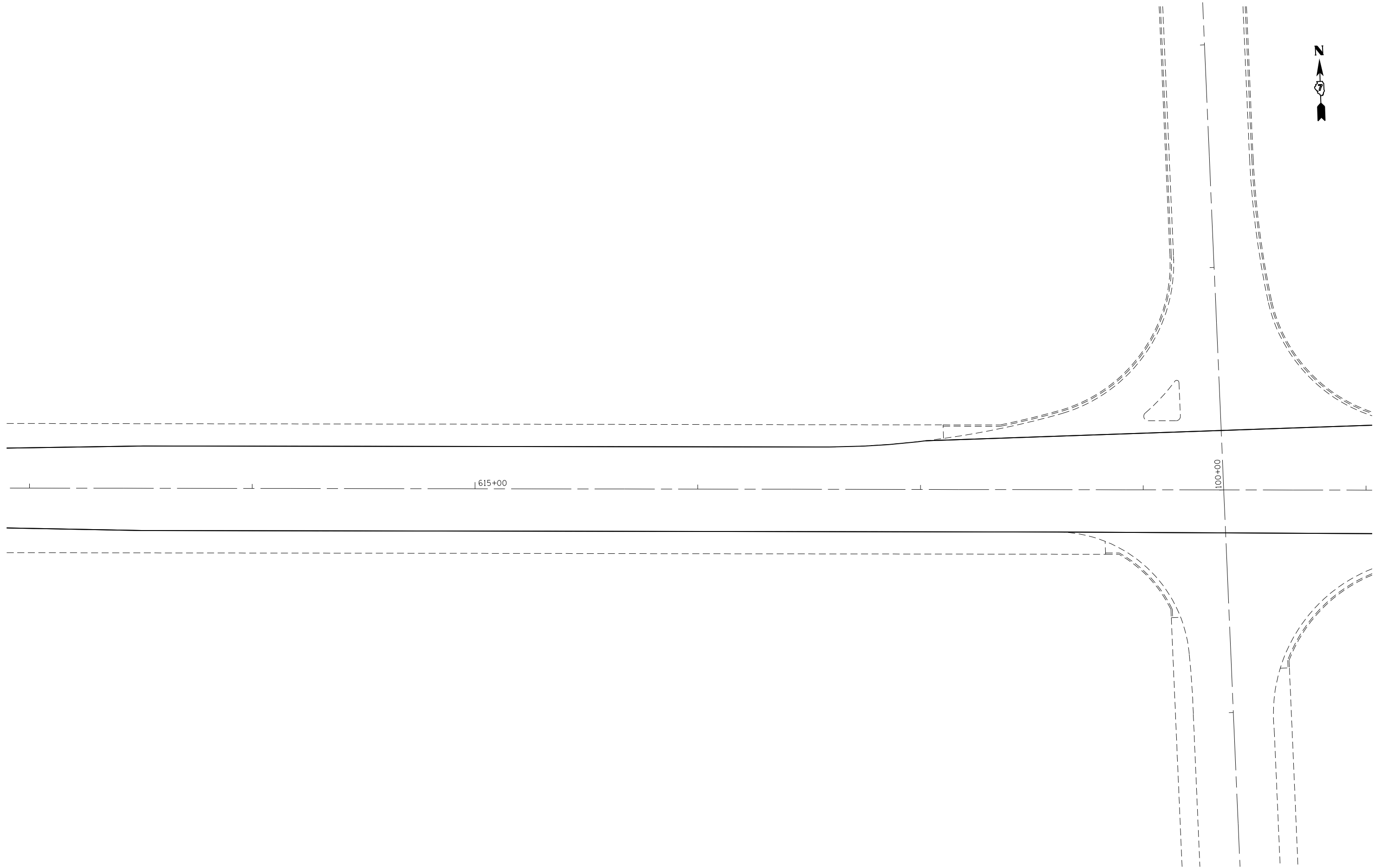

FILE NAME =	USER NAME = steffenmk	DESIGNED -	REVISED -
c:\pw\work\p\dot\stefjenmk\d0348176\07	74630-sh-t-plan.dgn	DRAWN -	REVISED -
Default	PLOT SCALE = 40.0000' / in.	CHECKED -	REVISED -
	PLOT DATE = 10/1/2013	DATE -	REVISED -

**STATE OF ILLINOIS
DEPARTMENT OF TRANSPORTATION**

PLAN

SCALE: 20 SHEET 5 OF 10 SHEETS STA. 613+00 TO STA. 619+00

F.A.P. RTE.	SECTION	COUNTY	TOTAL SHEETS	SHEET NO.
327	D7 HMA RESURF 2014-2	CLAY	26	14
CONTRACT NO. 74630			ILLINOIS FED. AID PROJECT	

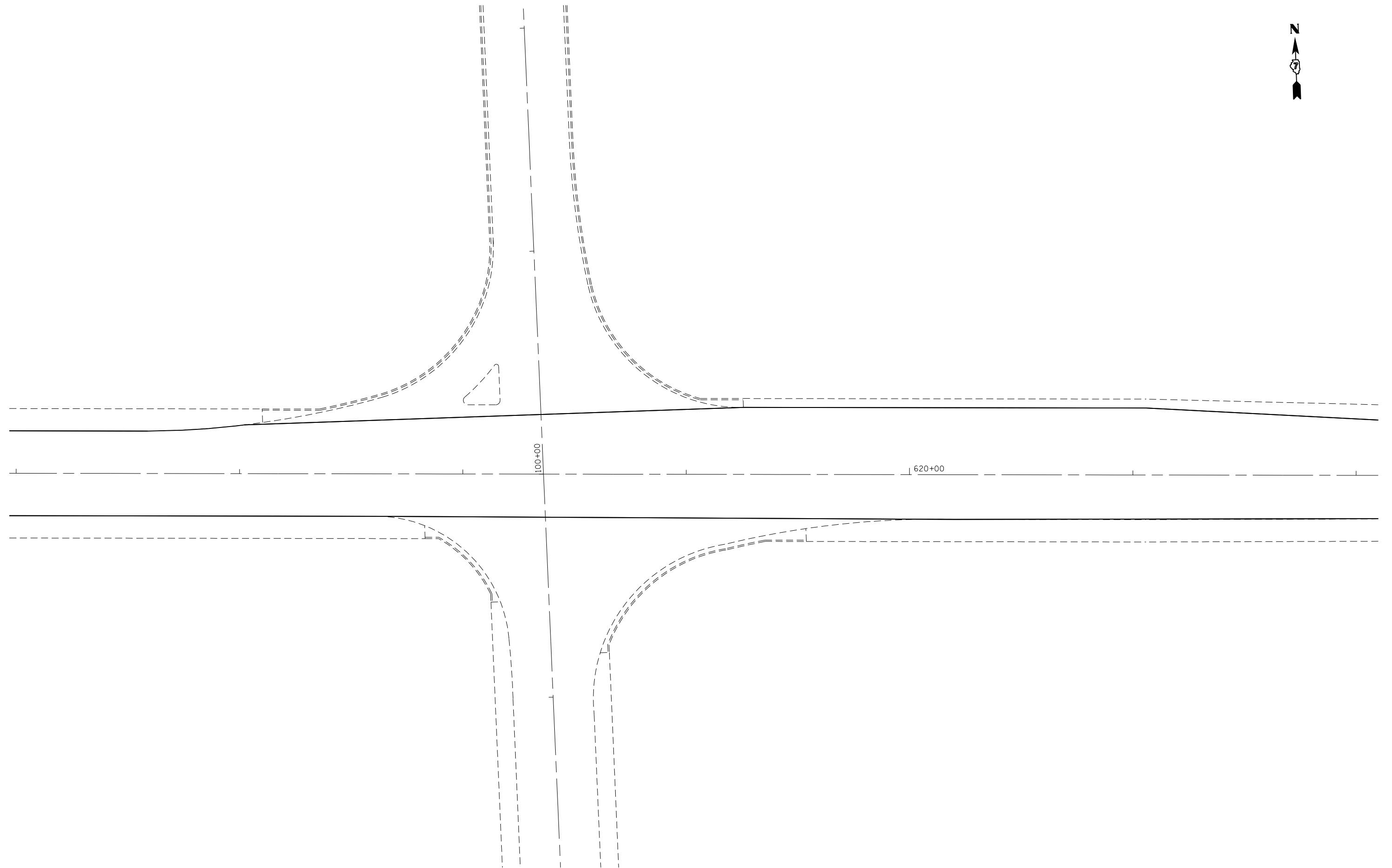

FILE NAME =	USER NAME = steffenmk	DESIGNED -	REVISED -
c:\pw\work\p\dot\steffenmk\d0348176\07	74630-sh-t-plan.dgn	DRAWN -	REVISED -
Default	PLOT SCALE = 40.0000' / in.	CHECKED -	REVISED -
	PLOT DATE = 10/1/2013	DATE -	REVISED -

**STATE OF ILLINOIS
DEPARTMENT OF TRANSPORTATION**

PLAN

SCALE: 20 SHEET 6 OF 10 SHEETS STA. 616+00 TO STA. 622+00

F.A.P. RTE.	SECTION	COUNTY	TOTAL SHEETS	SHEET NO.
327	D7 HMA RESURF 2014-2	CLAY	26	15
ILLINOIS FED. AID PROJECT			CONTRACT NO. 74630	

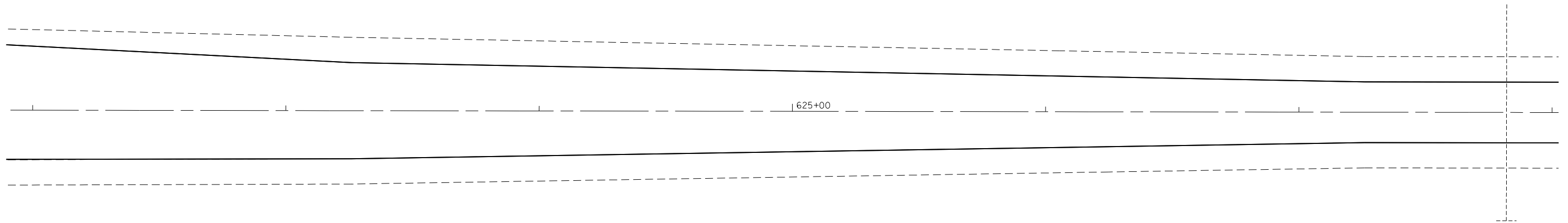

FILE NAME =	USER NAME = steffenmk	DESIGNED -	REVISED -
c:\pw\work\p\idot\stefjenmk\d0348176\074630-sh-t-plan.dgn		DRAWN -	REVISED -
Default	PLOT SCALE = 40.0000' / in.	CHECKED -	REVISED -
	PLOT DATE = 10/1/2013	DATE -	REVISED -

**STATE OF ILLINOIS
DEPARTMENT OF TRANSPORTATION**

PLAN

SCALE: 20 SHEET 7 OF 10 SHEETS STA. 622+00 TO STA. 628+00

F.A.P. RTE.	SECTION	COUNTY	TOTAL SHEETS	SHEET NO.
327	D7 HMA RESURF 2014-2	CLAY	26	16
ILLINOIS FED. AID PROJECT			CONTRACT NO. 74630	

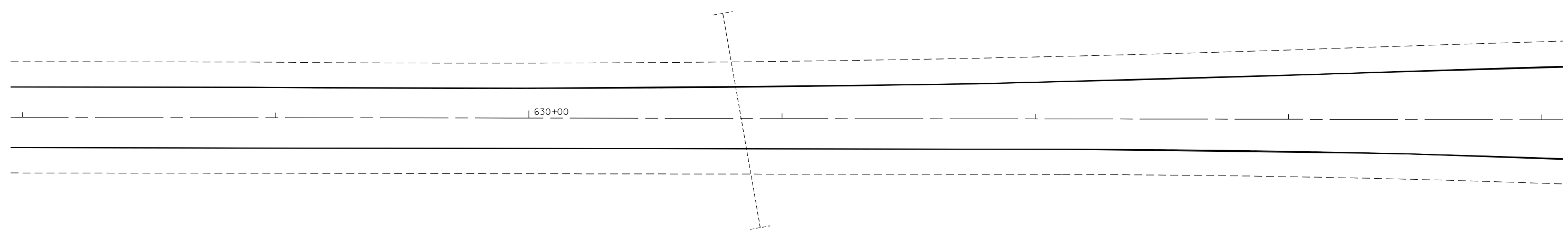

FILE NAME =	USER NAME = steffenmk	DESIGNED -	REVISED -	STATE OF ILLINOIS DEPARTMENT OF TRANSPORTATION	PLAN			F.A.P. RTE.	SECTION	COUNTY	TOTAL SHEETS	SHEET NO.
c:\pw\work\p\dot\steffenmk\d0348176\07	74630-sh-t-pln.dgn	DRAWN -	REVISED -					327	D7 HMA RESURF 2014-2	CLAY	26	17
Default	PLOT SCALE = 40.0000' / in.	CHECKED -	REVISED -		CONTRACT NO. 74630							
	PLOT DATE = 10/1/2013	DATE -	REVISED -		SCALE: 20	SHEET 8 OF 10 SHEETS	STA. 628+00 TO STA. 634+00	ILLINOIS FED. AID PROJECT				

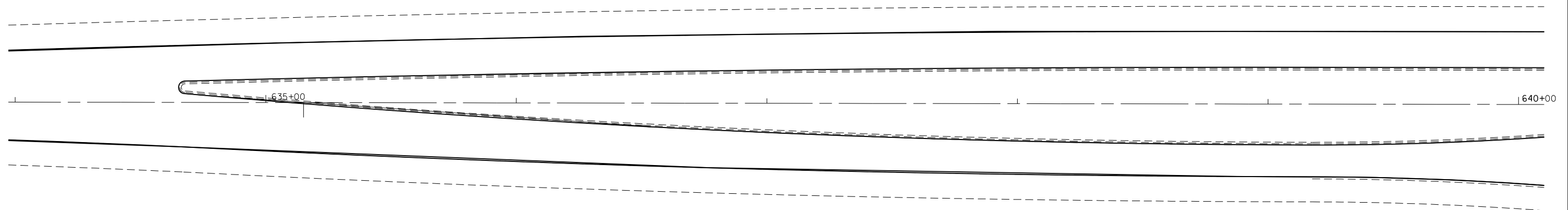

FILE NAME =	USER NAME = steffenmk	DESIGNED -	REVISED -
c:\pw\work\p\dot\steffenmk\d0348176\07	74630-sh-t-plan.dgn	DRAWN -	REVISED -
Default	PLOT SCALE = 40.0000 ' / in.	CHECKED -	REVISED -
	PLOT DATE = 10/1/2013	DATE -	REVISED -

**STATE OF ILLINOIS
DEPARTMENT OF TRANSPORTATION**

PLAN
SCALE: 20 SHEET 9 OF 10 SHEETS STA. 634+00 TO STA. 640+00

F.A.P. RTE.	SECTION	COUNTY	TOTAL SHEETS	SHEET NO.
327	D7 HMA RESURF 2014-2	CLAY	26	18
CONTRACT NO. 74630				
ILLINOIS FED. AID PROJECT				

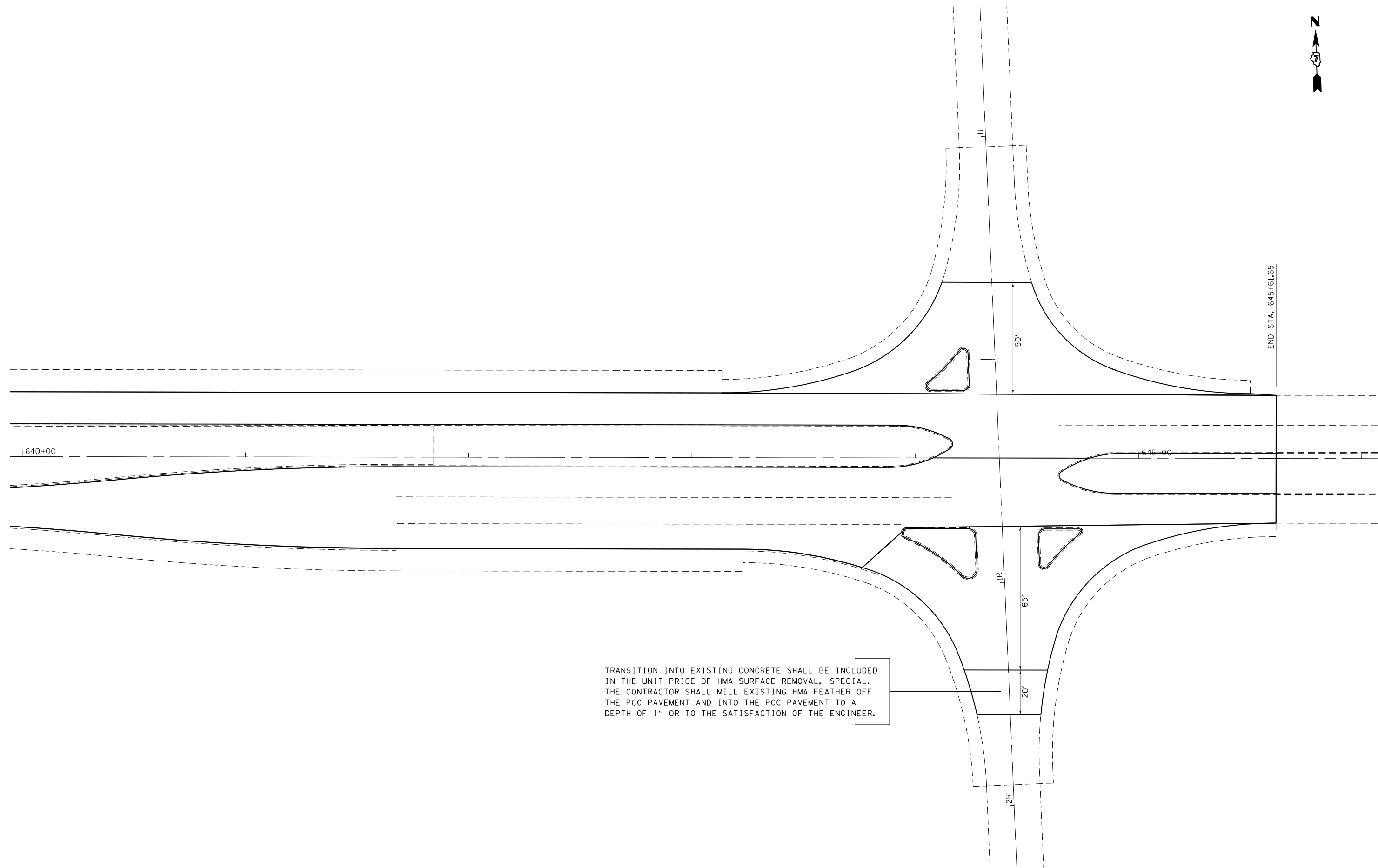

TRANSITION INTO EXISTING CONCRETE SHALL BE INCLUDED IN THE UNIT PRICE OF HMA SURFACE REMOVAL, SPECIAL. THE CONTRACTOR SHALL MILL EXISTING HMA FEATHER OFF THE PCC PAVEMENT AND INTO THE PCC PAVEMENT TO A DEPTH OF 1" OR TO THE SATISFACTION OF THE ENGINEER.

END STA. 645+61.65

FILE NAME =	USER NAME = steffenmk	DESIGNED -	REVISED -
ci:\pw\work\p\idot\stefjenmk\d0348176\074630-sh-t-pln.dgn		DRAWN -	REVISED -
Default	PLOT SCALE = 40.0000' / in.	CHECKED -	REVISED -
	PLOT DATE = 10/1/2013	DATE -	REVISED -

**STATE OF ILLINOIS
DEPARTMENT OF TRANSPORTATION**

PLAN
SCALE: 20 SHEET 10 OF 10 SHEETS STA. 640+00 TO STA. 646+00

F.A.P. RTE.	SECTION	COUNTY	TOTAL SHEETS	SHEET NO.
327	D7 HMA RESURF 2014-2	CLAY	26	19
ILLINOIS FED. AID PROJECT			CONTRACT NO. 74630	

US 45 & STATE STREET

LOOP:	SIZE:	MODE:	QUADRA-POLE:	DELAY:
A1,A2,A3,A4, B1,B2,B3,B4,B5, C1,C7,C9, C2,C8,C10, D1,D3,D5, D2,D4,D6	6' X 6'	NORMAL	NO	0
C11	6' X 15'	EXTENDED	NO	0
C3,C4,C5,C6	6' X 6'	DELAY	NO	15

THE FOLLOWING CABLES SHALL BE WIRED TO COMMON AMPLIFIERS:
 (A1, A3, A2, A4),
 (B1, B3, B5, B2, B4)
 (B3), (B9), (B10), (B11),
 (C1, C7, C9), (C2, C8, C10),
 (C3, C4, C5, C6), (C11),
 (D1, D3, D5), (D2, D4, D6)

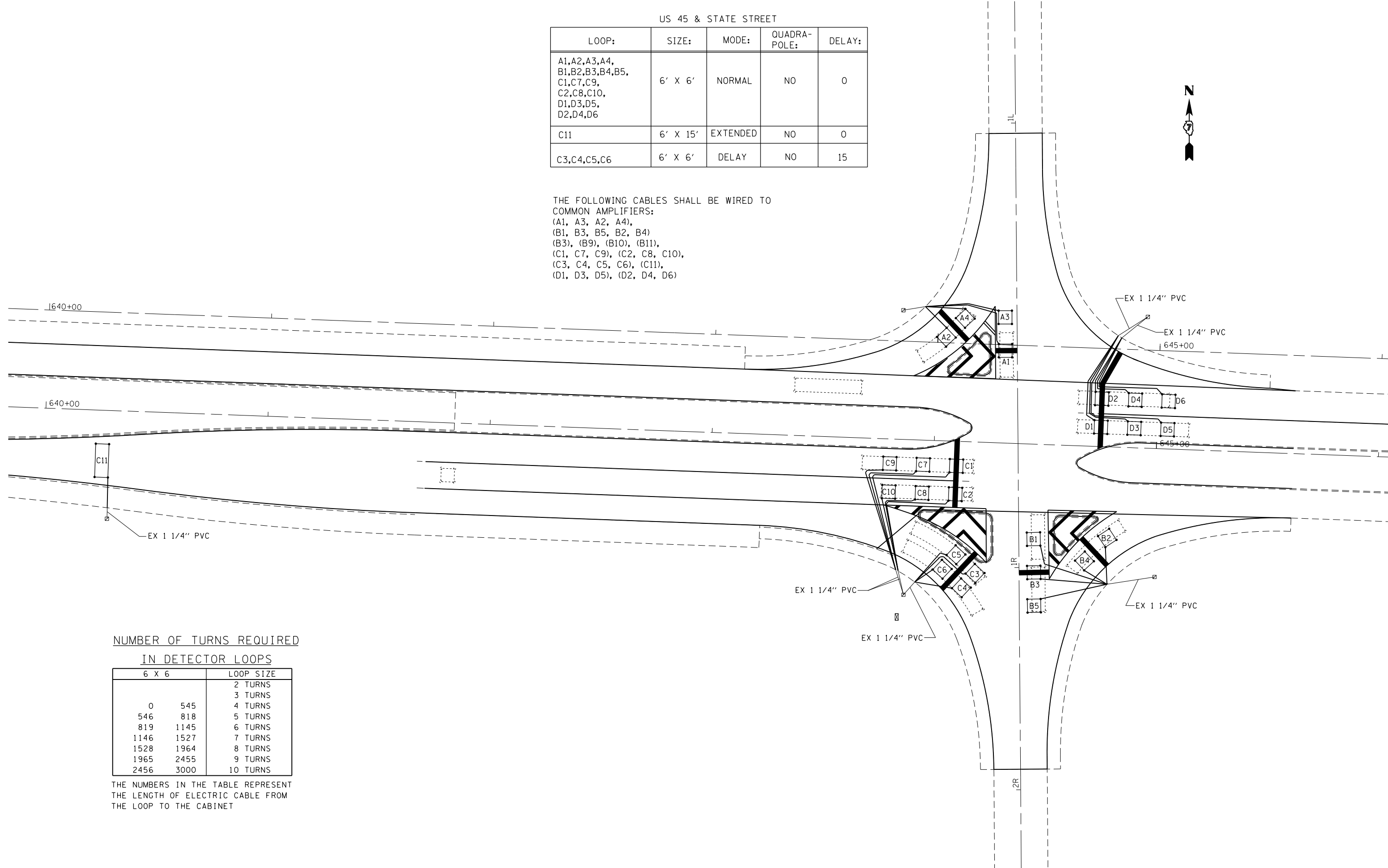

NUMBER OF TURNS REQUIRED
IN DETECTOR LOOPS

6 X 6		LOOP SIZE
		2 TURNS
		3 TURNS
0	545	4 TURNS
546	818	5 TURNS
819	1145	6 TURNS
1146	1527	7 TURNS
1528	1964	8 TURNS
1965	2455	9 TURNS
2456	3000	10 TURNS

THE NUMBERS IN THE TABLE REPRESENT THE LENGTH OF ELECTRIC CABLE FROM THE LOOP TO THE CABINET

FILE NAME =	USER NAME = steffenmk	DESIGNED -	REVISED -
ci:\pwork\pwork\stevfemk\d0348176\074630-sh1-det loops.dgn		DRAWN -	REVISED -
Default	PLOT SCALE = 40.0000' / in.	CHECKED -	REVISED -
	PLOT DATE = 10/1/2013	DATE -	REVISED -

STATE OF ILLINOIS
DEPARTMENT OF TRANSPORTATION

U.S. RTE. 45 & STATE STREET
DETECTOR LOOP LOCATIONS

SCALE: 20 SHEET 1 OF 2 SHEETS STA. TO STA.

F.A.P. RTE.	SECTION	COUNTY	TOTAL SHEETS	SHEET NO.
327	D7 HMA RESURF 2014-2	CLAY	26	20
CONTRACT NO. 74630				
ILLINOIS FED. AID PROJECT				

TYPICAL APPLICATION OF DETECTOR LOOPS

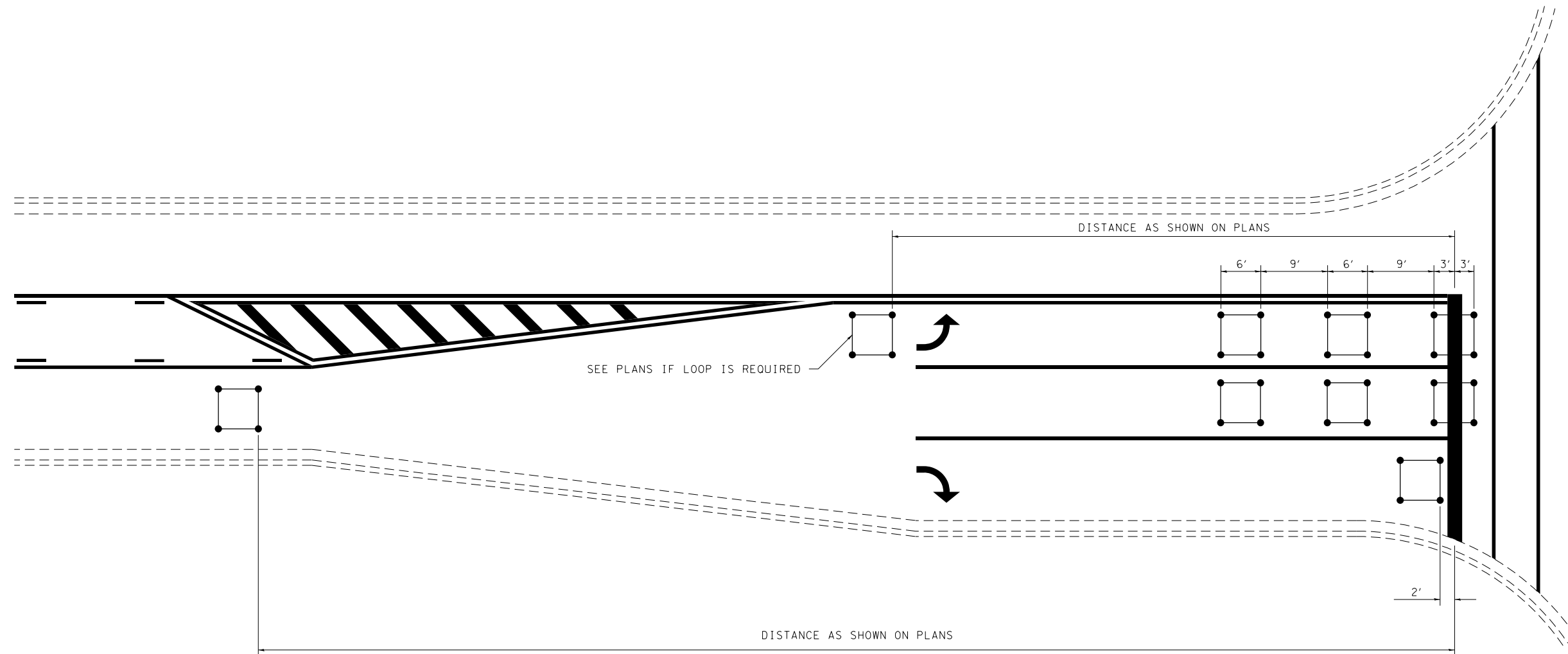

NOTE:

1. EACH LOOP SHALL HAVE ITS OWN HOMERUN TO THE GULFBOX/HANDHOLE.
2. LOOPS SHOULD BE CENTERED IN EACH LANE.
3. USE 6' BY 6' LOOPS FOR LANE WIDTHS OF 11' OR GREATER.
4. USE 5' BY 5' LOOPS IF LANE WIDTH IS LESS THAN 11'.

NOT TO SCALE

DISTRICT 7 DETAIL NO. 88600100

FILE NAME =	USER NAME = steffenmk	DESIGNED -	REVISED -
c:\pwork\pwork\stevfenmk\d0348176\074630-sh1-det loops.dgn		DRAWN -	REVISED -
Default	PLOT SCALE = 40.0000' / in.	CHECKED -	REVISED -
	PLOT DATE = 10/1/2013	DATE -	REVISED -

**STATE OF ILLINOIS
DEPARTMENT OF TRANSPORTATION**

TYPICAL APPLICATIONS OF DETECTOR LOOPS

SCALE: N/A SHEET 2 OF 2 SHEETS STA. TO STA.

F.A.P. RTE.	SECTION	COUNTY	TOTAL SHEETS	SHEET NO.
327	D7 HMA RESURF 2014-2	CLAY	26	21
CONTRACT NO. 74630				
ILLINOIS FED. AID PROJECT				

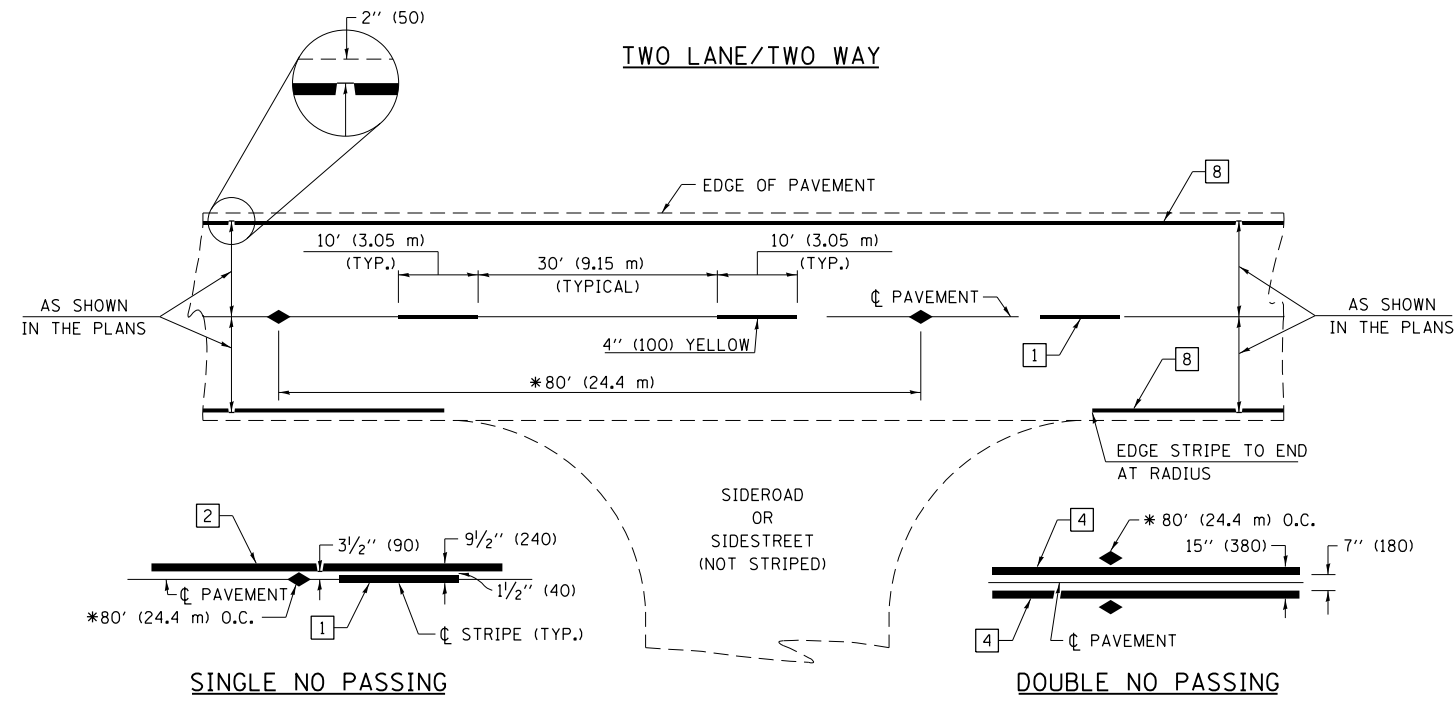

* REDUCE TO 40' (12.2 m) O.C. ON CURVES WITH POSTED OR ADVISORY SPEEDS OF 45 mph (70 km/h) OR LESS.

PAVEMENT MARKING LEGEND

- 1 4" (100) SKIP-DASH (YELLOW)
 - 2 4" (100) SOLID (YELLOW)
 - 3 12" (300) DIAGONAL (YELLOW)
 - 4 4" (100) DOUBLE YELLOW (NARROW)
 - 5 12" (300) SOLID WHITE
 - 6 RESERVED
 - 7 6" (150) SKIP-DASH (WHITE)
 - 8 4" (100) SOLID (WHITE)
 - 9 12" (300) DIAGONAL (WHITE)
 - 10 6" (150) SOLID (WHITE)
 - 11 24" (600) STOP BAR (WHITE)
 - 12 8" (200) SOLID (WHITE)
 - 13 4" (100) PARKING WHITE
-

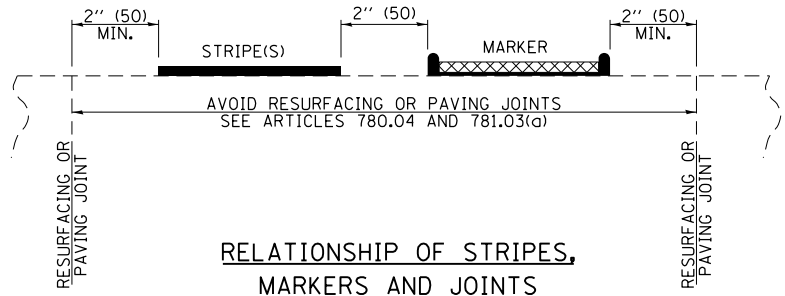

TYPICAL PAVEMENT MARKERS LEGEND

- ◆ TWO-WAY AMBER MARKER
- ▶ ONE-WAY AMBER MARKER
- ▷ ONE-WAY CRYSTAL MARKER

RAISED REFLECTIVE PAVEMENT MARKERS

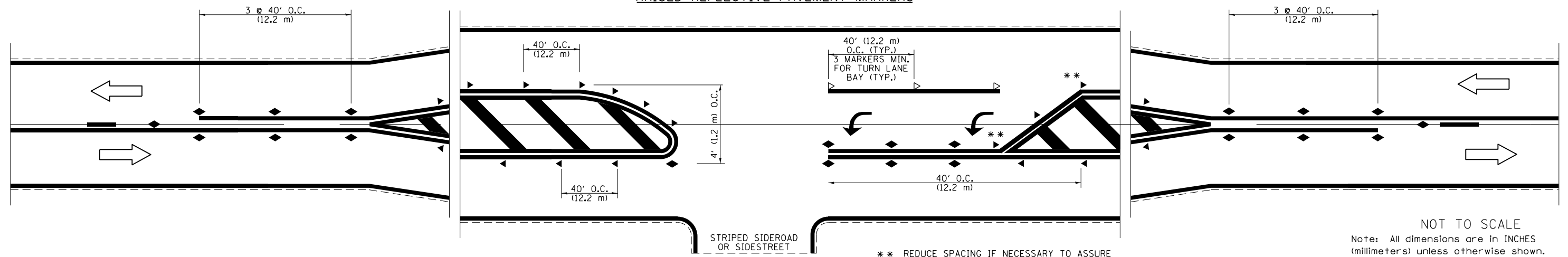

NOT TO SCALE
Note: All dimensions are in INCHES (millimeters) unless otherwise shown.

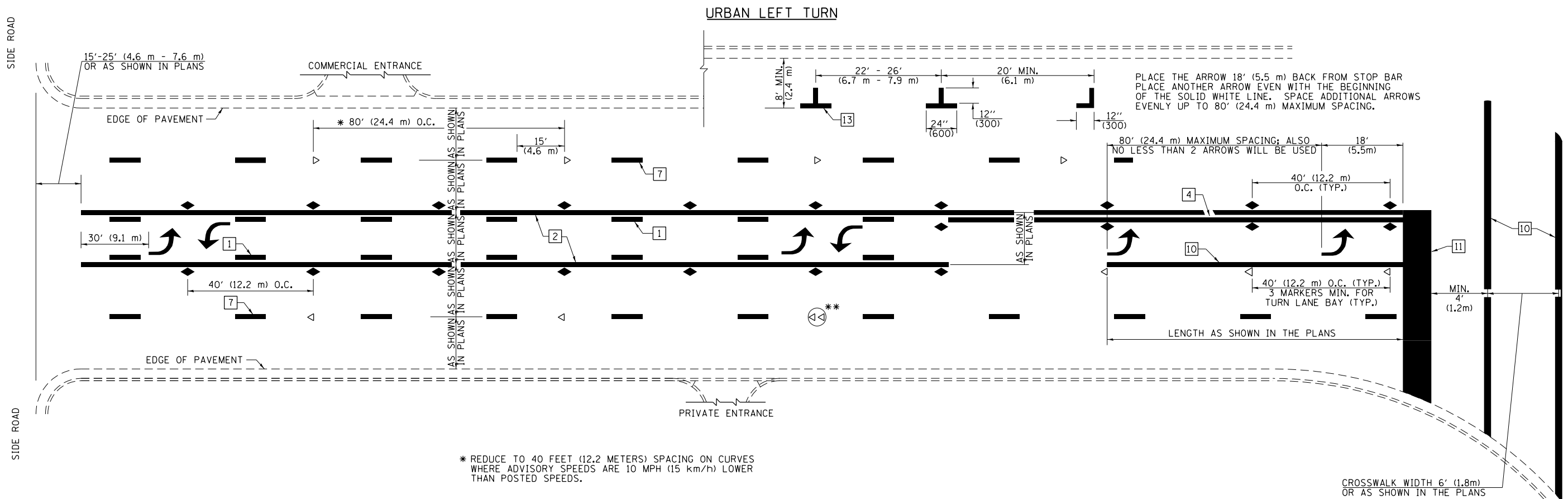

PLACE THE ARROW 18' (5.5 m) BACK FROM STOP BAR
 PLACE ANOTHER ARROW EVEN WITH THE BEGINNING
 OF THE SOLID WHITE LINE. SPACE ADDITIONAL ARROWS
 EVENLY UP TO 80' (24.4 m) MAXIMUM SPACING.

* REDUCE TO 40 FEET (12.2 METERS) SPACING ON CURVES
 WHERE ADVISORY SPEEDS ARE 10 MPH (15 km/h) LOWER
 THAN POSTED SPEEDS.

** DOUBLE LANE LINE MARKERS SHALL BE SPECIFIED
 AND SPACED AS SHOWN IN HIGHWAY STANDARD
 781001 FOR MULTI-LANE DIVIDED AND UNDIVIDED
 HIGHWAYS.

PAVEMENT MARKING LEGEND

- 1 4" (100) SKIP-DASH (YELLOW)
- 2 4" (100) SOLID (YELLOW)
- 3 12" (300) DIAGONAL (YELLOW)
- 4 4" (100) DOUBLE YELLOW (NARROW)
- 5 12" (300) SOLID WHITE
- 6 RESERVED
- 7 6" (150) SKIP-DASH (WHITE)
- 8 4" (100) SOLID (WHITE)
- 9 12" (300) DIAGONAL (WHITE)
- 10 6" (150) SOLID (WHITE)
- 11 24" (600) STOP BAR (WHITE)
- 12 8" (200) SOLID (WHITE)
- 13 4" (100) PARKING WHITE

GENERAL NOTES

1. TURN ARROW PAIRS SHALL BE PLACED AT 250' (75 m) INTERVALS AND SHALL BE EVENLY SPACED BETWEEN BOTH ENDS OF THE BIDIRECTIONAL LEFT TURN LANE. USE A MINIMUM OF TWO PAIRS PER BLOCK.
2. THE SOLID YELLOW PAVEMENT MARKINGS [2] SHOULD GENERALLY START OR END NEAR THE RADIUS POINT OF EACH STREET RETURN EXCEPT WHERE ONE OR BOTH ENDS WOULD INCLUDE STOP BARS.
3. THE SKIP-DASH PAVEMENT MARKINGS [1] OR [7] SHOULD BE CENTERED BETWEEN BOTH ENDS OF EACH CITY BLOCK AND SHALL BE PLACED SO THEY LINE UP ACROSS FROM EACH OTHER.
4. USE LARGE ARROW SIZE FOR BOTH RURAL AND URBAN LOCATIONS. (SEE LAST PAGE OF SECTION 780x FOR SYMBOLS TABLE)
5. LANE LINE EXTENSIONS SHALL BE THE SAME COLOR AND WIDTH AS THE LANE LINE BEING EXTENDED.

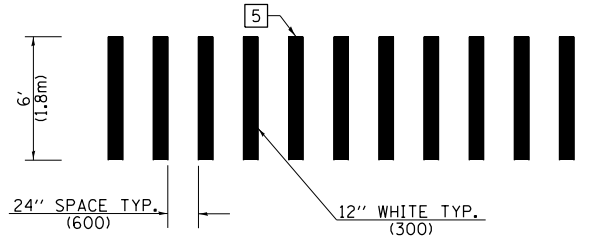

**CROSSWALK DETAIL
 (DECATUR CITY LIMITS ONLY)**

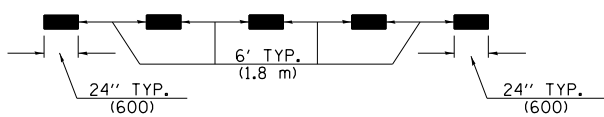

LANE LINE EXTENSIONS

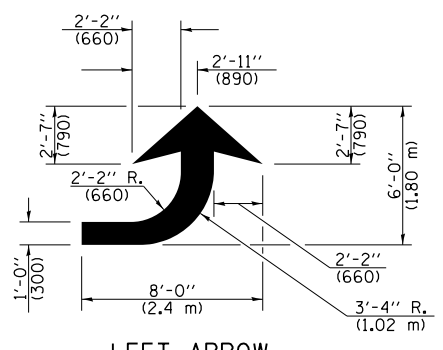

LEFT ARROW

REVERSE FOR RIGHT ARROW
 AREA = 15.6 SQ. FT. (1.47 m²)
 (WHITE)

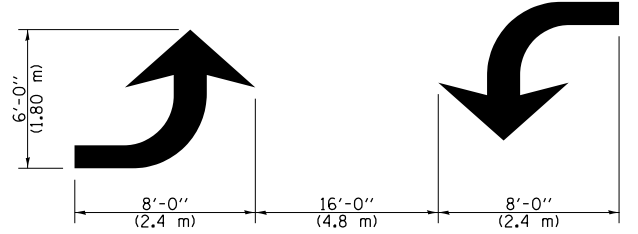

**TYPICAL DOUBLE
 TURN ARROWS (WHITE)**

NOT TO SCALE

Note: All dimensions are in INCHES (millimeters) unless otherwise shown.

DISTRICT 7 DETAIL NO. 78000001

FILE NAME = c:\pwwork\pwwork\stef\enmk\d0348176\074630-sh1-details.dgn	USER NAME = stefenmk	DESIGNED -	REVISED -	STATE OF ILLINOIS DEPARTMENT OF TRANSPORTATION	PAVEMENT MARKING AND RAISED REFLECTIVE PAVEMENT MARKERS (RURAL & URBAN APPLICATIONS)			F.A.P. RTE. = 327	SECTION = D7 HMA RESURF 2014-2	COUNTY = CLAY	TOTAL SHEETS = 26	SHEET NO. = 23
PLOT SCALE = 100.0000' / 1"	CHECKED -	REVISED -	REVISED -					SCALE: N/A	SHEET NO. 2 OF 4 SHEETS	STA. TO STA.	CONTRACT NO. 74630	
PLOT DATE = 10/1/2013	DATE -	REVISED -	REVISED -		ILLINOIS FED. AID PROJECT							

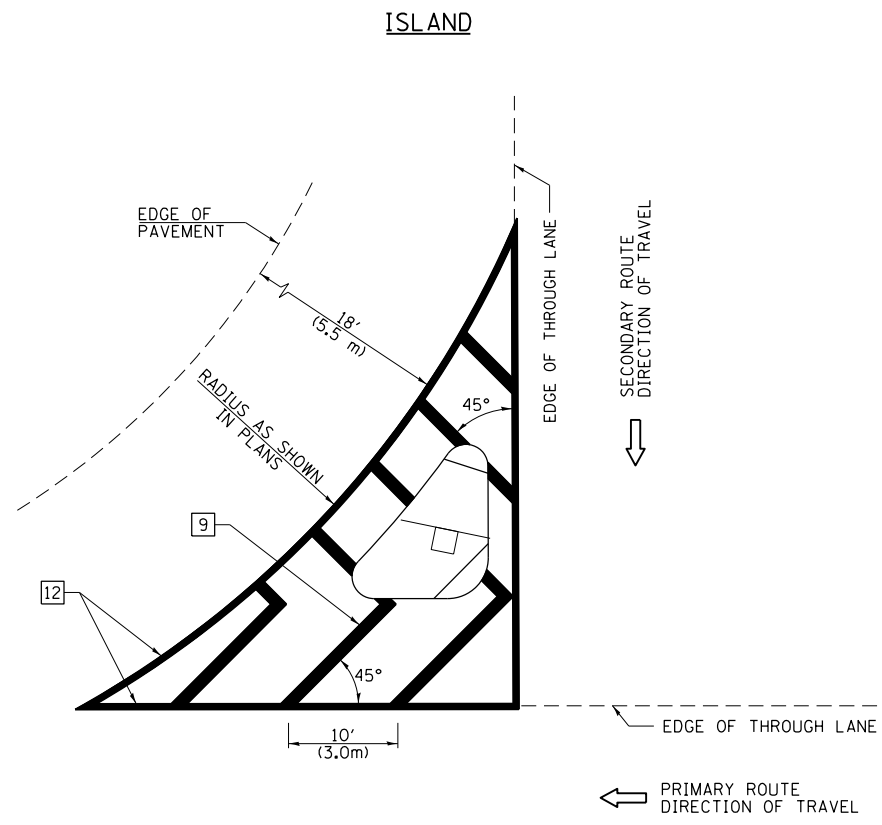

GENERAL NOTES

1. RAISED AND CORRUGATED MEDIANS SHALL BE OUTLINED WITH [2] IF PRESENT.
2. SOME OF THE INFORMATION INCLUDED WITH THIS DETAIL MAY NOT BE APPLICABLE TO THIS IMPROVEMENT.
3. PAVEMENT MARKINGS ARE TO BE EXTENDED THROUGH OMISSIONS WHEN APPLICABLE.
4. FINAL PAVEMENT MARKINGS SHALL BE IN PLACE PRIOR TO PLACING ANY RAISED REFLECTIVE PAVEMENT MARKERS.
5. THE FOLLOWING CRITERIA SHALL BE USED FOR SELECTING THE DIAGONAL PAVEMENT MARKING SPACING:

< 30 MPH (< 50 km/h)	15' (4.5 m)
30-45 MPH (50-75 km/h)	20' (6.0 m)
> 45 MPH (> 75 km/h)	30' (9.0 m)

PAVEMENT MARKING LEGEND

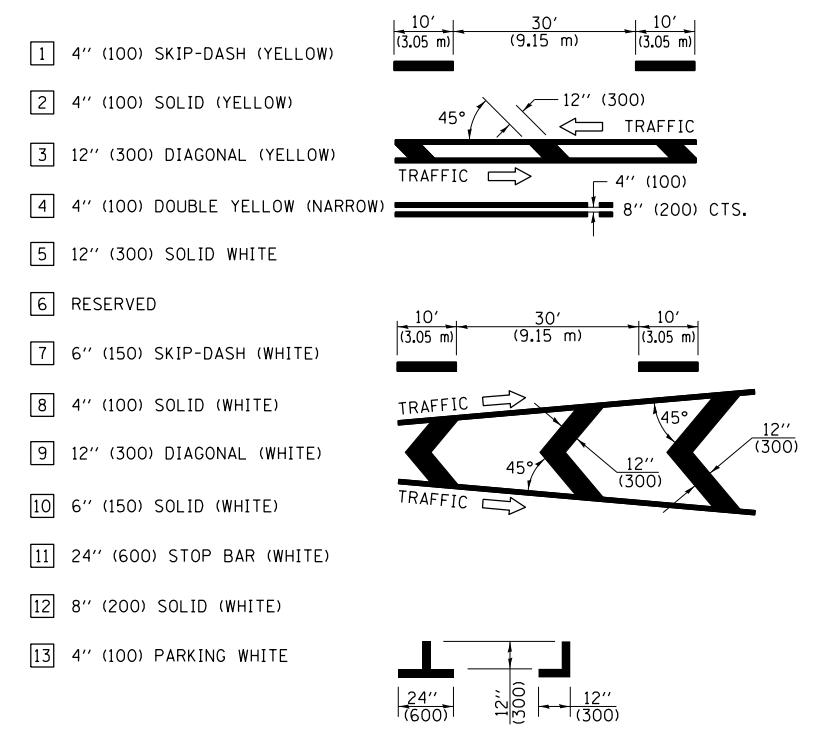

RURAL LEFT TURN STRIPING

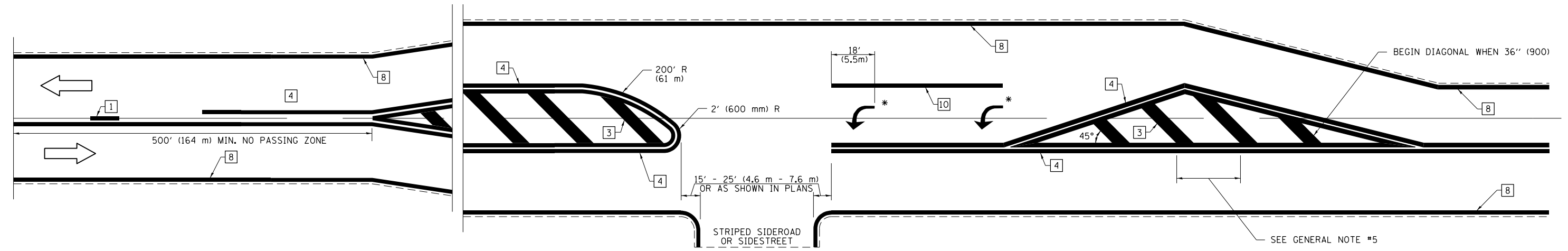

* PLACE AN ARROW 18' (5.5 m) BACK FROM STOP BAR. PLACE ANOTHER ARROW EVEN WITH THE BEGINNING OF THE SOLID WHITE LINE. SPACE ADDITIONAL ARROWS EVENLY UP TO 80' (24.4 m) MAXIMUM SPACING. USE MINIMUM OF 2 ARROWS.

NOT TO SCALE

Note: All dimensions are in INCHES (millimeters) unless otherwise shown.

DISTRICT 7 DETAIL NO. 7800001

FILE NAME =	USER NAME = steffenmk	DESIGNED -	REVISED -
ci:\pw\work\p\id\dot\steffenmk\d0348176\074630-sh\details.dgn	74630-sh\details.dgn	DRAWN -	REVISED -
PLOT SCALE = 100.0000' / 1in.		CHECKED -	REVISED -
PLOT DATE = 10/1/2013		DATE -	REVISED -

**STATE OF ILLINOIS
DEPARTMENT OF TRANSPORTATION**

**PAVEMENT MARKING AND RAISED REFLECTIVE PAVEMENT MARKERS
(RURAL & URBAN APPLICATIONS)**

SCALE: N/A SHEET NO. 3 OF 4 SHEETS STA. TO STA.

F.A.P. RTE.	SECTION	COUNTY	TOTAL SHEETS	SHEET NO.
327	D7 HMA RESURF 2014-2	CLAY	26	24
CONTRACT NO. 74630				
ILLINOIS FED. AID PROJECT				

PAVEMENT MARKINGS AT RAILROAD-HIGHWAY GRADE CROSSING

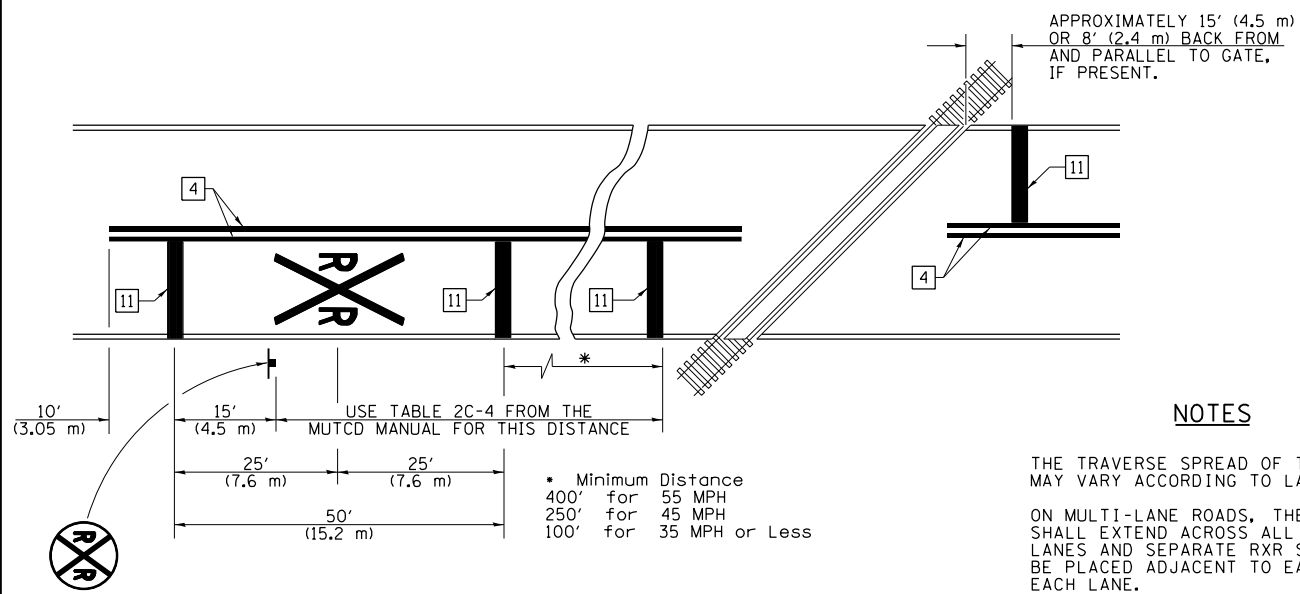

NOTES

THE TRAVERSE SPREAD OF THE "X" MAY VARY ACCORDING TO LANE WIDTH.

ON MULTI-LANE ROADS, THE STOP LINES SHALL EXTEND ACROSS ALL APPROACH LANES AND SEPARATE RXR SYMBOLS SHALL BE PLACED ADJACENT TO EACH OTHER IN EACH LANE.

WHEN THE PAVEMENT MARKING SYMBOL IS USED, A PORTION OF THE SYMBOL SHOULD BE LOCATED DIRECTLY ADJACENT TO THE ADVANCE WARNING SIGN (W10-1) AS PLACED BY TABLE II-1, CONDITION B OF THE MUTCD.

PAVEMENT MARKING LEGEND

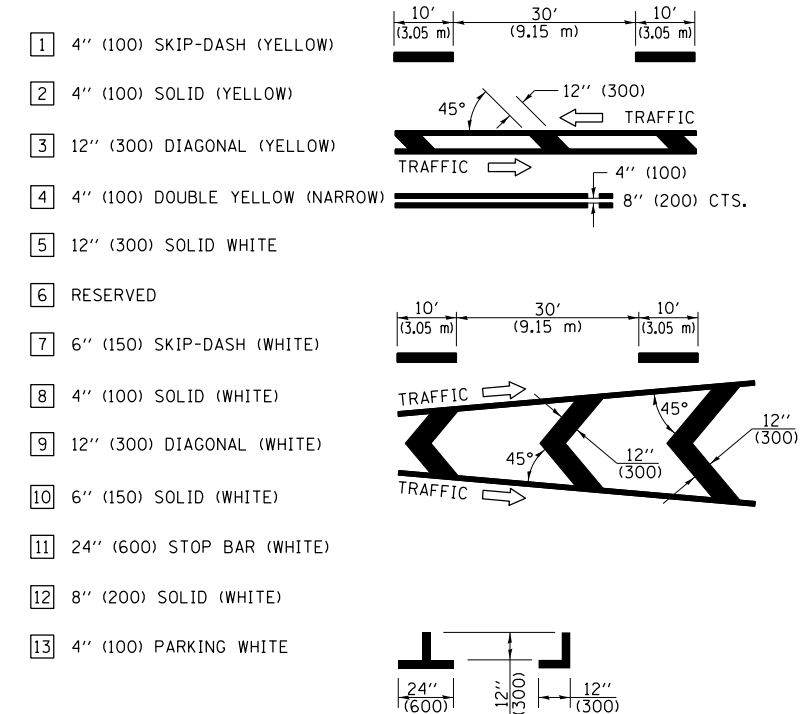

RAILROAD CROSSING WITH INTERCONNECT ONLY

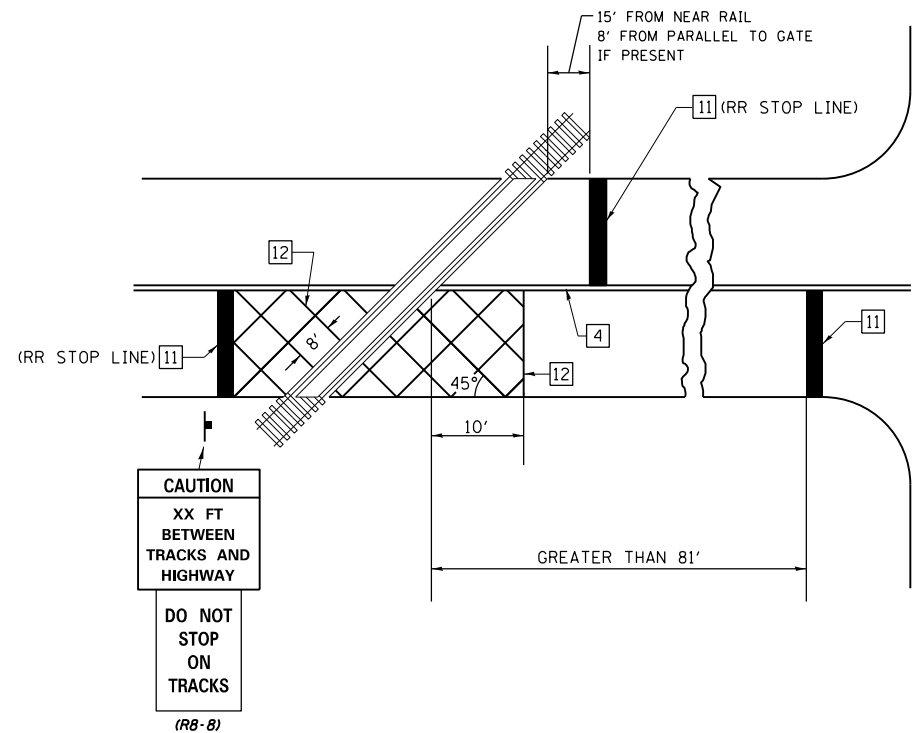

RAILROAD CROSSING WITH INTERCONNECT AND PRE-SIGNALS

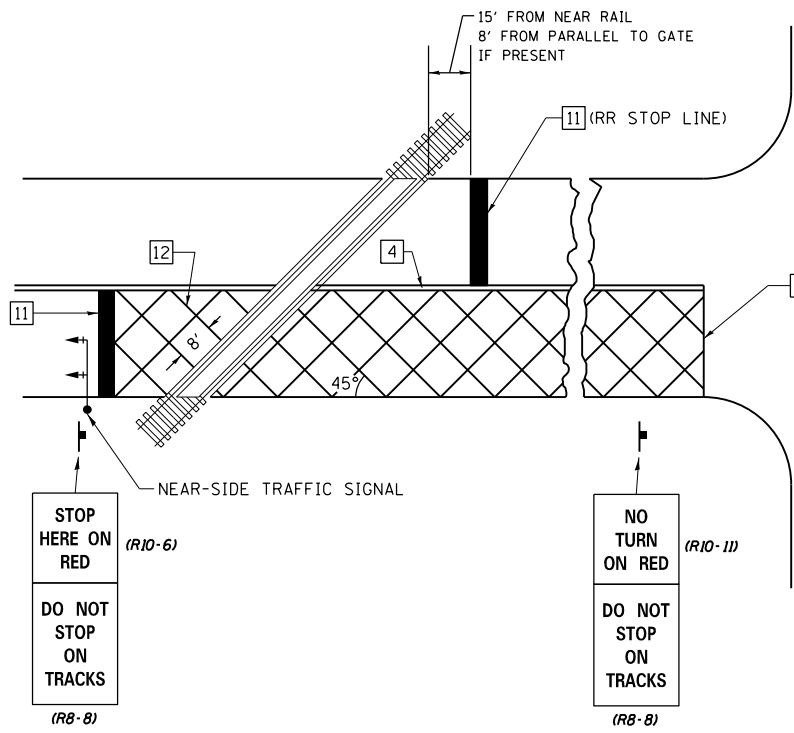

SUPPLEMENTAL PAVEMENT MARKING TREATMENT FOR RAILROAD-HIGHWAY GRADE CROSSING

GENERAL NOTES

- SUPPLEMENTAL PAVEMENT MARKINGS TO BE INSTALLED ONLY ON APPROACHES TO INTERSECTIONS CONTROLLED BY TRAFFIC SIGNALS WHICH ARE INTERCONNECTED WITH THE RAILROAD WARNING SIGNALS.
- EXTEND PAVEMENT MARKINGS TO THE INTERSECTION ONLY WHERE NEAR-SIDE TRAFFIC SIGNALS ARE USED.

NOT TO SCALE

Note: All dimensions are in INCHES (millimeters) unless otherwise shown.

DISTRICT 7 DETAIL NO. 78000001

FILE NAME =	USER NAME = steffenmk	DESIGNED -	REVISED -
c:\pwork\pwork\stev\stev\mk\d0348176\074630-sh1-details.dgn		DRAWN -	REVISED -
	PLOT SCALE = 100.0000' / 1in.	CHECKED -	REVISED -
	PLOT DATE = 10/1/2013	DATE -	REVISED -

STATE OF ILLINOIS
DEPARTMENT OF TRANSPORTATION

PAVEMENT MARKING AND RAISED REFLECTIVE PAVEMENT MARKERS
(RURAL & URBAN APPLICATIONS)

SCALE: N/A SHEET NO. 4 OF 4 SHEETS STA. TO STA.

F.A.P. RTE.	SECTION	COUNTY	TOTAL SHEETS	SHEET NO.
327	D7 HMA RESURF 2014-2	CLAY	26	25
CONTRACT NO. 74630				
ILLINOIS FED. AID PROJECT				

TYPICAL RUMBLE STRIP APPLICATION IN ADVANCE OF AN INTERSECTION

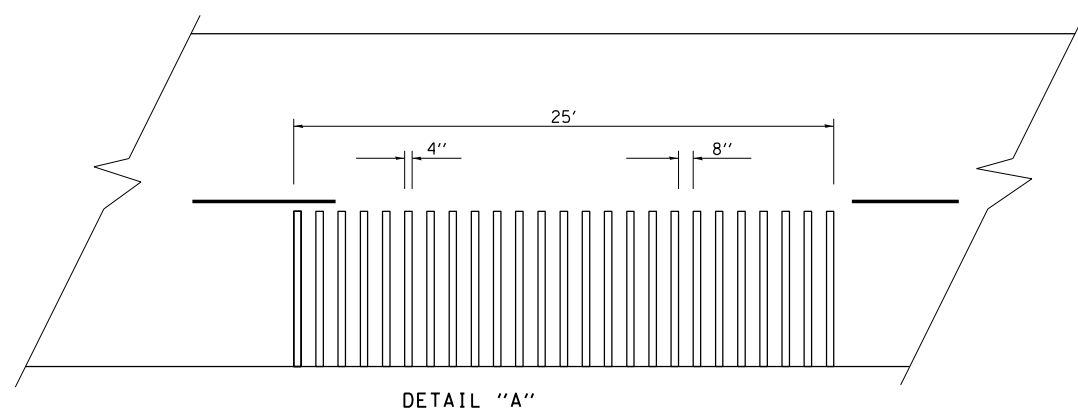
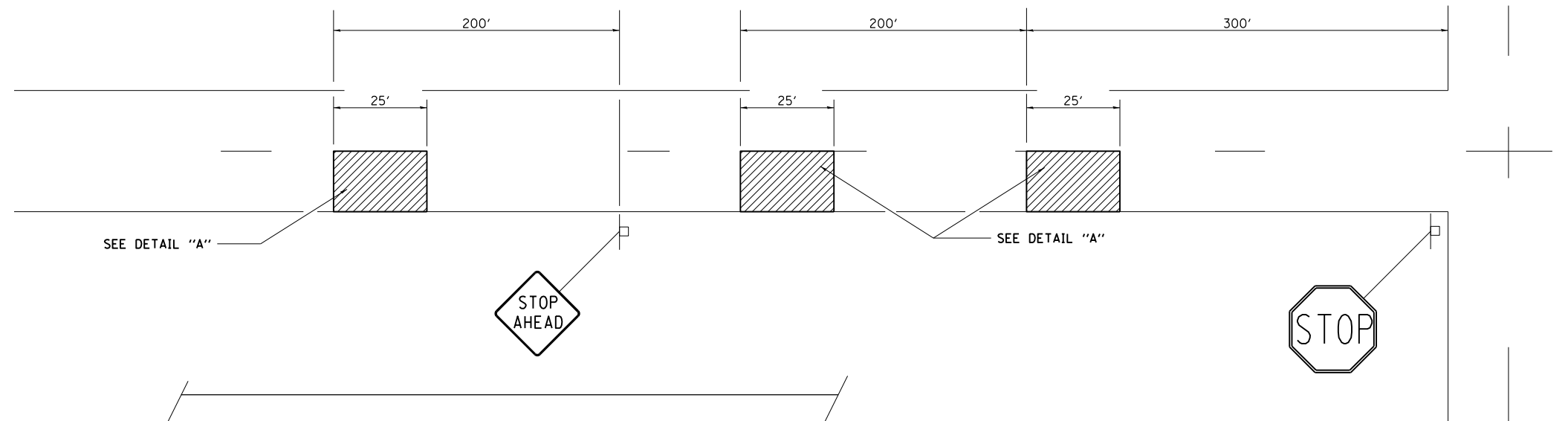

NOTE: THE 25 FEET RUMBLE AREA HAS 4" WIDE GROOVES SAWED INTO THE PAVEMENT, SEPARATED BY 8" OF EXISTING PAVEMENT. THE SAW CUTS SHALL EXTEND 12" INTO THE SHOULDER TO ALLOW FOR DRAINAGE.

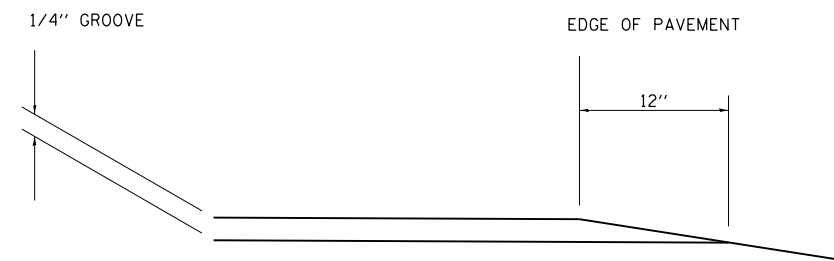
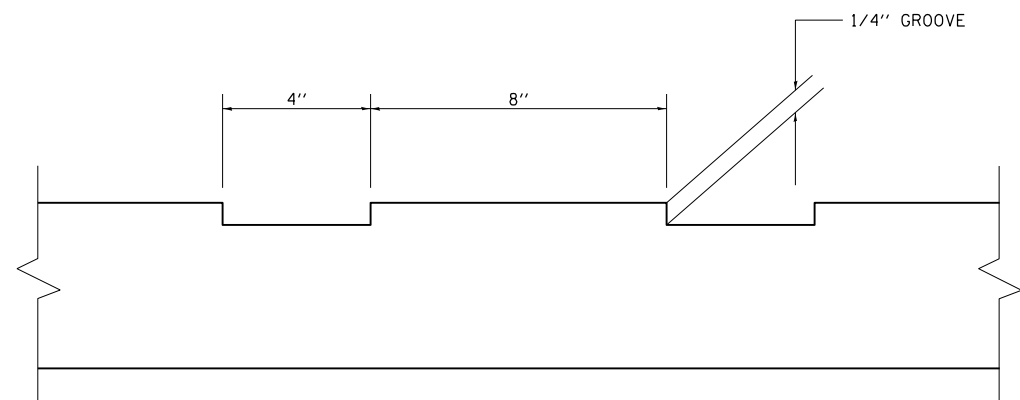

NOT TO SCALE

FILE NAME =	USER NAME = steffenmk	DESIGNED -	REVISED - MMO 12-99
ci:\pw\work\p\idot\steffenmk\d0348176\074630-sh1-details.dgn		DRAWN -	REVISED - MKS 04-08
	PLOT SCALE = 100.0000' / in.	CHECKED -	REVISED -
	PLOT DATE = 10/1/2013	DATE -	REVISED -

**STATE OF ILLINOIS
DEPARTMENT OF TRANSPORTATION**

TYPICAL RUMBLE STRIP APPLICATION

SCALE: N/A SHEET NO. 1 OF 1 SHEETS STA. TO STA.

DISTRICT 7 DETAIL NO. Z0055300

F.A.P. RTE.	SECTION	COUNTY	TOTAL SHEETS	SHEET NO.
327	D7 HMA RESURF 2014-2	CLAY	26	26
FED. ROAD DIST. NO.			ILLINOIS FED. AID PROJECT	
CONTRACT NO. 74630				