

STATE OF ILLINOIS
DEPARTMENT OF TRANSPORTATION
DIVISION OF HIGHWAYS

PROPOSED
HIGHWAY PLANS

S.B.I. ROUTE 11 (OLD US 40)
SECTION D7 HMA RESURF 2014-4

RESURFACE
CLARK COUNTY
C-97-086-13

FOR INDEX OF SHEETS, SEE SHEET NO. 2

ADT = 1,250

S.B.I. RTE.	SECTION	COUNTY	TOTAL SHEETS	SHEET NO.
11	D7 HMA RESURF 2014-4	CLARK	13	1
		ILLINOIS	CONTRACT NO. 74640	

D-97-040-13

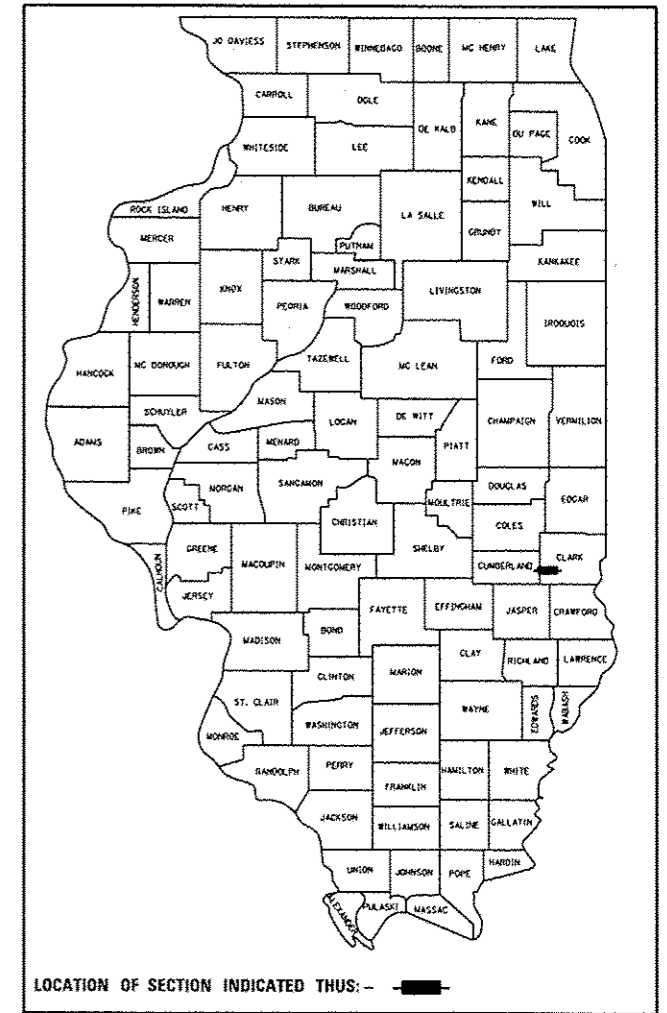

LOCATION OF SECTION INDICATED THUS: - [black rectangle] -

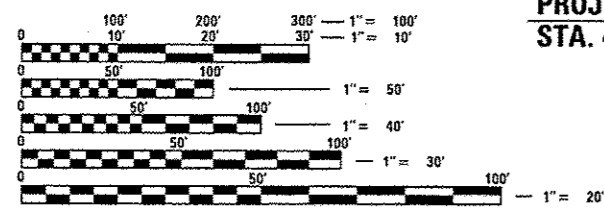

FULL SIZE PLANS HAVE BEEN PREPARED USING STANDARD ENGINEERING SCALES. REDUCED SIZED PLANS WILL NOT CONFORM TO STANDARD SCALES. IN MAKING MEASUREMENTS ON REDUCED PLANS, THE ABOVE SCALES MAY BE USED.

J.U.L.I.E.
JOINT UTILITY LOCATION INFORMATION FOR EXCAVATION
1-800-892-0123
OR 811

PROJECT ENGINEER: TOM RONAN
PROJECT MANAGER: TOM RONAN
PHONE: (217)-342-8314
CONTRACT NO. 74640

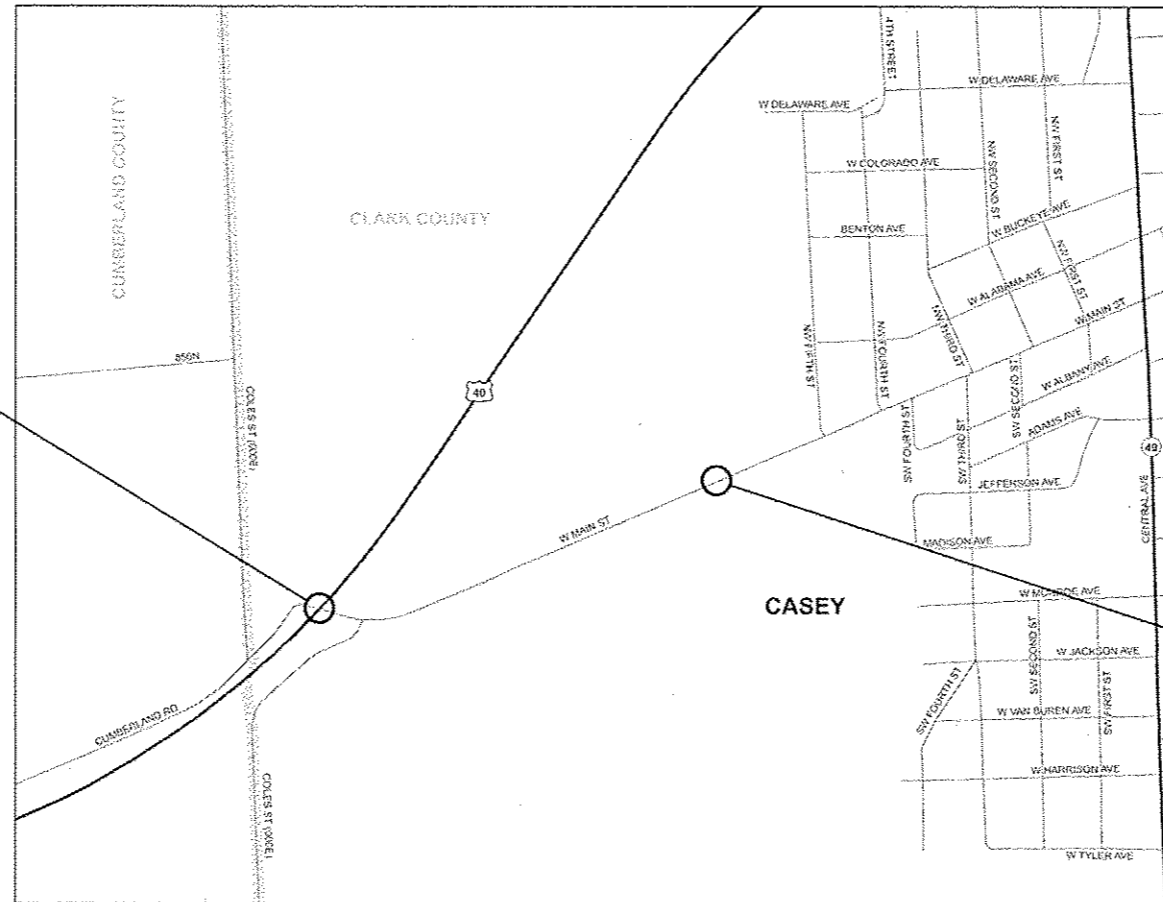

PROJECT ENDS:
STA. 415 + 83

PROJECT BEGINS:
STA. 395 + 16

GROSS LENGTH = 2067 FT. = 0.39 MILE
NET LENGTH = 2067 FT. = 0.39 MILE

STATE OF ILLINOIS
DEPARTMENT OF TRANSPORTATION
DIVISION OF HIGHWAYS

SUBMITTED SEPT 26 20 13
Roger L. Drishell, P.E.
DEPUTY DIRECTOR OF HIGHWAYS, REGION ENGINEER

Dec 6 20 13
John D. Baranzelli, P.E.
ENGINEER OF DESIGN AND ENVIRONMENT

Dec 6 20 13
Omer Osman, P.E.
DIRECTOR OF HIGHWAYS, CHIEF ENGINEER

PRINTED BY THE AUTHORITY
OF THE STATE OF ILLINOIS

INDEX OF SHEETS

SHEET NO.	ITEM
1	COVER SHEET
2	INDEX OF SHEETS & GENERAL NOTES
3-4	SUMMARY OF QUANTITIES
5-6	TYPICAL SECTIONS
7	SCHEDULES OF QUANTITIES
8-11	PLAN SHEETS
12	ENTRANCE SCHEDULE AND DETAILS
13	CONSTRUCTION DETAILS

THE FOLLOWING STANDARDS ARE A PART OF THESE PLANS AND ARE INCLUDED AFTER SHEET NO. 13:

STD. NO.	DESCRIPTION
000001-06	STANDARD SYMBOLS, ABBREVIATIONS AND PATTERNS
406201-01	MAILBOX TURNOUT
442201-03	CLASS C & D PATCHES
701006-05	OFF-RD OPERATIONS, 2L, 2W, 15' TO 24" FROM PAVEMENT EDGE, 45 MPH +
701011-04	OFF-RD MOVING OPERATIONS, 2L, 2W, DAY ONLY, 45 MPH +
701301-04	LANE CLOSURE, 2L, 2W, SHORT TIME OPERATIONS
701306-02	LANE CLOSURE, 2L, 2W, SLOW MOVING OPERATIONS DAY ONLY, FOR SPEEDS >= 45 MPH
701311-03	LANE CLOSURE 2L, 2W, MOVING OPERATIONS - DAY ONLY
701336-06	LANE CLOSURE, WORK AREAS IN SERIES
701901-03	TRAFFIC CONTROL DEVICES
780001-04	TYPICAL PAVEMENT MARKINGS

GENERAL NOTES

THIS SECTION SHALL BE CONSTRUCTED IN ACCORDANCE WITH THE PLANS; THE "STANDARD SPECIFICATIONS FOR ROAD AND BRIDGE CONSTRUCTION", ADOPTED JANUARY 1, 2012; THE "SUPPLEMENTAL SPECIFICATIONS AND RECURRING SPECIAL PROVISIONS", ADOPTED JANUARY 1, 2013, AND THE SPECIAL PROVISIONS INCLUDED IN THIS PROPOSAL.

THE WORK INCLUDED IN THIS SECTION IS LOCATED ON SBI ROUTE 11 (OLD US ROUTE 40) IN CLARK COUNTY BEGINNING AT US ROUTE 40 AND EXTENDING EAST FOR 0.4 MILES TO 0.2 MILES WEST OF NW 5TH STREET IN CASEY. THE WORK INCLUDED IN THIS SECTION CONSISTS OF PAVEMENT PATCHING, HOT-MIX ASPHALT SURFACE REMOVAL, OVERLAYING WITH HOT-MIX ASPHALT LEVELING BINDER AND SURFACE COURSE, AGGREGATE SHOULDER WEDGE, PIPE CULVERT REMOVAL AND REPLACEMENT, PAVEMENT MARKING, TRAFFIC CONTROL, AND ANY WORK NECESSARY TO COMPLETE THIS SECTION.

THE CONTRACTOR SHALL PROVIDE INTERNET ACCESSIBILITY TO THE HOT-MIX ASPHALT PLANT QUALITY CONTROL LAB SO THAT HOT-MIX ASPHALT PLANT REPORTS CAN BE E-MAILED TO THE DISTRICT HEADQUARTERS. THIS WORK SHALL BE INCLUDED IN THE COST OF ALL HOT-MIX ASPHALT ITEMS.

VIBRATORY ROLLERS IN DYNAMIC MODE WILL NOT BE PERMITTED WITHIN THE CORPORATE LIMITS OF CASEY. DENSITY REQUIREMENTS MUST STILL BE MET.

THE CONTRACTOR SHALL USE EITHER RC-70, SS1H, OR SS-1HP, APPLIED AT THE RATE DIRECTED BY THE ENGINEER, FOR THE PAY ITEM BITUMINOUS MATERIALS (PRIME COAT).

THE RESIDENT ENGINEER SHALL BE THE SOLE JUDGE CONCERNING THE CURING TIME FOR ALL HOT-MIX ASPHALT.

GENERAL NOTES (Cont'd)

THE PAY ITEM TEMPORARY RAMP HAS BEEN INCLUDED FOR THE CONSTRUCTION OF TEMPORARY RAMPS IN ACCORDANCE WITH ARTICLE 406.08 OF THE STANDARD SPECIFICATIONS. THE CONTRACT UNIT PRICE PER SQUARE YARD FOR TEMPORARY RAMP SHALL INCLUDE BOTH THE INSTALLATION AND THE REMOVAL OF THE RAMPS.

PAVEMENT MARKING SHALL BE APPLIED IN ACCORDANCE WITH SECTION 780 OF THE STANDARD SPECIFICATIONS. SHORT TERM PAVEMENT MARKING SHALL BE APPLIED TO THE MILLED SURFACE, BITUMINOUS MATERIALS (PRIME COAT), HOT-MIX ASPHALT LEVEL BINDER, AND HOT-MIX ASPHALT SURFACE COURSE AS SPECIFIED IN SECTION 703 OF THE STANDARD SPECIFICATIONS. TEMPORARY TAPE SHALL BE USED ON THE SURFACE COURSE AND PAINT SHALL BE USED ON MILLED SURFACES.

THE TOTAL QUANTITY OF PAINT PAVEMENT MARKING - LINE 4" CONSISTS OF 1,384 FEET OF YELLOW.

THE FOLLOWING MIXTURE REQUIREMENTS ARE APPLICABLE FOR THIS PROJECT:

LEVEL BINDER (3/4")

APPLICATION:	LEVEL BINDER, MACHINE METHOD, N70
PG GRADE:	PG 64-22
DESIGN AIR VOIDS:	4.0% \pm NDDESIGN = 70
MIXTURE COMPOSITION:	IL-9.5
FRICTION AGGREGATE:	N/A

SURFACE COURSE (1.5")

APPLICATION:	HOT MIX ASPHALT SURFACE COURSE, MIX C, N70
PG GRADE:	PG 64-22
DESIGN AIR VOIDS:	4.0% \pm NDDESIGN = 70
MIXTURE COMPOSITION:	IL-9.5
FRICTION AGGREGATE:	MIXTURE C

INCIDENTAL HMA

APPLICATION:	HOT MIX ASPHALT SURFACE COURSE, MIX C, N70
PG GRADE:	PG 64-22
DESIGN AIR VOIDS:	4.0% \pm NDDESIGN = 70
MIXTURE COMPOSITION:	IL-9.5
FRICTION AGGREGATE:	MIXTURE C

CLASS D PAVEMENT PATCHING

APPLICATION:	HOT MIX ASPHALT BINDER COURSE, IL-19, N70
PG GRADE:	PG 64-22
DESIGN AIR VOIDS:	4.0% \pm NDDESIGN = 70
MIXTURE COMPOSITION:	IL-19.0
FRICTION AGGREGATE:	N/A

THE FOLLOWING RATES OF APPLICATION HAVE BEEN USED IN CALCULATING PLAN QUANTITIES:

HOT MIX ASPHALT	112 LBS/SO YD/IN
BITUMINOUS MATERIALS PRIME COAT	0.10 GALLONS/SO YD
AGGREGATE PRIME COAT	2.00 LBS/SO YD
GRANULAR MATERIAL	2.05 TONS/CU YD

FILE NAME :	USER NAME : staffennk	DESIGNED -	REVISED -	STATE OF ILLINOIS DEPARTMENT OF TRANSPORTATION	INDEX OF SHEETS AND GENERAL NOTES	S.B.I. RTE.	SECTION	COUNTY	TOTAL SHEETS	SHEET NO.
c:\p\work\p\dot\staffennk\030510\07	4840-sht-index.dgn	DRAWN -	REVISED -			11	07 HMA RESURF 2014-4	CLARK	13	2
	PLOT SCALE = 1/8"=0'00" / 1"	CHECKED -	REVISED -			CONTRACT NO. 74640				
Default	PLOT DATE = 8/28/2013	DATE -	REVISED -			ILLINOIS FED. AID PROJECT				
					SCALE: N/A	SHEET 1 OF 1 SHEETS		STA.	TO STA.	

SUMMARY OF QUANTITIES			TOTAL QUANTITIES	CONSTRUCTION TYPE CODE		
CODE NO	ITEM	UNIT		100% STATE 0005		
20800150	TRENCH BACKFILL	CU YD	13	13		
40200800	AGGREGATE SURFACE COURSE, TYPE B	TON	23	23		
40600100	BITUMINOUS MATERIALS (PRIME COAT)	GALLON	570	570		
40600300	AGGREGATE (PRIME COAT)	TON	6	6		
40600635	LEVELING BINDER (MACHINE METHOD), N70	TON	219	219		
40600982	HOT-MIX ASPHALT SURFACE REMOVAL - BUTT JOINT	SO YD	80	80		
40600990	TEMPORARY RAMP	SO YD	101	101		
40603315	HOT-MIX ASPHALT SURFACE COURSE, MIX "C", N70	TON	479	479		
40800050	INCIDENTAL HOT-MIX ASPHALT SURFACING	TON	92	92		
44000155	HOT-MIX ASPHALT SURFACE REMOVAL, 1 1/2"	SO YD	478	478		
44201798	CLASS D PATCHES, TYPE I, 13 INCH	SO YD	30	30		
44201803	CLASS D PATCHES, TYPE II, 13 INCH	SO YD	125	125		
44201807	CLASS D PATCHES, TYPE III, 13 INCH	SO YD	58	58		
48102100	AGGREGATE WEDGE SHOULDER, TYPE B	TON	83	83		

SUMMARY OF QUANTITIES			TOTAL QUANTITIES	CONSTRUCTION TYPE CODE		
CODE NO	ITEM	UNIT		100% STATE 0005		
50105220	PIPE CULVERT REMOVAL	FOOT	88	88		
54214941	PRECAST REINFORCED CONCRETE FLARED END SECTIONS - ARCH, EQUIVALENT ROUND-SIZE 36"	EACH	2	2		
542A5473	PIPE CULVERTS, CLASS A, TYPE 1 EQUIVALENT ROUND-SIZE 18"	FOOT	50	50		
542A5491	PIPE CULVERTS, CLASS A, TYPE 1 EQUIVALENT ROUND-SIZE 36"	FOOT	38	38		
67100100	MOBILIZATION	L SUM	1	1		
70100460	TRAFFIC CONTROL AND PROTECTION, STANDARD 701306	L SUM	1	1		
70100600	TRAFFIC CONTROL AND PROTECTION, STANDARD 701336	L SUM	1	1		
70300100	SHORT TERM PAVEMENT MARKING	FOOT	624	624		
70301000	WORK ZONE PAVEMENT MARKING REMOVAL	SO FT	69	69		
* 78001110	PAINT PAVEMENT MARKING - LINE 4"	FOOT	1384	1384		
X4401198	HOT-MIX ASPHALT SURFACE REMOVAL, VARIABLE DEPTH	SO YD	5141	5141		

* SPECIALTY ITEM

FILE NAME =	USER NAME = steffernk	DESIGNED -	REVISED -	STATE OF ILLINOIS DEPARTMENT OF TRANSPORTATION	SUMMARY OF QUANTITIES		S.B.I. RTE.	SECTION	COUNTY	TOTAL SHEETS	SHEET NO.
c:\pwork\pedit\steffernk\00251510\07	4040-shr-soq.dgn	DRAWN -	REVISED -		11	D7 HMA RESURF 2014-4	CLARK	13	3		
	PLOT SCALE = 1/8"=1'-0"	CHECKED -	REVISED -		SCALE: N/A		SHEET 1 OF 2 SHEETS	STA.	TO STA.	CONTRACT NO. 74640	
Default	PLOT DATE = 8/28/2013	DATE -	REVISED -		ILLINOIS FED. AID PROJECT						

SUMMARY OF QUANTITIES			TOTAL QUANTITIES	CONSTRUCTION TYPE CODE		
CODE NO	ITEM	UNIT		100% STATE 0005		
X7015005	CHANGEABLE MESSAGE SIGN	CAL DA	28	28		

TYPICAL CROSS SECTION

S.B.I. ROUTE 11
STA. 395+16 TO STA. 409+59.80

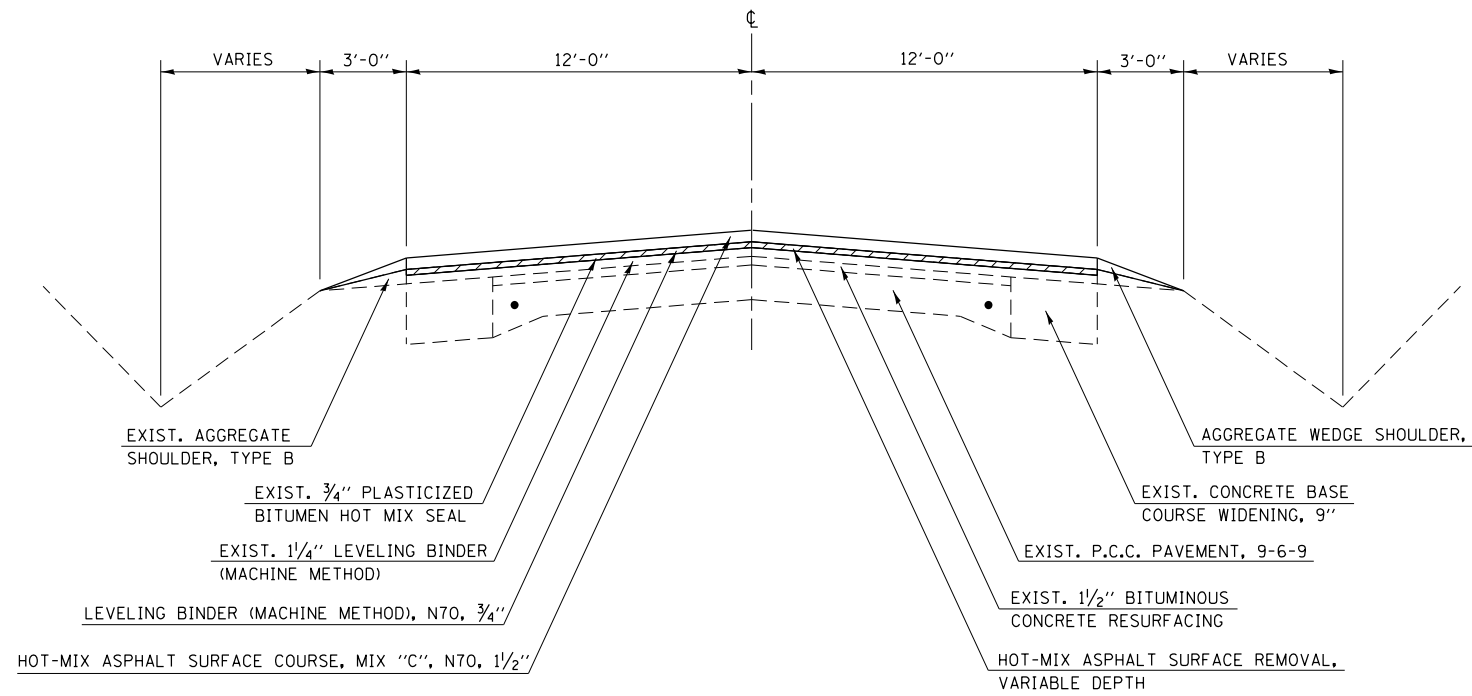

DRAWING NOT TO SCALE

TYPICAL CROSS SECTION

S.B.I. ROUTE 11
STA. 409+59.80 TO STA. 414+74

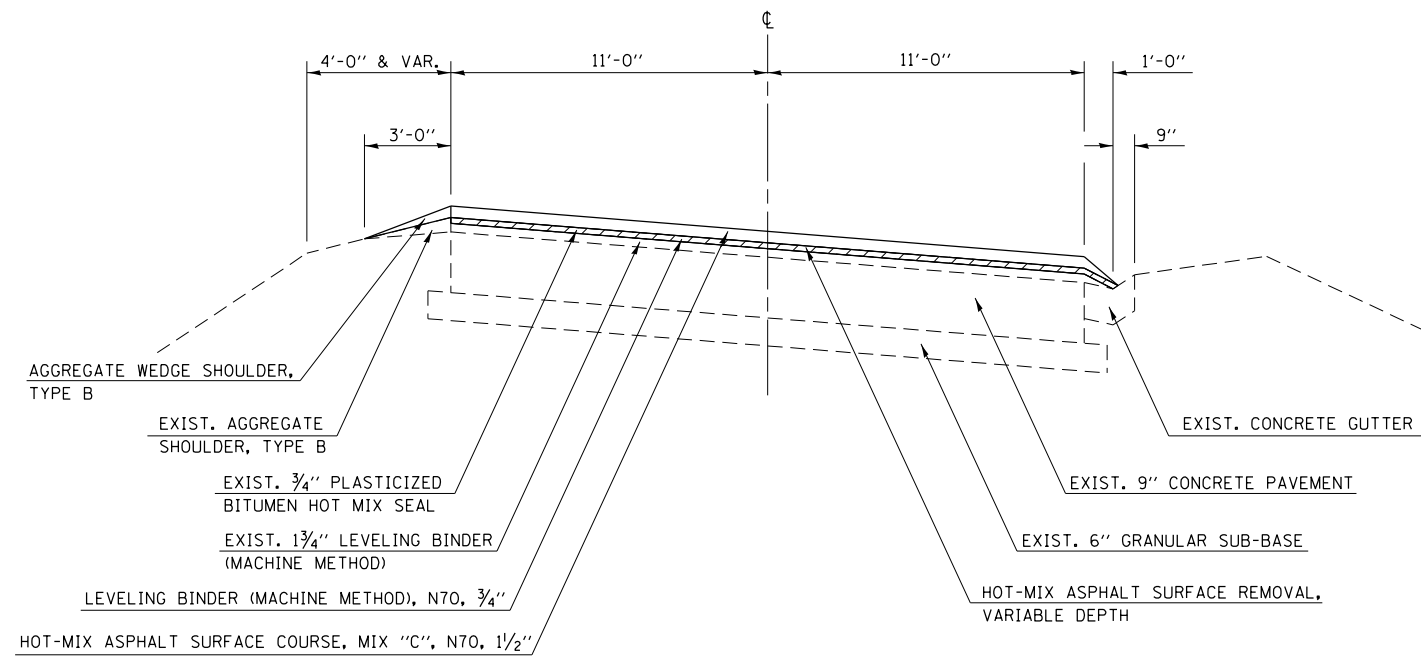

DRAWING NOT TO SCALE

FILE NAME =	USER NAME = steffenmk	DESIGNED -	REVISED -
ei:\pwork\pwork\stevfenmk\d0351510\07	4640-sh-typicals.dgn	DRAWN -	REVISED -
Default	PLOT SCALE = 100.0000' / in.	CHECKED -	REVISED -
	PLOT DATE = 8/28/2013	DATE -	REVISED -

STATE OF ILLINOIS
DEPARTMENT OF TRANSPORTATION

TYPICAL CROSS SECTIONS

SCALE: N/A SHEET 1 OF 2 SHEETS STA. TO STA.

S.B.I. RTE.	SECTION	COUNTY	TOTAL SHEETS	SHEET NO.
11	D7 HMA RESURF 2014-4	CLARK	13	5
CONTRACT NO. 74640			ILLINOIS FED. AID PROJECT	

TYPICAL CROSS SECTION

S.B.I. ROUTE 11
STA. 414+74 TO STA. 415+04

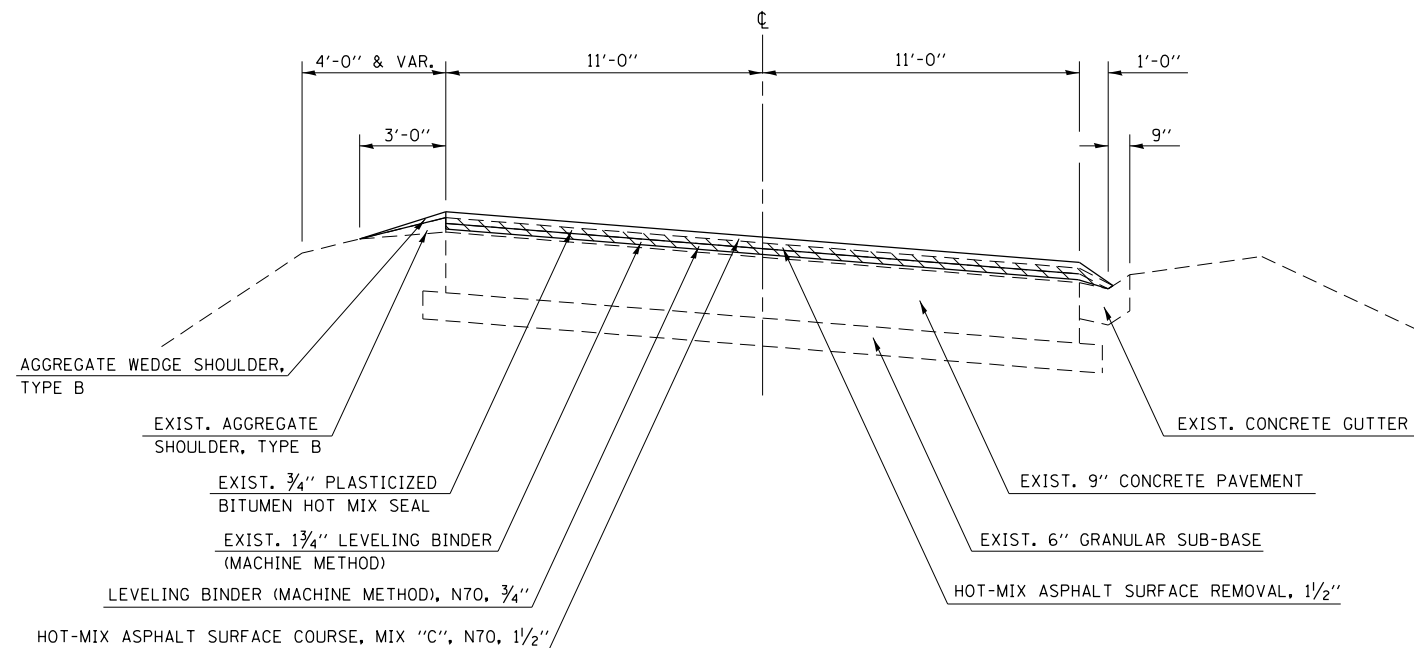

 HOT-MIX ASPHALT SURFACE REMOVAL, 1 1/2"

DRAWING NOT TO SCALE

TYPICAL CROSS SECTION

S.B.I. ROUTE 11
STA. 415+04 TO STA. 415+83

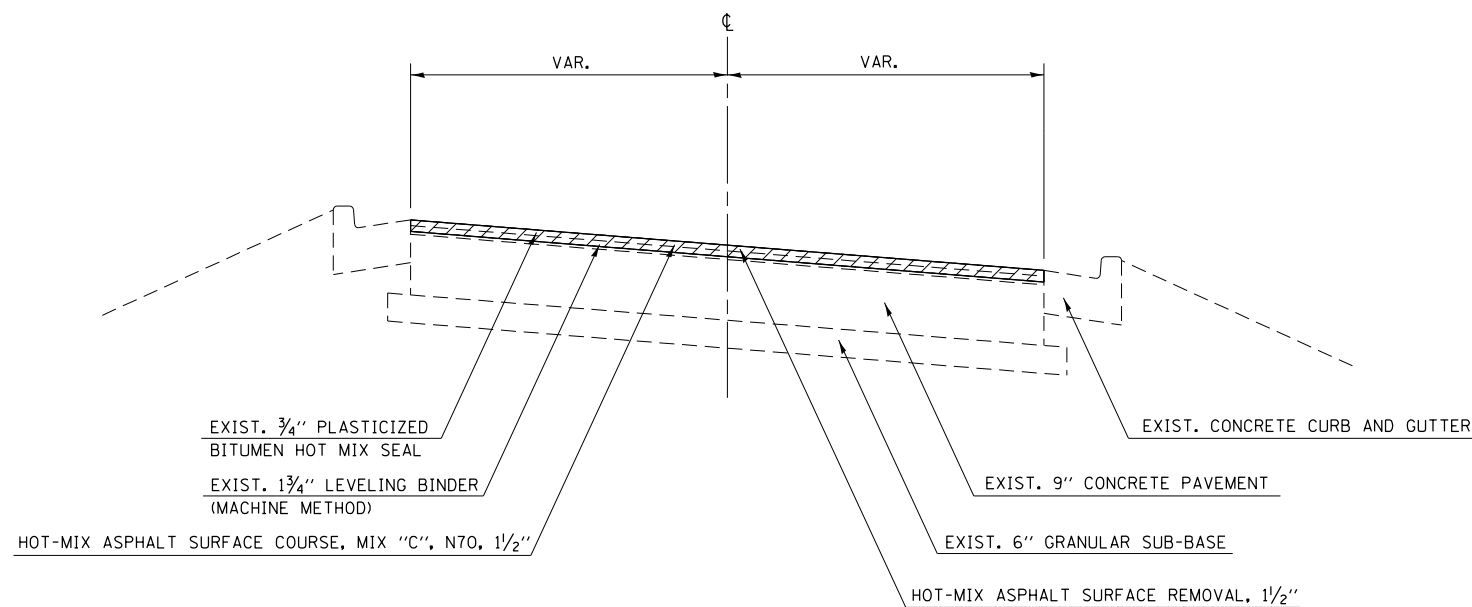

 HOT-MIX ASPHALT SURFACE REMOVAL, 1 1/2"

DRAWING NOT TO SCALE

FILE NAME =	USER NAME = steffenmk	DESIGNED -	REVISED -
c:\pwork\pwork\steffenmk\d0351510\07	4640-sh-typicals.dgn	DRAWN -	REVISED -
Default	PLOT SCALE = 100.0000' / in.	CHECKED -	REVISED -
	PLOT DATE = 8/28/2013	DATE -	REVISED -

STATE OF ILLINOIS
DEPARTMENT OF TRANSPORTATION

TYPICAL CROSS SECTIONS

SCALE: N/A SHEET 2 OF 2 SHEETS STA. TO STA.

S.B.I. RTE.	SECTION	COUNTY	TOTAL SHEETS	SHEET NO.
11	D7 HMA RESURF 2014-4	CLARK	13	6
CONTRACT NO. 74640			ILLINOIS FED. AID PROJECT	

RESURFACING SCHEDULE		LENGTH	HOT-MIX ASPHALT SURFACE REMOVAL - BUTT JOINT	HOT-MIX ASPHALT SURFACE REMOVAL, VARIABLE DEPTH	HOT-MIX ASPHALT SURFACE REMOVAL, 1 1/2"	BITUMINOUS MATERIALS (PRIME COAT)	AGGREGATE (PRIME COAT)	HOT-MIX ASPHALT SURFACE COURSE, MIX "C", NTO	LEVELING BINDER (MACHINE METHOD), NTO	AGGREGATE WEDGE SHOULDER, TYPE B	TEMPORARY RAMP
STATION	TO STATION	FOOT	SO YD	SO YD	SO YD	GALLON	TON	TON	TON	TON	SO YD
395+16.00	TO 395+46.00	30.0	80			8	0.1	7	2	2	13
395+46.00	TO 400+00.00	454.0		1211		121	1.2	102	51	20	
400+00.00	TO 409+76.00	976.0		2603		260	2.6	219	109	43	
409+76.00	TO 414+74.00	498.0		1328		133	1.3	112	56	11	
414+74.00	TO 415+04.00	30.0			80	8	0.1	7	2	1	
415+04.00	TO 415+83.00	79.0			398	40	0.4	33	0	6	87
TOTALS			80	5141	478	570	6	479	219	83	101

PAVEMENT MARKING SCHEDULE		LENGTH	PAINT PAVEMENT MARKING - LINE 4" (YELLOW)	SHORT-TERM PAVEMENT MARKING	WORK ZONE PAVEMENT MARKING REMOVAL
STATION	TO STATION	FOOT		FOOT	SQ FT
395+16.00	TO 400+00.00	484.0	121	144	16
400+00.00	TO 405+00.00	500.0	125	156	17
405+00.00	TO 410+50.00	550.0	138	168	19
410+50.00	TO 415+50.00	500.0	1000	156	17
TOTALS			1384	624	69

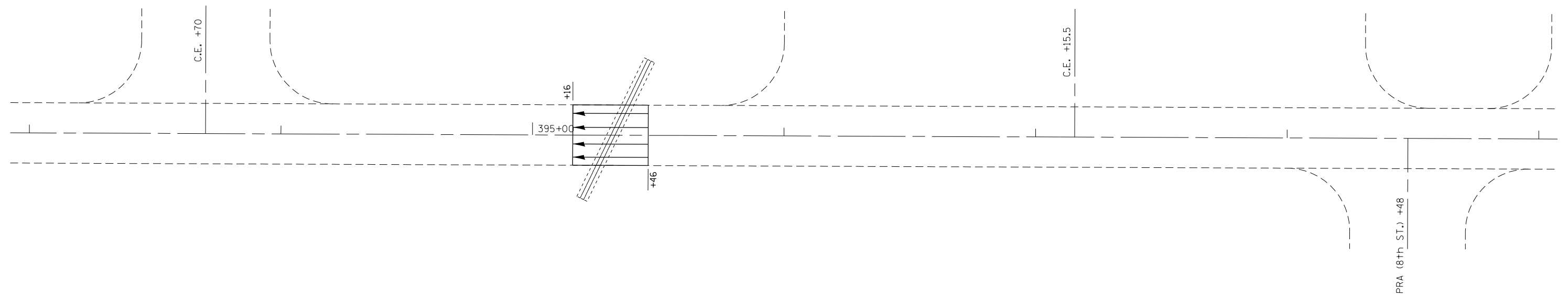

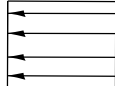

 HMA SURFACE REMOVAL - BUTT JOINT

FILE NAME =	USER NAME = steffenmk	DESIGNED -	REVISED -
ci:\pw\work\p\idot\steffenmk\d0351510\07	4640-sh1-plan.dgn	DRAWN -	REVISED -
Default	PLOT SCALE = 40.0000' / in.	CHECKED -	REVISED -
	PLOT DATE = 8/28/2013	DATE -	REVISED -

STATE OF ILLINOIS
DEPARTMENT OF TRANSPORTATION

PLAN			
SCALE: 20	SHEET 1	OF 4	SHEETS
STA. 395+16	TO STA. 399+00		

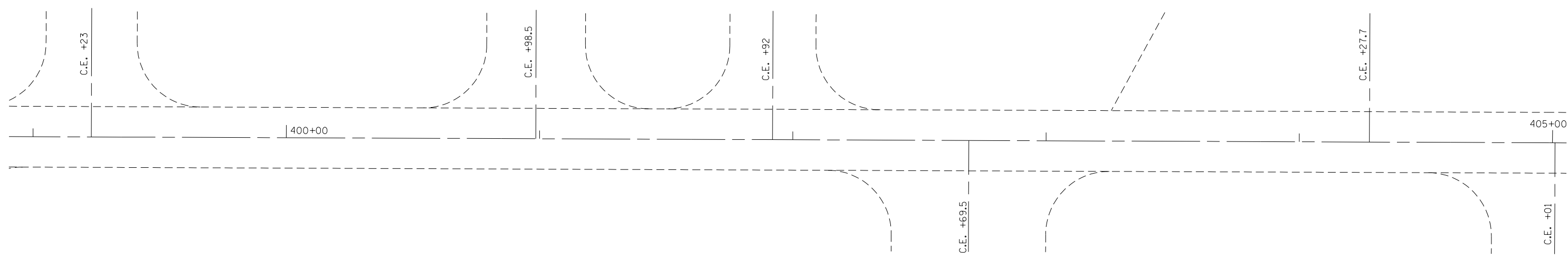
S.B.I. RTE.	SECTION	COUNTY	TOTAL SHEETS	SHEET NO.
11	D7 HMA RESURF 2014-4	CLARK	13	8
ILLINOIS FED. AID PROJECT			CONTRACT NO. 74640	



FILE NAME =	USER NAME = steffenmk	DESIGNED -	REVISED -
c:\pw\work\p\idot\steffenmk\d0351510\07	4640-sh:plan.dgn	DRAWN -	REVISED -
Default	PLOT SCALE = 40.0000' / in.	CHECKED -	REVISED -
	PLOT DATE = 8/28/2013	DATE -	REVISED -

**STATE OF ILLINOIS
DEPARTMENT OF TRANSPORTATION**

PLAN

SCALE: 20 SHEET 2 OF 4 SHEETS STA. 399+00 TO STA. 405+00

S.B.I. RTE.	SECTION	COUNTY	TOTAL SHEETS	SHEET NO.
11	D7 HMA RESURF 2014-4	CLARK	13	9
CONTRACT NO. 74640			ILLINOIS FED. AID PROJECT	

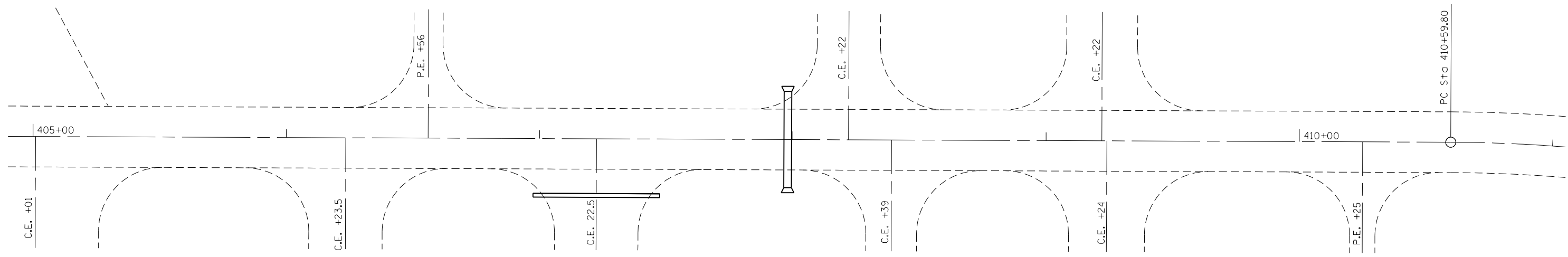

CULVERT WORK AT RT. STA. 407+23

PIPE CULVERT REMOVAL
 QTY = 50 FOOT

PIPE CULVERTS, CLASS A, TYPE I
 EQUIVALENT ROUND-SIZE 18"
 QTY = 50 FOOT

TRENCH BACKFILL
 QTY = 6 CU YD

PIPE TO BE REMOVED IS AN 18" DIA.
 CMP IN ENTRANCE TO PROPANE COMPANY

CULVERT WORK AT STA. 407+98

PIPE CULVERT REMOVAL
 QTY = 38 FOOT

PIPE CULVERTS, CLASS A, TYPE I
 EQUIVALENT ROUND-SIZE 36"
 QTY = 38 FOOT

PRC FLARED END SECTION EORS 36" = 2 EACH

TRENCH BACKFILL
 QTY = 7 CU YD

PIPE TO BE REMOVED IS A 36" DIA. EORS

FILE NAME =	USER NAME = steffenmk	DESIGNED -	REVISED -
ei:\pw\work\p\dot\steffenmk\d0351510\07	4640-sh:plan.dgn	DRAWN -	REVISED -
Default	PLOT SCALE = 40.0000' / in.	CHECKED -	REVISED -
	PLOT DATE = 8/28/2013	DATE -	REVISED -

**STATE OF ILLINOIS
 DEPARTMENT OF TRANSPORTATION**

PLAN			
SCALE: 20	SHEET 3	OF 4	SHEETS
STA. 405+00	TO STA. 411+00		

S.B.I. RTE.	SECTION	COUNTY	TOTAL SHEETS	SHEET NO.
11	D7 HMA RESURF 2014-4	CLARK	13	10
CONTRACT NO. 74640				
ILLINOIS FED. AID PROJECT				

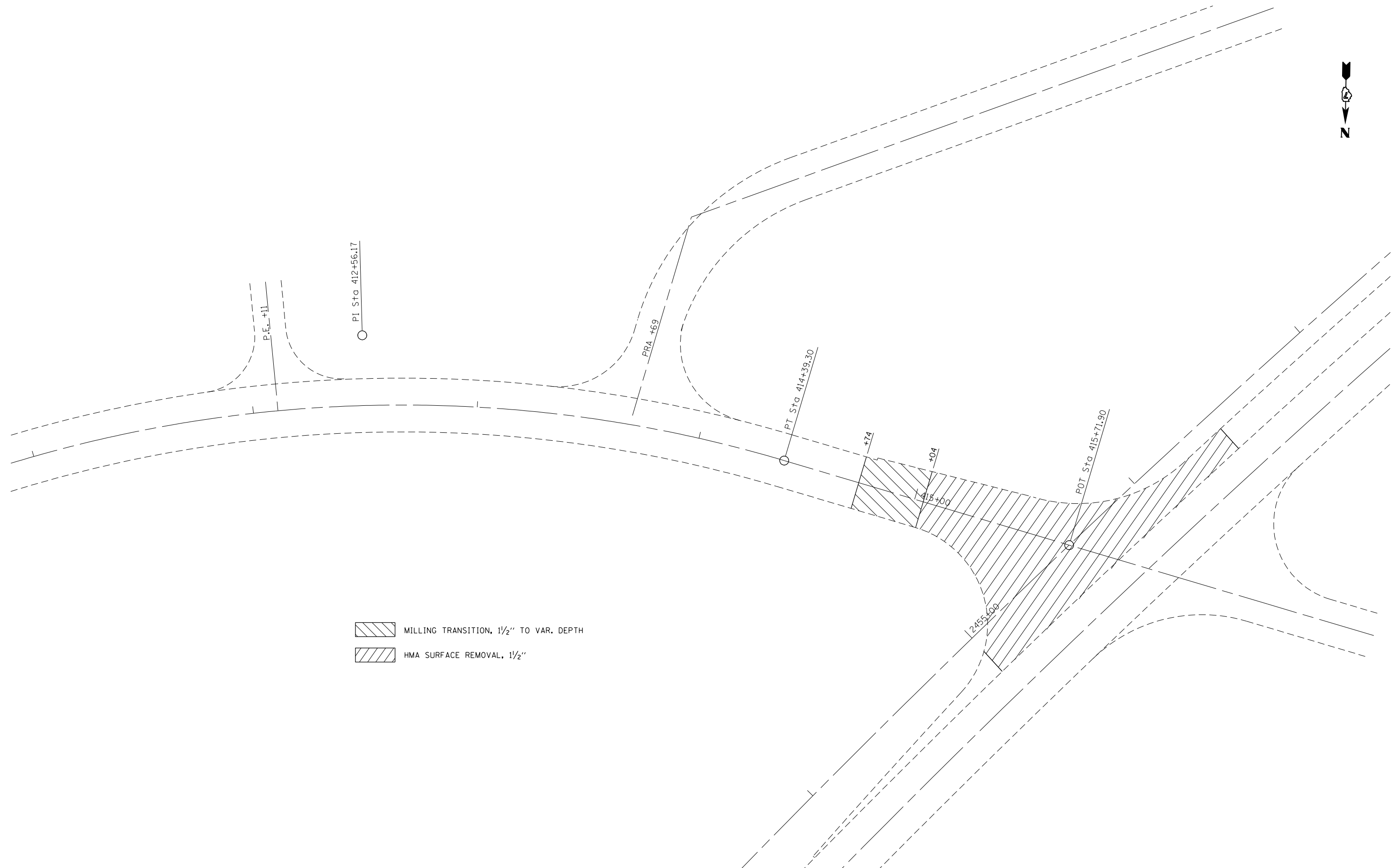

- MILLING TRANSITION, 1/2" TO VAR. DEPTH
- HMA SURFACE REMOVAL, 1/2"

FILE NAME =	USER NAME = steffenmk	DESIGNED -	REVISED -
c:\pw\work\p\dot\stef\enmk\d0351510\07	4640-sh\plan.dgn	DRAWN -	REVISED -
Default	PLOT SCALE = 40.0000' / in.	CHECKED -	REVISED -
	PLOT DATE = 8/28/2013	DATE -	REVISED -

**STATE OF ILLINOIS
DEPARTMENT OF TRANSPORTATION**

PLAN

SCALE: 20 SHEET 4 OF 4 SHEETS STA. 411+00 TO STA. 415+71.90

S.B.I. RTE.	SECTION	COUNTY	TOTAL SHEETS	SHEET NO.
11	D7 HMA RESURF 2014-4	CLARK	13	11
ILLINOIS FED. AID PROJECT			CONTRACT NO. 74640	

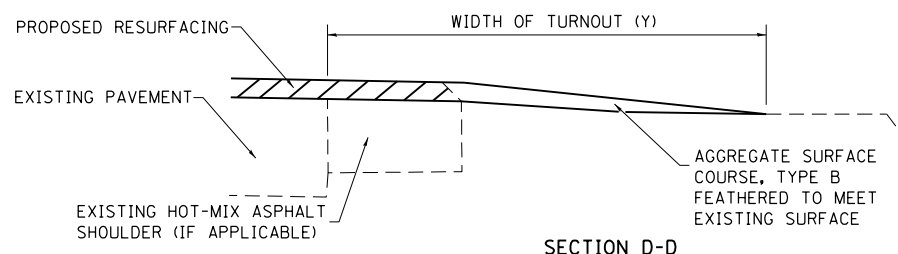
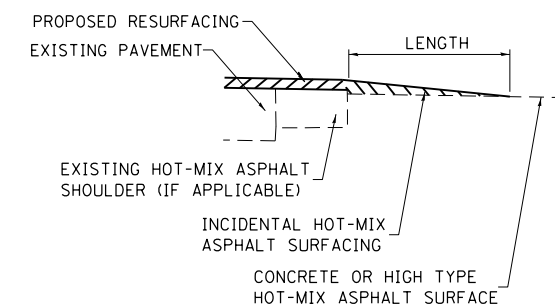
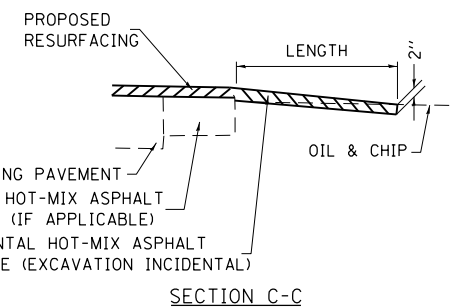
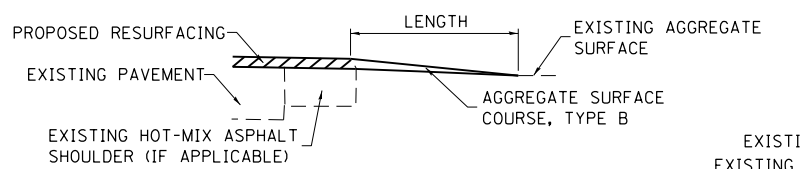
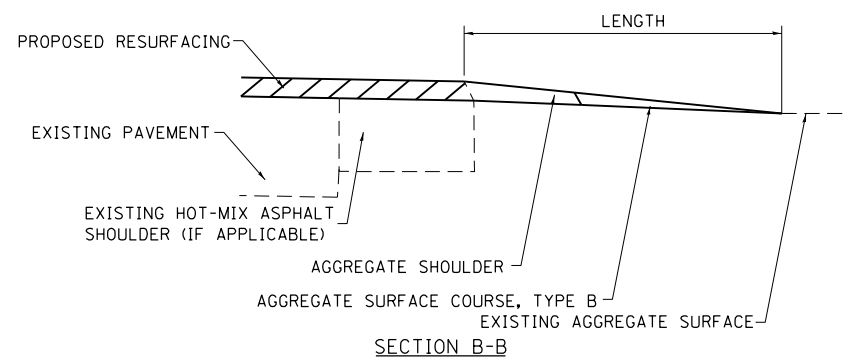
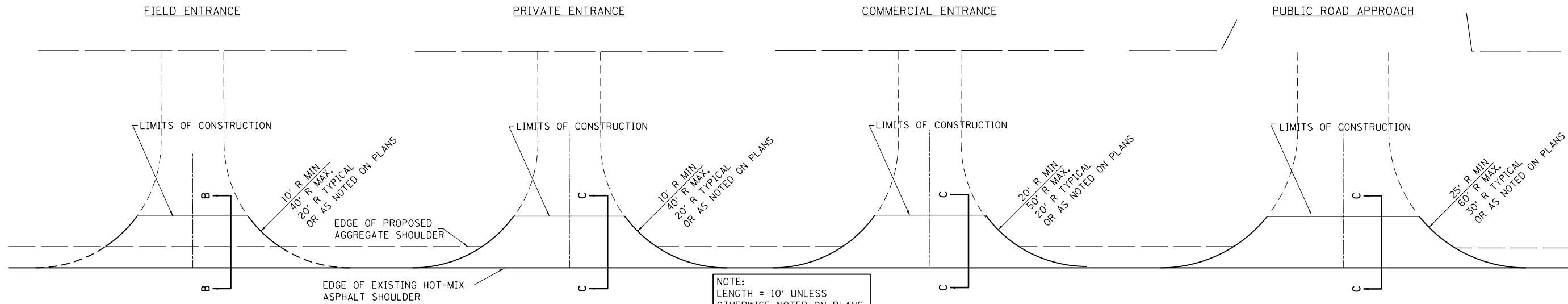

TYPICAL SECTION AT MAILBOX TURNOUT
NOTE: SEE STANDARD 406201 FOR MAILBOX TURNOUT DETAILS

NOTES

THE COST OF THE ASPHALT MATERIALS, AND AGGREGATE (PRIME COAT) FOR ENTRANCES AND PUBLIC ROADS AND APPROACHES SHALL BE INCLUDED IN THE PAY ITEM INCIDENTAL HOT-MIX ASPHALT SURFACING.

THE COST OF EXCAVATION IS INCLUDED IN THE PAY ITEM INCIDENTAL HOT-MIX ASPHALT SURFACING.

IF THERE IS NOT EXISTING HOT-MIX ASPHALT SHOULDER THEN THE ENTRANCE TAPER STARTS AT THE EDGE OF EXISTING PAVEMENT.

THE COST OF THE BITUMINOUS MATERIALS AND AGGREGATE (PRIME COAT) FOR ENTRANCES AND PUBLIC ROAD APPROACHES SHALL BE INCLUDED IN THE PAY ITEM INCIDENTAL HOT-MIX ASPHALT SURFACING.

SIDE	STATION	TYPE	INCIDENTAL HOT-MIX ASPHALT SURFACING	
			TON	TON
LT	397+16	CE	20.7	
RT	398+48	PRA	5.8	
RT	399+23	CE	6.3	
LT	400+98	CE	4.5	
LT	401+92	CE	3.6	
RT	402+70	CE	5.9	
LT	404+30	CE		16.6
RT	405+01	CE	5.3	
LT	405+35	MBT1		2.6
RT	406+24	CE		3.8
LT	406+56	PE	2.2	
RT	407+23	CE	4.2	
LT	408+22	PE	2.1	
RT	408+39	CE	2.5	
LT	408+92	MBT1	2.6	
LT	409+22	PE	4.4	
RT	409+24	CE	4.5	
RT	401+24	PE	1.7	
LT	410+32	MBT2	4.7	
LT	12+11	PE	2.4	
LT	412+35	MBT1	2.6	
LT	413+71	PRA	5.7	
		TOTALS	92	23

SIDE	STATION	TYPE	INCIDENTAL HOT-MIX ASPHALT SURFACING	
			TON	TON

FE=FIELD ENTRANCE PRA - PUBLIC ROAD APPROACH
PE=PRIVATE ENTRANCE MBT - MAILBOX TURNOUT
CE=COMMERCIAL ENTRANCE

FILE NAME =	USER NAME = steffernk	DESIGNED - 08-03-99	REVISED - 03-13-07
ca:\pwork\pwork\stef\stef\m\10351510\07	4640-shr-sch.dgn	DRAWN -	REVISED -
	PLOT SCALE = 100.0000' / 1\"/>		
	PLOT DATE = 8/28/2013	CHECKED -	REVISED -
		DATE -	REVISED -

**STATE OF ILLINOIS
DEPARTMENT OF TRANSPORTATION**

**RURAL ENTRANCE SCHEDULE AND MAILBOX TURNOUT DETAILS
WITH SHOULDERS**

SCALE: N/A SHEET NO. 1 OF 1 SHEETS STA. TO STA.

S.B.1. RTE.	SECTION	COUNTY	TOTAL SHEETS	SHEET NO.
11	D7 HMA RESURF 2014-4	CLARK	13	12
CONTRACT NO. 74640				
FED. ROAD DIST. NO. ILLINOIS FED. AID PROJECT				

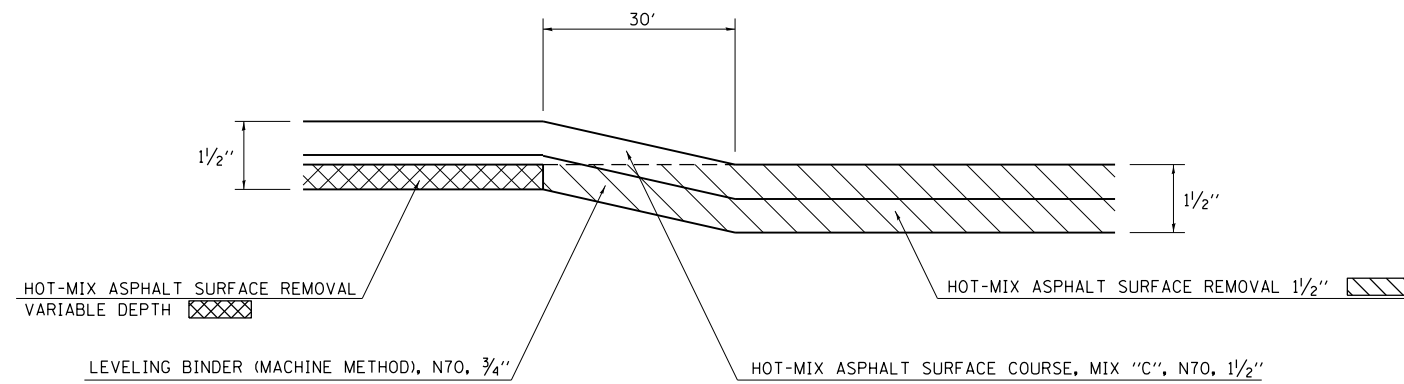

MILLING TRANSITION DETAIL

STA. 414+74 TO STA. 415+04

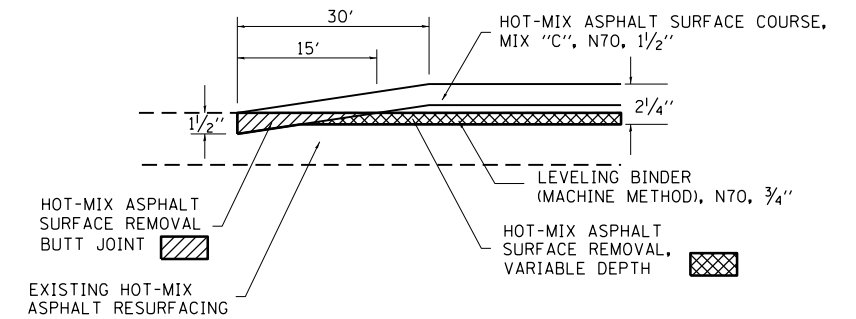

BUTT JOINT DETAIL

STA. 395+16 TO STA. 395+46

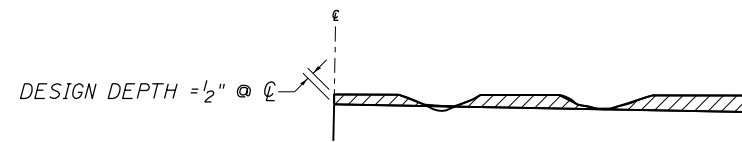

NOTES:

1. MILLING SHALL BE DONE TO ATTAIN A 3/16 "/li>
- 2. EXISTING S.E. AND S.E. TRANSITIONS SHALL BE MAINTAINED UNLESS OTHERWISE SHOWN ON THE PLANS.
- 3. MILLING TO THE BOTTOM OF WHEEL RUTS SHALL NOT BE NECESSARY UNLESS REQUIRED TO OBTAIN SLOPE OR THE DESIGN DEPTH AT CENTERLINE.
- 4. THE AVERAGE DEPTH OF MILLING IS ESTIMATED TO BE 1/2" BUT MAY VARY IN ISOLATED LOCATIONS.

HOT-MIX ASPHALT SURFACE REMOVAL (VARIABLE DEPTH) DETAIL

DRAWINGS NOT TO SCALE

FILE NAME =	USER NAME = steffenmk	DESIGNED -	REVISED -	STATE OF ILLINOIS DEPARTMENT OF TRANSPORTATION	CONSTRUCTION DETAILS			S.B.I. RTE.	SECTION	COUNTY	TOTAL SHEETS	SHEET NO.			
c:\pwork\pwork\dot\steffenmk\d0351510\07	4640-shit-details.dgn	DRAWN -	REVISED -		SCALE: N/A	SHEET 1	OF 1	SHEETS	STA.	TO STA.	11	D7 HMA RESURF 2014-4	CLARK	13	13
Default	PLOT SCALE = 100.0000' / in.	CHECKED -	REVISED -								CONTRACT NO. 74640				
	PLOT DATE = 8/28/2013	DATE -	REVISED -								ILLINOIS FED. AID PROJECT				