

SYMBOLS

- PRE-STAGE CONSTRUCTION
- STAGE CONSTRUCTION
- BRIDGE CONSTRUCTION THIS STAGE
- SIGN
- DIRECTION INDICATOR BARRICADE

- ARROW BOARD
- TYPE II BARRICADE OR DRUM
- DIRECTIONAL INDICATOR BARRICADE WITH STEADY BURN MONODIRECTIONAL LIGHT
- TYPE II BARRICADE, DRUM OR VERTICAL BARRICADE W/ STEADY BURN MONODIRECTIONAL LIGHT
- CONE, DRUM OR BARRICADE

- DRUM WITH STEADY BURNING MONODIRECTIONAL LIGHT
- TYPE III BARRICADE
- TEMPORARY CONCRETE BARRIER
- IMPACT ATTENUATOR
- DIRECTION OF TRAFFIC

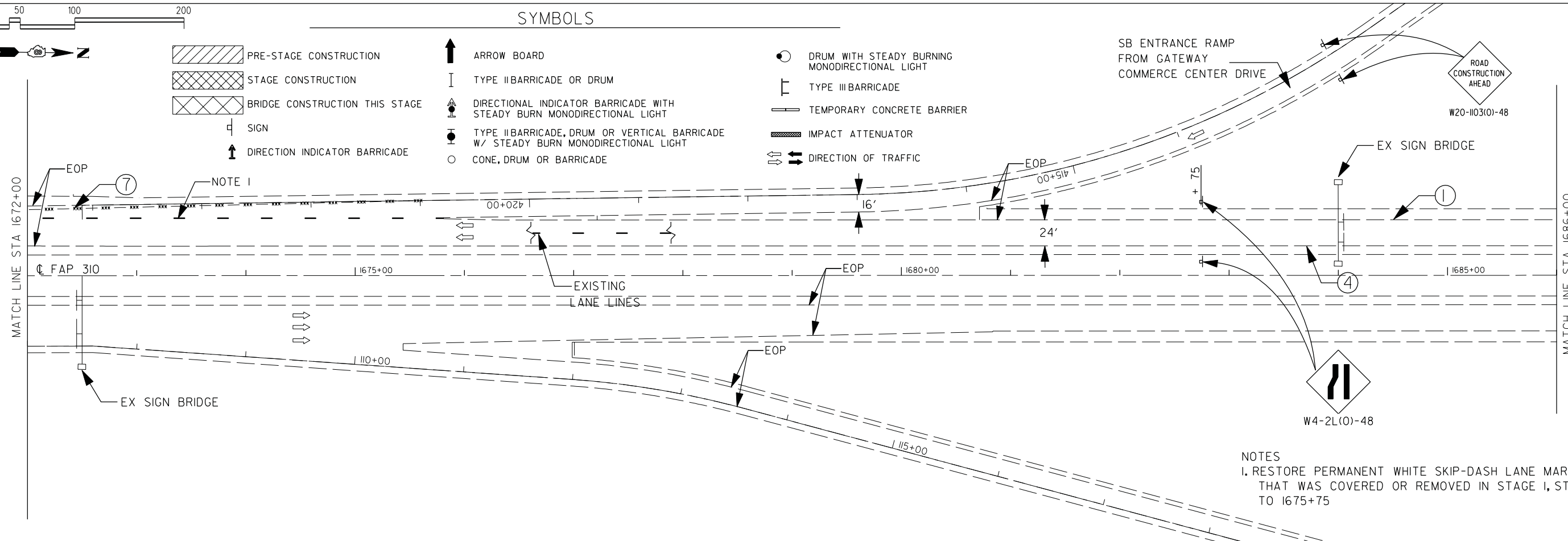

NOTES
1. RESTORE PERMANENT WHITE SKIP-DASH LANE MARKING THAT WAS COVERED OR REMOVED IN STAGE 1, STA 1637+75 TO 1675+75

PLOT DRIVER = M:\Admin\Reference Data\CAD_Support\workspaces\tondard\p101\inter-hoi.f.plt
 PEN TABLE = M:\Admin\Reference Data\CAD_Support\workspaces\tondard\p101\inter-hoi.f.tbl

GONZALEZ COMPANIES, LLC 618-222-2221 WWW.GONZALEZCOS.COM

FILE NAME = D876F10-sh79-stage 2.dgn	USER NAME = Note	DESIGNED - JG	REVISED - ----
		DRAWN - NC	REVISED - ----
		CHECKED - CH	REVISED - ----
		DATE - 09/23/2013	REVISED - ----

**STATE OF ILLINOIS
DEPARTMENT OF TRANSPORTATION**

TEMPORARY TRAFFIC CONTROL - STAGE 2

SCALE: 1"=50' SHEET NO. 36 OF 37 SHEETS STA. 1658+00 TO STA. 1686+00

F.A.I. RTE.	SECTION	COUNTY	TOTAL SHEETS	SHEET NO.
255	60-18.91RS-1	MADISON	206	79
CONTRACT NO. 76F10				
ILLINOIS FED. AID PROJECT				